

• 3808 Lighthouse •

L4 B B Park Bonanza East 6-B Zone R-1

1 Gatewood 9-27-79

305

T-11-2

CITY OF LAS VEGAS, NEVADA  
DEPT. OF PUBLIC SERVICES

LOG NO. & AREA  
DIVISION OF BUILDING & SAFETY  
PHONE: 386-6251

CONST. VAL. 27580  
APPLICATION & BUILDING PERMIT - for  
Dwellings, Duplexes, Misc. Residential Const.

ADDRESS OF CONSTRUCTION: 3808 LIGATHOUSE AVE

OWNER: KENNEY MOBILE HOMES INC

LOT(s) 4 BLOCK B SUBDIVISION PARK BONANZA EAST 6B ZONE R1

Existing structure on lot: Dwelling  Accessory bldgs.  Vacant lot  Other

PROPOSED CONSTRUCTION: 3FD USE R-1

MATERIALS OF CONSTRUCTION: Wood Frame  Concrete Block  Reinforced Concrete  Steel Frame

SQ. FEET OF FLOOR AREAS: 1st 1232 2nd 3rd Other GAR 294 TOTAL SQ. FT. 1526

FIRE ZONE: 3 Occupancy Group IJ CONST. TYPE: V

ARCHITECT: ENGINEER: R. KRAEMER NO. of UNITS 1 NO. of STORIES 1

Plans Submitted: Yes  No  Calculations Submitted Yes  No  Sewer Fee Req'd. Yes  No

CONTRACTOR: J. KENNEY JR STATE LICENSE # 11008 CITY LICENSE # C-11-4087

ADD'L. PERMITS REQ'D: Air Cond.  Elec.  Plumbing  Signs  Paving  Fence  Public Walks  Curb-gutters   
Incinerators  Fire-Sprinkling System

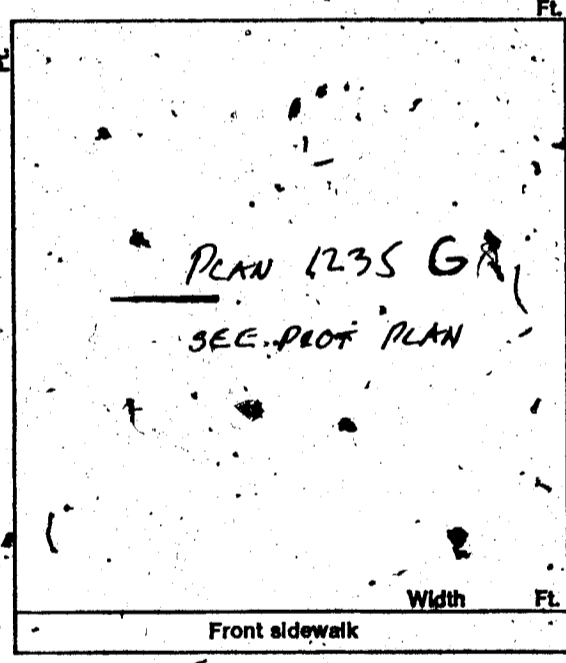

CONDITIONS OF THE PERMIT:

1. I agree to call the City Building Department for inspections before concrete is poured, before rough wiring, electrical, plumbing, framing is covered. Also for air conditioning, sheet-rock and sheathing inspection.
2. I agree that when the job is completed that I will call for final inspection before occupancy.
3. I agree to perform all construction in accordance with City Ordinances and Building Codes.
4. The Contractor's signature below denotes authority from the owner to sign in his behalf and that the owner is aware of all requirements of this application and permit. Separate permits must be taken out for work outlined above this agreement.
5. I have read and understand the contents of this application and permit; I hereby state that the information I have supplied on this application is true and correct.

SIGNED: J. Kenney Jr Contractor  
BY: KENNEY MOBILE HOMES INC Agent or Owner

CLARK COUNTY HEALTH DEPT. Date \_\_\_\_\_  
LAS VEGAS FIRE DEPARTMENT Date \_\_\_\_\_

PLANNING DEPT. [Signature] Date: 4/9/77  
PUBLIC WORKS DEPT. [Signature] Date: 4-5-77  
BUILDING DEPT. [Signature] Date: 4/6/77  
PERMIT NO.: 1873 PERMIT FEE \$ 107.00

RECEIPT  
8490 \$107.00 - 8

CITY OF LAS VEGAS  
BUILDING DEPARTMENT

MUST BE MACHINE VALIDATED

154-01-220  
76-11-14

1 Haterwood 9-27-79

3-05

CITY OF LAS VEGAS, NEVADA  
DEPT. OF PUBLIC SERVICES

LOG NO. & AREA T-11-2  
DIVISION OF BUILDING & SAFETY  
PHONE: 386-6251

CONST. VAL. 27580  
APPLICATION & BUILDING PERMIT - for  
Dwellings, Duplexes, Misc. Residential Const.

ADDRESS OF CONSTRUCTION: 3808 LIGHTHOUSE AVE OWNER: KENNEY MOBILE HOMES INC

LOT(s) 4 BLOCK B SUBDIVISION PARK BONANZA EAST 6B ZONE: R-1

Existing structure on lot: Dwelling  Accessory bldgs.  Vacant lot  Other

PROPOSED CONSTRUCTION: SFD USE: R-1

MATERIALS OF CONSTRUCTION: Wood Frame  Concrete Block  Reinforced Concrete  Steel Frame

SQ. FEET OF FLOOR AREAS: 1st 1232 2nd GAR 294 3rd  Other 1526 TOTAL SQ. FT. 1526

FIRE ZONE: 3 Occupancy Group I J CONST. TYPE: V

ARCHITECT:  ENGINEER: R. KRAEMER NO. of UNITS: 1 NO. of STORIES: 1

Plans Submitted: Yes  No  Calculations Submitted: Yes  No  Sewer Fee Req'd. Yes  No

CONTRACTOR: J. KENNEY, JR. STATE LICENSE # 11008 CITY LICENSE # C-11-4087

ADD'L. PERMITS REQ'D: Air Cond.  Elec.  Plumbing  Signs  Paving  Fence  Public Walks  Curb-gutters   
Incinerators  Fire-Sprinkling System

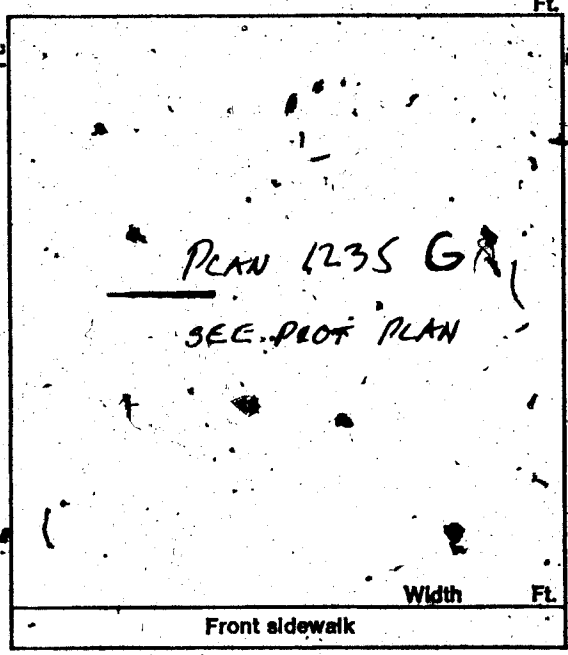

CONDITIONS OF THE PERMIT:

1. I agree to call the City Building Department for inspections before concrete is poured, before rough wiring, electrical, plumbing, framing is covered. Also for air conditioning, sheet-rock and sheathing inspection.
2. I agree that when the job is completed that I will call for final inspection before occupancy.
3. I agree to perform all construction in accordance with City Ordinances and Building Codes.
4. The Contractor's signature below denotes authority from the owner to sign in his behalf and that the owner is aware of all requirements of this application and permit. Separate permits must be taken out for work outlined above this agreement.
5. I have read and understand the contents of this application and permit; I hereby state that the information I have supplied on this application is true and correct.

SIGNED: John E. Kenney Contractor

BY: KENNEY MOBILE HOMES INC Agent or Owner

CLARK COUNTY HEALTH DEPT. Date: \_\_\_\_\_

LAS VEGAS FIRE DEPARTMENT Date: \_\_\_\_\_

PLANNING DEPT. [Signature] Date: 4/4/77

PUBLIC WORKS DEPT. [Signature] Date: 4-5-77

BUILDING DEPT.: [Signature] Date: 4/6/77

PERMIT NO.: 1873 PERMIT FEE \$ 107.00

154-01-220  
76-11-14

RECEIPT  
8490 \$107.00 - 8

CITY OF LAS VEGAS  
BUILDING DEPARTMENT

MUST BE MACHINE VALIDATED

J. Gatenwood 9-27-77

**CITY OF LAS VEGAS, NEVADA**  
**DEPARTMENT OF BUILDING & SAFETY - AIR CONDITIONING APPLICATION & PERMIT**

ADDRESS OF CONSTRUCTION: 3808 Lighthouse

OWNER'S NAME: KENNEY MOBILE HOMES INC.

CIRCLE: Addition; Remodel; New Bldg; TYPE OF BLDG.: SFD APT. COMM. PUBLIC

CONTRACTOR'S NAME: Tropic-Air Conditioning Co. STATE LICENSE # 1026 CITY LICENSE # 0331

UNITS	DESCRIPTION	FEE	TOTAL	UNITS	DESCRIPTION	FEE	TOTAL
	Unit heater - floor, wall or suspended	4.00			<b>EVAPORATIVE COOLERS:</b>		
	FOR EACH FORCED-AIR OR GRAVITY-TYPE FURNACE OR BURNER INCLUDING DUCTS AND VENT ATTACHED TO SUCH APPLIANCES:				5 outlets or under	3.00	
	Up to and including 100,000 B.t.u.'s	4.00			Over 5 and up to and including 10	5.00	
	Over 100,000 B.t.u.'s	6.00			Each additional outlet over 10	.25	
	FOR EACH HEATING APPLICATION, REFRIGERATION UNIT, COMFORT COOLING AND HEATING UNIT, ABSORPTION UNIT, COMPRESSOR OR BOILER:				<b>VENTILATION:</b>		
1	Up to and including 3 ton or horsepower, or absorption system up to and including 100,000 B.t.u.'s	4.00	4.00		For each fan connected to a single duct	1.00	
	Over 3 ton or 3 horsepower up to and including 10, or absorption system over 100,000 B.t.u.'s up to and including 250,000 B.t.u.'s	7.00			For each commercial or industrial ventilation system	5.00	
	Over 10 ton or 10 horsepower up to and including 30, or absorption system over 250,000 B.t.u.'s up to and including 1,000,000 B.t.u.'s	12.00			For each commercial kitchen hood	5.00	
	Over 30 ton or 30 horsepower up to and including 50, or absorption system over 1,000,000 B.t.u.'s up to and including 1,700,000 B.t.u.'s	20.00			<b>MISCELLANEOUS:</b>		
	Over 50 ton or 50 horsepower, or absorption system over 1,700,000 B.t.u.'s	30.00			For each water cooling tower	8.00	
	FOR EACH AIR HANDLING UNIT INCLUDING DUCTS ATTACHED THERETO:				Duct work only - each opening	.25	
	Up to and including 10,000 CFM	2.00			For installation or relocation of each commercial or industrial incinerator	15.00	
	Over 10,000 CFM	4.00			Gas piping related to the air cond. work in single family dwelling only	3.00	
					For each appliance, piece of equipment, any mechanical work or alteration or replacement not included in this schedule, the permit fee shall be computed the same as building permit fees by using the cost of installation for the valuation amount.		
					<b>FOR THE ISSUANCE OF EACH PERMIT</b>	3.00	
					<b>TOTAL PERMIT FEE \$</b>	<b>7.00</b>	

I hereby certify that I have carefully examined and read the above application; that the same is true and correct; and that the work herein described is to be done in accordance with all the provisions of the applicable Ordinances of the City of Las Vegas, Nevada and the State Laws, whether herein specified or not.

Approval for the work under this permit will be given only after refuse and debris have been removed from job site and public right of way.

SIGNED *William Wilson* Date 5-11-77  
 Air Conditioning Contractor - Owner

BUILDING DEPARTMENT *nm* Date 5-11-77

PERMIT NO. 659 PERMIT FEE \$ 7.00

154-01-224  
 #12890

**RECEIPT**  
 708 \$007.00 - 4  
 CITY OF LAS VEGAS  
 DEPT. OF BUILDING & SAFETY  
 MUST BE MACHINE VALIDATED  
 12 MAY 77

J. Gatuwood 9-27-79

**CITY OF LAS VEGAS, NEVADA**

**DEPARTMENT OF BUILDING & SAFETY - APPLICATION AND PERMIT FOR PLUMBING**

ADDRESS OF CONSTRUCTION: 3808 Lighthouse Ave. OWNER'S NAME: JACK KENNEY JR.  
 CIRCLE: New Bldg.; Add'n.; Remodel; TYPE OF BLDG.: SFD. APT. PUBLIC COMM.  
 CONTRACTOR'S NAME: HENDERSON PLBG. & HTG. CO. STATE LICENSE # 10547 CITY LICENSE # 111-7511

UNITS	DESCRIPTION	FEE	TOTAL
1	Bathtub	1.00	1.00
1	Shower	1.00	1.00
2	Lavatory	1.00	2.00
2	Toilet	1.00	2.00
	Urinal	1.00	
	Floor Drain	1.00	
	Floor Sink	1.00	
	Wash Tray	1.00	
1	Sink	1.00	1.00
1	Garbage Disposal	1.00	1.00
	Garbage Disposal (comm.)	3.00	
	Clothes Dryer (gas)	1.00	
1	Clothes Washer	1.00	1.00
	Clothes Washer (comm.)	5.00	
	Dishwasher	1.00	
	Dishwasher (commercial)	5.00	
	Dental Unit	10.00	
	Drinking Fountain	1.00	
	Any Water using Equipment	1.00	
	Water Heater (gas) (elect.)	1.00	
1	Sewer System - New, Replacement, or any Drainage System	4.00	4.00
	Grease or Sand Trap	2.00	
	Trailer Trap	2.00	
	Septic Disposal System	4.00	
<b>WATER SOFTENERS</b>			
	Nonpermanent Type	4.00	
	Permanent Type (connected to Drainage)	5.00	
<b>SWIMMING POOLS</b>			
	Private or Wading Pool	10.00	
	Public or Semi-public	20.00	

UNITS	DESCRIPTION	FEE	TOTAL
<b>WATER DISTRIBUTION SYSTEM</b>			
1	Single Family Dwelling	4.00	4.00
	Multiple Family Dwelling plus each unit	4.00	
	Bldg. Group "A" thru "C" per each floor	6.00	
	Hotel or Motel plus each bath	4.00	
	Trailer Park plus each space	20.00	
	Irrigation	1.00	
<b>GAS PIPING SYSTEM</b>			
1	Single Family Dwelling	3.00	3.00
	Multiple Family Dwelling plus each unit	6.00	
	Commercial Bldg. per floor plus each unit	1.00	
	Gas Appliance (any type)	3.00	
		1.00	
<b>AUTOMATIC FIRE EXTINGUISHING SYSTEM</b>			
	Underground Piping	16.00	
	Distribution Piping ea. ft.	.01	
	Sprinkler Head each	.10	
	In Range Hood and Vent	5.00	
<b>DRY STANDPIPE SYSTEM</b>			
	Piping	50.00	
	Each Outlet	1.00	
<b>WET STANDPIPE SYSTEM</b>			
	Piping	5.00	
	Fire Hose Cabinet	1.00	
<b>MINIMUM PERMIT FEE 4.00</b>			
<b>PIPELINE CONTRACTOR; SECT. 14-B.P.F. \$</b>			
<b>TOTAL PERMIT FEE \$ 20.00</b>			

I hereby certify that I have carefully examined and read the above application; that the same is true and correct; and that the work herein described is to be done in accordance with all the provisions of the applicable Ordinances of the City of Las Vegas, Nevada and the State Laws, whether herein specified or not.

Approval for the work under this permit will be given only after refuse and debris have been removed from job site and public right of way.

Signed: [Signature] Date: \_\_\_\_\_  
 Registered Master Plumber, Spec. Contr. or Owner  
 Building Department: [Signature] Date: 4-18-77  
 Permit No. 1366 Permit Fee \$ 20.00

154-01-222

**RECEIPT**

9088 \$020.00 - 7

**CITY OF LAS VEGAS**  
 BUILDING & SAFETY

MUST BE MACHINE VALIDATED

20 APR 77

J. Gatewood 9-27-79

# CITY OF LAS VEGAS, NEVADA

## DEPARTMENT OF BUILDING & SAFETY - APPLICATION AND PERMIT FOR PLUMBING

ADDRESS OF CONSTRUCTION: 3808 Lighthouse Ave. OWNER'S NAME: JACK KENNEY JR.

CIRCLE:  New Bldg.;  Add'n.;  Remodel; TYPE OF BLDG.:  SFD.  APT.  PUBLIC COMM.

CONTRACTOR'S NAME: HENDERSON PLOGG & HTC, CO. STATE LICENSE # 10547 CITY LICENSE # 111-7511

UNITS	DESCRIPTION	FEE	TOTAL
1	Bathtub	1.00	1.00
1	Shower	1.00	1.00
2	Lavatory	1.00	2.00
2	Toilet	1.00	2.00
	Urinal	1.00	
	Floor Drain	1.00	
	Floor Sink	1.00	
	Wash Tray	1.00	
1	Sink	1.00	1.00
1	Garbage Disposal	1.00	1.00
	Garbage Disposal (comm.)	3.00	
	Clothes Dryer (gas)	1.00	
1	Clothes Washer	1.00	1.00
	Clothes Washer (comm.)	5.00	
	Dishwasher	1.00	
	Dishwasher (commercial)	5.00	
	Dental Unit	10.00	
	Drinking Fountain	1.00	
	Any Water using Equipment	1.00	
	Water Heater (gas) (elect.)	1.00	
1	Sewer System—New, Replacement, or any Drainage System	4.00	4.00
	Grease or Sand Trap	2.00	
	Trailer Trap	2.00	
	Septic Disposal System	4.00	
WATER SOFTENERS			
	Nonpermanent Type	4.00	
	Permanent Type (connected to Drainage)	5.00	
SWIMMING POOLS			
	Private or Wading Pool	10.00	
	Public or Semi-public	20.00	

UNITS	DESCRIPTION	FEE	TOTAL
WATER DISTRIBUTION SYSTEM			
1	Single Family Dwelling	4.00	4.00
	Multiple Family Dwelling plus each unit	4.00 .00	
	Bldg. Group "A" thru "F" per each floor	6.00	
	Hotel or Motel plus each bath	4.00 1.50	
	Trailer Park plus each space	20.00 1.00	
	Irrigation	4.00	
GAS PIPING SYSTEM			
1	Single Family Dwelling	3.00	3.00
	Multiple Family Dwelling plus each unit	6.00 1.00	
	Commercial Bldg. per floor plus each unit	3.00 3.00	
	Gas Appliance (any type)	1.00	
AUTOMATIC FIRE EXTINGUISHING SYSTEM			
	Underground Piping	16.00	
	Distribution Piping ea. ft.	.01	
	Sprinkler Head each	.10	
	In Range Hood and Vent	5.00	
DRY STANDPIPE SYSTEM			
	Piping	50.00	
	Each Outlet	1.00	
WET STANDPIPE SYSTEM			
	Piping	5.00	
	Fire Hose Cabinet	1.00	
MINIMUM PERMIT FEE 4.00			
PIPELINE CONTRACTOR; SECT. 14-B.P.F. \$			
TOTAL PERMIT FEE \$ 20.00			

I hereby certify that I have carefully examined and read the above application; that the same is true and correct; and that the work herein described is to be done in accordance with all the provisions of the applicable Ordinances of the City of Las Vegas, Nevada and the State Laws, whether herein specified or not.

Approval for the work under this permit will be given only after refuse and debris have been removed from job site and public right of way.

Signed: [Signature] Date: \_\_\_\_\_  
Registered Master Plumber, Spec. Contr. or Owner

Building Department: [Signature] Date: 4-18-77

Permit No. 1366 Permit Fee \$ 20.00

RECEIPT

9088 \$020.00 - 7

CITY OF LAS VEGAS  
 BUILDING & SAFETY

MUST BE MACHINE VALIDATED

20 APR 77

J. Hatwood 9-27-79

# CITY OF LAS VEGAS, NEVADA

## DIVISION OF BUILDING & SAFETY - ELECTRICAL APPLICATION & PERMIT

ADDRESS OF CONSTRUCTION: 3808 Lighthouse OWNER'S NAME: KERRY MOBILE HOMES, Inc.

CIRCLE: New Bldg. Add'n.: Remodel. TYPE OF BLDG.: SFD. APT. PUBLIC COMM.

CONTRACTOR'S NAME: ANDERSON ELECTRIC STATE LICENSE # 10997 CITY LICENSE # 090-2-00350

NUMBER	FIXTURE OR INSTALLATION	UNIT PRICE	TOTAL
	Rm. addition, carport or garage enclosure	4.00	
	Temporary power	4.00	
43	Light, receptacle or switch outlet	.21	9.00
	Wall or ceiling space heater	.35	
1	Garbage grinder outlet	.35	.35
1	Dishwasher outlet	.35	.35
	Clothes dryer outlet	.35	
	Automatic clothes washer	.35	
	Electric range outlet	.35	
	Electric water heater outlet	.35	
	Special purpose outlet	.35	
	X-ray unit and its appurtenances	5.00	
	Watts of festoon lighting (Watts) First 3,000 watts for each additional thousand watts	4.00 1.50	
	Horsepower each motor first horsepower or less for each additional horsepower	1.75 .35	
1	Electric service (including any single meter socket) for each additional socket	3.00 .35	3.00
1	Air conditioning service	1.50	1.50
	Each KW(KVA) Generator (Transformer, Welder) First 100 KVA for each additional KW(KVA)	2.00 .01	
1	Speaker, signal or alarm outlet	.15	.15
	Amplifiers	.50	
	Control panels	.25	
	Main control racks	1.00	
	T.V. and radio antennas-master system only	.75	
	Minimum fee for any permit	4.00	
	<b>TOTAL FEE</b>		<b>\$14.35</b>

Approval for the work under this permit will be given only after refuse and debris have been removed from job site and public right of way.

I hereby certify that I have carefully examined and read the above application; that the same is true and correct; and that the work herein described is to be done in accordance with all the provisions of the applicable Ordinances of the City of Las Vegas, Nevada and State laws whether herein specified or not.

SIGNED Glenn E. Anderson DATE 5/24/77  
MASTER (ELECTRICIAN) (TECHNICIAN) (OWNER) MS

BUILDING DEPARTMENT NM DATE 5-26-77

76-10-14 154-01-221 PERMIT NO. 2584 PERMIT FEE: \$ 14.35

1639 RECEIVED 4.35 - 6  
CITY OF LAS VEGAS  
BUILDING & SAFETY  
MUST BE MACHINELY REPRODUCED  
26 MAY 77

49-02  
J. Gated 9-27-79

# CITY OF LAS VEGAS, NEVADA

LOG NO. & AREA

CONST. VAL 6160

DEPARTMENT OF PUBLIC SERVICES  
DIVISION OF BUILDING AND SAFETY

APPLICATION & BUILDING PERMIT - for:  
Dwellings, Duplexes, Misc, Residential Const.

ADDRESS OF CONSTRUCTION:

3808 LIGHTHOUSE

OWNER:

ORNEIAS

LOT(s)

4

BLOCK

B

SUBDIVISION

PARADISE BONANZA P. 10-B

ZONE

R-1

Existing structure on lot:

Dwelling

Accessory Bldgs.

Vacant Lot

Other

PROPOSED CONSTRUCTION:

PATIO (ATTACHED)

8' x 20' Side only

USE:

MATERIALS OF CONSTRUCTION:

Wood Frame

Concrete Block

Reinforced Concrete

Steel Frame

SQUARE FEET OF FLOOR AREAS:

1st

2nd

3rd

Other

TOTAL SQ. FT.

FIRE ZONE:

Occupancy Group

CONST. TYPE:

ARCHITECT:

ENGINEER:

NO. of UNITS

NO. of STORES

Plans Submitted:

Yes

No

Calculations Submitted

Yes

No

Sewer Fee Rec'd.

Yes

No

CONTRACTOR:

OWNER

STATE LICENSE #

CITY LICENSE #

ADD'L. PERMITS REQ'D.:

Air Cond.

Elec.

Plumbing

Signs

Paving

Fence

Public Walks

Curb-gutters

Incinerators

Fire Sprinkling System

## CONDITIONS OF THE PERMIT

1. I agree to call the City Building Department for inspections before concrete is poured, before rough wiring, electrical, plumbing, framing is covered. Also for Air conditioning, drywall and sheathing inspection.
2. I agree that when the job is completed that I will call for final inspection before occupancy.
3. I agree to perform all construction in accordance with City Ordinances and Building Codes.
4. The Contractor's signature below denotes authority from the owner to sign in his behalf and that the owner is aware of all requirements of this application and permit. Separate permits must be taken out for work outlined above this agreement.
5. I have read and understand the contents of this application and permit. I hereby state that the information I have supplied on this application is true and correct.

Approval for the work under this permit will be given only after refuse and debris have been removed from job site and public right of way.

SIGNED:

Contractor

BY:

Arthur K. G. ...

Agent or Owner

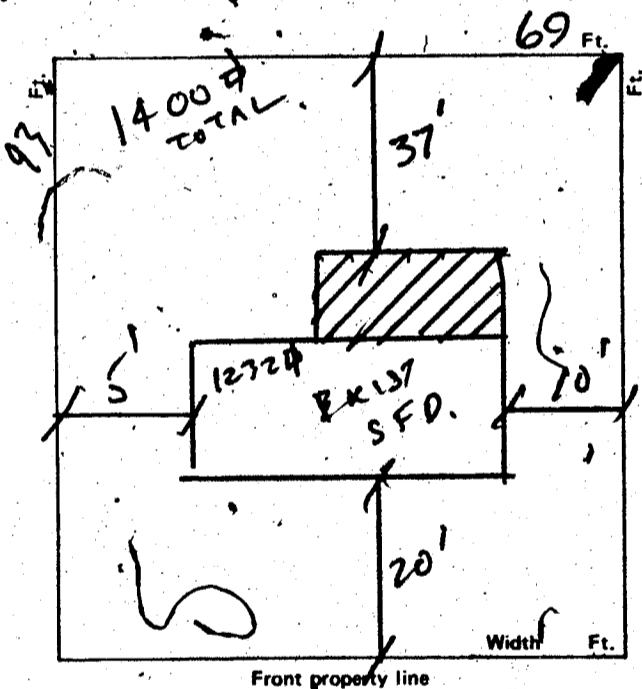

PLANNING DEPT.

[Signature]

Date:

3/20/78

PUBLIC WORKS DEPT.

Charles Turk

Date:

3/20/78

BUILDING DIVISION:

W.Y.

Date:

3-20-78

PERMIT NO.:

4564

PERMIT FEE \$

500

154-01-220

1 DEN \$ .00  
 SFD \$ 5.00  
 STL \$ 5.00  
 STL \$ 5.00  
 TITLE \$ .00  
 CASH RECEIPT \$ 5.00  
 R#4364 SR#001/01  
 CITY - LAS VEGAS  
 BLDG. & SAFETY  
 03/20/78

MUST BE MACHINE VALIDATED

*Dona Hooley* *P-2482*

DIVISION of BUILDING & SAFETY - CITY of LAS VEGAS, NEVADA

OWNER Ornelas ADDRESS 3808 Lighthouse DATE 3-20-78  
 GEN. CONT. Owner TYPE OF STRUCTURE patio slab only  
 PERMIT NO. 4564 LEGAL DESCRIPTION L 4 B 13 Park Bonanza

BUILDING	MECHANICAL	ELECTRICAL
Investigation	Plumbing Cont.	Temp. pole cont.
Location & Footing	Permit No. _____ Date _____	Permit No. _____ Date _____
Stem Wall	Heat & Vent. A/C Cont.	Inspection _____ Date _____
Concrete Slab Floor	Permit No. _____ Date _____	Electrical Cont.
Floor Framing	Sewer Cont.	Permit No. _____ Date _____
Fireplace Footing	Permit No. _____ Date _____	Fixtures Cont.
Chimney Steel	Rough Soil	Permit No. _____ Date _____
Vert. Steel Reinf.	Rough Water	Slab _____
Horiz. Steel Reinf.	Top-Out	Rough _____
Roof Sheathing	Rough Gas	Final Rough _____
Framing	A/C Rough Duct	Final Fixture _____
Backing for siding	Ref. Rough Piping	Final Electrical _____
Ext. Lath	Final Plumbing	Temporary Service _____
Ext. Scratch	Final Gas	
Ext. Brown	Final Air Cond.	
Int. Lath	Final Refrig.	
Int. Brown	Final Sewer	
Drywall	Final Septic Tank	
Insulation		
Final Building <u>EC 1-9-79</u>		
Appr. for Occu.		

INSPECTOR: \_\_\_\_\_ DATE \_\_\_\_\_

APPROVED FOR OCCUPANCY & METER

PLEASE NOTE REMARKS ON REVERSE SIDE 3808 Lighthouse LOG # \_\_\_\_\_ AREA # \_\_\_\_\_

DIVISION of BUILDING & SAFETY - CITY of LAS VEGAS, NEVADA

OWNER Kenney Mobile Homes ADDRESS 3808 Lighthouse Ave. DATE 4-7-77  
 GEN. CONT. J. Kenney TYPE OF STRUCTURE SFD  
 PERMIT NO. 1873 LEGAL DESCRIPTION L 4 B B Park Bonanza East 6 B

BUILDING	MECHANICAL	ELECTRICAL
Investigation	Plumbing Cont. <u>Hardman pbb</u>	Temp. pole cont.
Location & Footing <u>BW 4-12-77</u>	Permit No. <u>1366</u> Date <u>4-18-77</u>	Permit No. _____ Date _____
Stem Wall <u>BW 4-14-77</u>	Heat & Vent. A/C Cont. <u>Apple</u>	Inspection _____ Date _____
Concrete Slab Floor <u>BW 4-21-77</u>	Permit No. <u>659</u> Date <u>5-11-77</u>	Electrical Cont. <u>Anderson</u>
Floor Framing	Sewer Cont. <u>Kenney Jr.</u>	Permit No. <u>2584</u> Date <u>5-26-77</u>
Fireplace Footing	Permit No. <u>1171</u> Date _____	Fixtures Cont.
Chimney Steel	Rough Soil <u>WEP 4-19-77</u>	Permit No. _____ Date _____
Vert. Steel Reinf.	Rough Water <u>WEP 4-19-77</u>	Slab _____
Horiz. Steel Reinf.	Top-Out <u>WEP 5-26-77</u>	Rough _____
Roof Sheathing <u>BW 5-18-77</u>	Rough Gas <u>WEP 5-26-77</u>	Final Rough _____
Framing	A/C Rough Duct <u>WEP 5-25-77</u>	Final Fixture _____
Backing for siding	Ref. Rough Piping	Final Electrical <u>257-13-77</u>
Ext. Lath <u>BW 5-27-77</u>	Final Plumbing <u>1-5-79 JC</u>	Temporary Service _____
Ext. Scratch <u>BW 6-18-77</u>	Final Gas <u>1-5-79 JC</u>	
Ext. Brown <u>22-29-77</u>	Final Air Cond. <u>1-5-79 JC</u>	
Int. Lath	Final Refrig.	
Int. Brown	Final Sewer <u>WEP 4-18-77</u>	
Drywall <u>BW 6-8-77</u>	Final Septic Tank	
Insulation		
Final Building		
Appr. for Occu.		

INSPECTOR: \_\_\_\_\_ DATE \_\_\_\_\_

APPROVED FOR OCCUPANCY & METER

PLEASE NOTE REMARKS ON REVERSE SIDE 3808 Lighthouse Ave. LOG # \_\_\_\_\_ AREA # T 11-2 76-114