

Memorandum

Department of Public Works
City Engineer Division
Survey Section
333 North Rancho Dr., 8th Floor
Las Vegas, Nevada 89106
Phone (702) 229-6217
Fax (702) 804-8582

To: Michael Cunningham, Manager
Building and Safety Department

From: Alan R. Riecki, PLS
City Surveyor

C: Lance M. West, PLS
Wallace Morris Kline

Tim Parks, P.E., Engineering Project Manager
Sanitary Sewers Section, Engineering Planning

Date: May 3, 2021

Re: Sanitary Sewer Final Location Map
Crystal Canyon Unit 2 Village 21 Parcels A & B
(Drawing No. 107Y5130-2, L-Civil No. L20-01211)

The Survey Section has reviewed the Final Location Map and as far as our jurisdiction of this project is concerned, we find that the map is:

Acceptable: 05/03/21

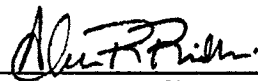

Signature

City Surveyor

Title

Public Works/Survey

Department/Division

ARR/OS:mj

CITY OF LAS VEGAS

BUILDING AND SAFETY DEPARTMENT

OFFSITE INSPECTION & TESTING
333 NORTH RANCHO DRIVE
LAS VEGAS, NV 89106
PHONE: (702) 229-6337
FAX: (702) 363-1051

DEVELOPER'S SUBMITTAL OF GPS COORDINATES

Sewer

Storm Drain

Electronic Comma Delineated File

Final Location Map (2)

NOTE: THE TOP PART OF THIS FORM MUST BE FILLED OUT IN ITS ENTIRETY

PROJECT NAME: CRYSTAL CANYON UNIT 2 UNIT: 2 PHASE: N/A

PROJECT LOCATION: RIDGE PINE STREET AND REDPOINT DRIVE

CLV PLAN #: L20-01211 CLV PROJECT # 107Y5130-2 SHEET NO. (S): 2

OF MANHOLES 9 PUB. SEWER/STORM DRAIN LIN. FT. 1,312 # OF PRIVATE LATERALS N/A

DEVELOPER: WOODSIDE HOMES OF NEVADA LLC. PHONE: 702-889-7824 FAX: _____

SURVEY CO.: WALLACE MORRIS KLINE PHONE: 702-212-3967 FAX: 702-212-3963

CONTRACTOR: WESTERN STATES PHONE: 702-644-1117 FAX: 702-644-1227

CONTRACTOR'S SUPERVISOR NAME: FAUSTINO GUERRAS MOBILE: 702-204-9827

DATE OF REQUEST: 02/22/2021

THIS SEWER HAS BEEN SURVEYED BY NEVADA LICENSED LAND SURVEYOR:

Company Name WALLACE MORRIS KLINE Surveyor Name LANCE WEST

License # 18232 License exp. Date: 6/30/22

CITY USE ONLY

DATE SR. INSPECTOR RECEIVED: _____ SR. INSPECTOR INITIALS: _____

DATE RECEIVED FROM SR. INSPECTOR AND SENT TO CITY SURVEYOR: _____

ACCEPTABLE BY CITY SURVEYOR DATE: 05/03/21 NOT ACCEPTABLE BY CITY SURVEYOR DATE _____

CLV SURVEYOR'S SIGNATURE: _____  DATE: 5/3/2021

THE CITY OF LAS VEGAS RECOMMENDS THAT ALL DEFICIENCIES NOTED ON THE ATTACHED SURVEY REPORT BE CORRECTED PRIOR TO THE FINAL ACCEPTANCE.

For Sanitary Sewer To Complete and Return to Offsite Inspection & Testing:

RECEIVED BY: _____
(PLEASE PRINT)

SIGNATURE: _____ DATE: _____

For Flood Control To Complete and Return to Offsite Inspection & Testing:

RECEIVED BY: _____
(PLEASE PRINT)

SIGNATURE: _____ DATE: _____

SANITARY SEWER FINAL LOCATION MAP FOR CRYSTAL CANYON UNIT 2 SUMMERLIN VILLAGE 21 PARCEL A AND B

A COMMON INTEREST COMMUNITY

BEING A SUBDIVISION OF LOT A OF THAT CERTAIN FINAL MAP ENTITLED "CRYSTAL CANYON - SUMMERLIN VILLAGE 21 PARCELS A&B - UNIT 1" ON FILE IN BOOK 162, PAGE 77 OF PLATS, OFFICIAL RECORDS, CLARK COUNTY, NEVADA, LYING WITHIN THE WEST HALF (W1/2) OF SECTION 26, TOWNSHIP 20 SOUTH, RANGE 59 EAST, M.D.M., CITY OF LAS VEGAS, CLARK COUNTY, NEVADA



SURVEYOR'S STATEMENT

- 1) SURVEY WAS COMPLETED ON FEBRUARY 22, 2021.
- 2) THE POSITIONAL CERTAINTY FOR THIS SURVEY IS 0.3' HORIZONTAL AND 0.3' VERTICAL BASED ON NAD83(2011), EPOCH 2010.00
- 3) THE POSITIONAL CERTAINTY STATED DOES NOT TAKE INTO ACCOUNT ANY MODIFICATIONS TO THE PIPE, MANHOLES OR LATERALS COMPLETED AFTER THE DATE OF SURVEY.

LANCE M. WEST
PROFESSIONAL LAND SURVEYOR
NEVADA LICENSE NO. 18232

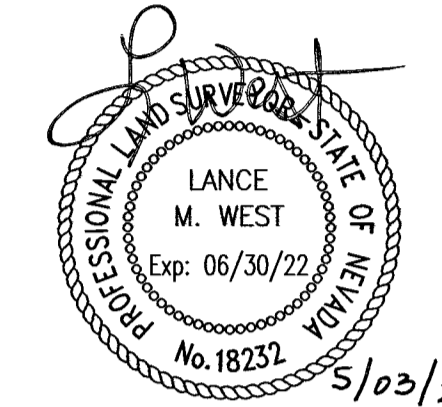

BASIS OF BEARINGS

GRID NORTH AS DEFINED BY THE CENTRAL MERIDIAN OF THE NEVADA COORDINATE REFERENCE SYSTEM (NCRS), LAS VEGAS AND LAS VEGAS HIGH ELEVATION ZONES, NORTH AMERICAN DATUM OF 1983; SAID MERIDIAN BEING COINCIDENT WITH 114°58' WEST OF THE GREENWICH MERIDIAN.

ZONE: LAS VEGAS HIGH ZONE

DATUM (REFERENCE FRAME): NAD 1983(2011) EPOCH 2010.00

SYSTEM: NEVADA COORDINATE REFERENCE SYSTEM (NCRS)

PROJECTION: TRANSVERSE MERCATOR

STANDARD PARALLEL (AND LATITUDE OF GRID ORIGIN): 36°15'00"N

LONGITUDE OF CENTRAL MERIDIAN: 114°58'00"W

NORTHING AT GRID ORIGIN: 400,000.00 M (1,312,333.3333 FEET US)

EASTING AT CENTRAL MERIDIAN: 300,000.00 M (984,250.0000 FEET US)

SCALE FACTOR ON CENTRAL MERIDIAN: 1.000135 (EXACT)

NOTES:

1. ALL DISTANCES AND BEARINGS SHOWN HEREON ARE PROJECTED (GRID) VALUES BASED ON THE PRECEDING PROJECTION DEFINITION.
2. GRID BEARING SHOWN HEREON (OR IMPLIED BY GRID COORDINATES) DO NOT EQUAL GEODETIC BEARING DUE TO MERIDIAN CONVERGENCE.

BENCHMARK

SLV0926W6 - BEING A RIVET AND PLATE IN TOP OF CURB AT THE SE CORNER OF CARRIAGE HILL DR. AND FAR HILLS DR.

3229.29 US SURVEY FEET
984.288 METERS

N.A.V.D. 88 DATUM

NOTES

- 1) SEE ELECTRONIC FILE "CRYSTAL CANYON UNIT 2--SS--PNIS--NCRS.TXT" FOR COORDINATES.

LEGEND

---	RIGHT-OF-WAY LINE	CL BARREL	CENTER OF MANHOLE BARREL
---	STREET CENTERLINE	SWR-Y	SHOT TAKEN ON TOP OF PIPE AT SEWER Y
---	SEWER LINE	SWR-LATERAL	SHOT TAKEN ON TOP OF PIPE AT SEWER LATERAL
x	POINT LOCATION	PIPE-TOP	SHOT TAKEN ON TOP OF PIPE
23118	POINT NUMBER		
21	LOT NUMBER		

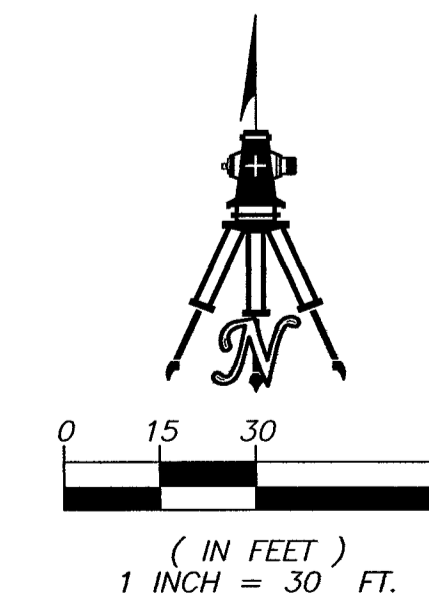

SHEET 1 OF 2

JOB# WSH-20062

H# L20-01211
CLV DWG# 107Y5130-2

SANITARY SEWER FINAL LOCATION MAP
CRYSTAL CANYON UNIT 2
A COMMON INTEREST COMMUNITY
BEING A SUBDIVISION OF LOT A OF THAT CERTAIN FINAL MAP ENTITLED "CRYSTAL CANYON - SUMMERLIN VILLAGE 21 PARCELS A&B - UNIT 1" ON FILE IN BOOK 162, PAGE 77 OF PLATS, OFFICIAL RECORDS, CLARK COUNTY, NEVADA, LYING WITHIN THE WEST HALF (W1/2) OF SECTION 26, TOWNSHIP 20 SOUTH, RANGE 59 EAST, M.D.M., CITY OF LAS VEGAS, CLARK COUNTY, NEVADA

WALLACE · MORRIS · KLINE
SURVEYING, L.L.C.
LAND SURVEY CONSULTING
5740 SOUTH ARVILLE STREET, #206
LAS VEGAS, NEVADA 89118
PH:702.212.3967 FX:702.212.3963

SANITARY SEWER FINAL LOCATION MAP FOR CRYSTAL CANYON UNIT 2 SUMMERLIN VILLAGE 21 PARCEL A AND B

A COMMON INTEREST COMMUNITY

BEING A SUBDIVISION OF LOT A OF THAT CERTAIN FINAL MAP ENTITLED "CRYSTAL CANYON - SUMMERLIN VILLAGE 21 PARCELS A&B - UNIT 1" ON FILE IN BOOK 162, PAGE 77 OF PLATS, OFFICIAL RECORDS, CLARK COUNTY, NEVADA, LYING WITHIN THE WEST HALF (W1/2) OF SECTION 26, TOWNSHIP 20 SOUTH, RANGE 59 EAST, M.D.M., CITY OF LAS VEGAS, CLARK COUNTY, NEVADA

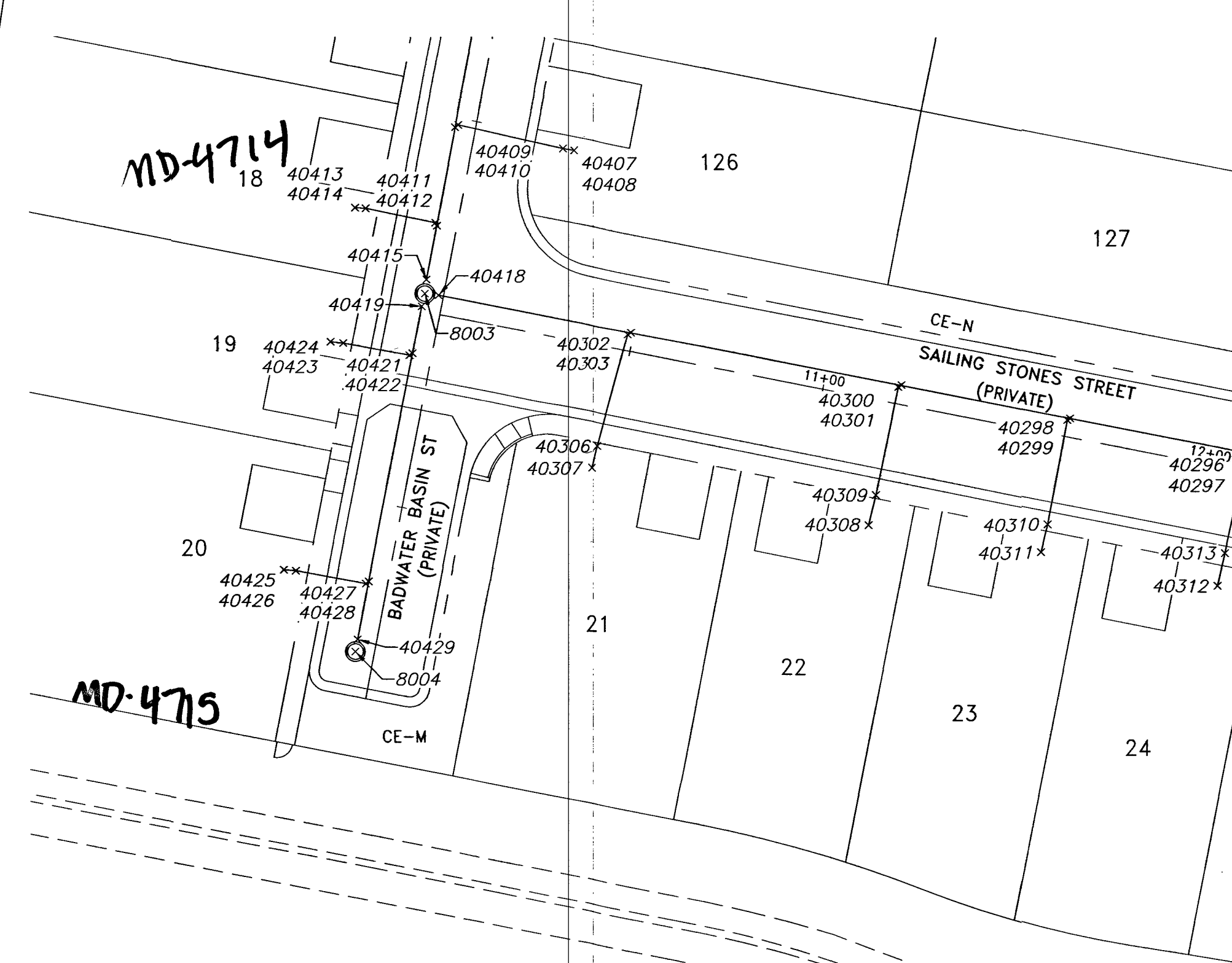
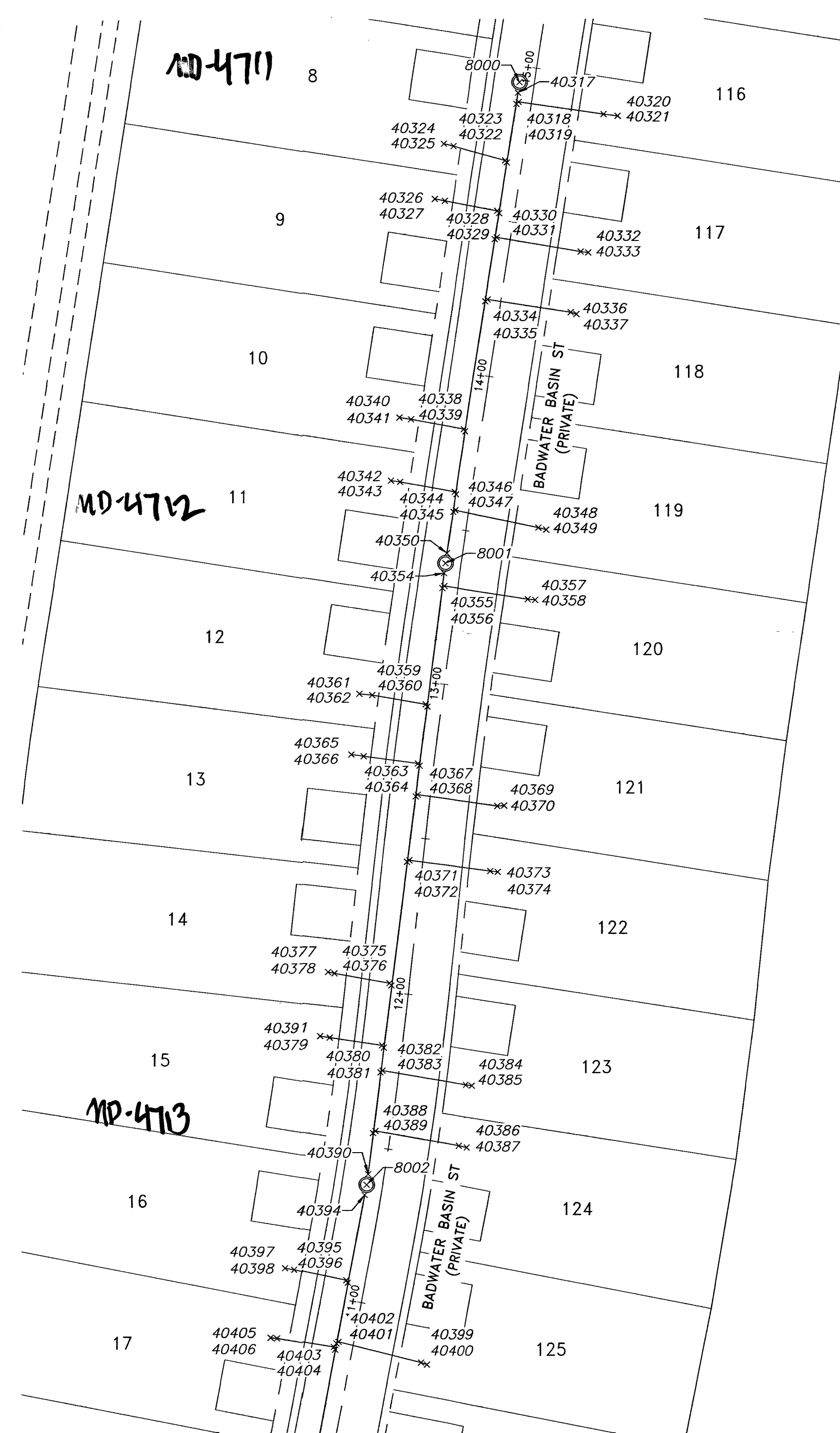

SURVEYOR'S STATEMENT

- 1) SURVEY WAS COMPLETED ON FEBRUARY 22, 2021.
- 2) THE POSITIONAL CERTAINTY FOR THIS SURVEY IS 0.3' HORIZONTAL AND 0.3' VERTICAL BASED ON NAD83(2011), EPOCH 2010.00
- 3) THE POSITIONAL CERTAINTY STATED DOES NOT TAKE INTO ACCOUNT ANY MODIFICATIONS TO THE PIPE, MANHOLES OR LATERALS COMPLETED AFTER THE DATE OF SURVEY.

LANCE M. WEST
PROFESSIONAL LAND SURVEYOR
NEVADA LICENSE NO. 18232

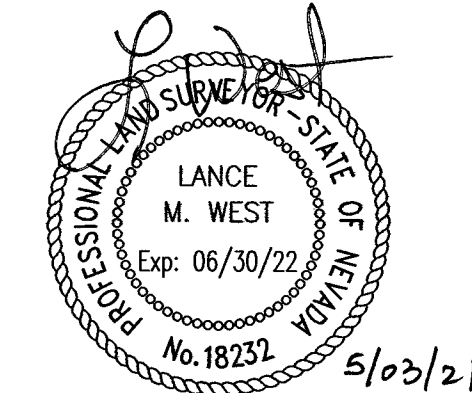

BASIS OF BEARINGS

GRID NORTH AS DEFINED BY THE CENTRAL MERIDIAN OF THE NEVADA COORDINATE REFERENCE SYSTEM (NCRS), LAS VEGAS AND LAS VEGAS HIGH ELEVATION ZONES, NORTH AMERICAN DATUM OF 1983; SAID MERIDIAN BEING COINCIDENT WITH 114°58' WEST OF THE GREENWICH MERIDIAN.

ZONE: LAS VEGAS HIGH ZONE

DATUM (REFERENCE FRAME): NAD 1983(2011) EPOCH 2010.00

SYSTEM: NEVADA COORDINATE REFERENCE SYSTEM (NCRS)

PROJECTION: TRANSVERSE MERCATOR

STANDARD PARALLEL (AND LATITUDE OF GRID ORIGIN): 36°15'00"N

LONGITUDE OF CENTRAL MERIDIAN: 114°58'00"W

NORTHING AT GRID ORIGIN: 400,000.00 M (1,312,333.3333 FEET US)

EASTING AT CENTRAL MERIDIAN: 300,000.00 M (984,250.0000 FEET US)

SCALE FACTOR ON CENTRAL MERIDIAN: 1.000135 (EXACT)

NOTES:

1. ALL DISTANCES AND BEARINGS SHOWN HEREON ARE PROJECTED (GRID) VALUES BASED ON THE PRECEDING PROJECTION DEFINITION.
2. GRID BEARING SHOWN HEREON (OR IMPLIED BY GRID COORDINATES) DO NOT EQUAL GEODETIC BEARING DUE TO MERIDIAN CONVERGENCE.

BENCHMARK

SLV0926W6 - BEING A RIVET AND PLATE IN TOP OF CURB AT THE SE CORNER OF CARRIAGE HILL DR. AND FAR HILLS DR.

3229.29 US SURVEY FEET
984.288 METERS

N.A.V.D. 88 DATUM

NOTES

- 1) SEE ELECTRONIC FILE "CRYSTAL CANYON UNIT 2-SS-PNTS-NCRS.TXT" FOR COORDINATES.

LEGEND

---	RIGHT-OF-WAY LINE	CL BARREL	CENTER OF MANHOLE BARREL
---	STREET CENTERLINE	SWR-Y	SHOT TAKEN ON TOP OF PIPE AT SEWER Y
---	SEWER LINE	SWR-LATERAL	SHOT TAKEN ON TOP OF PIPE AT SEWER LATERAL
x	POINT LOCATION	PIPE-TOP	SHOT TAKEN ON TOP OF PIPE
23118	POINT NUMBER		
21	LOT NUMBER		

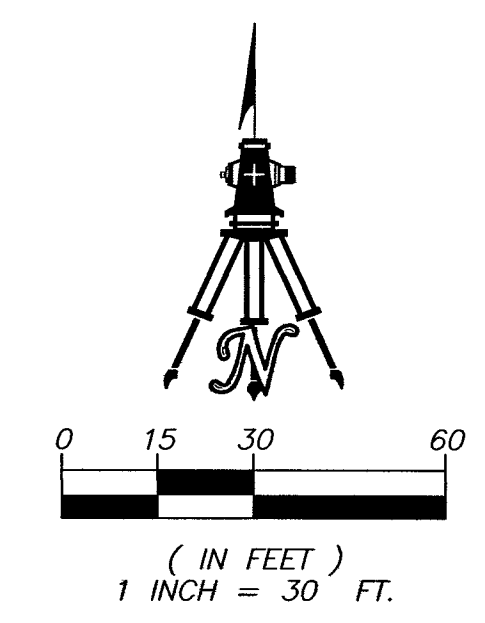

SHEET 2 OF 2

H# L20-01211
CLV DWG# 107Y5130-2

**SANITARY SEWER FINAL LOCATION MAP
CRYSTAL CANYON 2
A COMMON INTEREST COMMUNITY**

BEING A SUBDIVISION OF LOT A OF THAT CERTAIN FINAL MAP ENTITLED "CRYSTAL CANYON - SUMMERLIN VILLAGE 21 PARCELS A&B - UNIT 1" ON FILE IN BOOK 162, PAGE 77 OF PLATS, OFFICIAL RECORDS, CLARK COUNTY, NEVADA, LYING WITHIN THE WEST HALF (W1/2) OF SECTION 26, TOWNSHIP 20 SOUTH, RANGE 59 EAST, M.D.M., CITY OF LAS VEGAS, CLARK COUNTY, NEVADA

WALLACE · MORRIS · KLINE
SURVEYING, LLC.
LAND SURVEY CONSULTING
5740 SOUTH ARVILLE STREET, #206
LAS VEGAS, NEVADA 89118
PH:702.212.3967 FX:702.212.3963