

17664

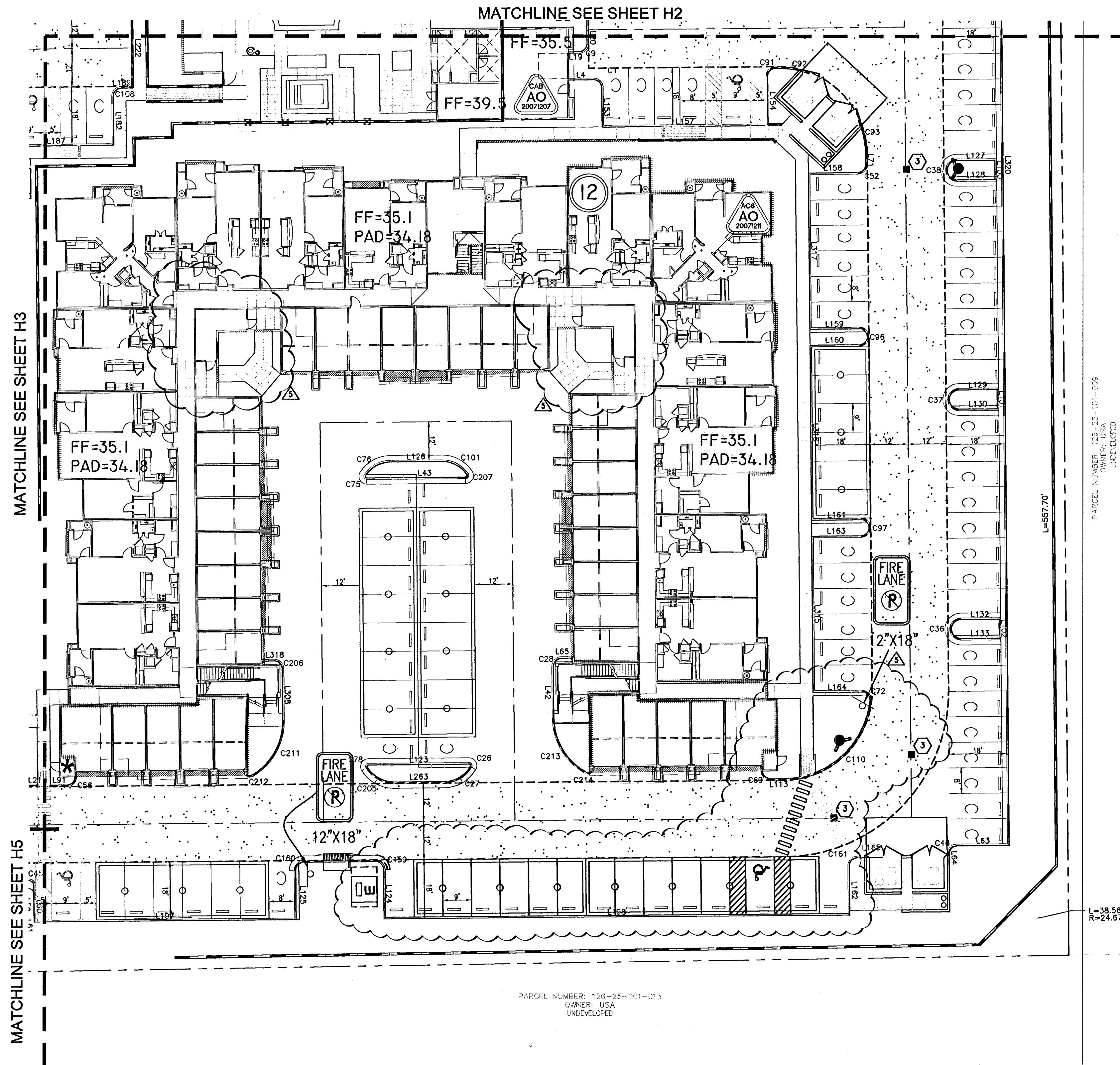

MATCHLINE SEE SHEET H2

MATCHLINE SEE SHEET H3

MATCHLINE SEE SHEET H5

PARCEL NUMBER: 126-25-201-013  
OWNER: USA  
UNDEVELOPED

PARCEL NUMBER: 126-25-101-009  
OWNER: USA  
UNDEVELOPED

**APPROVALS**

_____ SEE COVER CITY FIRE MARSHAL	_____ DATE
---	---------------

**DRAINAGE EASEMENT NOTE**

ALL AREAS AND COMMON LOTS NOT OCCUPIED BY BUILDINGS ARE PUBLIC DRAINAGE EASEMENTS TO BE PRIVATELY MAINTAINED.

**BASIS OF BEARINGS**

NORTH 00°37'29" WEST, BEING ALONG THE WEST LINE OF THE NORTHWEST QUARTER (NW ¼) OF THE NORTHWEST QUARTER (NW ¼) OF SECTION 25 TOWNSHIP 18 SOUTH RANGE 80 EAST M.D.M. AS SHOWN BY THAT CERTAIN MAP RECORDED IN FILE 104 AT PAGE 74 OF SURVEYS IN THE OFFICE OF THE COUNTY RECORDER, CLARK COUNTY, NEVADA.

**BENCHMARK**

CLV BENCHMARK: BLV90 30W4 NAVD 88v.2002 ELEVATION 834.8354 (METERS), 2738.30 (FEET).

RIVET AND PLATE IN CONCRETE PAD (ELEC) NE CORNER OF HUALAPAI & TROPICAL PARKWAY.

**NOTE:**

**STANTEC**  
ASSUMES NO RESPONSIBILITY FOR EXISTING UTILITY LOCATIONS, SHOWN OR NOT SHOWN. THE UTILITIES SHOWN ON THIS DRAWING HAVE BEEN PLOTTED FROM RECORD INFORMATION AND ARE FOR THE CONVENIENCE OF THE CONTRACTOR ONLY. THE CONTRACTOR IS RESPONSIBLE TO FIELD VERIFY THE LOCATIONS AND DEPTHS OF ALL RELEVANT UTILITIES PRIOR TO COMMENCING WITH CONSTRUCTION. THE CONTRACTOR IS RESPONSIBLE TO NOTIFY THE ENGINEER OF WORK, IN WRITING, OF ANY CONFLICTS OR DISCREPANCIES.

**NOTE TO CONTRACTOR:**

- THE TYPE OF STRIPING PROPOSED BY THIS PROJECT NEED TO MATCH THE EXISTING STRIPING ON THE NORTH SIDE OF THE STREET PER HTE# 05-28871 & CLV# 107Y4816-C.
- THESE PLANS SHALL NOT, IN PART OR IN WHOLE, TO BE USED FOR CONSTRUCTION UNTIL APPROVED AND SIGNED BY THE GOVERNING AGENCY. ENGINEER TO BE NOTIFIED OF ANY DISCREPANCIES IMMEDIATELY.
- EXISTING UTILITY LOCATIONS SHOWN HEREON ARE APPROXIMATE ONLY. IT SHALL BE THE CONTRACTOR'S RESPONSIBILITY TO DETERMINE THE EXACT VERTICAL AND HORIZONTAL LOCATION OF ALL EXISTING UNDERGROUND UTILITIES PRIOR TO COMMENCING CONSTRUCTION. NO REPRESENTATION IS MADE THAT ALL EXISTING UTILITIES ARE SHOWN HEREON. THE ENGINEER ASSUMES NO RESPONSIBILITY FOR UTILITIES NOT SHOWN OR UTILITIES NOT SHOWN IN THEIR PROPER LOCATION. CALL BEFORE YOU DIG: 1-800-227-2600.

**CONSTRUCTION NOTES**

- INSTALL R1-1 STOP SIGN (30") PER MUTCD SEC 2B.04 AND TABLE 2B-1
- INSTALL (2) 9" D-3 STREET NAME SIGNS PER MUTCD SEC 2D-39
- INSTALL BLUE REFLECTIVE MARKER @ CL
- INSTALL TYPE IIIA BARRICADE L=25 FT PER USD #601
- INSTALL SIGN AS INDICATED
- PROVIDE 4' CLEAR FIRE ACCESS WITH KNOX LOCKS
- INSTALL TYPE 2 CENTERLINE DELINEATION PER USD #244
- INSTALL 8" WHITE PAINTED TRANSITION SECTION PER USD #245
- INSTALL 8" WHITE PAINTED TRANSITION SECTION PER USD #245
- INSTALL 4" WHITE PAINTED EDGELINE
- INSTALL 2" WIDE STOP BAR USING WHITE COLD POLYMER FILM PER USD #254.1
- INSTALL 36" R1-1 "STOP" SIGN AND (2) 12" D3 STREET NAME
- INSTALL 2" CONDUIT
- INSTALL END OF PAVEMENT SIGN W8-3
- SITE VISIBILITY ZONE SEE DETAILS ON SHEET H8
- SITE VISIBILITY ZONE SEE DETAILS ON SHEET H8

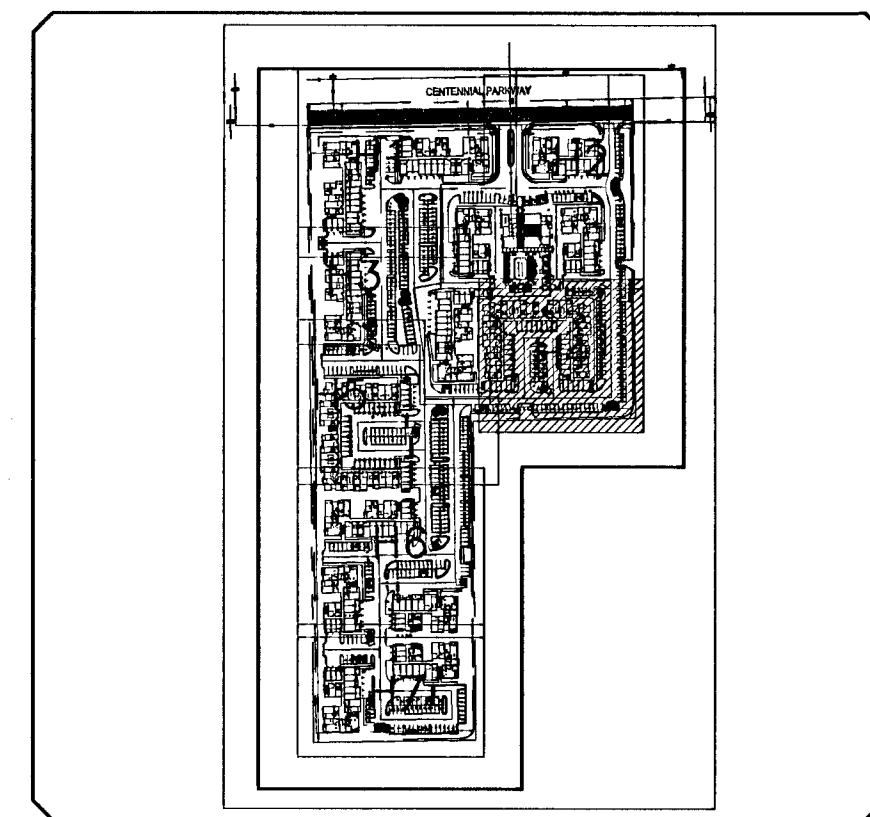

**KEY MAP**  
NOT TO SCALE

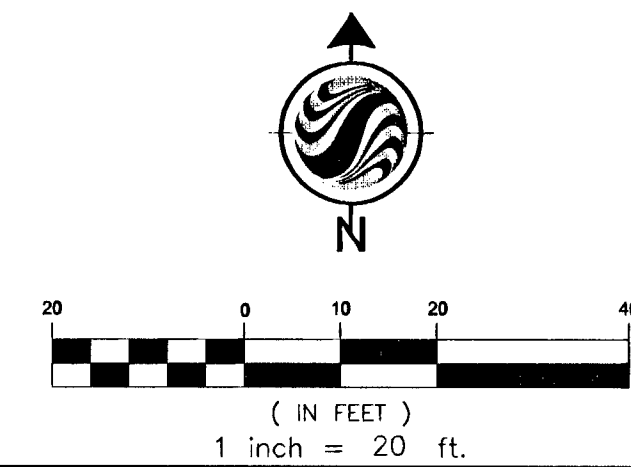

**LEGEND**

- CROSS WALK
- FIRE LANE
- NO PARKING
- VAN ACCESSIBLE HANDICAP PARKING
- FIRE ACCESS ROUTE
- HANDICAP PARKING
- TANDEM PARKING
- COMPACT PARKING
- RISER ROOM LOCATION
- FIRE DEPT. CONNECTION
- INSTALL NEVADA POWER RS-35 OR EQUAL
- 
- 
- SPEED LIMIT 35
- INSTALL RIGHT TURN ONLY ARROW PER R3-SR, AND "RIGHT LANE" SIGN PER R3-SF.
- INSTALL SIGN PER OM-3

**CALL BEFORE YOU DO UNDERGROUND-AVOID HITTING UNDERGROUND TRAFFIC SIGNAL SYSTEMS AND STREET LIGHT SYSTEM CONDUITS-IT'S COSTLY**

**Call before you Dig**  
1-702-432-5300  
FREEMWAY ARTERIAL SYSTEM TRANSPORTATION F.A.S.T.

**Call before you Dig**  
1-800-227-2600  
AND  
CLARK COUNTY TRAFFIC OPERATIONS  
1-702-455-7544

**Call before you Dig**  
1-702-227-2929

Stantec Consulting Inc.  
7251 West Chemon Boulevard  
Las Vegas, NV  
Tel: 702.258.0115  
Fax: 702.256.4956  
www.stantec.com

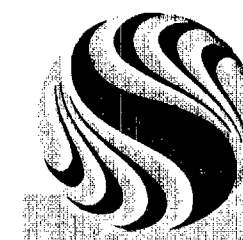

**Stantec**  
The Contractor shall verify and be responsible for all dimensions. DO NOT make the drawing any larger or smaller than the original. All dimensions are in feet unless otherwise noted. Stantec Consulting Inc. is not responsible for any errors or omissions. Reproduction or use for any purpose other than that authorized by Stantec is forbidden.

Revised Layout to Add New Power Transformer	By	JZ	Date	6/23/09
Revision	By		Date	

Client/Project: FAIRFIELD CENTENNIAL, LLC  
Permit/Seal: CENTENNIAL CONDOMINIUMS  
CITY OF LAS VEGAS, NV  
Title: HORIZONTAL CONTROL, STREET LIGHTING, AND SIGNAGE PLAN

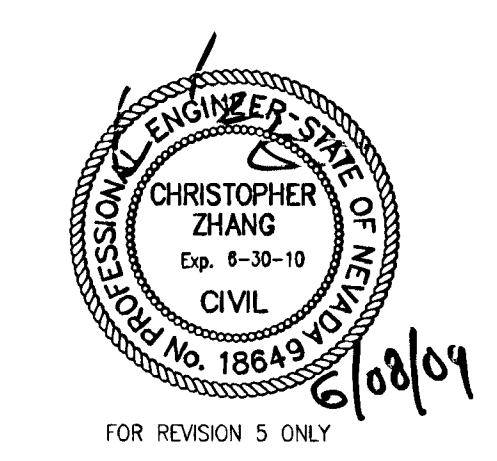

Project Number: 188100435  
File Name: 00435c-101horz.dwg  
Date: 6/2/2009  
Drawing No. H4  
CLV# 107Y4967  
Revision Sheet