

- WATER CONSTRUCTION NOTES:**
- ALL WATER CONSTRUCTION TO BE DONE IN ACCORDANCE WITH "UNIFORM DESIGN AND CONSTRUCTION STANDARDS FOR WATER DISTRIBUTION SYSTEMS (U.D.A.C.S.)" LATEST EDITION.
  - NOT ALL NOTES USED ON THIS SHEET -
- INSTALL 45° BEND W/THRUST BLOCK (SAME SIZE AS PIPE) PER U.D.A.C.S. PLATE No. 5.
  - INSTALL 90° BEND W/THRUST BLOCK (SAME SIZE AS PIPE) PER U.D.A.C.S. PLATE No. 5.
  - INSTALL TEE (SAME SIZE AS PIPES).
  - INSTALL MECHANICAL JOINT TAPPING SLEEVE & TAPPING VALVE (SAME SIZE AS PIPE) PER U.D.A.C.S. PLATE No. 22.
  - INSTALL GATE VALVE (SAME SIZE AS PIPE).
  - INSTALL CAP (SAME SIZE AS PIPE).
  - INSTALL BLOW-OFF ASSEMBLY (SAME SIZE AS PIPE) PER U.D.A.C.S. PLATE No. 4.
  - STUB & CAP WATER SERVICE. REFER TO PLUMBING PLANS FOR CONTINUATION.
  - INSTALL FIRE HYDRANT W/GATE VALVE PER U.D.A.C.S. PLATE No. 7.

**SANITARY SEWER MANHOLE SCHEDULE**

SSMH#	RIM	INV IN	INV OUT
SSMH#1	96.22	88.25	(85.50)
SSMH#2	100.68	94.27	94.07
SSMH#3	100.66	N/A	94.81
SSMH#4	99.66	94.90	94.70
SSMH#5	100.88	96.08	95.85
SSMH#6	101.63	96.98	96.76
SSMH#7	101.40	98.03	95.83
SSMH#8	102.06	97.38	97.18
SSMH#9	101.20	96.71	96.51
SSMH#10	101.50	98.13	97.93

**EXISTING FIRE FLOW CALCULATIONS**

BASED ON:

	EXISTING SCHOOL	EXISTING GYM
SQUARE FOOTAGE:	105,000 SQ. FT.	14,570 SQ. FT.
LARGEST AREA BETWEEN 4 HR. AREA SEPARATION WALL:	-	-
BUILDING HEIGHT:	45.00'	35.00'
NUMBER OF STORIES:	2	2
TYPE OF CONSTRUCTION:	II-A	II-FR
EXPOSURES:	-	-
SPRINKLER SYSTEM:	YES	YES
OCCUPANCY:	E	E
ROOF CONSTRUCTION:	SINGLE PLY	SINGLE PLY
FLOW REQUIRED @ 20 PSI RESIDUAL:	2,375	1,500
MAX. STORAGE HEIGHT:	-	-

EX. STATIC WATER PRESSURE IS 55.0± psi IN STREET.

**SEWER CONTRIBUTION:**

AVERAGE DAILY FLOW ..... 0.00376 MGD  
 PEAK HOURLY FLOW ..... 58.0 GPH

**SAFETY ALERT**  
 Before You Overhead Call Before You Dig  
 1-702-455-7511  
 C.C. TRAFFIC OPERATIONS

**BASIS OF BEARINGS**  
 SOUTH 89°52'09" EAST BEING THE NORTH LINE OF THE NORTHEAST QUARTER (NE 1/4) OF SECTION 29, TOWNSHIP 20 SOUTH, RANGE 61 EAST, W.D.M., CLARK COUNTY, NEVADA AS SHOWN BY MAP THEREOF ON FILE IN BOOK 48, PAGE 77 OF PLATS IN THE CLARK COUNTY RECORDERS OFFICE, CLARK COUNTY, NEVADA.  
**BENCHMARK**  
 CITY OF LAS VEGAS NO: 0LVO129NNWS  
 RIVET & PLATE IN TOP OF CURB @ SE CORNER OF VEGAS DR. & TUMBLEWEED.  
 ELEV.= 842.5245 (METRIC)  
 2108.02 (U.S. SURVEY FEET) "NAVD 88"

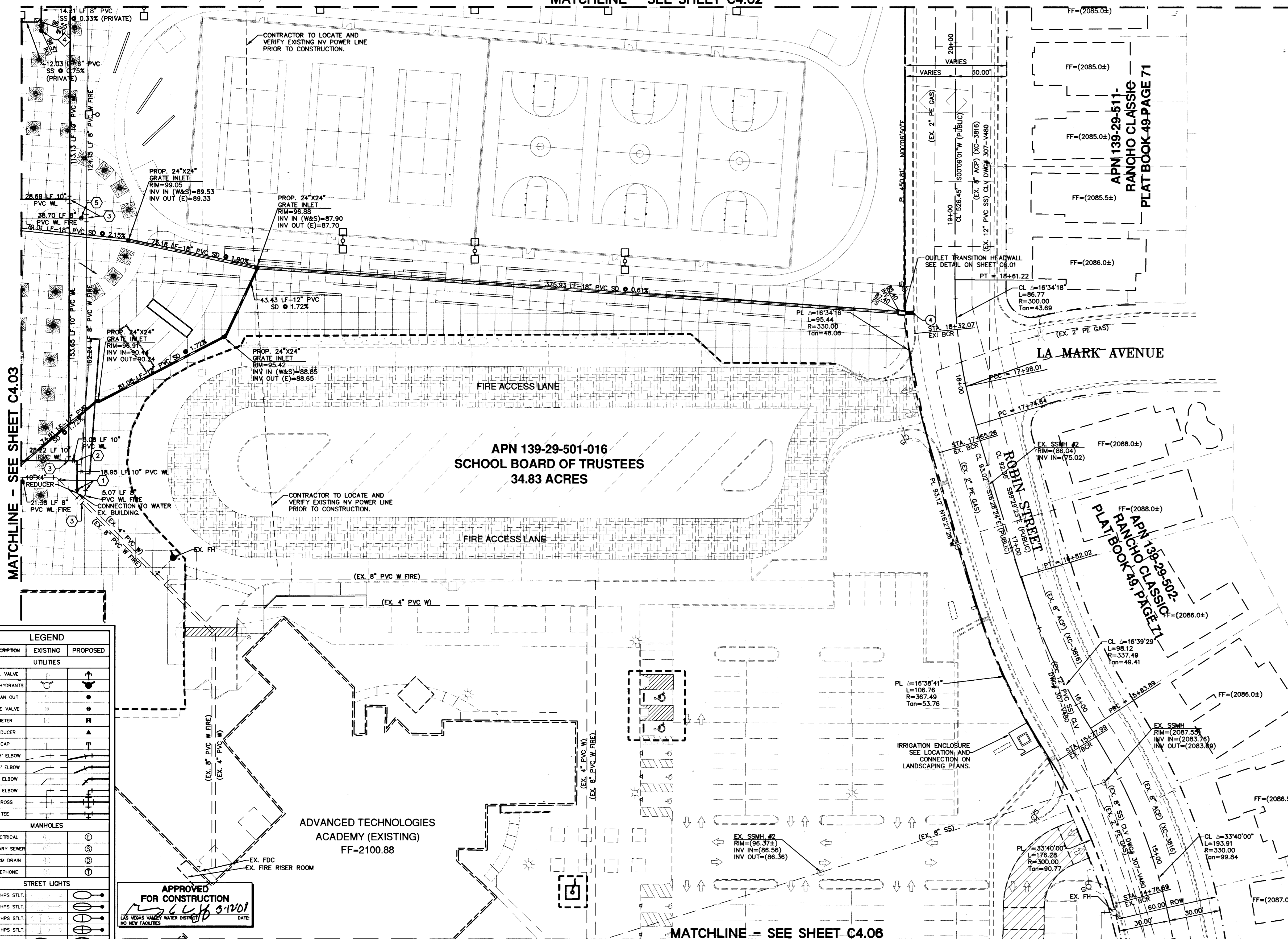

**LEGEND**

DESCRIPTION	EXISTING	PROPOSED
<b>UTILITIES</b>		
B.O. VALVE		↑
FIRE HYDRANTS		●
CLEAN OUT		○
GATE VALVE		⊙
METER		⊕
REDUCER		▲
CAP		⊖
11.25" ELBOW		⌒
22.5" ELBOW		⌒
45" ELBOW		⌒
90" ELBOW		⌒
CROSS		⊕
TEE		⊕
<b>MANHOLES</b>		
ELECTRICAL		⊕
SANITARY SEWER		⊕
STORM DRAIN		⊕
TELEPHONE		⊕
<b>STREET LIGHTS</b>		
100W HPS STLT.		⊕
150W HPS STLT.		⊕
200W HPS STLT.		⊕
250W HPS STLT.		⊕
400W HPS STLT.		⊕
<b>GRADING</b>		
SPOT ELEV.	(12.34)	12.34
SLOPE	(1.2%)	1.2%
5' CONT.	(2005)	(2005)
1' CONT.	(2007)	(2007)
<b>SITE</b>		
5/8" CURB		—
1" CURB		—
EDGE OF PAVT.		—
WALL		—
<b>LINE TYPES</b>		
CL OF SECTION LINE		—
PROPERTY LINE		—
RIGHT OF WAY LINE		—
ASEMENT LINE		—
SAWTOOTH LINE		—
FLOW LINE		—
<b>SHADES</b>		
HEAVY AC PAVEMENT		—
LIGHT AC PAVEMENT		—

**APPROVED FOR CONSTRUCTION**  
 DATE: 3/12/01  
 LAS VEGAS VALLEY WATER DISTRICT

**SEWER CONSTRUCTION NOTES: STORM DRAIN**

- NOT ALL NOTES USED ON THIS SHEET -
- INSTALL 48" SANITARY SEWER MANHOLE PER C.C.A.U.S.D. No. 403 WITH CONCRETE COLLAR PER C.C.A.U.S.D. No. 408. REFER TO C.C.A.U.S.D. No. 409 FOR MANHOLE COVER AND RING.
- STUB SANITARY SEWER SERVICE. REFER TO PLUMBING PLANS FOR CONTINUATION.
- INSTALL SEWER CLEAN-OUT PER DETAIL 19 ON SHEET C6.01.
- PROPOSED GREASE INTERCEPTOR LOCATION. REFER TO PLUMBING PLANS FOR SPECIFICATIONS.
- PROPOSED ACID WASH TANKS. REFER TO PLUMBING PLANS FOR SPECIFICATIONS.
- INSTALL 60" SANITARY SEWER MANHOLE PER C.C.A.U.S.D. No. 403 WITH CONCRETE COLLAR PER C.C.A.U.S.D. No. 408. REFER TO C.C.A.U.S.D. No. 409 FOR MANHOLE COVER AND RING. INSTALL T-LOCK.

**TRAFFIC NOTES:**

- RELOCATE STREET LIGHT DOWN TO EXISTING FOUNDATION 24" MIN. CONNECT CONDUIT

**NOTE:**  
 CONTRACTOR TO INCLUDE COST OF UNDERGROUND UTILITY DETECTION COMPANY TO LOCATE AND MARK ALL EXISTING UTILITIES PRIOR TO ANY DEMOLITION OR EXCAVATION. ENGINEER TO BE PROVIDED WITH AS-BUILT SKETCH OF EXISTING UTILITIES, AND IS TO BE NOTIFIED IMMEDIATELY OF ANY POTENTIAL CONFLICTS WITH PROPOSED UTILITIES AND/OR FINISHED GRADES.

**NOTE:**  
 REMOVAL OF EXISTING ACTIVE UTILITIES TO BE PHASED AS DIRECTED BY OWNER.

**CITY OF LAS VEGAS FIRE DEPARTMENT APPROVAL**  
 BY: Robert Bell DATE: 3/14/09  
 APPROVAL OF THESE PLANS SHALL NOT BE CONSTRUED TO BE A PERMIT FOR, OR AN APPROVAL OF, ANY VIOLATION OF ANY OF THE PROVISIONS OF THE STATE OR COUNTY LAWS. FIRE FLOW 3,125 GPM AT 20 P.S.I. RESIDUAL.

**FIRE FLOW CALCULATIONS**

BASED ON:

	GLOBAL STUDIES	PUBLIC SERVICES/PE	ADMIN/RESOURCE	COMMONS	BUSINESS INFO/TECH
SQUARE FOOTAGE:	13,990 SQ. FT.	37,418 SQ. FT.	17,082 SQ. FT.	10,398 SQ. FT.	17,831 SQ. FT.
LARGEST AREA BETWEEN 4 HR. AREA SEPARATION WALL:	-	-	-	-	-
BUILDING HEIGHT:	37.00'	40.00'	37.00'	23.50'	37.00'
NUMBER OF STORIES:	1	2	2	1	2
TYPE OF CONSTRUCTION:	V-B	II-B	V-B	V-B	V-B
EXPOSURES:	-	-	-	-	-
SPRINKLER SYSTEM:	YES	YES	YES	YES	YES
OCCUPANCY:	E	E	E	E	E
ROOF CONSTRUCTION:	SINGLE PLY/CLASS A	SINGLE PLY/CLASS A	SINGLE PLY/CLASS A	SINGLE PLY/CLASS A	SINGLE PLY/CLASS A
FLOW REQUIRED @ 20 PSI RESIDUAL:	1,625	2,125	1,750	1,500	1,750
MAX. STORAGE HEIGHT:	16'	16'	16'	16'	16'

EX. STATIC WATER PRESSURE IS 55.0± psi IN STREET.

**CivilWorks Inc**  
 Engineering with "sensible" solutions tailored to your "specific" needs.  
 7625 Dean Martin Drive, Suite #101 • Las Vegas, NV 89139-5975  
 Office #: (702) 876-3474 • Fax #: (702) 876-1323

**CENTRAL CAREER & TECH SCHOOL**  
 © ROBIN ST. AND VEGAS DR.  
 OWNER/DEVELOPER: CLARK COUNTY SCHOOL DISTRICT  
 CONSTRUCTION MANAGEMENT DIVISION  
 4828 S. PEARL STREET  
 LAS VEGAS, NEVADA 89121  
 (702) 799-9695

**UTILITY & STREETLIGHT PLAN - PAGE 4**

DATE: 14/02/08  
 PROJECT NO.: 59800002.00  
 DESIGNER: BRANDON A. POTTS  
 CHECKER: RHP  
 REVISIONS:

PRINTS REQUIRE ENGINEER'S SEAL AND SIGN FOR PROOF OF VALIDITY

**BRANDON A. POTTS**  
 Exp: 12/31/09  
 CIVIL  
 STATE OF NEVADA  
 No. 13121

715-172