

APN 139-20-403-002
SIETE SUERTE L L C
RECORD DOCUMENT No. 20050614:04773

APN 139-20-801-012
MILLER HARVEY M FAMILY TRUST and
MILLER HARVEY M TRS
RECORD DOCUMENT No. 20060315:00933

APN 139-20-801-011
FREEDOM STORAGE VEGAS DRIVE LLC
RECORD DOCUMENT No. 20040701:03150

SEWER CONTRIBUTION:
AVERAGE DAILY FLOW 0.00376 MGD
PEAK HOURLY FLOW 58.0 GPM

APPROVED FOR CONSTRUCTION
LAS VEGAS VALLEY WATER DISTRICT
DATE: 3/12/08

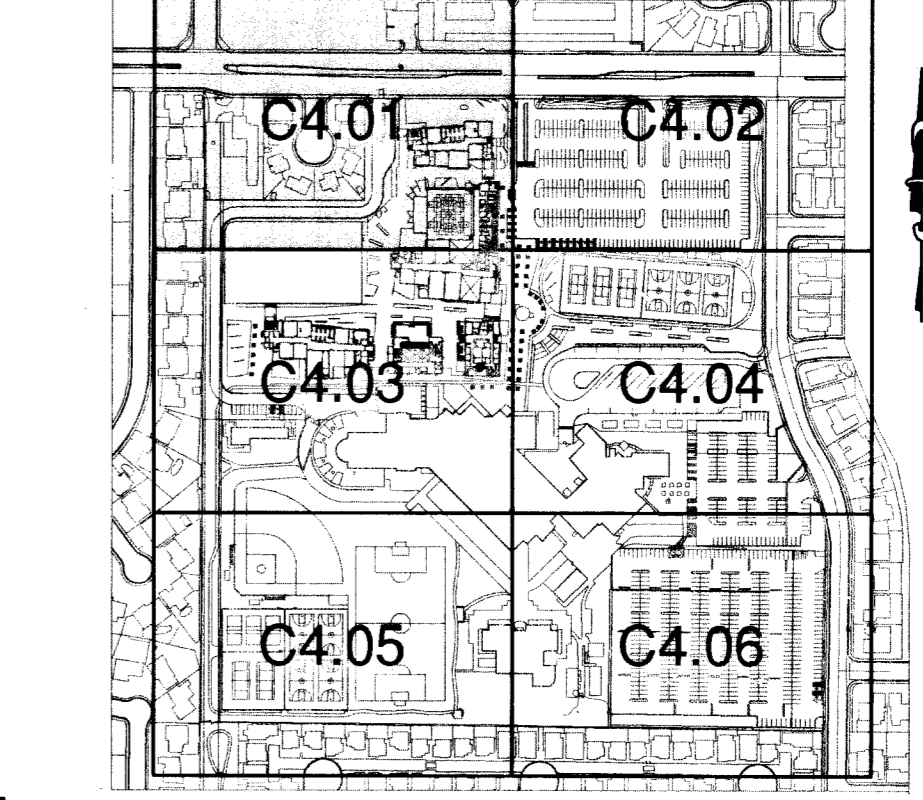
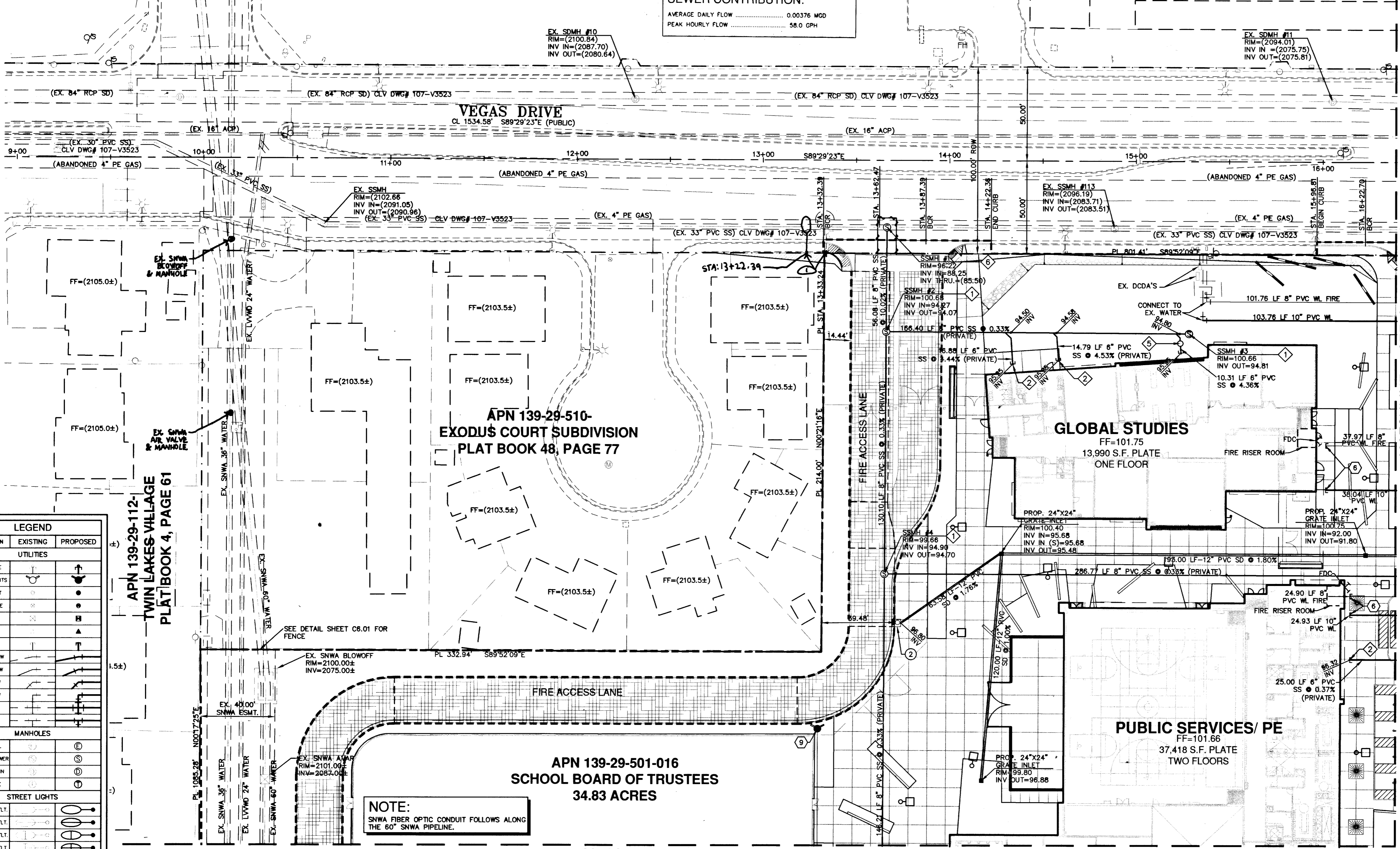
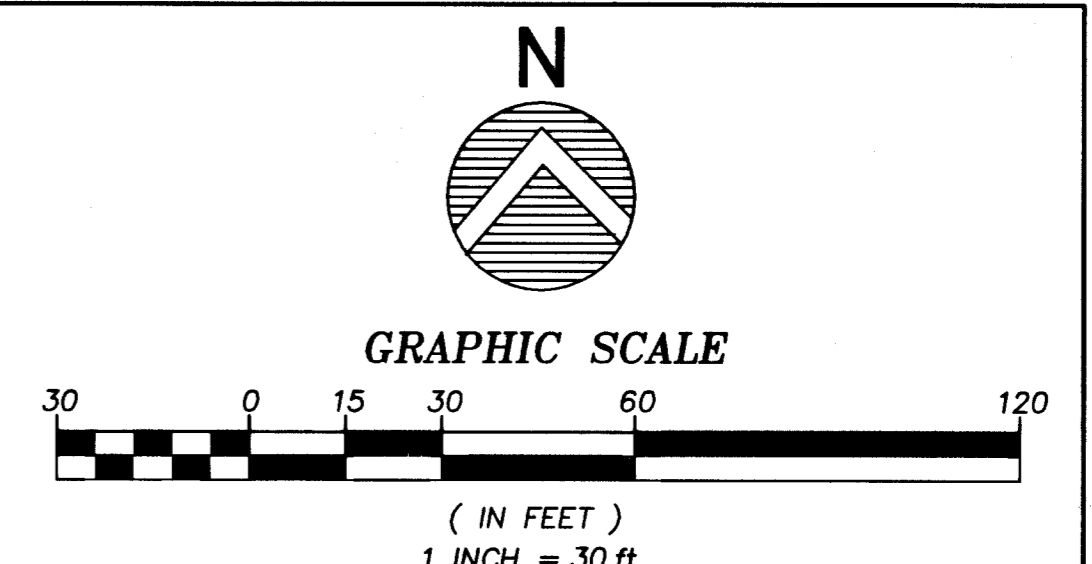

- WATER CONSTRUCTION NOTES:**
- ALL WATER CONSTRUCTION TO BE DONE IN ACCORDANCE WITH "UNIFORM DESIGN AND CONSTRUCTION STANDARDS FOR WATER DISTRIBUTION SYSTEMS (U.D.A.C.S.)" LATEST EDITION.
 - NOT ALL NOTES USED ON THIS SHEET -
 - INSTALL 45° BEND W/THRUST BLOCK (SAME SIZE AS PIPE) PER U.D.A.C.S. PLATE No. 5.
 - INSTALL 90° BEND W/THRUST BLOCK (SAME SIZE AS PIPE) PER U.D.A.C.S. PLATE No. 5.
 - INSTALL TEE (SAME SIZE AS PIPES).
 - INSTALL MECHANICAL JOINT TAPPING SLEEVE & TAPPING VALVE (SAME SIZE AS PIPE) PER U.D.A.C.S. PLATE No. 22.
 - INSTALL GATE VALVE (SAME SIZE AS PIPE).
 - INSTALL CAP (SAME SIZE AS PIPE).
 - INSTALL BLOW-OFF ASSEMBLY (SAME SIZE AS PIPE) PER U.D.A.C.S. PLATE No. 4.
 - STUB & CAP WATER SERVICE. REFER TO PLUMBING PLANS FOR CONTINUATION.
 - INSTALL FIRE HYDRANT W/GATE VALVE PER U.D.A.C.S. PLATE No. 7.

SANITARY SEWER MANHOLE SCHEDULE

SSMH#	RIM	INV IN	INV OUT
SSMH#1	96.22	88.25	(85.50)
SSMH#2	100.68	94.27	94.07
SSMH#3	100.68	N/A	94.81
SSMH#4	99.66	94.90	94.70
SSMH#5	100.88	96.06	95.85
SSMH#6	101.63	96.96	96.76
SSMH#7	101.40	96.03	95.83
SSMH#8	102.06	97.38	97.18
SSMH#9	101.20	96.71	96.51
SSMH#10	101.50	98.13	97.93

EXISTING FIRE FLOW CALCULATIONS

BASED ON:	EXISTING SCHOOL	EXISTING GYM
SQUARE FOOTAGE:	105,000 SQ. FT.	14,570 SQ. FT.
LARGEST AREA BETWEEN 4 HR. AREA SEPARATION WALL:	-	-
BUILDING HEIGHT:	45.00'	35.00'
NUMBER OF STORIES:	2	2
TYPE OF CONSTRUCTION:	II-A	II-FR
EXPOSURES:	-	-
SPRINKLER SYSTEM:	YES	YES
OCCUPANCY:	E	E
ROOF CONSTRUCTION:	SINGLE PLY	SINGLE PLY
FLOW REQUIRED @ 20 PSI RESIDUAL:	2,375	1,500
MAX. STORAGE HEIGHT:	-	-

EX. STATIC WATER PRESSURE IS 55.0± psi IN STREET.

LEGEND

DESCRIPTION	EXISTING	PROPOSED
UTILITIES		
B.O. VALVE		
FIRE HYDRANTS		
CLEAN OUT		
GATE VALVE		
METER		
REDUCER		
CAP		
11.25" ELBOW		
22.5" ELBOW		
45" ELBOW		
90" ELBOW		
CROSS		
TEE		
MANHOLES		
ELECTRICAL		
SANITARY SEWER		
STORM DRAIN		
TELEPHONE		
STREET LIGHTS		
100W HPS STL		
150W HPS STL		
200W HPS STL		
250W HPS STL		
400W HPS STL		
GRADING		
SPOT ELEV.	(12.34)	12.34
SLOPE	(1.2%)	1.2%
5' CONT.	(2005)	(2005)
1' CONT.	(2007)	(2007)
SITE		
"L" CURB		
"A" CURB		
EDGE OF PAVT.		
WALL		
LINE TYPES		
CL OR SECTION LINE		
PROPERTY LINE		
RIGHT OF WAY LINE		
EASEMENT LINE		
SAWTOOTH LINE		
FLOW LINE		
SHADES		
HEAVY AC PAVEMENT		
LIGHT AC PAVEMENT		

- SEWER CONSTRUCTION NOTES: STORM DRAIN**
- NOT ALL NOTES USED ON THIS SHEET -
 - INSTALL 48" SANITARY SEWER MANHOLE PER C.C.A.U.S.D. No. 403 WITH CONCRETE COLLAR PER C.C.A.U.S.D. No. 408. REFER TO C.C.A.U.S.D. No. 409 FOR MANHOLE COVER AND RING.
 - STUB SANITARY SEWER SERVICE. REFER TO PLUMBING PLANS FOR CONTINUATION.
 - INSTALL SEWER CLEAN-OUT PER DETAIL 19 ON SHEET C6.01.
 - PROPOSED GREASE INTERCEPTOR LOCATION. REFER TO PLUMBING PLANS FOR SPECIFICATIONS.
 - PROPOSED ACID WASH TANK. REFER TO PLUMBING PLANS FOR SPECIFICATIONS.
 - INSTALL 60" SANITARY SEWER MANHOLE PER C.C.A.U.S.D. No. 403 WITH CONCRETE COLLAR PER C.C.A.U.S.D. No. 408. REFER TO C.C.A.U.S.D. No. 409 FOR MANHOLE COVER AND RING. INSTALL T-LOCK.
- TRAFFIC NOTES:**
- RELOCATE STREET LIGHT DOWN TO EXISTING FOUNDATION 24" MIN. CONNECT CONDUIT AND REPAIR WIRE.

CONSTRUCTION NOTES:

- NOT ALL NOTES USED ON THIS SHEET -
- INSTALL 12"x12" GRATE INLET THAT IS PEDESTRIAN SLOTTED FOR ADA STANDARDS. SEE JENSEN PRECAST DETAIL ON SHEET C6.01.
- 5' NEEHAN PRE-CAST DROP INLET.
- INSTALL 24"x24" GRATE INLET THAT IS PEDESTRIAN SLOTTED FOR ADA STANDARDS AND TRAFFIC RATED. SEE JENSEN PRECAST DETAIL ON SHEET C6.01.
- CONSTRUCT SIDEWALK UNDERDRAIN PER C.C.A.U.S.D. No. 236.

NOTE:
SNWA FIBER OPTIC CABLE FOLLOWS ALONG THE 60" SNWA PIPELINE.

FIRE FLOW CALCULATIONS

BASED ON:	GLOBAL STUDIES	PUBLIC SERVICES/PE	ADMIN/RESOURCE	COMMONS	BUSINESS INFO/TECH
SQUARE FOOTAGE:	13,990 SQ. FT.	37,418 SQ. FT.	17,062 SQ. FT.	10,398 SQ. FT.	17,831 SQ. FT.
LARGEST AREA BETWEEN 4 HR. AREA SEPARATION WALL:	-	-	-	-	-
BUILDING HEIGHT:	37.00'	40.00'	37.00'	23.50'	37.00'
NUMBER OF STORIES:	1	2	2	1	2
TYPE OF CONSTRUCTION:	V-B	II-B	V-B	V-B	V-B
EXPOSURES:	-	-	-	-	-
SPRINKLER SYSTEM:	YES	YES	YES	YES	YES
OCCUPANCY:	E	E	E	E	E
ROOF CONSTRUCTION:	SINGLE PLY/CLASS A	SINGLE PLY/CLASS A	SINGLE PLY/CLASS A	SINGLE PLY/CLASS A	SINGLE PLY/CLASS A
FLOW REQUIRED @ 20 PSI RESIDUAL:	1,625	2,125	1,750	1,500	1,750
MAX. STORAGE HEIGHT:	16'	16'	16'	16'	16'

EX. STATIC WATER PRESSURE IS 55.0± psi IN STREET.

SNWA CONSTRUCTION NOTES:

CONTRACTOR SHALL FIELD LOCATE AND PROTECT ALL SNWA/SNWS APPURTENANCES INCLUDING, BUT NOT LIMITED TO AV/AR, ACCESS MAINWAYS AND CATHODIC PROTECTION SYSTEMS. ALL ABOVE GROUND STRUCTURES AND AT GRADE STRUCTURES MUST BE ADJUSTED TO NEW GRADE AT CONTRACTOR'S EXPENSE. CONTRACTOR TO NOTIFY SOUTHERN NEVADA WATER AUTHORITY DEVELOPMENT PLAN REVIEW AT (702) 862-3444 AT LEAST 48 HOURS PRIOR TO CONSTRUCTION ACTIVITY.

THIS DATA MAY BE BASED ON THE NATION GEODETIC VERTICAL DATUM OF 1929. IT IS THE ENGINEER'S RESPONSIBILITY TO ENSURE THAT THIS DATA IS COVERTED TO THE APPROPRIATE DATUM BEFORE USING SAID DATA.

NO BUILDINGS, STRUCTURES, FENCES OR TREES SHALL BE PLACED UPON, OVER OR UNDER THE SNWA EASEMENT EXCEPT THAT SAID PARCEL MAY BE IMPROVED AND USED FOR STREET, ROAD OR DRIVEWAY PURPOSES AND FOR OTHER UTILITIES. INsofar AS SUCH USE DOES NOT INTERFERE WITH ITS USE BY SNWA FOR THE PURPOSES FOR WHICH IT IS GRANTED.

SNWA APPROVAL
Valerie A. Schmitt 3/28/08
SOUTHERN NEVADA WATER AUTHORITY DATE

BASIS OF BEARINGS

SOUTH 89°52'09" EAST BEING THE NORTH LINE OF THE NORTHEAST QUARTER (NE 1/4) OF SECTION 29, TOWNSHIP 20 SOUTH, RANGE 61 EAST, M.D.M., CLARK COUNTY, NEVADA AS SHOWN BY MAP THEREOF ON FILE IN BOOK 48, PAGE 77 OF PLATS IN THE CLARK COUNTY RECORDERS OFFICE, CLARK COUNTY, NEVADA.

BENCHMARK
CITY OF LAS VEGAS NO: 0LV0129NNWS
RIVET & PLATE IN TOP OF CURB @ SE CORNER OF VEGAS DR. & TUNNELWEED.
ELEV. = 642.5245 (METRIC)
2108.02 (U.S. SURVEY FEET) "NAVD 88"

SAFETY ALERT
Call before you dig
1-702-455-7511
C.C. TRAFFIC OPERATIONS
1-702-229-6611

**CITY OF LAS VEGAS
FIRE DEPARTMENT APPROVAL**
BY: [Signature] DATE: 3/14/08
APPROVAL OF THESE PLANS SHALL NOT BE CONSTRUED TO BE A PERMIT FOR, OR AN APPROVAL OF, ANY VIOLATION OF ANY OF THE PROVISIONS OF THE STATE OR COUNTY LAWS. FIRE FLOW 3,125 GPM AT 20 P.S.I. RESIDUAL.

Givini & Associates Inc.
Engineering with "sensible" solutions tailored to your "specific" needs.
7625 Dean Martin Drive, Suite #101 • Las Vegas, NV 89139-5975
Office #: (702) 876-3474 • Fax #: (702) 876-1323

UTILITY & STREETLIGHT PLAN - PAGE 1

CENTRAL CAREER & TECH SCHOOL
© ROBIN ST. AND VEGAS DR.
OWNER/DEVELOPER: CLARK COUNTY SCHOOL DISTRICT
CONSTRUCTION MANAGEMENT DIVISION
4828 S. PEARL STREET
LAS VEGAS, NEVADA 89121
(702) 798-9695

BRANDON A. POTTS
Professional Engineer State of Nevada
No. 13121
3/14/08

C4.01
18 OF 32