

P:\Las Vegas\131973-Corran Rancho Vegas Sewer Rehab\Drawings\WV2-SHEETS\CIVIL\131973-C-1.dwg Sep 25, 2007 - 12:48pm

107733

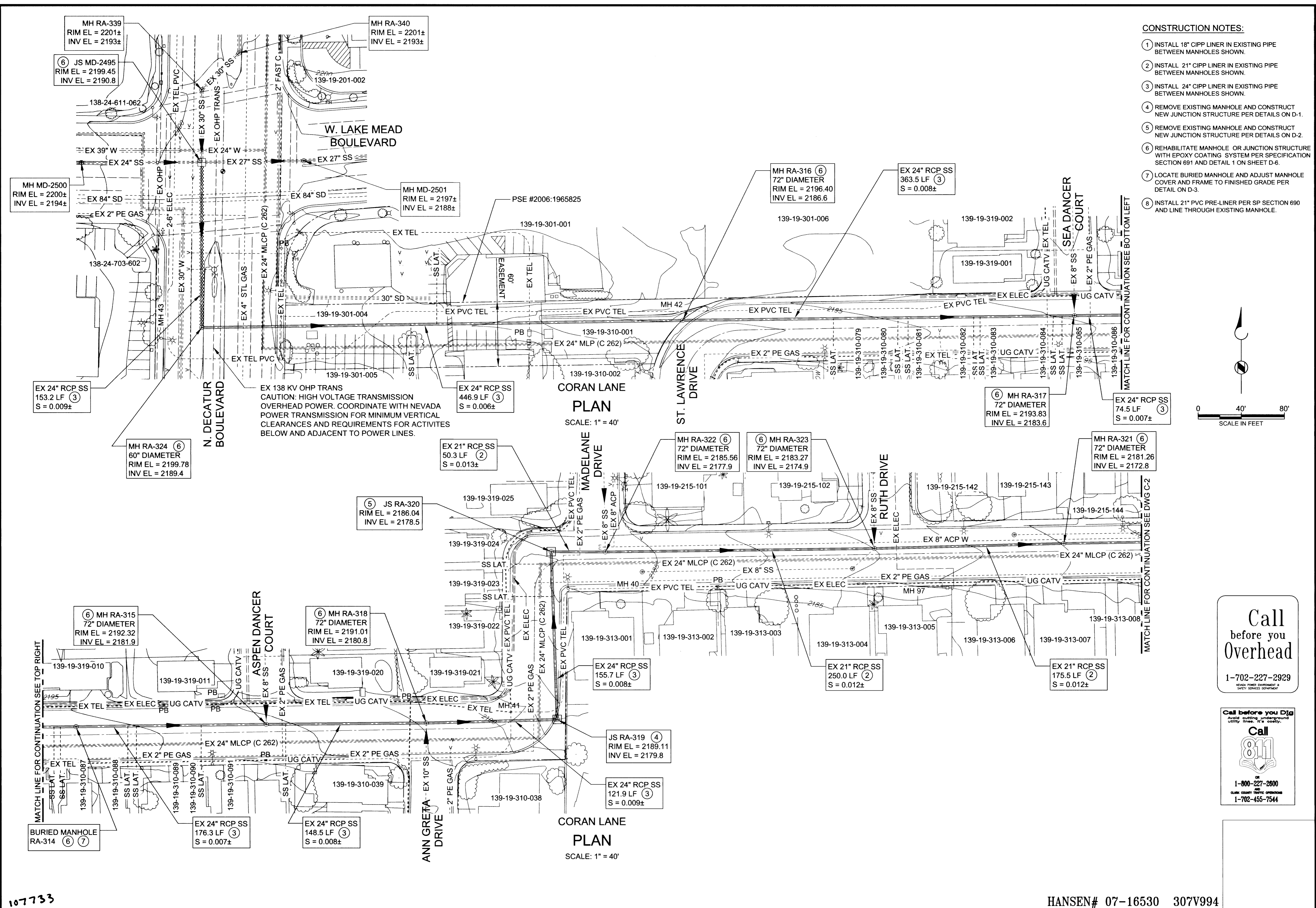

- CONSTRUCTION NOTES:**
1. INSTALL 18" CIPP LINER IN EXISTING PIPE BETWEEN MANHOLES SHOWN.
 2. INSTALL 21" CIPP LINER IN EXISTING PIPE BETWEEN MANHOLES SHOWN.
 3. INSTALL 24" CIPP LINER IN EXISTING PIPE BETWEEN MANHOLES SHOWN.
 4. REMOVE EXISTING MANHOLE AND CONSTRUCT NEW JUNCTION STRUCTURE PER DETAILS ON D-1.
 5. REMOVE EXISTING MANHOLE AND CONSTRUCT NEW JUNCTION STRUCTURE PER DETAILS ON D-2.
 6. REHABILITATE MANHOLE OR JUNCTION STRUCTURE WITH EPOXY COATING SYSTEM PER SPECIFICATION SECTION 691 AND DETAIL 1 ON SHEET D-6.
 7. LOCATE BURIED MANHOLE AND ADJUST MANHOLE COVER AND FRAME TO FINISHED GRADE PER DETAIL ON D-3.
 8. INSTALL 21" PVC PRE-LINER PER SP SECTION 690 AND LINE THROUGH EXISTING MANHOLE.

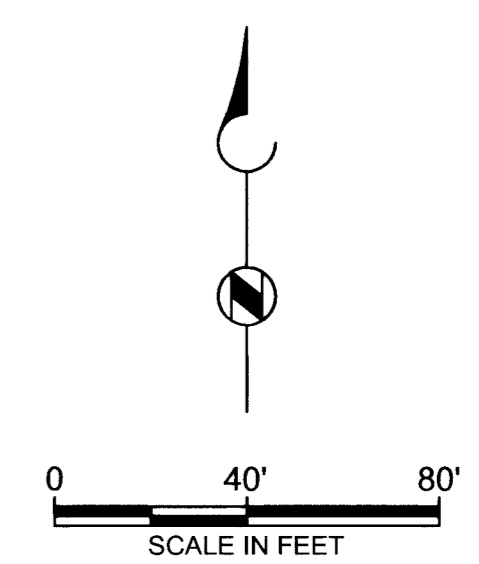

DATE	
REVISIONS	
LINE IS 2 INCHES AT FULL SIZE (IF NOT 2" - SCALE ACCORDINGLY)	
DESIGNED: O. FURLAN	
DRAWN: L. OLIVARES	
CHECKED: H. STEED	
PROJECT MANAGER	
APPROVED: BROWN AND CALDWELL	

BROWN AND CALDWELL
 SPRING MOUNTAIN ROAD, SUITE 225
 LAS VEGAS, NEVADA 89102
 (702) 938-4080

SUBMITTED: _____ DATE: _____
 APPROVED: _____ DATE: _____

CITY OF LAS VEGAS - DEPARTMENT OF PUBLIC WORKS
CORAN/ RANCHO/ VEGAS SEWER REHABILITATION
CORAN LANE PLAN VIEW
DECATUR BOULEVARD TO RUTH DRIVE

Call before you Overhead
 1-702-227-2929
WHILE THESE SERVICES ARE SAFETY SERVICES DEPARTMENT

Call before you Dig
 Avoid existing underground utility lines. It's costly.
Call 811
 or 1-800-227-2800
OR 702-251-0000
 1-702-455-7544

PROFESSIONAL ENGINEER - STATE OF NEVADA
O. FURLAN
 No. 12509
 CIVIL
 Exp. 9/30/08

DRAWING NO. **5**
 C-1 **39**

HANSEN# 07-16530 307V994