

MATCHMARK SHEET B

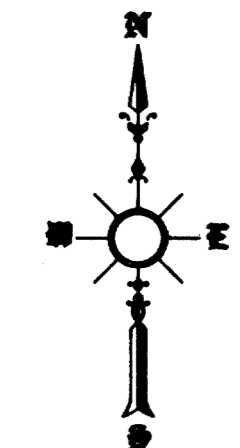

LEGEND

- PROP 6" CONCRETE PAVEMENT
- PROP 3" ASPHALT PAVEMENT W/ CONCRETE CURB & GUTTER
- PROP 2" ASPHALT PAVEMENT W/ CONCRETE CURB & GUTTER
- PAVEMENT TO BE REMOVED
- SAWED/CONSTRUCTION JOINT
- EXPANSION JOINT
- PROP. 4" SLEEVE FOR FUTURE IRRIGATION LINES

FIRE CONTROL LEGEND:

- DESIGNATED FIRE LANE PAVING
- PAINTED RED CURB (NO PARKING FIRE LANE).
- PAINTED WHITE BLOCK LETTERING -- "NO PARKING FIRE LANE" (NOT LESS THAN 4 INCHES IN HEIGHT WITH A STROKE OF NOT LESS THAN 3/4 INCH EVERY 50' TO FIT CURB).

CONSTRUCTION NOTES

- (NOT ALL KEY NOTES ARE USED ON THIS DRAWING)
- CONSTRUCT "L" TYPE CURB AND GUTTER PER C.C.A.U.S.D. #218.
 - CONSTRUCT COMMERCIAL/INDUSTRIAL DRIVEWAY PER C.C.A.U.S.D. #225 WITH GEOMETRICS OF #222A. CONSTRUCT 8" CROSS GUTTER PER C.C.A.U.S.D. #228.
 - CONSTRUCT CONCRETE SIDEWALK PER C.C.A.U.S.D. #234.
 - CONSTRUCT SIDEWALK RAMP CASE II PER C.C.A.U.S.D. #235.
 - CONSTRUCT 2" UNDER SIDEWALK DRAIN PER C.C.A.U.S.D. #236.
 - CONSTRUCT ON-SITE SIDEWALK RAMP PER DETAIL ON SHEET C2.1.
 - CONSTRUCT 6" ON-SITE SIDEWALK PER DETAIL ON SHEET C2.1. (SEE CIVIL PLAN SHEET C2.1 FOR FINISHES AND JOINT LAYOUT).
 - CONSTRUCT SIX INCH (6") CONCRETE PAVEMENT PER "CONCRETE PAVEMENT DETAIL" ON SHEET C2.1.
 - CONSTRUCT THREE INCH (3") ASPHALT PAVEMENT WITH CONCRETE CURB AND GUTTER PER ASPHALT PAVEMENT DETAIL ON SHEET C2.1.
 - CONSTRUCT TWO INCH (2") ASPHALT PAVEMENT WITH CONCRETE CURB AND GUTTER PER ASPHALT PAVEMENT DETAIL ON SHEET C2.1.
 - VOID
 - CONSTRUCT HELISTOP PAD PER DETAIL ON SHEET C2.1.
 - CONSTRUCT CONCRETE VALLEY GUTTER PER DETAIL ON SHEET C2.1.
 - PLANTING AREA REFER TO LANDSCAPE PLANS.
 - INSTALL PRECAST BUMPER BLOCK PER C.C.A.U.S.D. #238.
 - CONSTRUCT OUTFALL NO. 1 PER DETAIL ON SHEET C5.3.
 - CONSTRUCT OUTFALL NO. 2 PER DETAIL ON SHEET C5.3.
 - CONSTRUCT TYPE 1-A MANHOLE PER C.C.A.U.S.D. #404 ON SHEET C5.6.
 - CONSTRUCT TYPE ON DROP INLET PER DETAIL ON SHEET C5.6.
 - CONSTRUCT 15"x30" TYPE 3 DROP INLET PER N.D.O.T. DETAIL ON SHEET R-4.3.1.
 - CONSTRUCT ADS AREA DRAIN PER DETAIL ON SHEET C5.5.
 - CONSTRUCT CONCRETE FLUME PER DETAIL ON SHEET C5.5.
 - INSTALL ADS FLARED END SECTION PER DETAIL ON SHEET S.5.

FIRE FLOW CALCULATIONS

FIRE FLOW REQUIREMENT IS 300-300 GALLONS PER MINUTE AT 20 PSI RESIDUAL PRESSURE. BASED ON:

SQUARE FOOTAGE: 235,700

LARGEST AREA BETWEEN 4-HOUR AREA SEPARATION WALLS: N/A

BUILDING HEIGHT: 132'

NUMBER OF STORIES: 8 MAX

TYPE OF CONSTRUCTION: 1A REDUCE TO 1B PER IBC 403.3.1

OCCUPANCY: 1-2

FULL AUTOMATIC FIRE SPRINKLER SYSTEM: YES NO

REVIEWED BY: LAS VEGAS FIRE DEPARTMENT DATE: _____

CAUTION TO CONTRACTOR

THE CONTRACTOR SHALL BE RESPONSIBLE TO INVESTIGATE AND VERIFY THE ACTUAL LOCATION AND DEPTH OF ALL EXISTING UNDERGROUND FACILITIES AT LEAST 48 HOURS IN ADVANCE OF THE PERFORMANCE OF ANY WORK.

DESCRIPTION OF REVISIONS:
ADA PARKING WAS REVISED (2 WERE ADDED),
FIRE CONTROL ADDED, STRIPING ADDED,
CONSTRUCTION NOTES ADDED. M.O.B. ENTRY
REVISED FOR FIRE LANE.

DESCRIPTION OF REVISIONS:
M.O.B. PARKING LOT ADDED WITH
GRADING AROUND THE BUILDING AND
PARKING LOT REVISED AND STORM
DRAINAGE ADJUSTED. MOVED
SIDEWALK 10 FT NORTH.

BASIS OF BEARING

THE BASIS OF BEARING IS A LINE BETWEEN THE N1/4 COR. OF SEC. 20, T. 19 S., R. 60 E., M.D.M., AND THE E1/16 COR. OF SAID SEC. 20, AS SHOWN ON EXHIBIT B OF DOC. 20030131:03151, WHICH IS THE DEDICATION OF ELKHORN ROAD, WHICH BEARS S 89°42'15" E.

CLV BENCHMARK #BLV90-20M6
RIVET & PLATE IN CONCRETE CYLINDER NE CORNER OF EL CAPITAN & DORRELL
ELEVATION: 788.9015 METERS, 2588.25 FEET

REV:	DESCRIPTION:	DATE:	BY:
1	REVISED EAST DRIVE TO DEER SPRINGS WAY	9/21/07	RC

KEY PLAN

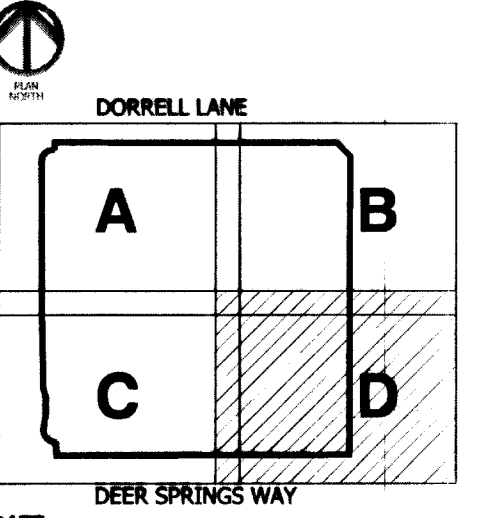

DATE: **20 Jun 05**

BID/PERMIT ISSUE: 20 JUN 05
CITY OF LAS VEGAS - CIVIL REVIEW: 15 SEPT. 05
FINAL SUBMITTAL: 21 OCT. 05
C.C. No: 73
28 JULY 07
P.C. No: 69
17 SEPT 07

PAVING AND STRIPING PLAN

SHEET NO. **C2.D**
SHEET NO. 11 OF 43

Call before you dig
1-800-227-2600

Call before you overhead
1-702-593-6111

Call before you UnderGround
1-702-455-7511
CLARK COUNTY TRAFFIC OPERATORS
1-702-229-6611

2412B-PAN.DWG