

**SEWER CONTRIBUTION**  
0.028 MGD AVERAGE DAILY FLOW

**NOTES**  
ALL SEWER/STORM DRAINS CROSSING WATER LINES MUST CONFORM TO SECTION 2.19 OF THE UNIFORM DESIGN AND

**PRIVATE STREET NOTE**  
ALL PRIVATE STREETS ARE P.U.E.'S, CLV

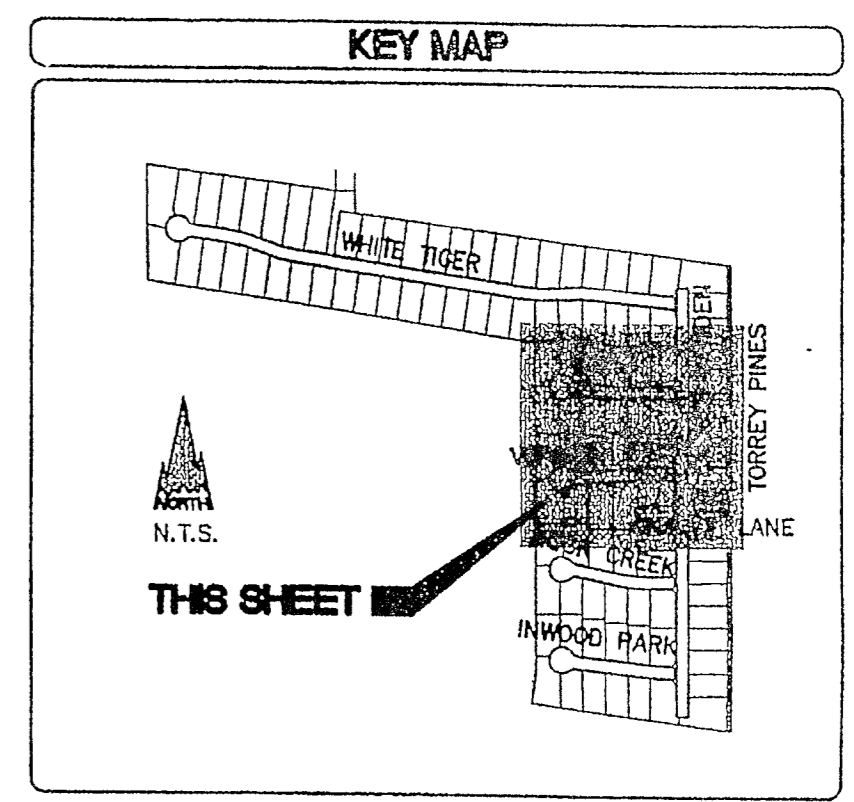

**UTILITY LEGEND**

BOUNDARY	10+00	PRESSURE REDUCING VALVE	PRV
CENTER LINE & STATION	---	FIRE HYDRANT	⊕
RIGHT-OF-WAY	---	2" BLOW-OFF	⊕
LOT LINE	---	GATE VALVE	⊕
WATER MAIN	---	WATER METER	⊕
WATER LATERAL	---	PIPE FITTINGS	⊕
EXISTING WATER MAIN	---	SEWER MANHOLE	⊕
EXISTING GAS MAIN	---	STORM DRAIN MANHOLE	⊕
SEWER MAIN	---	100W STREET LIGHT	⊕
SEWER LATERAL	---	150W STREET LIGHT	⊕
EXISTING SEWER MAIN	---	200W STREET LIGHT	⊕
STORM DRAIN MAIN	---	400W STREET LIGHT	⊕
STORM DRAIN LATERAL	---	PROP. SL CONDUIT	⊕
EXISTING STORM DRAIN	---	EXISTING STREETLIGHT	⊕
BACK OF CURB	---	EX. SL CONDUIT	⊕
FACE OF CURB	---	STREETLIGHT SERVICE POINT	⊕
LIP OF GUTTER	---	SIDEWALK	---
EDGE OF PAVEMENT	---	EXISTING CURB	---
		EDGE OF EXISTING PAVT	---

**WATER FITTING LEGEND**

① 8" x 8" TEE	⑤ INSTALL (2) 4" SCH. 40 IRRIGATION SLEEVES
② 8" GATE VALVE	⑩ 2 1/2" x 8" TAPPING SLEEVE W/ 8" TAPPING VALVE
③ 6" FIRE HYDRANT ASSY. PER UDACS STD. PLATE 7 (INCLUDE GATE VALVE, TEE & LATERAL)	⑪ 8" x 8" TAPPING SLEEVE W/ 8" TAPPING VALVE
④ 2" BLOW-OFF ASSY. W/CAP PER UDACS STD. PLATE 4A	⑫ 8" GATE VALVE
⑤ 6" - 1 1/2" BEND	⑬ 10" x 8" MJ TAPPING SLEEVE W/ 8" TAPPING VALVE
⑥ 8" x 6" REDUCER	⑭ 1" METER PER UDACS STD. PLATE NO. 1D
⑦ 3/4" METER-PER UDACS STD. PLATE NO. 1D	⑮ 8" - 5' BEND <i>RESTRICTIONED</i>
⑧ 1" METER-PER UDACS STD. PLATE NO. 1D (RR.) W/ 1" BPPA PER UDACS PLATE # 11A	⑯ 8" - 11' BEND
	⑰ 8" - 45' BEND
	⑱ 8" - 90' BEND

**BASIS OF BEARINGS**

THE EAST LINE OF THE SOUTHWEST QUARTER (SW 1/4) OF SECTION 35, TOWNSHIP 19 SOUTH, RANGE 60 EAST, M.D.M., CLARK COUNTY, NEVADA, AS SHOWN BY THAT RECORD OF SURVEY ON FILE IN FILE 40 OF SURVEYS, PAGE 74 IN THE CLARK COUNTY RECORDER'S OFFICE, CLARK COUNTY, NEVADA.

SAID LINE BEARS SOUTH 00°09'24" EAST.

**BENCHMARK**  
CLV BM 0LV 90 3554 BEING A RIVET & PLATE IN TOP OF CURB 60 FT NORTH OF LONE MOUNTAIN ON EAST CURB OF TORREY PINES.  
ELEVATION: 2301.17 FEET/701.3985 METERS (NAVD '88 DATUM)

**APPROVALS**

APPROVAL: [Signature] DATE: JUN 29 2006  
CITY OF LAS VEGAS FIRE DEPARTMENT  
APPROVED FOR CONSTRUCTION: [Signature] DATE: 07/26/06

TEJAS UNDERGROUND

DR. HORTON  
6845 ESCOBADO STREET BLDG #6, SUITE 105  
LAS VEGAS, NV 89119  
PHONE: (702) 435-4888 FAX: (702) 638-4700

LONE MOUNTAIN ENGINEERING  
6345 S. JONES BLVD., SUITE 200  
LAS VEGAS, NEVADA 89118  
PHONE: (702) 312-3774 FAX: (702) 312-3775

UTILITY/STREETLIGHT PLAN  
SHEET 02

BAVARIA ESTATES

DATE: [ ] DRAWN BY: [ ] DESIGNED BY: [ ] CHECKED BY: [ ] PROJECT NO: [ ] DWG NO: [ ] SHEET NO: [ ]