

LEGEND + ABBREVIATIONS

	DRAWING NUMBER FOR DETAIL WITH REFERENCE TO ITS SHEET	ABBREVIATIONS	W = WATER
	INDICATES SEWER MANHOLE IN PROFILE	S = SEWER	SD = STORM DRAIN
	INDICATES STORM DRAIN MANHOLE IN PROFILE	SL = STREET LIGHT	SMH = SEWER MANHOLE
	EXIST. ELEVATION	SMH = STORM DRAIN MH	CLV = CITY OF LAS VEGAS
	PROPOSED ELEVATION	LVVWD = LAS VEGAS VALLEY WATER DISTRICT	EX = EXISTING
	EXIST. SPOT ELEVATION	FL = FLOW LINE	HP = HIGH POINT
	SUBDIVISION BOUNDARY	R/W = RIGHT-OF-WAY	TC = TOP BACK OF CURB
	EASEMENT LINE	FG = FINISHED GRADE	BCR = BEGIN CURB RETURN
	FUTURE LINE	DS = DOWN SLOUT	USDOCA = UNIFORM STANDARD DRAWING CLARK COUNTY AREA
	STREET CENTERLINE	USDOCA = UNIFORM STANDARD DRAWING CLARK COUNTY AREA	CF = CURB FACE
	EDGE OF PAVEMENT		BW = BACK OF WALK
	EXISTING IMPROVEMENTS		FS = FINISH SURFACE
	EXISTING GROUND CONTOURS		NG = NATURAL GRADE
	FINISH GROUND CONTOUR LINE		FF = FINISH FLOOR
	DRAINAGE FLOW LINE		GB = GRADE BREAK
			FUT = FUTURE
			EP = EDGE OF PAVEMENT
			TC = TOP OF GRATE

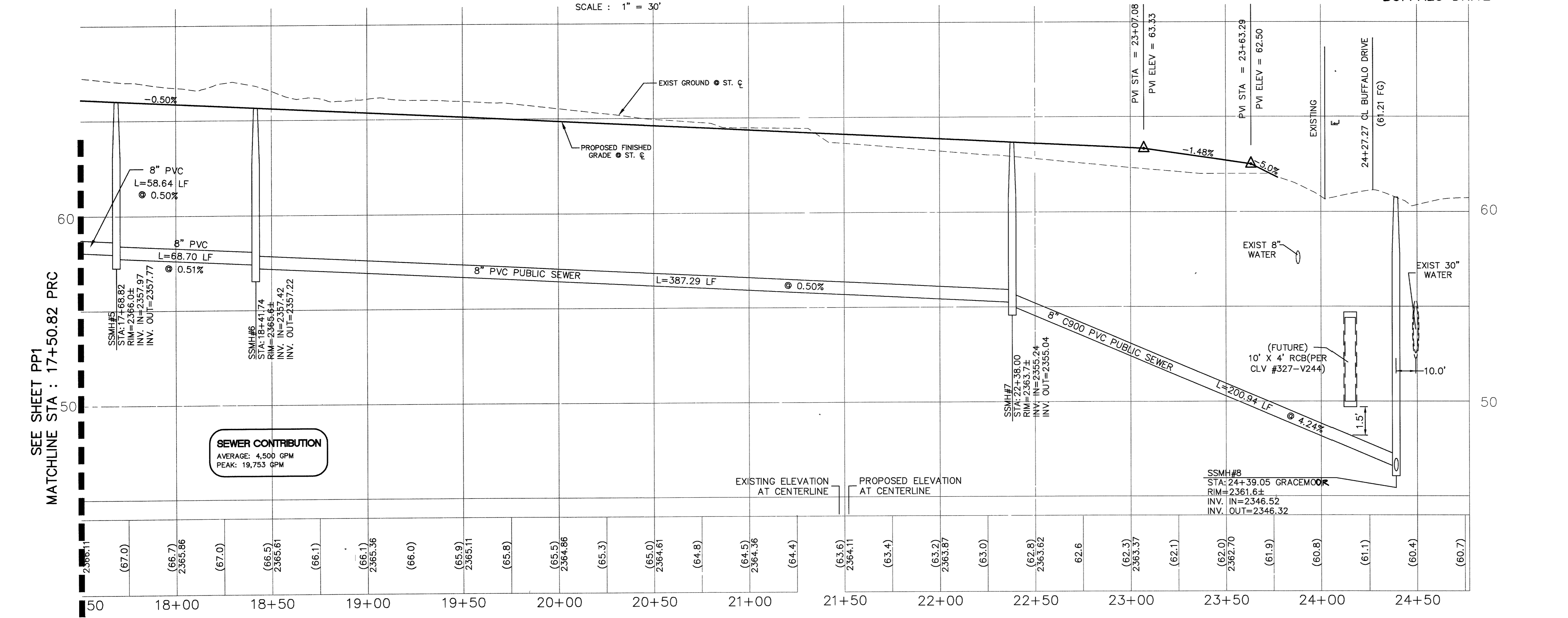

- CONSTRUCTION NOTES:**
- (A) CONSTRUCT 8' WIDE VALLEY GUTTER PER USD DWG NO 228
 - (B) CONSTRUCT 2-1/2" AC PAVEMENT OVER 10" AGGREGATE BASE PER TYPICAL SECTION. ACTUAL SECTION TO BE DETERMINED DURING CONSTRUCTION
 - (C) CONSTRUCT 4' WIDE VALLEY GUTTER PER K/D1
 - (D) 2' FEATHER TO MATCH EXISTING PAVEMENT
 - (E) CONSTRUCT 30" ROLL TYPE CURB AND GUTTER PER STD DWG 217A
 - (F) REMOVE EXIST AC OVER AB
 - (G) CONSTRUCT 5" AC PAVEMENT OVER 13" MIN TYPE II AGGREGATE BASE PER TYPICAL SECTION. ACTUAL SECTION TO BE DETERMINED DURING CONSTRUCTION

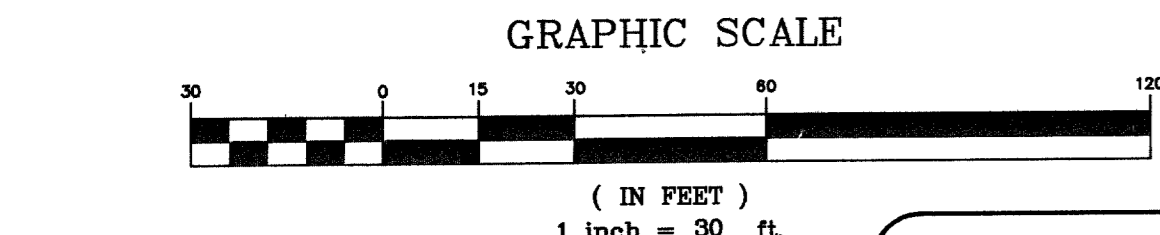
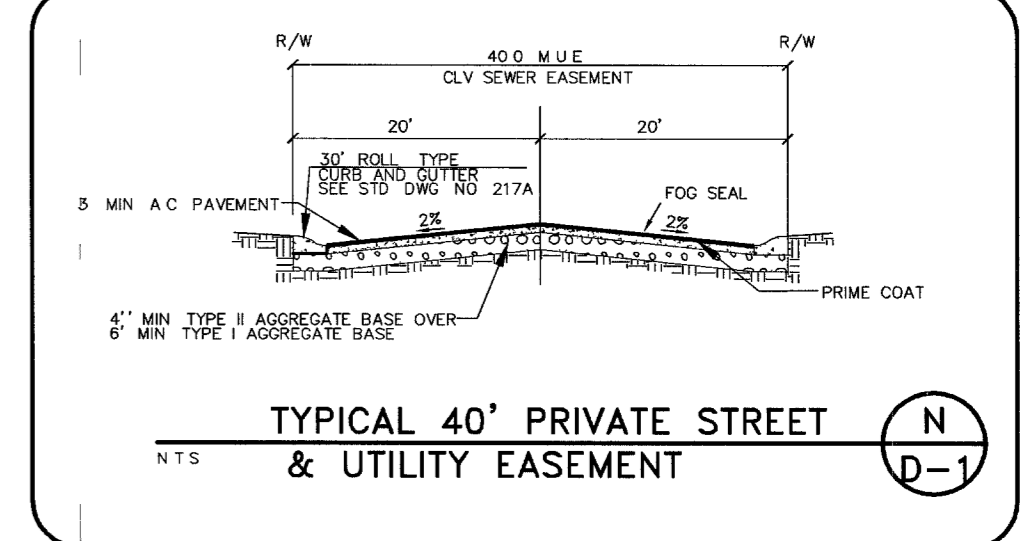

PROFILE: GRACEMOOR STREET PRIVATE
HOR. : 1" = 30'
VERT. : 1" = 3'

SEWER LINE TABLE

LINE	LENGTH	BEARING
L1	425.70	S88°38'02"E
L2	80.65	N65°55'08"W
L3	58.65	N24°35'56"W
L4	68.70	N51°26'37"W
L5	623.98	S88°38'02"E
L6	1548.09	S01°04'37"E
L7	53.96	S26°49'52"E
L8	176.22	N88°04'46"E

CENTERLINE & BACK OF CURB CURVE TABLE

CURVE	RADIUS	DELTA	LENGTH	TANGENT
(C3)	120.00'	67°58'32"	142.37'	80.90'
(C4)	80.00'	67°58'32"	94.91'	53.94'
(C14)	30.00'	30°00'00"	15.71'	8.04'
(E15)	30.00'	30°00'00"	15.71'	8.04'
(E17)	100.00'	67°58'32"	118.64'	67.42'

CENTERLINE & BACK OF CURB LINE TABLE

LINE	LENGTH	BEARING	LINE	LENGTH	BEARING
(L1)	493.83'	N88°37'37"W	(L11)	12.99'	S61°22'23"W
(L2)	61.00'	S01°22'23"W	(L12)	30.00'	N88°37'37"W
(L3)	437.61'	N88°37'37"W	(L13)	30.00'	N88°37'37"W
(L4)	437.63'	N88°37'37"W	(L15)	63.97'	N88°37'37"W
(L10)	12.96'	N58°37'37"W			

Call before you Dig
1-702-455-7511
1-702-229-6611
1-702-593-6111

NOTE:
SEE SHEET UT1 FOR SEWER MANHOLE SCHEDULE

Call before you Dig
1-800-227-2600
UNDERGROUND SERVICE (USA)

NOTE:
ADD 2300 FT. TO ALL PROPOSED ELEVATIONS

BASIS OF BEARINGS
NORTH 88°59'47" WEST ALONG THE NORTH LINE OF THE NORTHEAST QUARTER (NE 1/4) OF THE NORTHWEST QUARTER (NW 1/4) SECTION 33, TOWNSHIP 19 SOUTH, RANGE 60 EAST, M.D.M. AS SHOWN IN THE FINAL MAP OF "LAMPLIGHT GLEN AT BUFFALO AND WASHBURN" RECORDED IN BPPK 119, PAGE 48 RECORDS OF CLARK COUNTY, NEVADA.

BENCHMARK
CITY OF LAS VEGAS BENCHMARK NO. 5LV9034C4 BEING A RIVET AND PLATE IN THE TOP OF CURB AT THE EAST SIDE OF TENAYA AND WASHBURN, ID #413
ELEVATION= 714.1246 METERS OR 2342.92 FEET.
NAVD 88

R L HOME, LLC
CONOUGH ESTATES - IMPROVEMENT PLANS
GRACEMOOR STREET (PRIVATE)
STA. 17+50.82 TO STA. 24+50.00
DRAWING PP2
CLV DWG# 307U997
9 OF 10 SHEETS