

Call before you **OVERHEAD** 1-702-593-0111  
 Call before you **Dig** 1-800-227-2000

**LAS VEGAS FIRE DEPARTMENT**  
 FIRE FLOW REQUIREMENT IS 1,800 GALLONS/MIN. AT 20 PSI RESIDUAL.

BASED ON:  
 SQUARE FOOTAGE < 3800  
 LARGEST AREA BETWEEN SEPARATION WALLS: N/A  
 HEIGHT: 2 STORY  
 TYPE OF CONSTRUCTION:  
 EXPOSURE: 10' MIN.  
 SPRINKLER SYSTEM: YES  
 OCCUPANCY: SINGLE FAMILY RESIDENCE  
 ROOF CONSTRUCTION: CONCRETE TILE

**LINE TABLE - WATERLINES**

8" (PUBLIC) PVC WATERLINE LENGTHS	28.35 LF
6" (PUBLIC) PVC WATERLINE LENGTHS	20.09 LF
4" (PUBLIC) PVC WATERLINE LENGTHS	20.09 LF
3" (PUBLIC) PVC WATERLINE LENGTHS	27.00 LF

**PROJECT BENCHMARK**  
 PROJECT DATUM: NORTH AMERICAN VERTICAL DATUM OF 1988 (NAVD88)  
 CITY OF LAS VEGAS BENCHMARK: 0C901788  
 ELEVATION: 799.057 METERS (2,621.67 FEET)  
 RIVET AND SQUARE ALUMINUM PLATE IN TOP CENTER OF HEADWALL ON THE WEST SIDE OF U.S.-95 NEAR MILE MARKER 90.15.

**NOTE**  
 ALL STREETS ARE PRIVATE DRIVES UNLESS OTHERWISE NOTED.  
 ALL PRIVATE STREETS AND DRIVES ARE P.U.E., PUBLIC SEWER EASEMENTS, AND PUBLIC DRAINAGE EASEMENTS TO BE PRIVATELY MAINTAINED BY HOA.

**NOTE**  
 CONTRACTOR SHALL VERIFY HORIZONTAL AND VERTICAL ALIGNMENT OF EXISTING UTILITIES AND TO NOTIFY THE DESIGN ENGINEER IMMEDIATELY OF ANY DISCREPANCIES PRIOR TO CONSTRUCTION.

**SEWER CONTRIBUTION**  
 AVERAGE FLOW \_\_\_\_\_ 0.01925 MG/D  
 PEAK FLOW \_\_\_\_\_ 0.067376 MG/D

**BASIS OF BEARING**  
 SOUTH 89°10'24" EAST - BEING THE SOUTH LINE OF THE NORTHWEST QUARTER (NW 1/4) OF THE NORTHEAST QUARTER (NE 1/4) OF SECTION 18, TOWNSHIP 19 SOUTH, RANGE 80 EAST, M.D.M., CLARK COUNTY, NEVADA AS SHOWN BY THAT RECORD OF SURVEY ON FILE IN THE OFFICE OF THE COUNTY RECORDER, CLARK COUNTY, NEVADA, IN FILE 114 OF SURVEYS, AT PAGE 57.

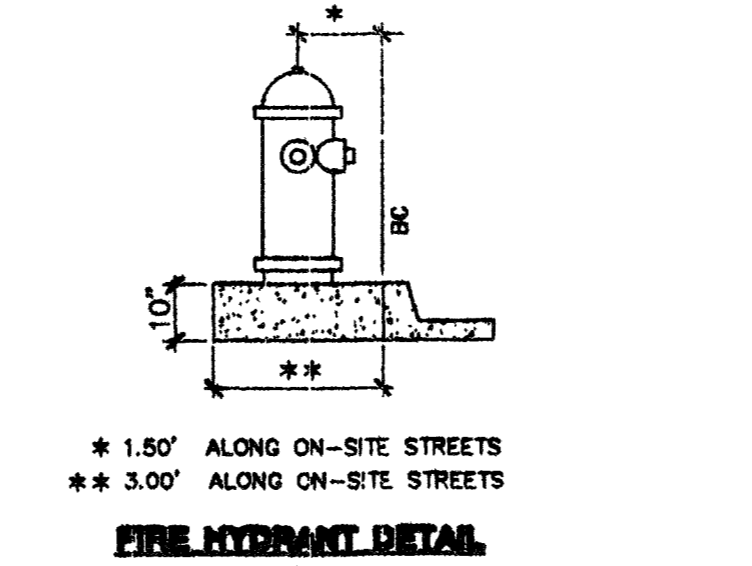
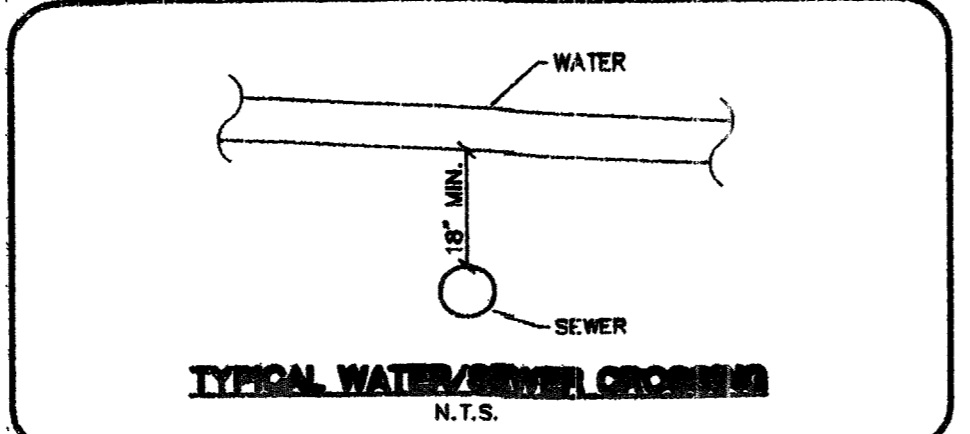

**FIRE HYDRANT INSTALLATION**  
 FIRE HYDRANT(S) TO BE INSTALLED IN ACCORDANCE WITH THE UDACS STANDARD PLATE NO. 7

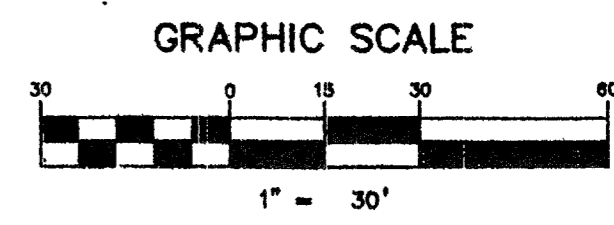
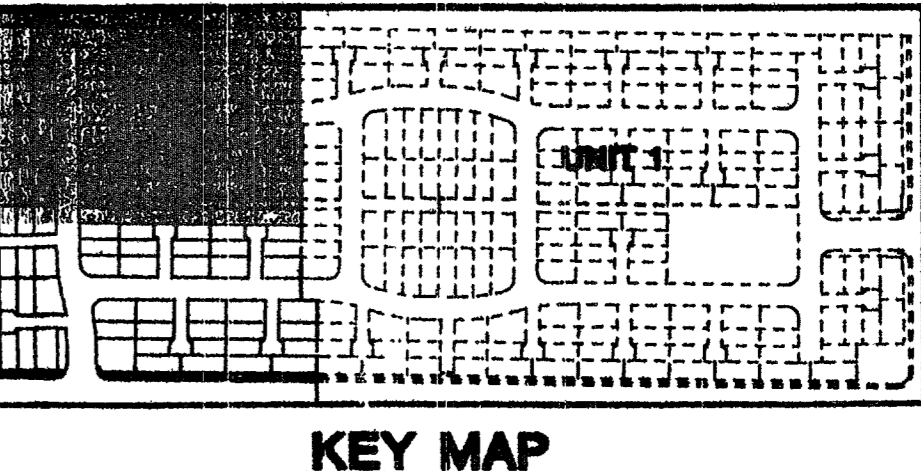
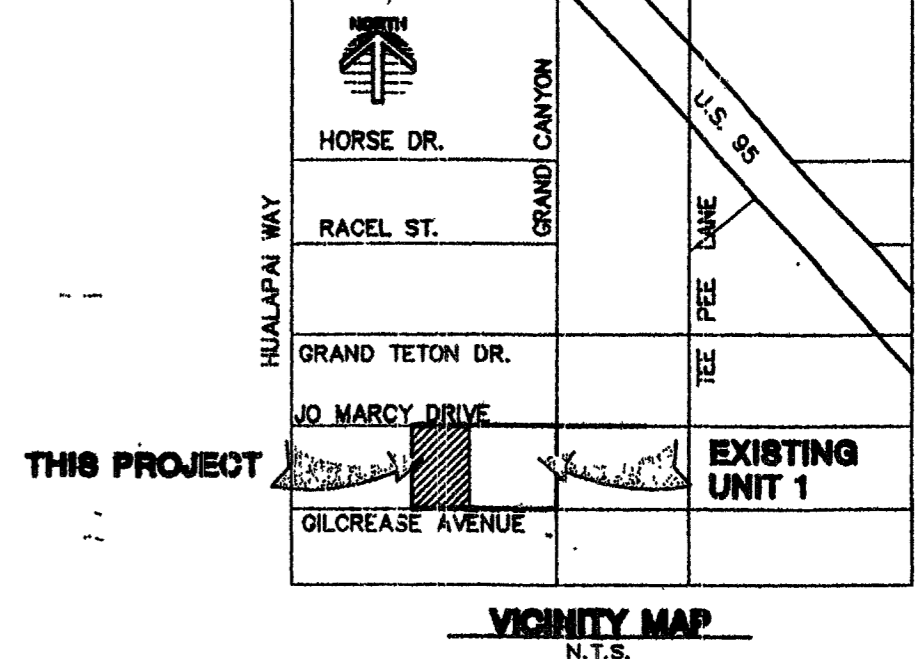
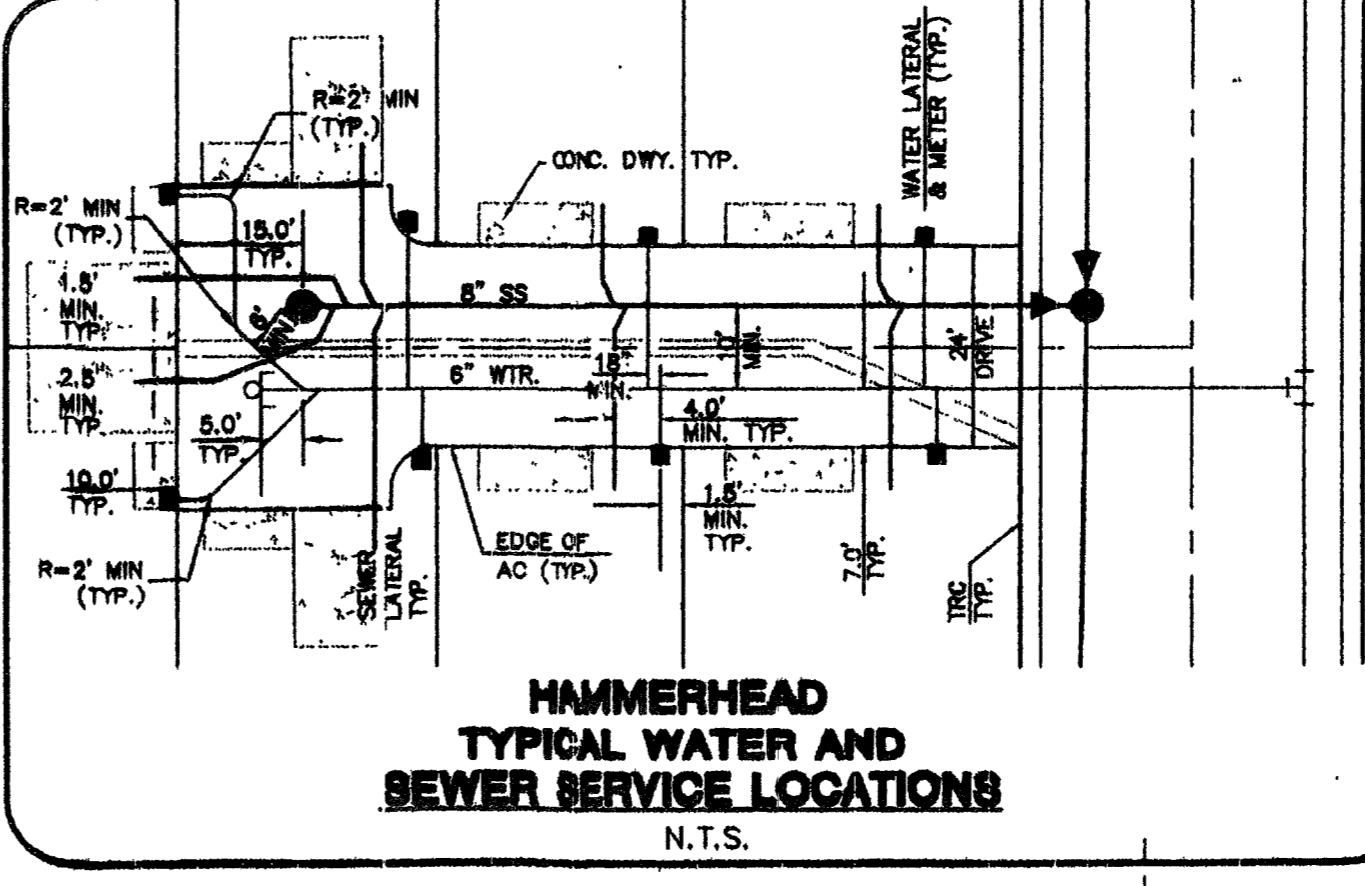

**NOTE**  
 FOR LOTS 81-86 BLOCK A, 89-100, 105-120 BLOCK B, & 283-284 BLOCK E  
 INSTALL ADJUST METER BOXES PART # A8000485 (METER BOX) PART # A8000484R (COVER)

**FUTURE BEAZER AT GRAND TETON VILLAGE BY BEAZER HOMES**  
 APNI 125-18-101-004

**REDUCED PRESSURE PRINCIPLE ASSEMBLY (R.P.A.)**  
 APPROVED REDUCED PRESSURE PRINCIPLE ASSEMBLY(S) SHALL BE INSTALLED PER THE UDACS PLATE NO. 11A. NO WATER SHALL BE TAKEN FROM A SERVICE REQUIRING BACKFLOW PREVENTION UNTIL THE REDUCED PRESSURE PRINCIPLE ASSEMBLY HAS BEEN SUCCESSFULLY TESTED BY THE LVWD.

**"AS BUILTS"**  
 DOW INDUSTRIES

Date: 2-14-02 By: R. Leigh Wenger  
 C-900 Water Pipe By: Diamond  
 SDR-35 Sewer Pipe By: Diamond  
 All Manhole Components By: Man Pro Corp  
 All Valves By: Mueller Model# A-403  
 Fire Hydrant By: Mueller Model# A-403

**LEGEND / ESTIMATE OF QUANTITIES**

**WATER (PUBLIC)**

- 1 STD. FIRE HYDRANT (INCLUDES PIPES, VALVE, TEE, & RISER) PER UDACS PL #7 3 EA
- 2 8" TEE 1 EA
- 3 8" x 6" REDUCER 1 EA
- 4 CAP & 2" BLOW-OFF PER UDACS PL #4A 12 EA
- 5 6" GATE VALVE 2 EA
- 6 6" 45° ELBOW 4 EA
- 7 REMOVE EXISTING CAP AND CONNECT TO EXISTING 6" PVC WL PER UDACS PL #4A
- 8 REMOVE EXISTING CAP AND CONNECT TO EXISTING 6" PVC WL PER UDACS PL #4A
- 9 8" x 6" CROSS 2 EA
- 10 6" TEE 1 EA
- 11 8" x 6" TEE 1 EA
- 12 8" 11.25" BEND 1 EA
- 13 8" 90° BEND 1 EA
- 14 1" COPPER WATER SERVICE W/ 5/8" METER PER UDACS PL #1E 1B 14 EA
- 15 1" COPPER WATER SERVICE W/ 3/4" MVR 30 METER PER UDACS PLATE 1B 96 EA
- 16 8" PVC WATER LINE (PUBLIC) 698 LF
- 17 6" PVC WATER LINE (PUBLIC) 1402 LF
- 18 6/8" METER WITH 1" RPPA PER UDACS PL #1D & 11A 1 EA

**SEWER**

- 1 STD. MANHOLE (PUBLIC) 29 EA
- 2 8" SEWER MAIN (PUBLIC) 3259 LF
- 3 4" SERVICE LATERALS (PRIVATE) 1690 LF
- 4 BACKWATER VALVE (PRIVATE) 2 EA

\* UNITS TO BE FIRE PROTECTED BY FIRE SPRINKLER SYSTEM

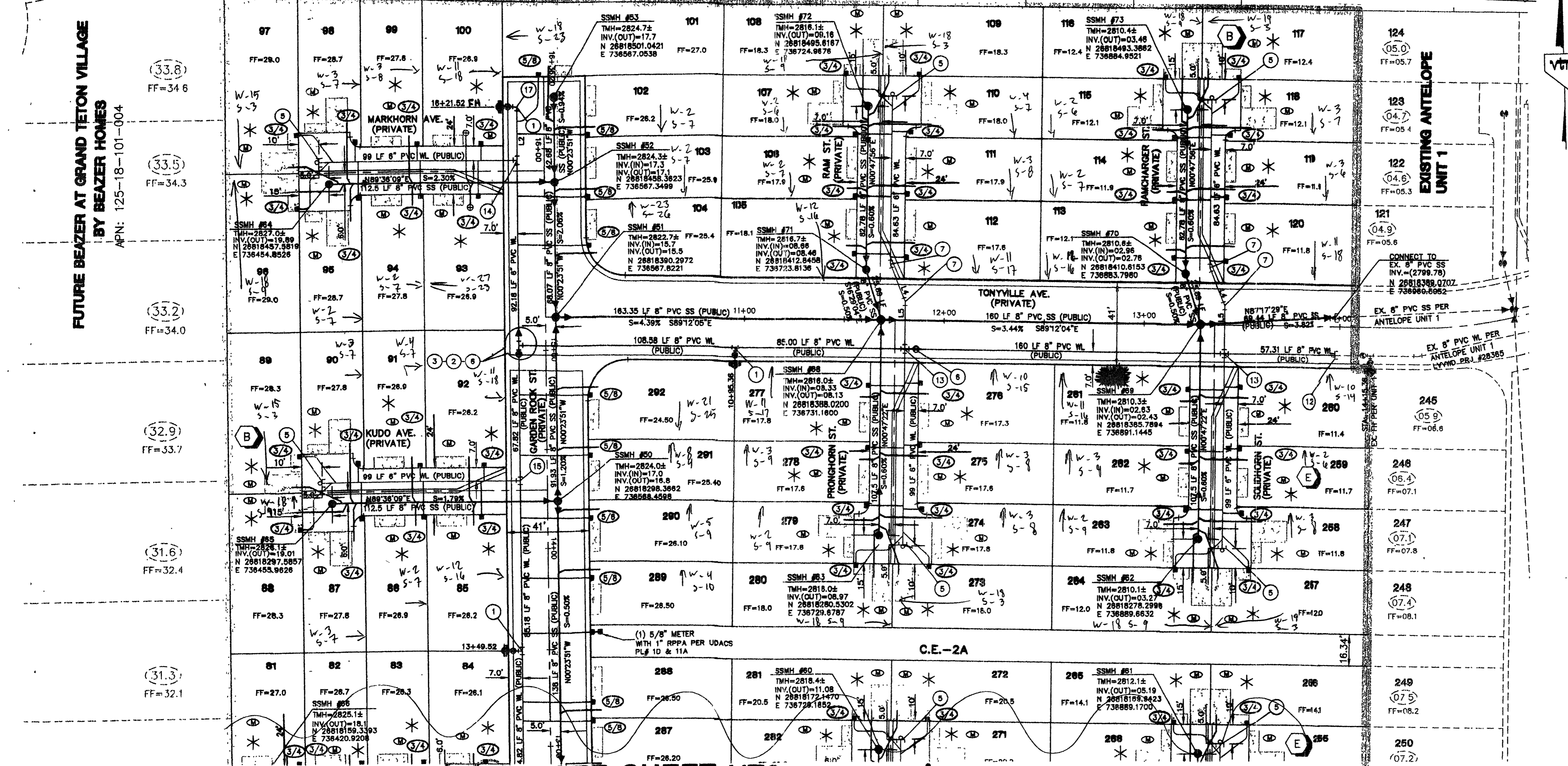

**NOTE**  
 ALL SEWER/STORM DRAIN CROSSING WATER LINES MUST CONFORM TO SECTION 2.19 OF THE UNIFORM DESIGN AND CONSTRUCTION STANDARDS FOR POTABLE WATER SYSTEMS (UDACS) FOR WATER AND STORM MAIN CROSSING AND CLEARANCES.

**SEE SHEET UT2**

**NOTE**  
 INSTALL PIPELINE MARKER BALLS IN TRENCH ABOVE EACH HORIZONTAL ELBOW FITTING, PER UDACS PLATE NO. 27.

**WATER MAIN JOINT DEFLECTION (PVC, 4" - 24")**  
 PVC PIPE SHALL BE DEFLECTED AT THE JOINT ONLY. THE MAXIMUM ALLOWABLE DEFLECTION SHALL BE ONE (1) DEGREE PER JOINT WITH A MINIMUM RADIUS OF CURVATURE OF 1,150 FEET, PER UDACS 2.06.01 AND 2.06.02. FOR CHANGES IN DIRECTION EXCEEDING THE MAXIMUM ALLOWABLE JOINT DEFLECTION, FITTINGS SHALL BE USED.

**APPROVALS**  
 City of Las Vegas Fire Marshal: [Signature] 1/29/04  
 Las Vegas Valley Water District: [Signature] 3/1/04

**GREYSTONE HOMES**  
 CITY OF LAS VEGAS, NEVADA  
 2727 SOUTH RAINBOW BOULEVARD LAS VEGAS, NEVADA 89146-5148  
 PH: (702) 875-7550 FAX: (702) 382-2987  
 3765 E. SUNSET #1 LAS VEGAS, NEVADA 89120  
 (702) 468-7700

**UTILITY PLAN RECEIVED**  
 AUG. 2003  
 DESIGNED BY: [Signature]  
 CHECKED BY: [Signature]  
 PROJECT NO: 588-2

**ANTELOPE UNIT 2**  
 MAR 08 2004  
 DOW INDUSTRIES

**PROFESSIONAL ENGINEER STATE OF NEVADA**  
 AARON M. [Signature]  
 LICENSE NO. 16079

**SHEET UT1**  
 6 OF 26 SHEETS  
 DRAWING NO. 10714781-2