

PEAK DRIVE STORM DRAIN 2 - PLAN

HORIZONTAL: 1"=5'
VERTICAL: 1"=5'

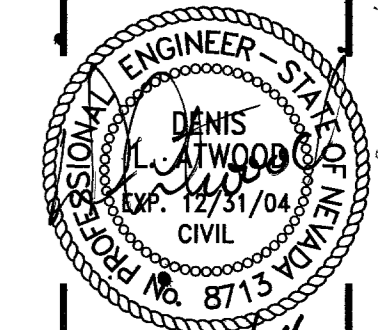
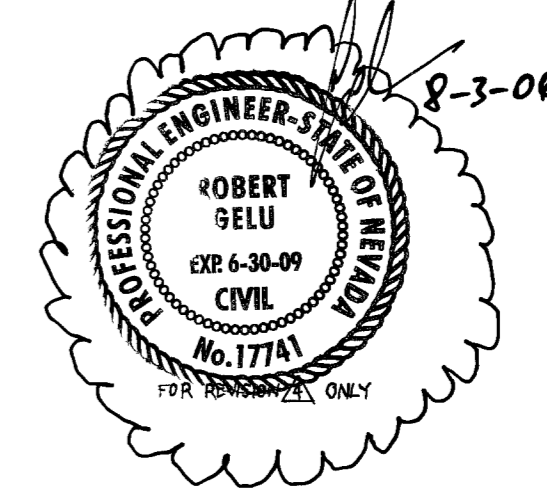
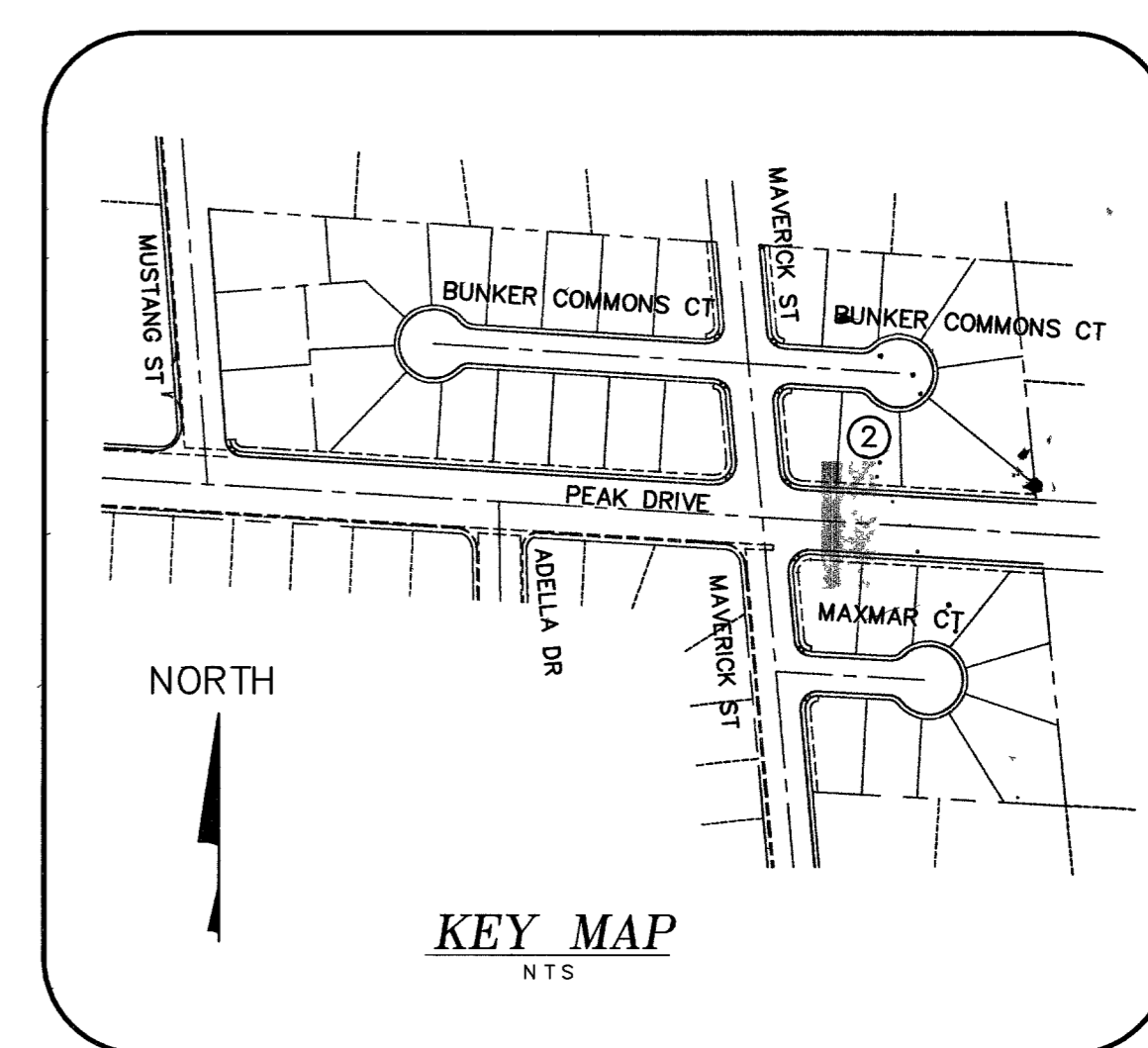

REV	DESCRIPTION	DATE	BY	APP.
1	REVISED DROP INLET ON PEAK DR	08/26		
2	REMOVE PLUG FROM EXISTING DRAIN	08/26		
3	ADD 24\"/>			

PROJ NO: 607.001N
DESIGN: DL
DATE: FEB. 2004
SCALE: AS SHOWN
CADFILE:

STAMP DATE: 9/21/04
EXP. DATE: 12/31/04

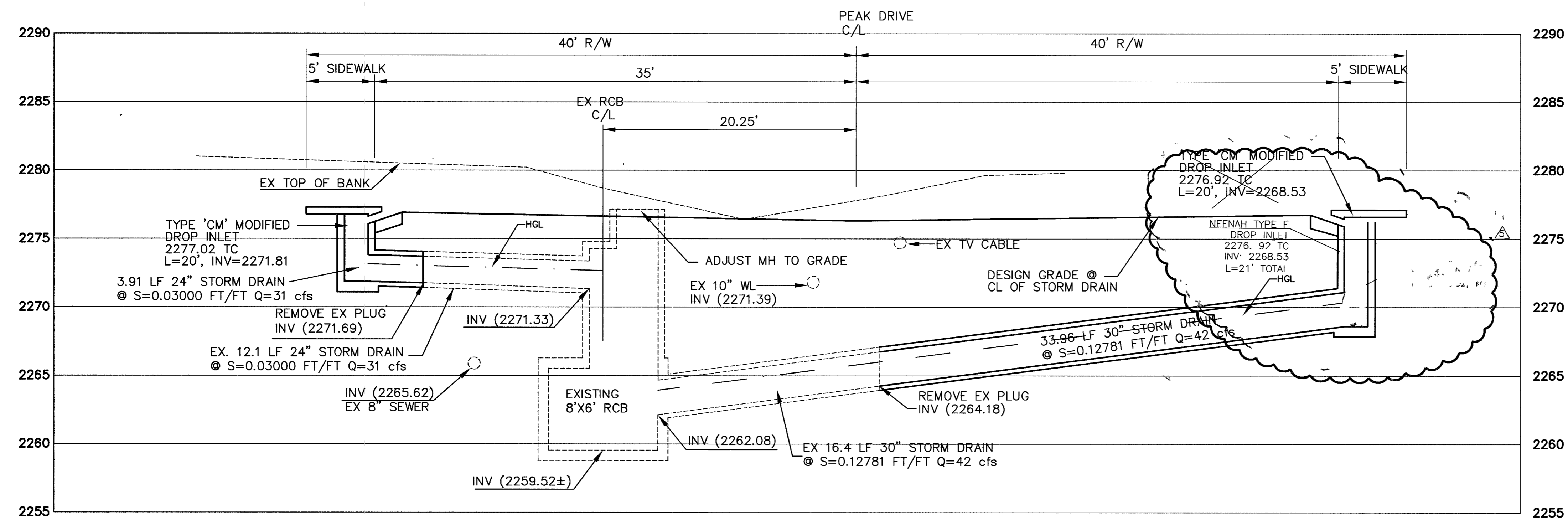

PEAK DRIVE STORM DRAIN 2 - PROFILE

HORIZONTAL: 1"=5'
VERTICAL: 1"=5'

BASIS OF BEARING
NORTH 041°3'42" WEST, BEING THE CENTERLINE OF MUSTANG ROAD, THE WEST LINE OF THE NW 1/4 OF THE NE 1/4 OF THE SW 1/4 OF THE NE 1/4 OF SECTION 14, TOWNSHIP 20 SOUTH, RANGE 60 EAST, M.D.M., AS SHOWN ON PARCEL MAP FILE 13, PAGE 23, CLARK COUNTY, NEVADA.

BENCHMARK
PROJECT DATUM: NORTH AMERICAN VERTICAL DATUM OF 1988 (NAVD88)
CITY OF LAS VEGAS BENCHMARK: #725, 6LV00 14SE6
ELEVATION: 694.8878 METERS (2279.81 FEET)
RIVET & PLATE IN TOP OF CURB ON THE WEST SIDE OF MAVERICK STREET
• CARTIER

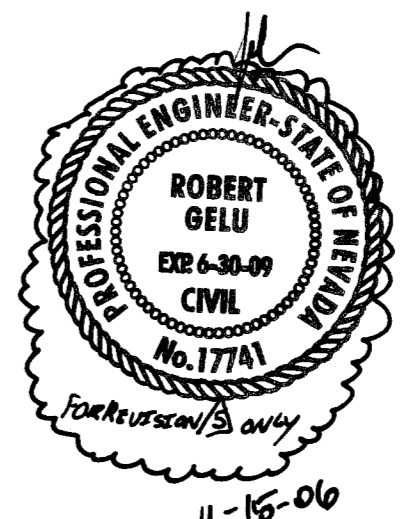

DISCLAIMER NOTE

Avoid cutting underground utility lines. If's costly.
Call before you Dig
1-800-227-2600
UNDERGROUND SERVICE (USA)

Avoid overhead power line contact.
Call before you Overhead
1-702-227-2929
UTILITY POWER ENGINTEERS AND SAFETY SERVICES DEPARTMENT

Avoid hitting UNDERGROUND TRAFFIC SIGNAL SYSTEMS AND STREET LIGHT SYSTEM CONDUITS.
Call before you UnderGround
1-702-455-7511
CLARK COUNTY TRAFFIC SIGNALS AND STREET LIGHTS DIVISION AND LAS VEGAS AREA COMPUTERIZED TRAFFIC SYSTEM

TRC
Customer-Focused Solutions
BV Engineering Nevada

8395 W. SUNSET ROAD
Suite 190
Las Vegas, NV 89113
Tel: 702-650-0572
Fax: 702-303-4422
Web: trcsolutions.com

OWNER/DEVELOPER
SF INVESTMENTS
4911 W. CHEYENNE BLVD.
N. LAS VEGAS, NEVADA 89032
TEL: 702-675-7773

**BUNKER COMMONS
PEAK DRIVE STORM DRAINS
STORM DRAINS 2**

SHEET
16A
OF 17 SHTS
PROJECT ID
107448434

G:\607.001N Bunker Commons\dwg\03\PROFILES.dwg dwg\sheethead Mon, 20 Sep 2004 - 2:18pm

3299810 94033 90239