

CENTENNIAL PARKWAY (PUBLIC STREET)

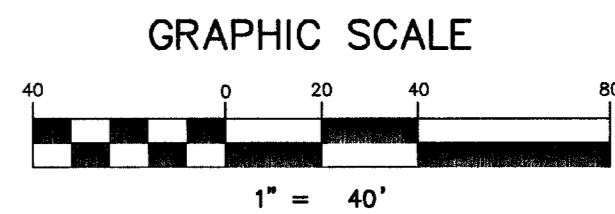
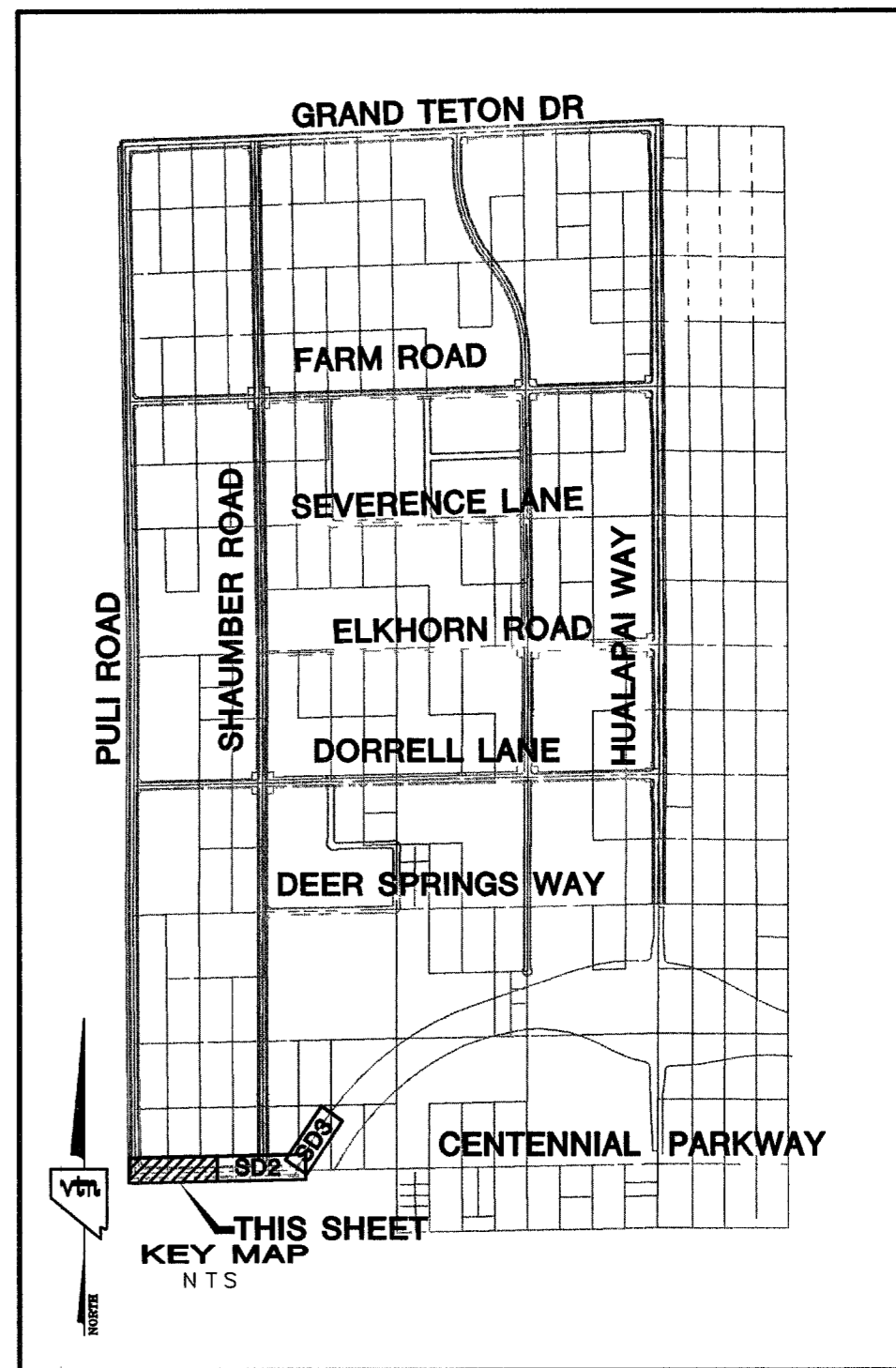
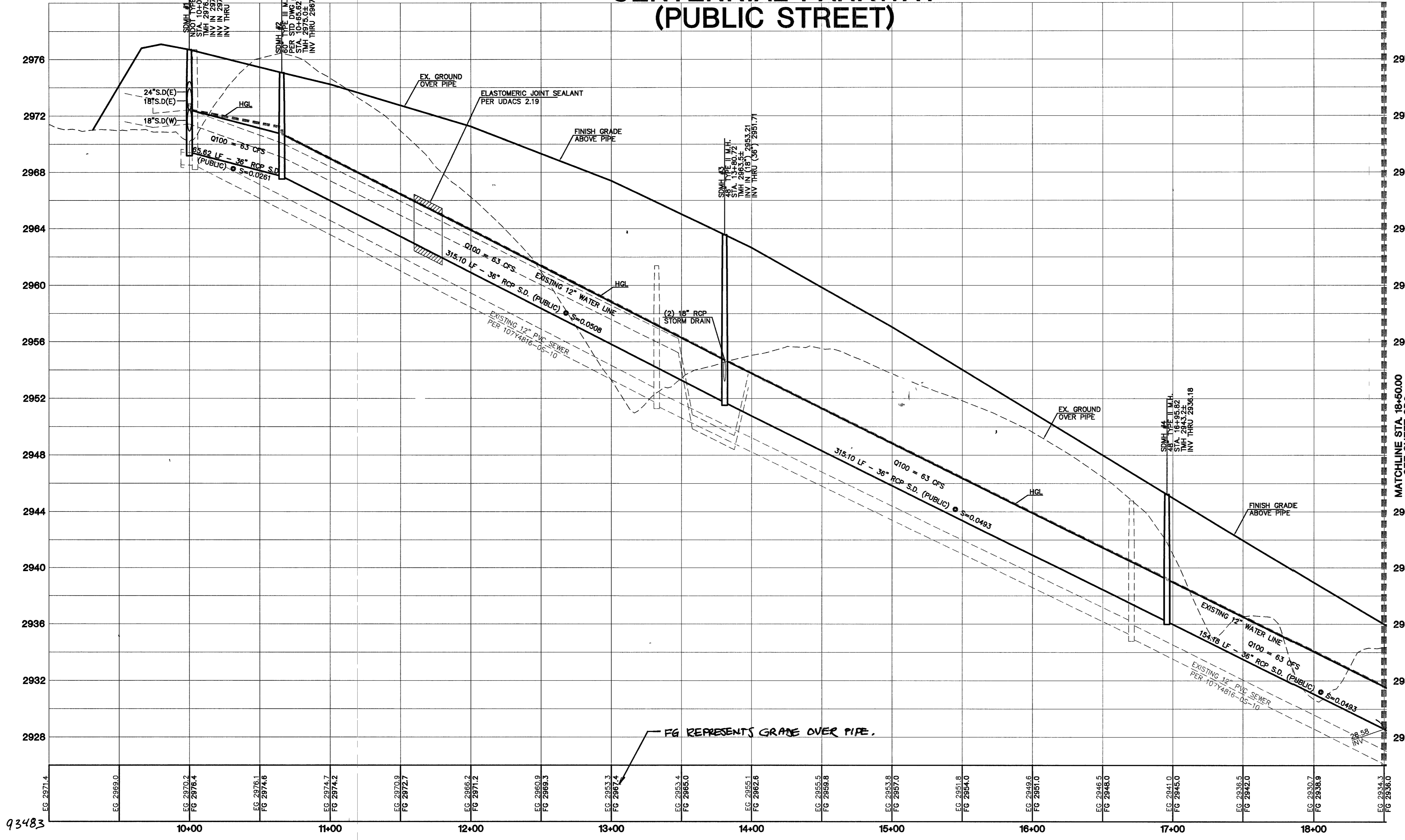

CONTRACTOR NOTE
CONTRACTOR SHALL VERIFY HORIZONTAL AND VERTICAL LOCATION OF EXISTING UTILITIES AND NOTIFY THE DESIGN ENGINEER IMMEDIATELY OF ANY DISCREPANCIES PRIOR TO CONSTRUCTION.

NOTE :
STRUCTURAL CALCULATIONS FOR ALL NON-STANDARD DRAINAGE FACILITIES, SUCH AS JUNCTION BOXES AND OVERFLOW STRUCTURES, WILL BE PROVIDED WITH THE STRUCTURAL CALCULATIONS FOR THE RCA STORM DRAINS.

I CERTIFY THAT THIS PLAN IS IN CONFORMANCE WITH THE APPROVED DRAINAGE STUDY ON FILE AT CITY OF LAS VEGAS FOR THIS PROJECT. #DS3617
Daniel J. Hood NO. 12811 DATE 5/1/20

CLARK COUNTY DEPARTMENT OF DEVELOPMENT SERVICES
Acceptance of plans for filing
By: [Signature] 6/2/20
Acceptance of these plans for filing shall not be construed to be a permit or an approval of any violation of any of the provisions of the state or county laws and/or specifications. Clark County shall be held free from damages which may result from the construction of the improvements from the engineering design depicted hereon.
NOTE: Power poles and/or other existing facilities not in proper location based on proposed improvements shown hereon will be relocated at no expense to Clark County.

Call before you Underground
1-702-455-7511
CLARK COUNTY TRAFFIC OPERATIONS AND 1-702-229-6611
FREEWAY AND ARTERIAL SYSTEM OF TRANSPORTATION

Call before you Dig
1-800-227-2600

Call before you Overhead
1-702-227-2929

BASIS OF BEARINGS
THE BASIS OF BEARINGS FOR THIS PROJECT IS NORTH 00°08'16" EAST BEING THE EAST LINE OF THE NORTHWEST QUARTER (NE 1/4) OF THE SECTION 24, TOWNSHIP 19 SOUTH, RANGE 59 EAST, M.D.M., CLARK COUNTY, NEVADA, AS SHOWN ON A RECORD OF SURVEY ON FILE IN THE CLARK COUNTY, NEVADA, RECORDER'S OFFICE IN FILE 123 AT PAGE 32.

PROJECT BENCHMARK
PROJECT DATUM: NORTH AMERICAN VERTICAL DATUM OF 1988 (NAVD88)
CLARK COUNTY VERTICAL CONTROL: 1000; 6N6
NAVD88 ELEVATION: 787.794 METERS (2584.62 FEET)

RIVET AND SQUARE ALUMINUM PLATE IN A CONCRETE CYLINDER, LOCATED 25' SOUTH & 50' EAST OF GRAND CANYON DRIVE AND RED COACH AVENUE, 1' WEST OF ELECTRICAL VAULT.

CITY OF LAS VEGAS BENCHMARK
DATUM: NORTH AMERICAN VERTICAL DATUM OF 1988 (NAVD88)
CITY OF LAS VEGAS BENCHMARK: BLV99; 13SES
NAVD88 ELEVATION: 869.806 METERS (2853.03 FEET)

RIVET AND PLATE IN CONCRETE CYLINDER NW CORNER OF HUALAPAI AND ELKHORN

NOTE: ADD 0.34' TO ABOVE CITY OF LAS VEGAS BENCHMARK BLV99; 13SES TO MATCH ORIGINAL PROJECT BENCHMARK, CLARK COUNTY BENCHMARK 1000-6N6 (2584.62 FEET) AS SHOWN ON RECORD OF SURVEY FILE 124 PAGE 94.

7	6	5	4	3	2	1
DATE	BY	REV	DATE	BY	REV	DATE

CLIFFS EDGE LLC
3455 CLIFF SHADOWS PARKWAY, SUITE 290
LAS VEGAS, NEVADA 89129
(702) 777-1221

STORM DRAIN PLAN & PROFILE
CENTENNIAL PARKWAY
STA. 10+00.00 TO 18+50.00

CLIFFS EDGE / PROVIDENCE
CENTENNIAL PARKWAY
PULLI ROAD TO WESTERN BELTWAY

CITY OF LAS VEGAS, NEVADA
2727 SOUTH RAINBOW BOULEVARD LAS VEGAS, NEVADA 89146-5148
PH. (702) 873-7500 FAX (702) 362-2597
PLANNERS AND SURVEYORS
CONSULTING ENGINEERS

PROFESSIONAL ENGINEER STATE OF NEVADA
DANIEL J. HOOD
NO. 12811
CIVIL

EXPIRES 06-30-07

SCALE: 1" = 40' HORIZ.
1" = 6' VERT.

SD1
7 OF 15 SHEETS
DRAWING NO. 1074816-C

HTE 05-26671