

DATE

HKS JOB NO. **8849**

3/9/06

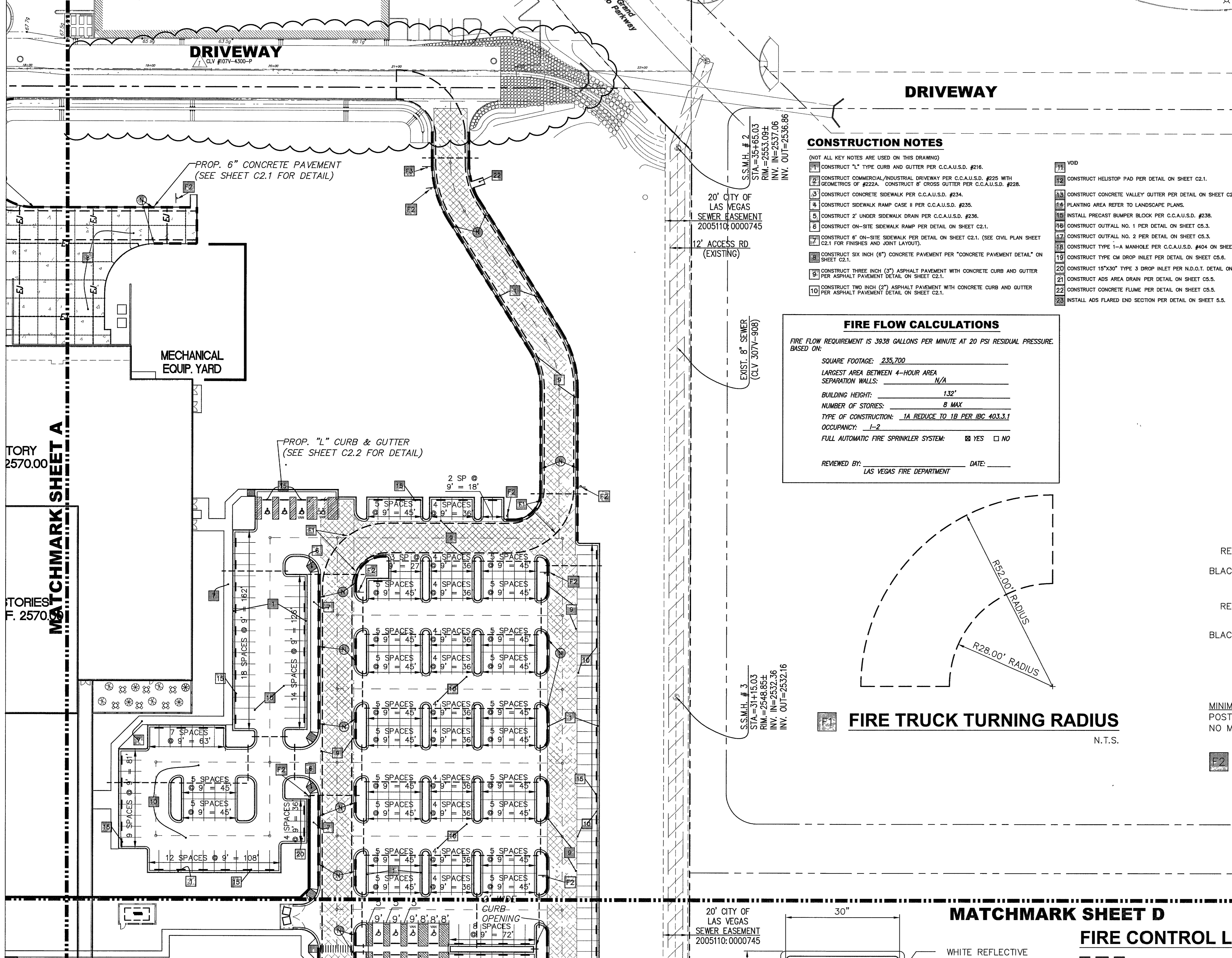
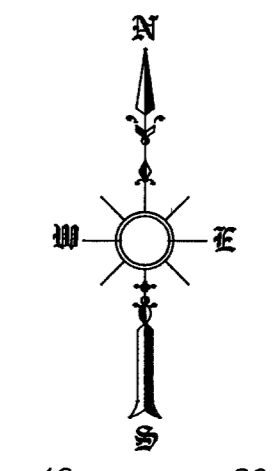

**CONSTRUCTION NOTES**

- (NOT ALL KEY NOTES ARE USED ON THIS DRAWING)
- 1. CONSTRUCT "L" TYPE CURB AND GUTTER PER C.C.A.U.S.D. #216.
  - 2. CONSTRUCT COMMERCIAL/INDUSTRIAL DRIVEWAY PER C.C.A.U.S.D. #225 WITH GEOMETRICS OF #222A. CONSTRUCT 8" CROSS GUTTER PER C.C.A.U.S.D. #228.
  - 3. CONSTRUCT CONCRETE SIDEWALK PER C.C.A.U.S.D. #234.
  - 4. CONSTRUCT SIDEWALK RAMP CASE II PER C.C.A.U.S.D. #235.
  - 5. CONSTRUCT 2" UNDER SIDEWALK DRAIN PER C.C.A.U.S.D. #236.
  - 6. CONSTRUCT ON-SITE SIDEWALK RAMP PER DETAIL ON SHEET C2.1.
  - 7. CONSTRUCT 6" ON-SITE SIDEWALK PER DETAIL ON SHEET C2.1. (SEE CIVIL PLAN SHEET C2.1 FOR FINISHES AND JOINT LAYOUT).
  - 8. CONSTRUCT SIX INCH (6") CONCRETE PAVEMENT PER "CONCRETE PAVEMENT DETAIL" ON SHEET C2.1.
  - 9. CONSTRUCT THREE INCH (3") ASPHALT PAVEMENT WITH CONCRETE CURB AND GUTTER PER ASPHALT PAVEMENT DETAIL ON SHEET C2.1.
  - 10. CONSTRUCT TWO INCH (2") ASPHALT PAVEMENT WITH CONCRETE CURB AND GUTTER PER ASPHALT PAVEMENT DETAIL ON SHEET C2.1.

- 11. VOID
- 12. CONSTRUCT HELISTOP PAD PER DETAIL ON SHEET C2.1.
- 13. CONSTRUCT CONCRETE VALLEY GUTTER PER DETAIL ON SHEET C2.1.
- 14. PLANTING AREA REFER TO LANDSCAPE PLANS.
- 15. INSTALL PRECAST BUMPER BLOCK PER C.C.A.U.S.D. #238.
- 16. CONSTRUCT OUTFALL NO. 1 PER DETAIL ON SHEET C5.3.
- 17. CONSTRUCT OUTFALL NO. 2 PER DETAIL ON SHEET C5.3.
- 18. CONSTRUCT TYPE 1-A MANHOLE PER C.C.A.U.S.D. #104 ON SHEET C5.6.
- 19. CONSTRUCT TYPE CM DROP INLET PER DETAIL ON SHEET C5.6.
- 20. CONSTRUCT 15"x30" TYPE 3 DROP INLET PER N.D.O.T. DETAIL ON SHEET R-4.3.1.
- 21. CONSTRUCT ADS AREA DRAIN PER DETAIL ON SHEET C5.5.
- 22. CONSTRUCT CONCRETE FLUME PER DETAIL ON SHEET C5.5.
- 23. INSTALL ADS FLARED END SECTION PER DETAIL ON SHEET 5.5.

**FIRE FLOW CALCULATIONS**

FIRE FLOW REQUIREMENT IS 3938 GALLONS PER MINUTE AT 20 PSI RESIDUAL PRESSURE. BASED ON:

SQUARE FOOTAGE: 235,700

LARGEST AREA BETWEEN 4-HOUR AREA SEPARATION WALLS: N/A

BUILDING HEIGHT: 132'

NUMBER OF STORIES: 8 MAX

TYPE OF CONSTRUCTION: 1A REDUCE TO 1B PER IBC 403.3.1

OCCUPANCY: I-2

FULL AUTOMATIC FIRE SPRINKLER SYSTEM:  YES  NO

REVIEWED BY: \_\_\_\_\_ DATE: \_\_\_\_\_  
LAS VEGAS FIRE DEPARTMENT

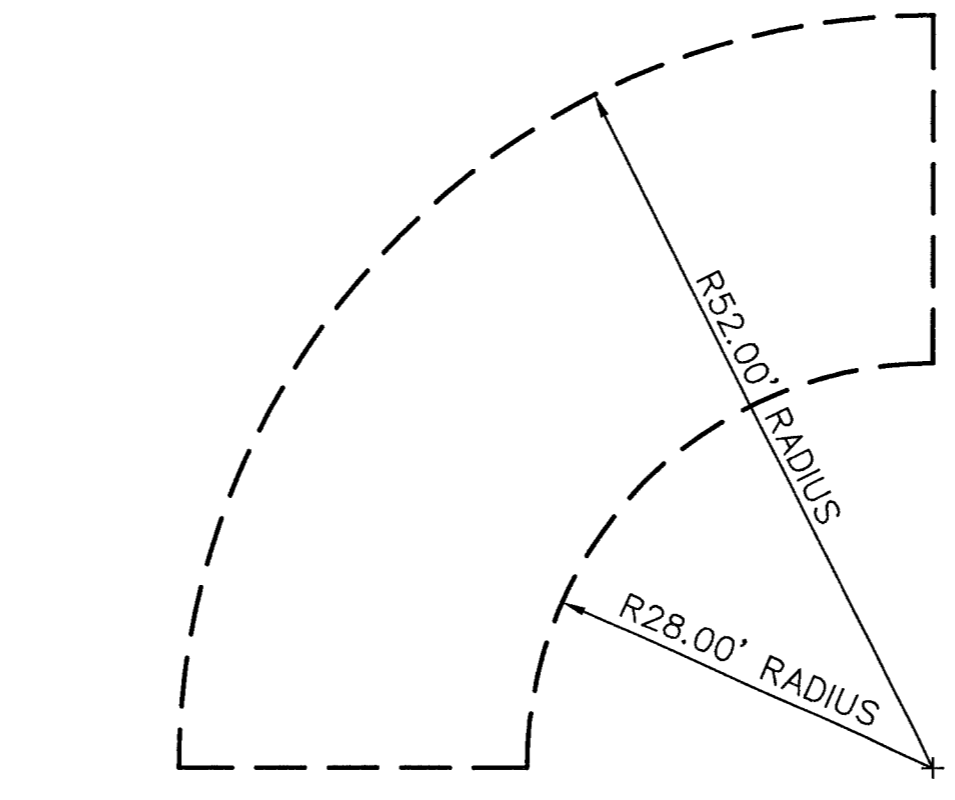

**FIRE TRUCK TURNING RADIUS**  
N.T.S.

- LEGEND**
- PROP 6" CONCRETE PAVEMENT
  - PROP 3" ASPHALT PAVEMENT W/ CONCRETE CURB & GUTTER
  - PROP 2" ASPHALT PAVEMENT W/ CONCRETE CURB & GUTTER
  - PAVEMENT TO BE REMOVED
  - SAWED/CONSTRUCTION JOINT
  - EXPANSION JOINT
  - PROP. 4" SLEEVE FOR FUTURE IRRIGATION LINES

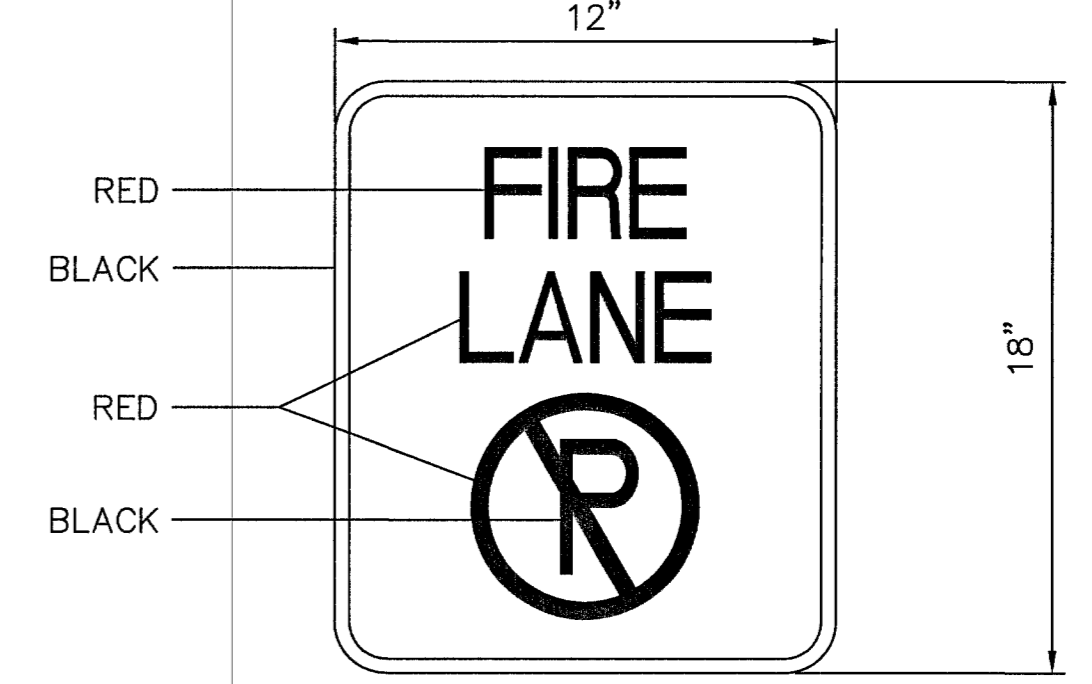

MINIMUM SPECIFICATIONS OF "NO PARKING FIRE LANE" SIGNS  
POST EVERY 100' ON EACH SIDE OF PAINTED CURB.  
NO MORE THAN TEN (10) FEET FROM GROUND LEVEL

**FIRE LANE SIGNAGE**  
N.T.S.

DESCRIPTION OF REVISIONS:  
PARKING STALL WIDTH CHANGED NEAR FUTURE BED TOWER,  
ACCESS DRIVE CHANGED TO 3" ASPHALT WITH ROCK RIPRAP  
ALONG NORTH EDGE, FIRE CONTROL ADDED WITH DETAILS, STRIPING  
ADDED, CONSTRUCTION NOTES ADDED. CONCRETE FLUME ADDED AT  
NORTH EXIT.

**BASIS OF BEARING**

THE BASIS OF BEARING IS A LINE BETWEEN THE N1/4 COR. OF SEC. 20, T. 19 S., R. 60 E., M.D.M., AND THE E1/16 COR. OF SAID SEC. 20, AS SHOWN ON EXHIBIT B OF DOC. 20030131:03151, WHICH IS THE DEDICATION OF ELKHORN ROAD, WHICH BEARS S 89°42'15" E.

CLV BENCHMARK #BLV90-20NG  
RIVET & PLATE IN CONCRETE CYLINDER NE CORNER OF EL CAPITAN & DORRELL  
ELEVATION: 788.9015 METERS, 2588.25 FEET

**FIRE CONTROL LEGEND:**

- DESIGNATED FIRE LANE PAVING
- PAINTED RED CURB (NO PARKING FIRE LANE).
- PAINTED WHITE BLOCK LETTERING - "NO PARKING FIRE LANE" (NOT LESS THAN 4 INCHES IN HEIGHT WITH A STROKE OF NOT LESS THAN 3/4 INCH EVERY 50' TO FIT CURB).

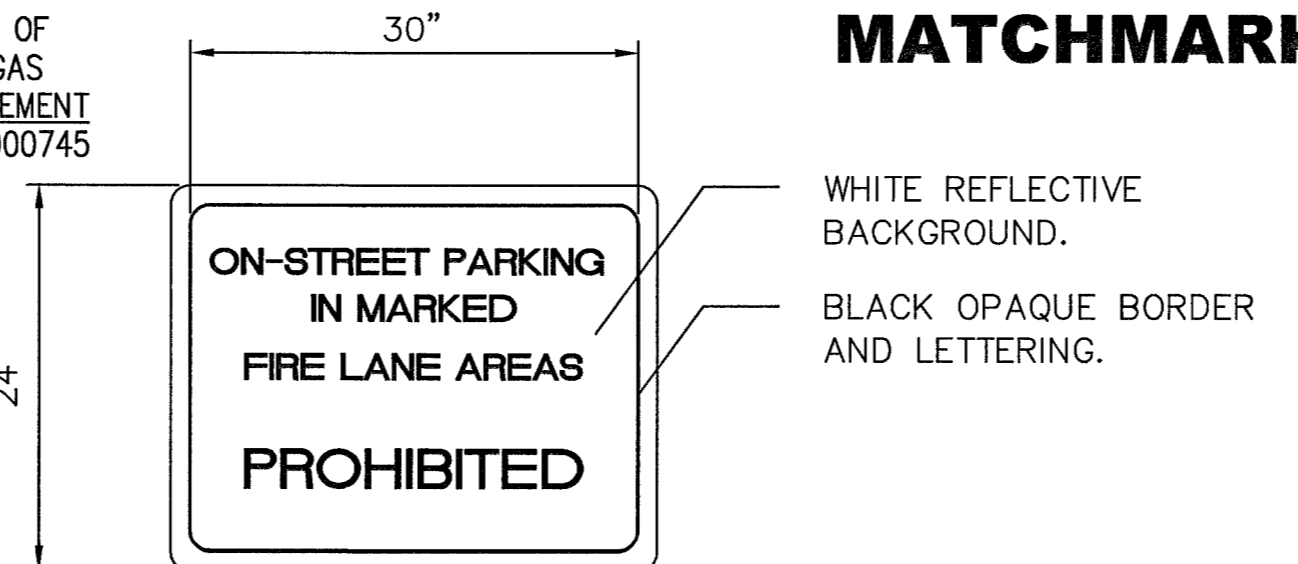

**ENTRANCE WARNING SIGN DETAIL**

**CAUTION TO CONTRACTOR**

THE CONTRACTOR SHALL BE RESPONSIBLE TO INVESTIGATE AND VERIFY THE ACTUAL LOCATION AND DEPTH OF ALL EXISTING UNDERGROUND FACILITIES AT LEAST 48 HOURS IN ADVANCE OF THE PERFORMANCE OF ANY WORK.

Avoid cutting underground utility lines. It's costly.

Avoid overhead power line contact. It's costly.

**Call before you Dig**  
89072  
1-800-227-2600

**Call before you OVERHEAD**  
1-702-593-6111

**Call before you UnderGround**  
1-702-455-7511  
CLARK COUNTY TRAFFIC OPERATIONS AND  
1-702-229-6611

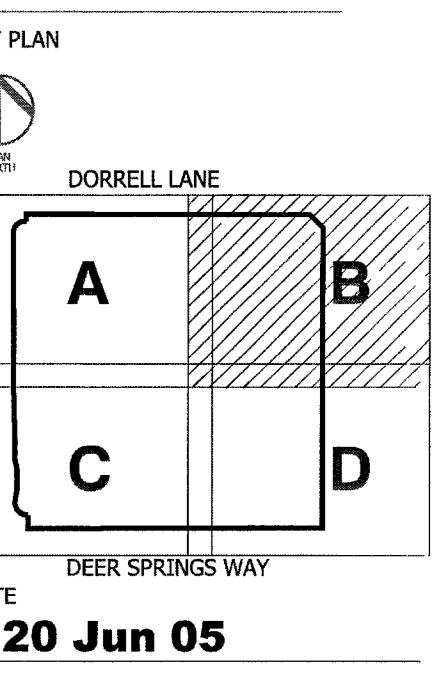

BID/PERMIT ISSUE  
20 JUN 05

CITY OF LAS VEGAS - CIVIL REVIEW  
15 SEPT 05  
FINAL SUBMITTAL  
31 OCT 05

SHEET TITLE  
**PAVING AND STRIPING PLAN**

SHEET NO.  
**C2.B**

SHEET NO. 9 OF 43