

Instr: 20051220-0002664
 Map Type/Plat/Sheet: PL 128 0077
 Date: 12/20/05

FINAL MAP OF ALTESSA AT THE VISTAS CONDOMINIUMS

(A CONDOMINIUM COMMUNITY)
 BEING A DIVISION OF "LOT 1" OF "BLOCK A" PER THAT CERTAIN FINAL MAP ENTITLED "THE VISTAS AT SUMMERLIN VILLAGE 20 UNIT NO. 2"
 PER BOOK 98 OF PLATS PAGE 11, SITUATED WITHIN THE SOUTH HALF (S 1/2) OF SECTION 26, TOWNSHIP 20 SOUTH, RANGE 59 EAST, M.D.M.,
 CITY OF LAS VEGAS, CLARK COUNTY, NEVADA

Receipt/Confirmed Copy
 Requestor: MRG DESIGN
 12/20/2005 13:23:01 T20050230251
 Book/Instr: 20051220-0002664
 Plat Page Count: 10
 Fees: \$144.00 N/C Fee: \$0.00
 Frances Deane
 Clark County Recorder

OWNER'S CERTIFICATE AND DEDICATION

CHATEAU PROPERTIES III, L.L.C., A NEVADA LIMITED LIABILITY COMPANY, DOES HEREBY CERTIFY THAT IT IS THE OWNER OF THE PARCEL OF LAND AS SHOWN UPON THE PLAT OF:

"ALTESSA AT THE VISTAS CONDOMINIUMS"
 AND DOES HEREBY CONSENT TO THE PREPARATION AND RECORDATION OF THIS PLAT, AND DO HEREBY OFFER AND DEDICATE TO THE CITY OF LAS VEGAS ALL THE STREETS (EXCEPT PRIVATE STREETS), AND PUBLIC RIGHT-OF-WAY AS INDICATED AND OUTLINED HEREON FOR THE USE OF THE PUBLIC AND HEREBY GRANTS TO THE CITY OF LAS VEGAS PUBLIC UTILITY EASEMENTS AS SHOWN HEREON FOR THE USE OF THE PUBLIC. NO PART OF THE PARCELS MARKED "NOT A PART OF THIS SUBDIVISION" IS OFFERED FOR DEDICATION.

FURTHERMORE, THE UNDERSIGNED OWNER OF THE WITHIN PLATTED LANDS, DOES HEREBY GRANT AND CONVEY TO NEVADA POWER COMPANY, SPRINT, SOUTHWEST GAS CORPORATION, THE LAS VEGAS VALLEY WATER DISTRICT, COX COMMUNICATIONS, LAS VEGAS, INC., JOINTLY AND SEVERALLY, AND TO THEIR RESPECTIVE SUCCESSORS AND ASSIGNS, A PERMANENT EASEMENT WITHIN THE AREA SHOWN HEREON AS PRIVATE STREETS, COMMON AREAS AND ALL AREAS NOT OCCUPIED BY ANY BUILDING FOR THE CONSTRUCTION, MAINTENANCE, OPERATION AND FINAL REMOVAL AND/OR ABANDONMENT OF STREET LIGHTS, IF ANY, AND FIREHYDRANTS, UNDERGROUND POWER, TELEPHONE, GAS, WATER AND CABLE TELEVISION LINES AND APPURTENANCES AND ABOVE GROUND ELECTRIC TRANSFORMERS, TOGETHER WITH THE RIGHT OF INGRESS THERETO AND EGRESS THEREFROM.

FURTHER, THE UNDERSIGNED OWNER HEREBY GRANTS AND CONVEYS TO THE CITY OF LAS VEGAS AND TO ITS SUCCESSORS AND ASSIGNS A PERMANENT EASEMENT WITHIN THE AREA SHOWN HEREON AS PRIVATE STREETS, COMMON AREAS AND ALL AREAS NOT OCCUPIED BY ANY BUILDING FOR THE CONSTRUCTION, MAINTENANCE, OPERATION AND FINAL REMOVAL AND/OR ABANDONMENT OF PUBLIC STREET LIGHTS, IF ANY, TRAFFIC SIGNALS, CONDUITS AND APPURTENANCES, AND PUBLIC FIRE HYDRANTS, TOGETHER WITH THE RIGHT OF INGRESS TO AND EGRESS THEREFROM.

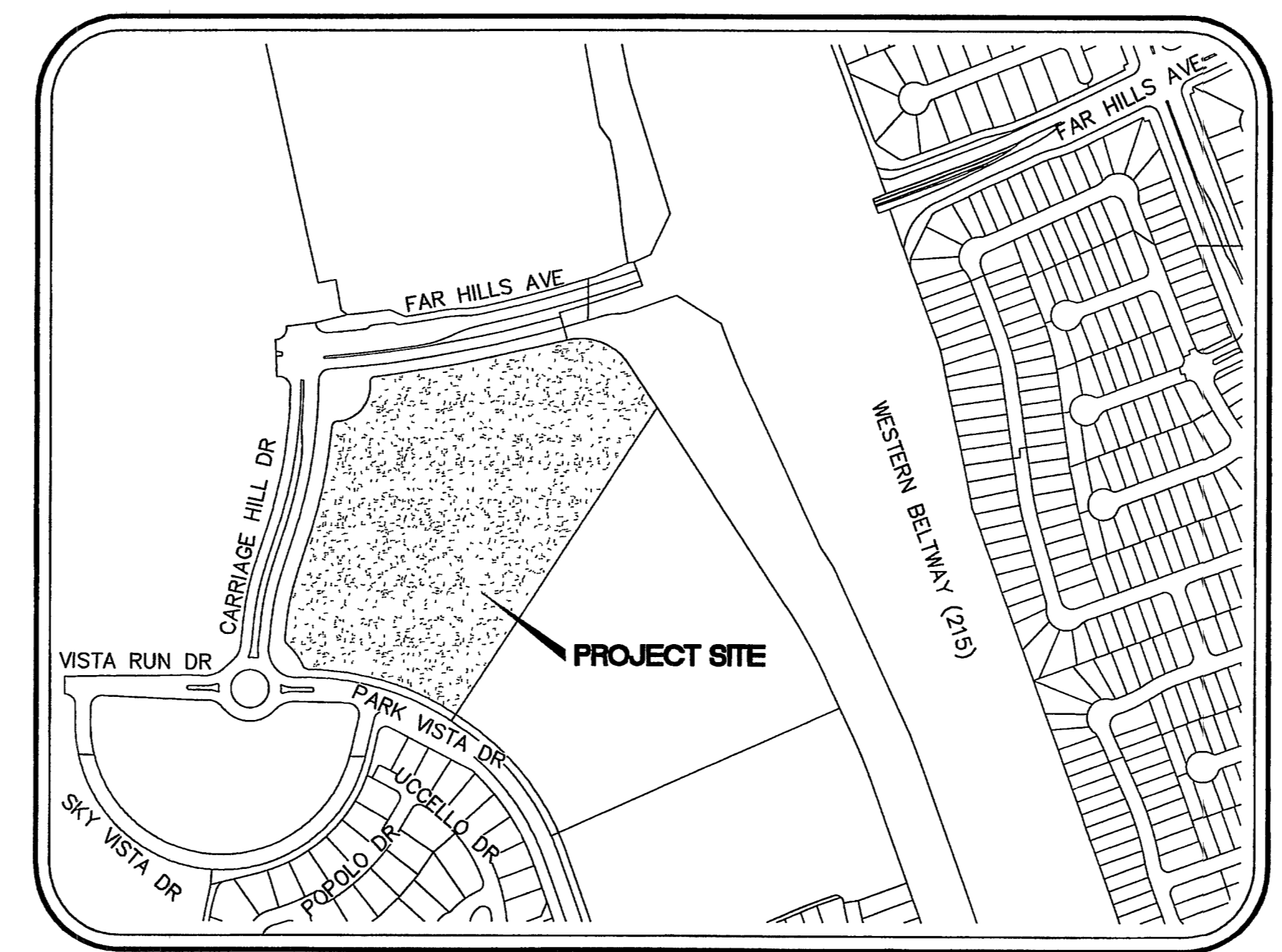

VICINITY MAP
NOT TO SCALE

LEGAL DESCRIPTION

A TRACT OF LAND SITUATED WITHIN THE SOUTH HALF (S 1/2) OF SECTION 26, TOWNSHIP 20 SOUTH, RANGE 59 EAST, M.D.M., CITY OF LAS VEGAS, CLARK COUNTY, NEVADA, BEING MORE PARTICULARLY DESCRIBED AS FOLLOWS:

"LOT 1" OF "BLOCK A" AS SHOWN BY THAT CERTAIN FINAL MAP ENTITLED "THE VISTAS AT SUMMERLIN VILLAGE 20 UNIT NO 2" ON FILE IN BOOK 98 OF PLATS, PAGE 11, OFFICIAL RECORDS, CLARK COUNTY, NEVADA;

CONTAINS 13.135 ACRES, MORE OR LESS.

BASIS OF BEARINGS

NORTH 18°16'00" EAST, BEING THE CENTERLINE OF A PORTION OF "CARRIAGE HILL DRIVE" AS SHOWN BY MAP IN THE OFFICE OF THE CLARK COUNTY, NEVADA RECORDER IN BOOK 98, PAGE 11 OF PLATS.

TOTAL UNITS: 280
TOTAL ACREAGE: 13.135 ACRES

DRAINAGE NOTE

ALL AREAS NOT OCCUPIED BY A BUILDING ARE PUBLIC DRAINAGE EASEMENTS TO BE PRIVATELY MAINTAINED BY THE HOMEOWNERS ASSOCIATION OF "ALTESSA AT THE VISTAS CONDOMINIUMS".

SANITARY SEWER NOTE

THE MAINTENANCE FOR ON-SITE SANITARY SEWER IS PRIVATE AND IS TO BE PRIVATELY MAINTAINED BY THE HOMEOWNERS ASSOCIATION OF "ALTESSA AT THE VISTAS CONDOMINIUMS".

REFERENCE SURVEYS

PLATS	PARCEL MAPS
BOOK 98, PAGE 11	FILE 91, PAGE 28
BOOK 104, PAGE 82	
BOOK 108, PAGE 72	
BOOK 106, PAGE 55	

COUNTY RECORDER'S NOTE

ANY SUBSEQUENT CHANGES TO THIS MAP SHOULD BE EXAMINED AND MAY BE DETERMINED BY REFERENCE TO THE COUNTY RECORDER'S CUMULATIVE MAP INDEX.
 N.R.S. 278.5695

CITY SURVEYOR'S CERTIFICATE

I, ALAN R. RIEKKI, CITY SURVEYOR OF THE CITY OF LAS VEGAS, CLARK COUNTY, NEVADA, DO HEREBY CERTIFY THAT I HAVE EXAMINED THIS FINAL SUBDIVISION MAP OF "ALTESSA AT THE VISTAS CONDOMINIUMS". AND AM SATISFIED THAT THE MAP IS TECHNICALLY CORRECT.

Alan R. Riekk

ALAN R. RIEKKI
 CITY SURVEYOR, CITY OF LAS VEGAS, NEVADA
 NEVADA CERTIFICATE NO. 12469

12/19/05
DATE

CERTIFICATE OF PLANNING AND DEVELOPMENT DEPARTMENT

I CERTIFY THAT THIS FINAL MAP SUBSTANTIALLY COMPLIES WITH THE TENTATIVE MAP AND ANY APPROVED ALTERATIONS THERETO; THAT THE MAP COMPLIES WITH APPLICABLE STATUTORY AND ORDINANCE PROVISIONS; THAT ALL CONDITIONS IMPOSED UPON THE FINAL MAP HAVE BEEN MET; AND THAT THE MAP WAS APPROVED AND THE PARCELS HEREIN WERE ACCEPTED BY THE PLANNING AND DEVELOPMENT DEPARTMENT OF THE CITY OF LAS VEGAS, NEVADA ON THE 17TH DAY OF NOVEMBER 2005.

M. Margo Wheeler

M. MARGO WHEELER, AICP
 DIRECTOR OF PLANNING AND DEVELOPMENT DEPARTMENT
 CITY OF LAS VEGAS, NEVADA

11/17/05
DATE

Mark H. Cassidy
 BY: Mark H. Cassidy AS: President DATE: 5/4/05
 CHATEAU PROPERTIES III, L.L.C., A NEVADA LIMITED LIABILITY COMPANY

ACKNOWLEDGMENT

STATE OF NEVADA }
 COUNTY OF CLARK } SS

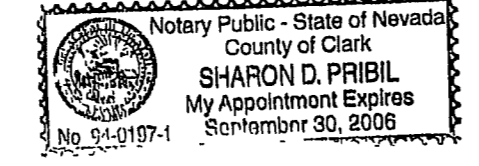

THIS INSTRUMENT WAS ACKNOWLEDGED BEFORE ME ON May 6 2005,
 BY Mark H. Cassidy AS President OF
 CHATEAU PROPERTIES III, L.L.C., A NEVADA LIMITED LIABILITY COMPANY

Sharon D. Pribil NOTARY PUBLIC IN AND FOR SAID COUNTY AND STATE
 MY COMMISSION EXPIRES 9/30/06

DIVISION OF WATER RESOURCES

THIS FINAL MAP IS APPROVED BY THE DIVISION OF WATER RESOURCES OF THE DEPARTMENT OF CONSERVATION AND NATURAL RESOURCES CONCERNING WATER QUANTITY SUBJECT TO REVIEW OF APPROVAL ON FILE IN THIS OFFICE.

Robert Coache, P.E.
 BY: ROBERT COACHE, P.E. DATE: 8-24-05
 DIVISION OF WATER RESOURCES

UTILITY/AGENCY APPROVALS

WE, THE HEREIN NAMED UTILITY COMPANIES AND AGENCIES, APPROVE THE GRANT OF THE DESIGNATED EASEMENTS

Danny L. Lewis
 BY: DANNY L. LEWIS DATE: 6/17/05
 LAS VEGAS VALLEY WATER DISTRICT

Charles Karkowski
 BY: CHARLES KARKOWSKI DATE: 11-1-2005
 CITY OF LAS VEGAS

David Valles
 BY: DAVID VALLES DATE: 6/20/05
 SOUTHWEST GAS CORPORATION

Sharon McSlea
 BY: SHARON MCSLEA DATE: 7-12-05
 NEVADA POWER COMPANY

Galen J. Gozdan
 BY: GALEN J. GOZDAN DATE: 6/17/05
 SPRINT CENTRAL TELEPHONE - NEVADA

Maria L. Tapia
 BY: MARIA L. TAPIA DATE: 6/22/05
 COX COMMUNICATIONS OF LAS VEGAS, INC.



DISTRICT BOARD OF HEALTH CERTIFICATE

THIS FINAL MAP IS APPROVED BY THE CLARK COUNTY DISTRICT BOARD OF HEALTH. THIS APPROVAL CONCERNS SEWAGE DISPOSAL, WATER POLLUTION, WATER QUALITY AND WATER SUPPLY FACILITIES AND IS PREDICATED UPON PLANS FOR A PUBLIC WATER SUPPLY AND A COMMUNITY SYSTEM FOR DISPOSAL OF SEWAGE.

Walter B. Ross

BY: WALTER B. ROSS
 DISTRICT BOARD OF HEALTH

10/25/05
DATE

SURVEYOR'S CERTIFICATE

I, TEX J. BROOKS, A PROFESSIONAL LAND SURVEYOR LICENSED IN THE STATE OF NEVADA, CERTIFY THAT:

- 1) THIS PLAT REPRESENTS THE RESULTS OF A SURVEY CONDUCTED UNDER MY DIRECT SUPERVISION AT THE INSTANCE OF CHATEAU PROPERTIES III, L.L.C., A NEVADA LIMITED LIABILITY COMPANY.
- 2) LANDS SURVEYED LIE WITHIN THE SOUTH HALF (S 1/2) OF SECTION 26, TOWNSHIP 20 SOUTH, RANGE 59 EAST, M.D.M., CITY OF LAS VEGAS, CLARK COUNTY, NEVADA AND THE SURVEY WAS COMPLETED ON JUNE 21, 2004.
- 3) THIS PLAT COMPLIES WITH THE APPLICABLE STATE STATUTES AND ANY LOCAL ORDINANCES IN EFFECT ON THE DATE THAT THE GOVERNING BODY GAVE ITS FINAL APPROVAL.
- 4) THE MONUMENTS DEPICTED ON THIS PLAT ARE OF THE CHARACTER SHOWN, OCCUPY THE POSITIONS INDICATED AND ARE OF SUFFICIENT NUMBER AND DURABILITY.

TEX J. BROOKS
 PROFESSIONAL LAND SURVEYOR
 NEVADA LICENSE NO. 13747

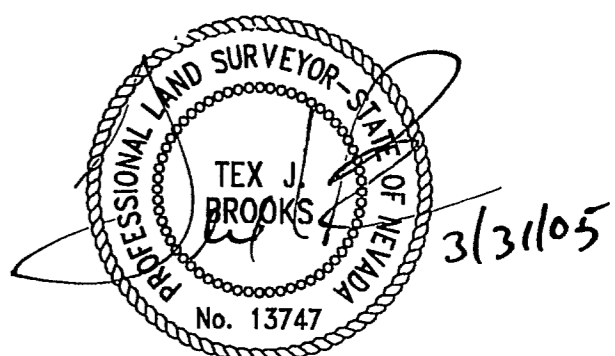

EXP. 12-31-06 FMP-5872

SHEET INDEX

- | | |
|-----------|---|
| SHEET 1) | COVER SHEET |
| SHEET 2) | SURVEY ANALYSIS & FINANCE PHASE LINES |
| SHEET 3) | BUILDING TIE LINES & BASEMENT FLOOR UNIT #S |
| SHEET 4) | BUILDING TIE LINES & 1ST FLOOR UNIT #S |
| SHEET 5) | BUILDING TIE LINES & 2ND FLOOR UNIT #S |
| SHEET 6) | DRIVE AISLE DETAILS |
| SHEET 7) | BUILDING TYPE I DETAILS |
| SHEET 8) | BUILDING TYPE II DETAILS |
| SHEET 9) | BUILDING TYPE III DETAILS |
| SHEET 10) | & GENERAL NOTES |

FINAL MAP OF ALTESSA AT THE VISTAS CONDOMINIUMS (A CONDOMINIUM COMMUNITY) BEING A DIVISION OF "LOT 1" OF "BLOCK A" PER THAT CERTAIN FINAL MAP ENTITLED "THE VISTAS AT SUMMERLIN VILLAGE 20 UNIT NO. 2" PER BOOK 98 OF PLATS PAGE 11, SITUATED WITHIN THE SOUTH HALF (S 1/2) OF SECTION 26, TOWNSHIP 20 SOUTH, RANGE 59 EAST, M.D.M., CITY OF LAS VEGAS, CLARK COUNTY, NEVADA	NO. <u>2-664</u> FILED AT THE REQUEST OF: WRG DESIGN DATE: <u>12-20-05</u> AT <u>13:23</u> BOOK: <u>128</u> PAGE: <u>77</u> OF PLATS OFFICIAL RECORDS BOOK NO. <u>20051220</u> CLARK COUNTY, NEVADA RECORDS FRANCES DEANE - RECORDER FEE: <u>144</u> DEPUTY <u>DG</u>
W R G DESIGN INC. 3011 W. HORIZON RIDGE PARKWAY #100, HENDERSON, NV, 89052 Tel. 702.990.9300 Fax. 702.990.9305 PLANNERS • ENGINEERS • LANDSCAPE ARCHITECTS • SURVEYORS	
DATE: 03/08/2005 JOB# PCP 3044152.00 SHEET 1 OF 10	BOOK <u>128</u> PAGE <u>77</u> 107-v 3688