

**GRAND TETON DRIVE  
(PUBLIC STREET)**

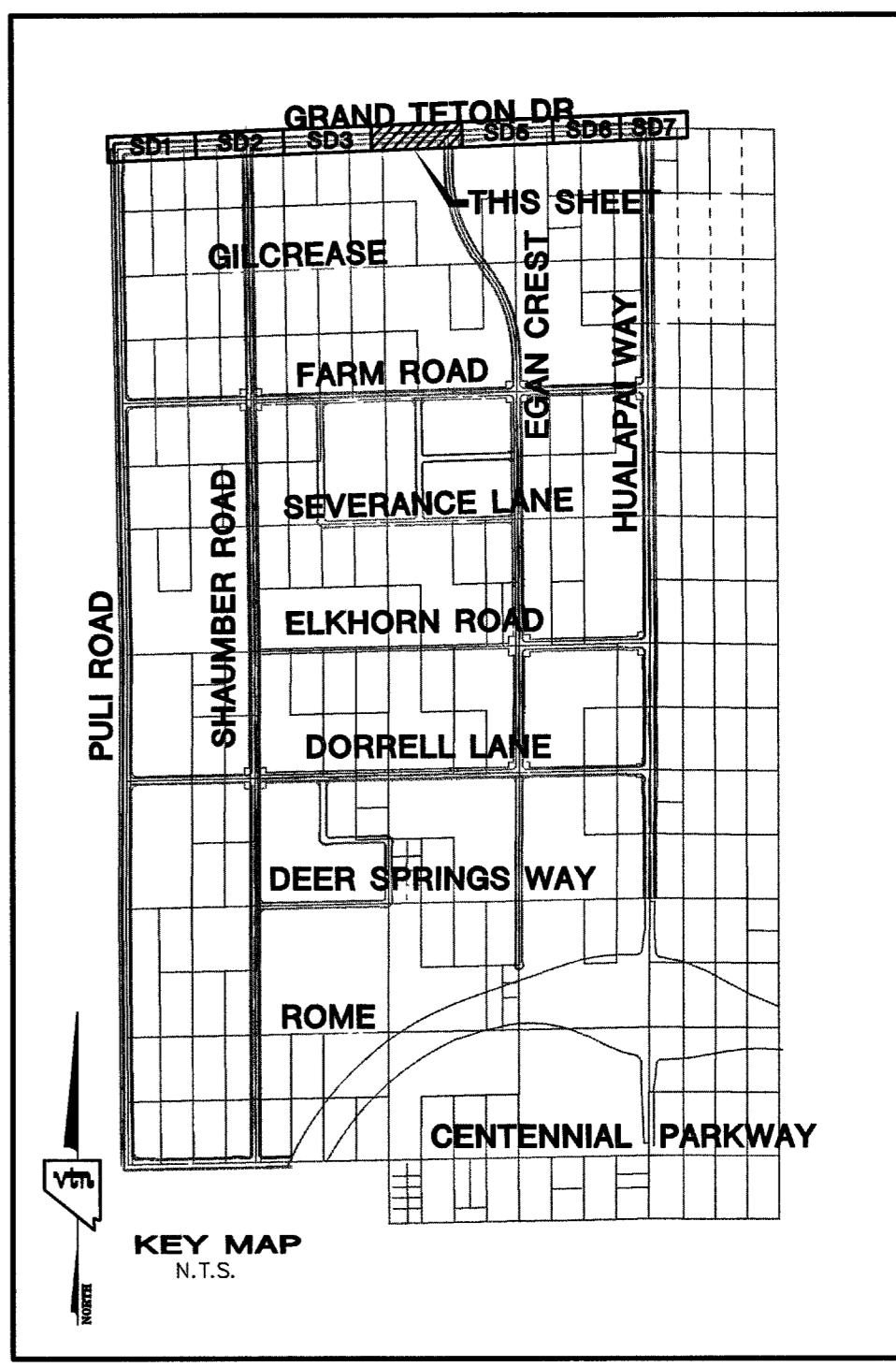

**NOTE :**  
STRUCTURAL CALCULATIONS FOR ALL NON-STANDARD DRAINAGE FACILITIES, SUCH AS JUNCTION BOXES AND OVERFLOW STRUCTURES, WILL BE PROVIDED WITH THE STRUCTURAL CALCULATIONS FOR THE RCA STORM DRAINS.

**CONTRACTOR NOTE**  
CONTRACTOR SHALL VERIFY HORIZONTAL AND VERTICAL LOCATION OF EXISTING UTILITIES AND NOTIFY THE DESIGN ENGINEER IMMEDIATELY OF ANY DISCREPANCIES PRIOR TO CONSTRUCTION.

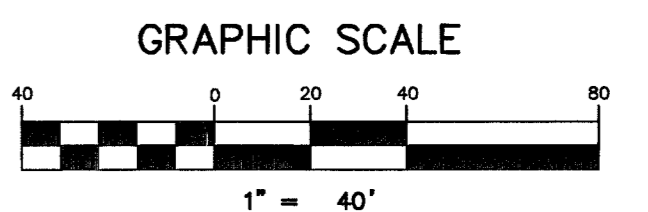

**Call before you Underground**  
1-702-455-7511  
CLARK COUNTY TRAFFIC OPERATIONS  
1-702-229-6611  
LAS VEGAS AREA COMPUTERIZED TRAFFIC SYSTEM

**Call before you Dig**  
1-800-227-2600

**Call before you Overhead**  
1-702-227-2929

**BASIS OF BEARINGS**  
THE BASIS OF BEARINGS FOR THIS PROJECT IS NORTH 00°08'16" EAST BEING THE EAST LINE OF THE NORTHWEST QUARTER (NE 1/4) OF THE SECTION 24, TOWNSHIP 24, RANGE 59 EAST, M.D.M., CLARK COUNTY, NEVADA, AS SHOWN ON A RECORD OF SURVEY ON FILE IN THE CLARK COUNTY, NEVADA, RECORDER'S OFFICE IN FILE 123 AT PAGE 32.

**PROJECT BENCHMARK**  
PROJECT DATUM: NORTH AMERICAN VERTICAL DATUM OF 1988 (NAVD88)  
CLARK COUNTY VERTICAL CONTROL: 1000-6N8  
NAVD88 ELEVATION: 787.794 METERS (2584.62 FEET)  
RIVET AND SQUARE ALUMINUM PLATE IN A CONCRETE CYLINDER, LOCATED 25' SOUTH & 50' EAST OF GRAND CANYON DRIVE AND RED COACH AVENUE, 1' WEST OF ELECTRICAL VAULT.

**CITY OF LAS VEGAS BENCHMARK**  
DATUM: NORTH AMERICAN VERTICAL DATUM OF 1988 (NAVD88)  
CITY OF LAS VEGAS BENCHMARK: 8LV99-13SES  
NAVD88 ELEVATION: 869.606 METERS (2853.03 FEET)  
RIVET AND PLATE IN CONCRETE CYLINDER NW CORNER OF HUALAPAI AND ELKHORN

NOTE: ADD 0.34' TO ABOVE CITY OF LAS VEGAS BENCHMARK 8LV99-13SES TO MATCH ORIGINAL PROJECT BENCHMARK, CLARK COUNTY BENCHMARK 1000-6N8 (2584.62 FEET) AS SHOWN ON RECORD OF SURVEY FILE 124 PAGE 94.

"I CERTIFY THAT THIS PLAN IS IN CONFORMANCE WITH THE APPROVED DRAINAGE STUDY (DS3576) ON FILE AT THE CITY OF LAS VEGAS FOR THIS PROJECT."  
DANIEL J. HOOD NO. 12811 DATE

<b>CLIFFS EDGE LLC</b> 3455 CLIFF SHADOWS PARKWAY, SUITE 290 LAS VEGAS, NEVADA 89129 (702) 777-1221		<b>CITY OF LAS VEGAS, NEVADA</b> 2727 SOUTH RAINBOW BOULEVARD LAS VEGAS, NEVADA 89146-5148 PH. (702) 874-7550 FAX (702) 362-2597	
<b>STORM DRAIN PLAN &amp; PROFILE</b> GRAND TETON DRIVE, STA. 62+50.00 TO 72+50.00		<b>CLIFFS EDGE / PROVIDENCE</b> GRAND TETON DRIVE PULL ROAD TO HUALAPAI WAY	
DRAWN BY: MS	DESIGNED BY: N.H.	CHECKED BY: L.M.	PROJECT NO: 5989
APRIL '04	MAR. '04	APRIL '04	SCALE: 1"=40' HORIZ. 1"=4' VERT.
EXPIRES 06-30-05 <b>PROFESSIONAL ENGINEER STATE OF NEVADA</b> DANIEL J. HOOD CIVIL No. 12811			
SHEET <b>SD4</b> 14 OF 30 SHEETS		DRAWING NO. 107-4816-97	