

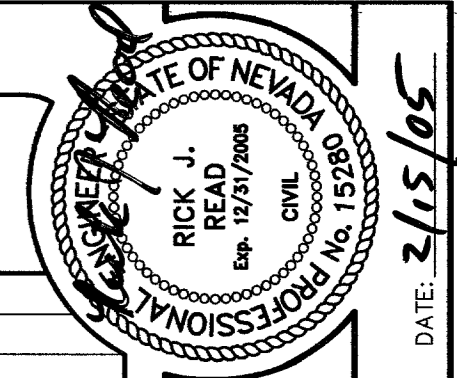

# IMPROVEMENT PLANS FOR CITY OF LAS VEGAS CHARLESTON BLM 10 ACRE (FULTON PARK)

APN: 138-33-401-015

INDEX OF DRAWINGS		
NO.	SHT.NO.	TITLE
1	C-1	COVER SHEET
2	C-2	GENERAL NOTES
3	C-3	LEGEND AND ESTIMATE OF QUANTITIES
4	U-1	MASTER UTILITY PLAN
5	U-2	UTILITY PLAN I
6	U-3	UTILITY PLAN II
7	G-1	GRADING PLAN I
8	G-2	GRADING PLAN II
9	SL-1	STREETLIGHT, SIGNAGE AND STRIPING PLAN I
10	SL-2	STREETLIGHT, SIGNAGE AND STRIPING PLAN II
11	D-1	DETAIL SHEET I
12	D-2	DETAIL SHEET II
13	D-3	DETAIL SHEET III
14	D-4	DETAIL SHEET IV
15	D-5	DETAIL SHEET V



DATE: 2/15/05  
REV. DATE: \_\_\_\_\_  
AGEN. APP. DATE: \_\_\_\_\_  
DESC. DATE: \_\_\_\_\_

PROJECT NAME: Fulton Park  
This project water plan complies with the Las Vegas Valley Water District's technical requirements. However, this water plan is  
**NOT APPROVED FOR CONSTRUCTION**  
at this time and this signature does not provide or imply a water commitment.  
*Gregory Long* 3/15/05  
LVWVD Project # 109887 DATE ESN 052

**APPROVALS:**

*Charles K. Kowalski* 4-18-2005  
CITY ENGINEER CHARLES KAJKOWSKI, JR; PE #4784 DATE  
APPROVAL OF THESE PLANS BY THE CITY ENGINEER IS LIMITED TO THOSE IMPROVEMENTS CONSTRUCTED IN THE DEDICATED RIGHT-OF-WAY, AND/OR CONSTRUCTION OF ANY IMPROVEMENTS THAT DEVIATE FROM ADOPTED STANDARDS AND/OR SPECIFICATIONS EXCEPT THOSE SPECIFICALLY LISTED UNDER DEVIATIONS FROM STANDARDS. THE ENGINEER SHALL RESOLVE ANY DEVIATION OTHER THAN THOSE LISTED IN DEVIATIONS FROM STANDARD IN FAVOR OF THE UNIFORM STANDARD DRAWINGS AND SPECIFICATIONS FOR CLARK COUNTY AREA NEVADA.

*M. Wargo* 04/01/05  
M. WARGO WHEELER, AICP, DIRECTOR OF PLANNING AND DEVELOPMENT DATE  
THIS PLAN MEETS THE APPLICABLE STANDARDS OF THE PLANNING AND DEVELOPMENT DEPARTMENT.

*Tom Spurgeon* 4/2/05  
LAS VEGAS VALLEY WATER DISTRICT #107887 DATE  
(SHEETS C1, C2, U1, U2, U3, AND U3)

*Sandy Larson* Sandy Larson 2-25-05  
NEVADA POWER COMPANY DATE  
THIS APPROVAL IS ONLY FOR THE PLACEMENT AND CLEARANCE OF STREETLIGHT AND SIGNAL LIGHT INSTALLATIONS. NEVADA POWER COMPANY ACKNOWLEDGES THAT WE HAVE RECEIVED YOUR PLANS AND WILL PROVIDE SERVICE TO ALL ELECTRICAL NEEDS ASSOCIATED WITH THIS PROJECT. NEVADA POWER COMPANY RESERVES THE RIGHT TO ADDRESS ANY EXISTING OR FUTURE CONFLICTS ONCE THE FINAL DESIGN IS COMPLETED. THE NEW SERVICE AND THE RESOLUTION OF ANY CONFLICTS WILL BE ACCOMPLISHED PURSUANT TO THE NEVADA PUBLIC UTILITY COMMISSION'S RULES AND REGULATIONS.

*Tom O'Neil* 2/24/05  
SPRINT CENTRAL TELEPHONE - NEVADA DATE  
COX COMMUNICATIONS LAS VEGAS, INC. DATE  
2-25-05  
"THE AFFIXED SPRINT NEVADA APPROVAL DOES NOT ASSUME OR GUARANTEE LIABILITY FOR KNOWN OR UNKNOWN CONFLICTS WITH EXISTING OR PROPOSED IMPROVEMENTS. RESOLUTION OF ANY CONFLICT WILL BE ACCOMPLISHED PURSUANT TO LOCAL ORDINANCES, NEVADA REVISED STATUTES AND/OR PUBLIC UTILITY COMMISSION RULES AND REGULATIONS."

*Tom O'Neil* 3/28/05  
CITY FIRE MARSHAL DATE

*Tom O'Neil* 2/21/05  
SOUTHWEST GAS DATE

10744864

**NOTE:**  
NDOT ENCROACHMENT PERMIT REQUIRED FOR ALL WORK PERFORMED IN THE NDOT RIGHT-OF-WAY.

BENCHMARK			
BM #	DESCRIPTION	ELEV. DATUM (FEET)	ELEV. DATUM (METERS)
0LV00 3354	CITY OF LAS VEGAS RIVET AND ROUND PLATE IN TOP OF CURB, AT THE NORTHEAST CORNER OF CHARLESTON AND CIMARRON RD.	2594.24	790.725

**BASIS OF BEARINGS**  
SOUTH 89°39'53" WEST, BEING THE BEARING OF THE SOUTH LINE OF THE SOUTHWEST QUARTER (SW 1/4) OF SECTION 33, TOWNSHIP 20 SOUTH, RANGE 60 EAST, M.D.M., AS SHOWN BY MAP THEREOF ON FILE IN BOOK 75, PAGE 06 OF PLATS IN THE COUNTY RECORDER'S OFFICE, CLARK COUNTY, NEVADA.

**ENGINEER**  
G.C. WALLACE INC.  
1555 SOUTH RAINBOW BOULEVARD  
LAS VEGAS, NEVADA 89146  
PHONE: (702) 804-2000

**UTILITY SERVICES BY**  
LAS VEGAS VALLEY WATER DISTRICT  
CITY OF LAS VEGAS SEWER  
REPUBLIC SERVICES OF SOUTHERN NEVADA  
NEVADA POWER COMPANY  
SPRINT TELEPHONE COMPANY  
SOUTHWEST GAS CORPORATION  
COX COMMUNICATIONS

**RECORD OWNER**  
PULTE HOMES, INC.  
11500 SOUTH EASTERN  
LAS VEGAS, NEVADA 89134  
PHONE: (702) 914-4700

**SUBDIVIDER**  
PULTE HOMES, INC.  
1635 VILLAGE CENTER CIRCLE, SUITE 250  
LAS VEGAS, NEVADA 89134  
PHONE: (702) 256-7900

ACREAGE: 10.15 AC. (GROSS)  
NO. OF UNITS: 140  
UNITS PER ACRE: 13.78  
LOCATION: CITY OF LAS VEGAS  
APN: 138-33-401-015

**ABBREVIATIONS**

ASPHALTIC CONCRETE PAVEMENT	AC	POINT OF TANGENCY	PT
BACK OF CURB	BC, B/C	POINT OF COMPOUND CURVATURE	PCC
BEGIN CURB RETURN	BCR	POINT OF VERTICAL INTERSECTION	PVI
BEGIN VERTICAL CURVE	BVC	RADIUS	R
DESIGN GRADE ELEVATION	DG	RADIUS POINT	RP
EDGE OF PAVEMENT	EP	REINFORCED CONCRETE PIPE	RCP
END VERTICAL CURVE	EVC	STORM DRAIN MANHOLE	SDMH
FINISHED GRADE ELEVATION	FG	SANITARY SEWER MANHOLE	SMH
FIRE HYDRANT	FH	SIGHT VISIBILITY RESTRICTION EASEMENT	SVRE
FLOW LINE	FL	SIDEWALK	SW
GRADE BREAK	GB	TOP OF CURB	TC
HIGH POINT	HP, HI PT	TOP OF FOOTING	TF
INVERT	INV.	TOP OF GRADE	TG
LINEAR FEET	L.F.	TOP OF WALL	TW
LOW POINT	LP, L.P.		
LANDSCAPING	LS, L.S.	UNIFORM DESIGN AND CONSTRUCTION STANDARDS, FOR WATER DISTRIBUTION SYSTEMS, LATEST EDITION	UDACS
MIDDLE OF VERTICAL CURVE	MVC		
POLYVINYL CHLORIDE	PVC	UNIFORM STANDARD DRAWINGS (BLUE BOOK), LATEST EDITION	USD
POINT OF CURVATURE	PC		
POINT OF INTERSECTION	PI	VERTICAL CURVE	VC
POINT OF REVERSE CURVATURE	PRC	WATER SURFACE	WS

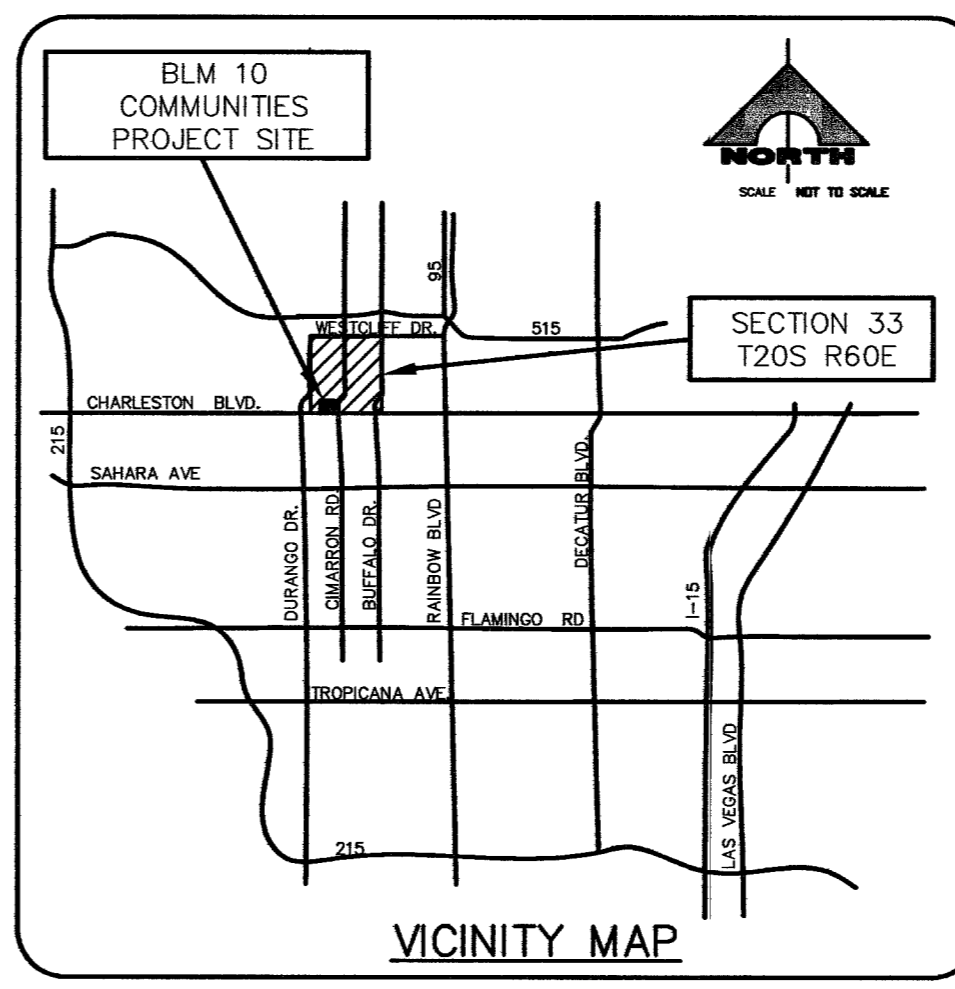

"The affixed Sprint Nevada approval does not assume or guarantee liability for known or unknown conflicts with existing or proposed improvements. Resolution of any conflict will be accomplished pursuant to Local Ordinances, Nevada Revised Statutes and/or Public Utility Commission Rules and Regulations."

Avoid cutting underground utility lines. It's costly.  
**Call before you Dig.**  
1-800-227-2600  
UNDERGROUND SERVICE (USA)

Avoid hitting overhead power lines. It's costly.  
**CALL BEFORE YOU DIG OVERHEAD**  
1-702-227-2929

G. C. WALLACE, INC.  
Engineers/Planners/Surveyors  
1555 SOUTH RAINBOW BLVD., LAS VEGAS, NEVADA 89146  
TELEPHONE: (702) 804-2000 • FAX: (702) 804-2289  
G:\764-085-013\dwg\impro\083-013-C-1.dwg

PULTE HOMES, INC.  
CHARLESTON BLM 10 ACRE - FULTON PARK  
COVER SHEET

DRAWING  
C-1  
1 OF 15 SHTS