

- CONSTRUCTION NOTES:**
- 1 LOCATE ALL UNDERGROUND UTILITIES BEFORE DIGGING. 1-800-227-2600
 - 2 INSTALL PULL BOXES AT EXISTING FINISH GRADE.
 - 3 MAINTAIN 18" MINIMUM COVER OVER DUCT IN DIRT BEHIND SIDEWALK. MAINTAIN 24" MINIMUM COVER OVER DUCT UNDER PROPOSED SIDEWALK. MAINTAIN 36" MINIMUM COVER OVER DUCT UNDER STREET.
 - 4 COMPACT BACKFILL IN THE STREET TO 95% AND COMPLY TO ALL CITY OF LAS VEGAS, COUNTY STANDARDS.
 - 5 PULL BOX - 15-3/4" x 25-1/4" x 12" OR 22-1/4" x 35-1/4" x 12"
 - 6 CONDUIT - PVC SCHEDULE 40
 - 7 REMOVE ONE SECTION OF SIDEWALK WHERE REQUIRED.
 - 8 PLACE TV PEDESTAL AT LOCATION SHOWN, TV-2400, CPH-1230, 1730 OR 2000 AS NOTED.
 - 9 REPLACE SIDEWALK AT EXISTING FINISH GRADE WHERE REQUIRED.
 - 10 BORE UNDER ALL CROSS GUTTERS.
 - 11 ALL LONGITUDINAL CUTS SHALL BE AT LIP OF GUTTER UNLESS OTHERWISE NOTED.

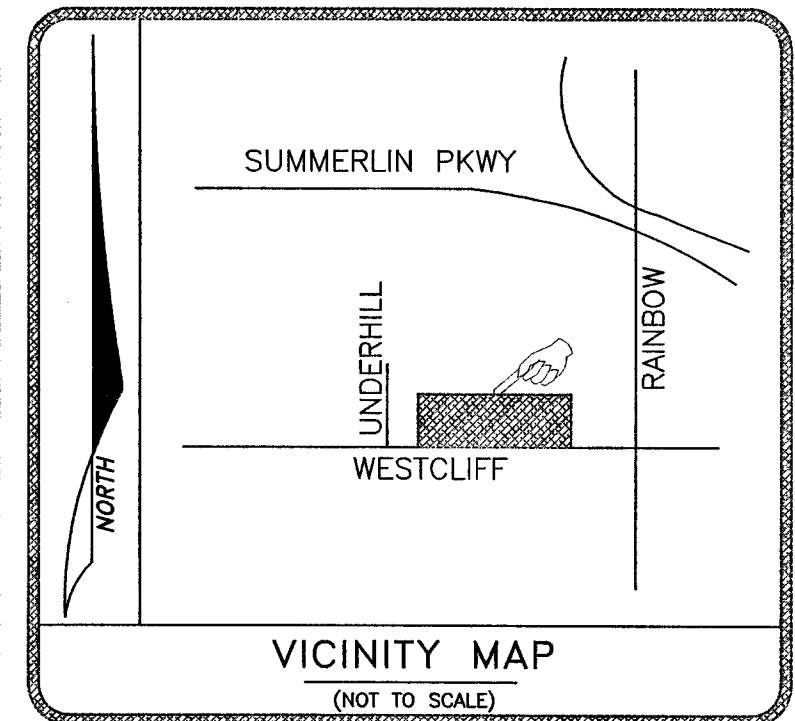

- LEGEND:**
- R&R SLAB OR POTHOLE
 - EXISTING PULL BOX
 - PROPOSED PULL BOX
 - ▲ EXISTING PEDESTAL
 - ▲ PROPOSED PEDESTAL
 - C-C- PROPOSED CONDUIT TRENCH
 - X-X- EXISTING CONDUIT
 - B-B- PROPOSED BORE
 - RIGHT-OF-WAY OR PROPERTY LINE
 - BACK OF CURB OR CURB FACE
 - ⊕ INTERSECTING CENTERLINE
- *OTHER ITEMS WILL BE CALLED OUT

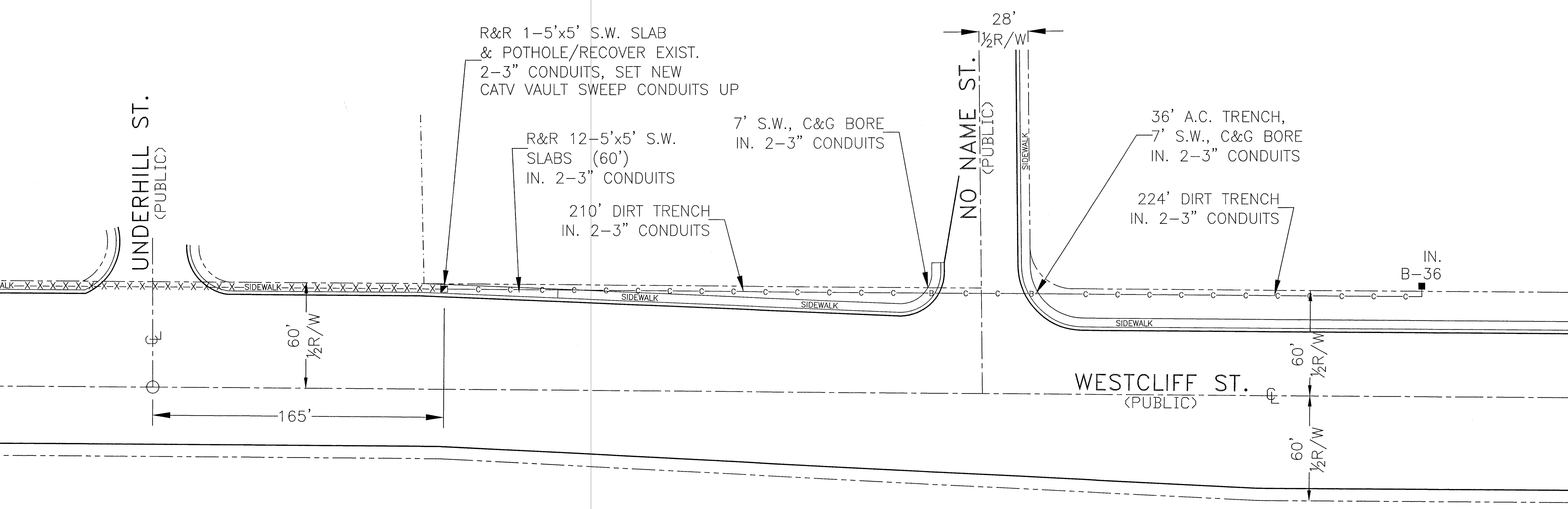

NOTE
 EXISTING UTILITY LOCATIONS SHOWN HEREIN ARE APPROXIMATE ONLY. IT SHALL BE THE CONTRACTOR'S RESPONSIBILITY TO DETERMINE THE EXACT VERTICAL AND HORIZONTAL LOCATION OF ALL EXISTING UNDERGROUND UTILITIES PRIOR TO COMMENCING CONSTRUCTION. NO REPRESENTATION IS MADE THAT ALL EXISTING UTILITIES ARE SHOWN HEREON. THE ENGINEER ASSUMES NO RESPONSIBILITY FOR UTILITIES NOT SHOWN OR UTILITIES NOT SHOWN IN THEIR PROPER LOCATION.

Government Approval Signature
 GOVERNMENT APPROVAL
 8/23/09
 DATE

Avoid cutting underground utility lines. It's costly.
 Call before you Dig.
 1-800-227-2600
 UNDERGROUND SERVICE ALERT (USA)

DRAFTING CONTACT: Jeremiah Bowles
 PHONE: (702) 384-8084 EXT.1159

TOTAL BORE	14'
TOTAL DIRT TRENCH	434'
TOTAL ASPHALT TRENCH	36'
TOTAL TRENCH	484'
SIDEWALK REMOVAL/REPAIR	
TOTAL S/W PANELS	13'
TOTAL LINEAR FOOTAGE	65'

PROJECT LOCATION/DESCRIPTION:
6900 WESTCLIFF

AREA:
City of LAS VEGAS

SCALE: 1"=30'
 DATE: 7-7-04 BY: JB
 TECH. # 512
 F.B.#
 DATE: BY: REVISIONS

APPROVED BY:
TERRY SOVEY

MAP #
BANK OF AMERICA 5640

PERMIT #
3349

CONTRACTOR: CLOVER COMMUNICATIONS

72646

10714094-COX