

A 37' STREET SECTION (INTERIOR)
PRIVATE STREET N.T.S.

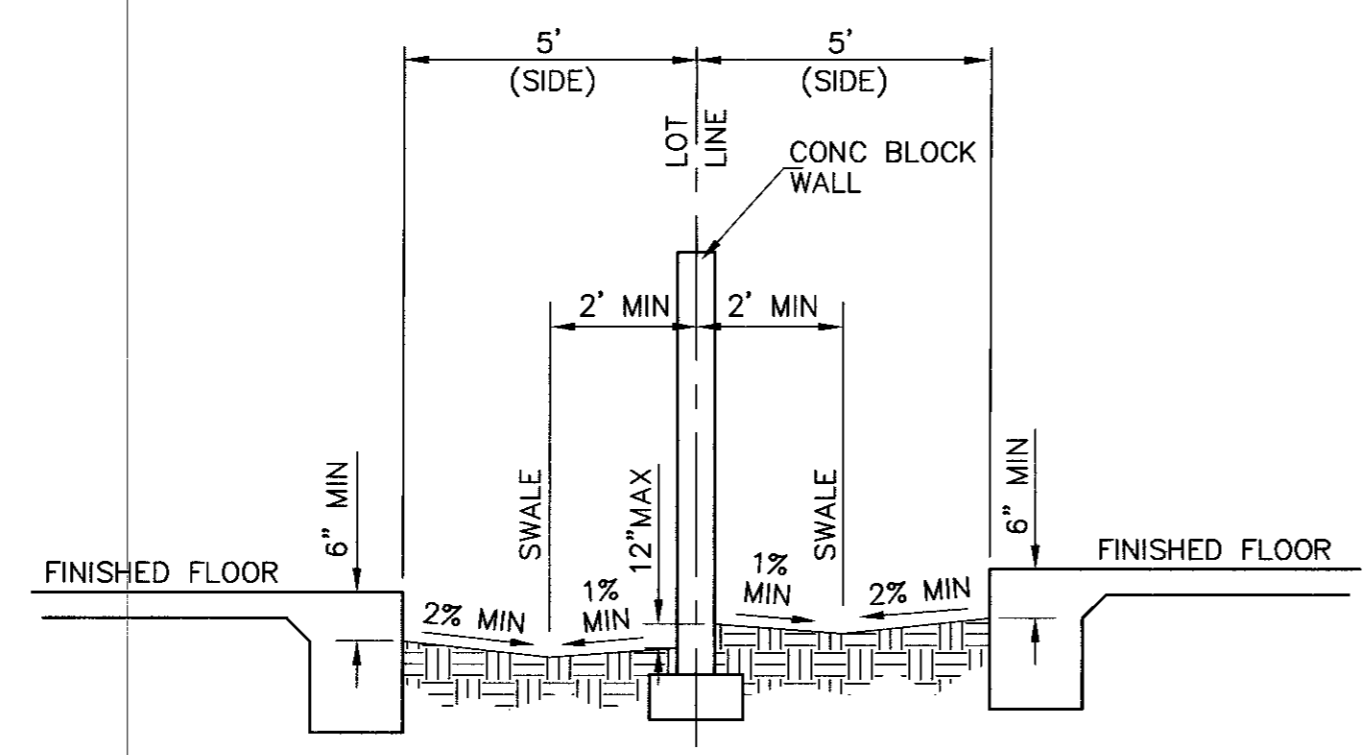

F SECTION
N.T.S.

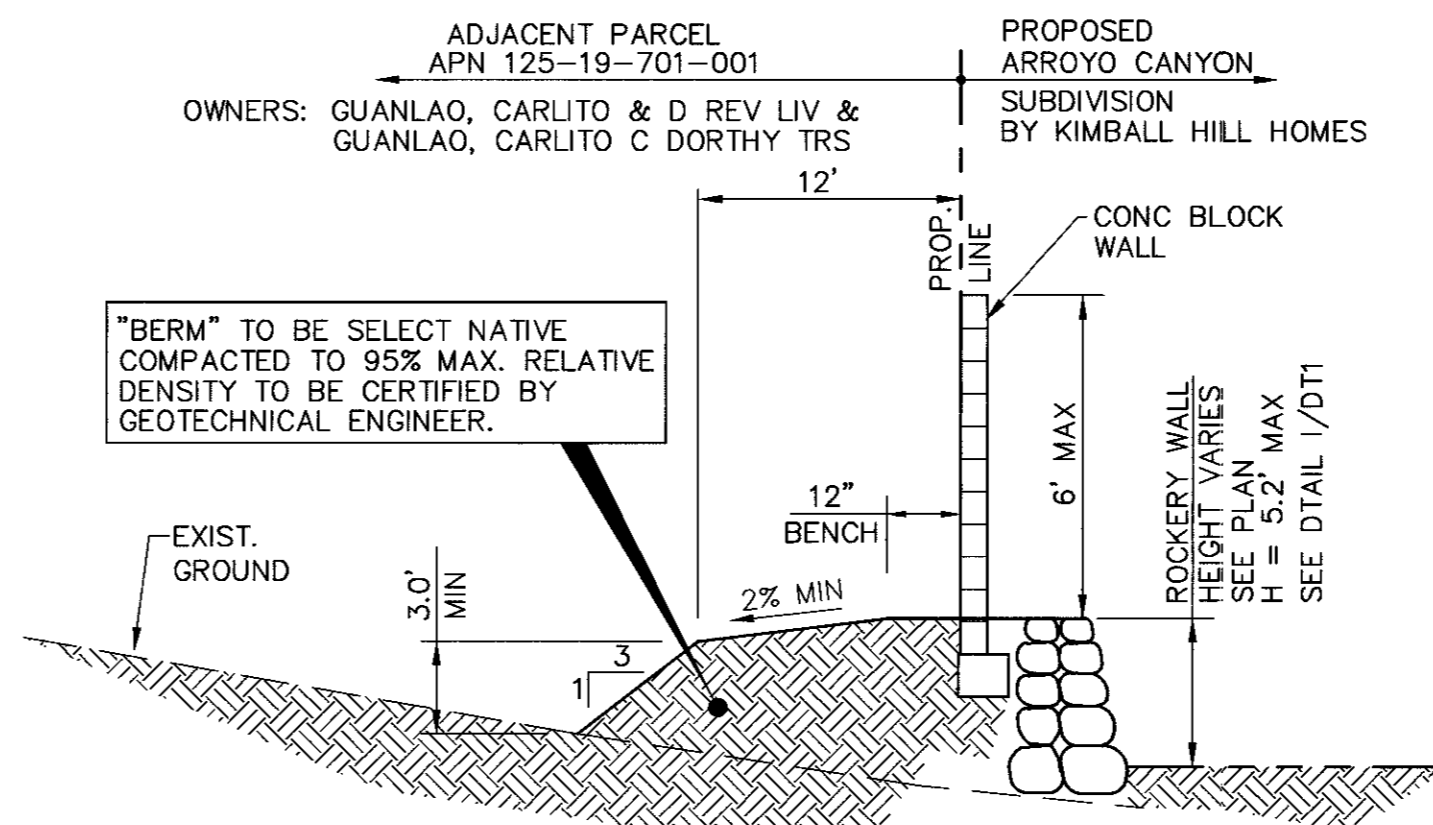

K SECTION
N.T.S.

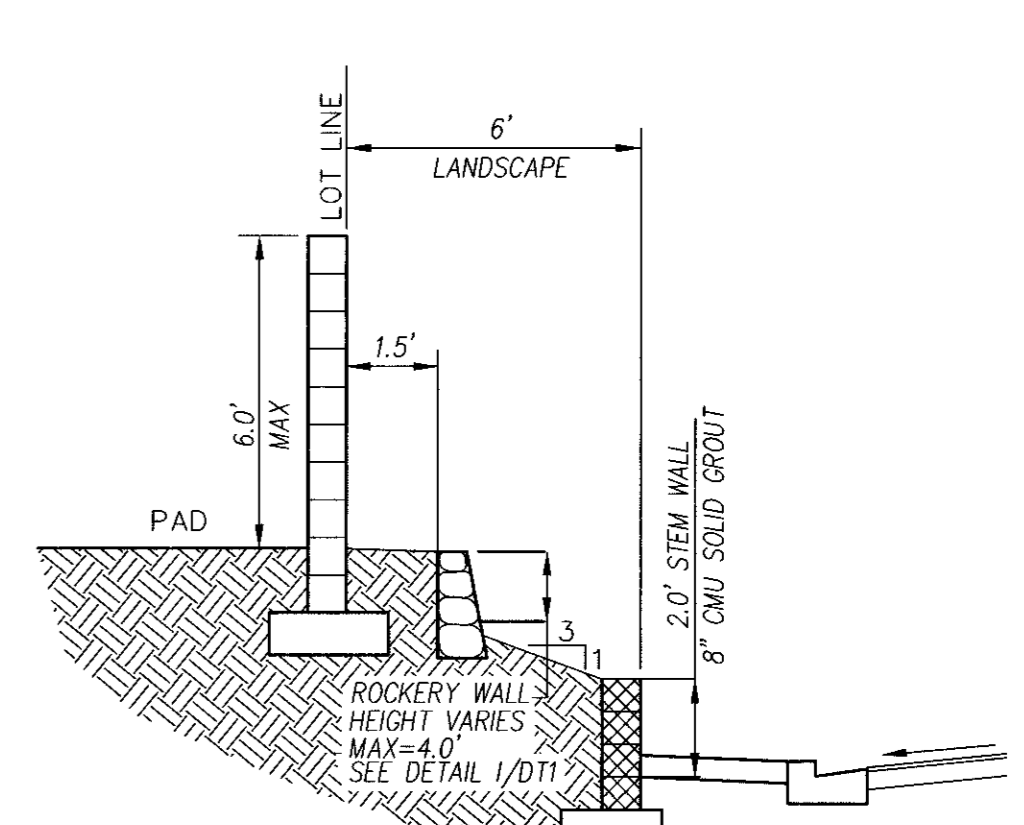

O SECTION
N.T.S.

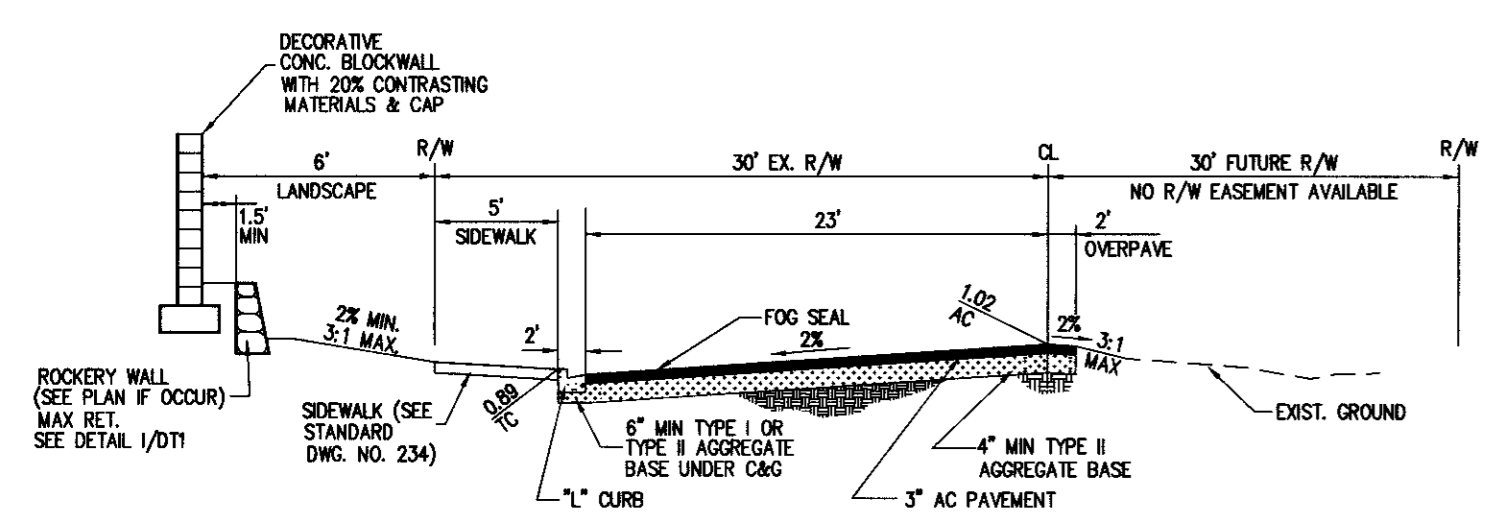

B 30' HALF STREET SECTION (BATH DRIVE)
PUBLIC STREET (RIGHT-OF-WAY EASEMENT NOT AVAILABLE SOUTH OF CENTERLINE) N.T.S.

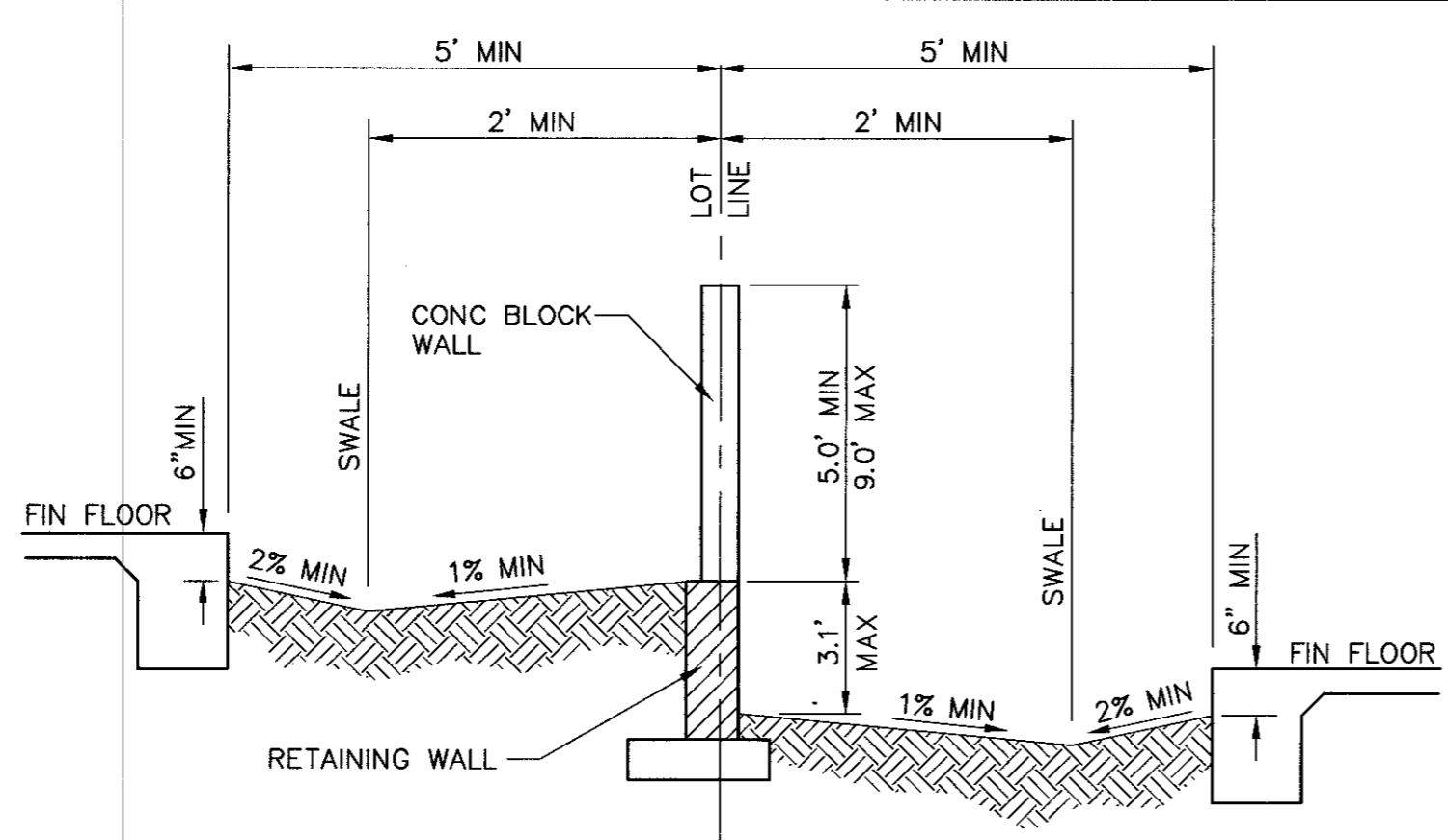

G SECTION
N.T.S.

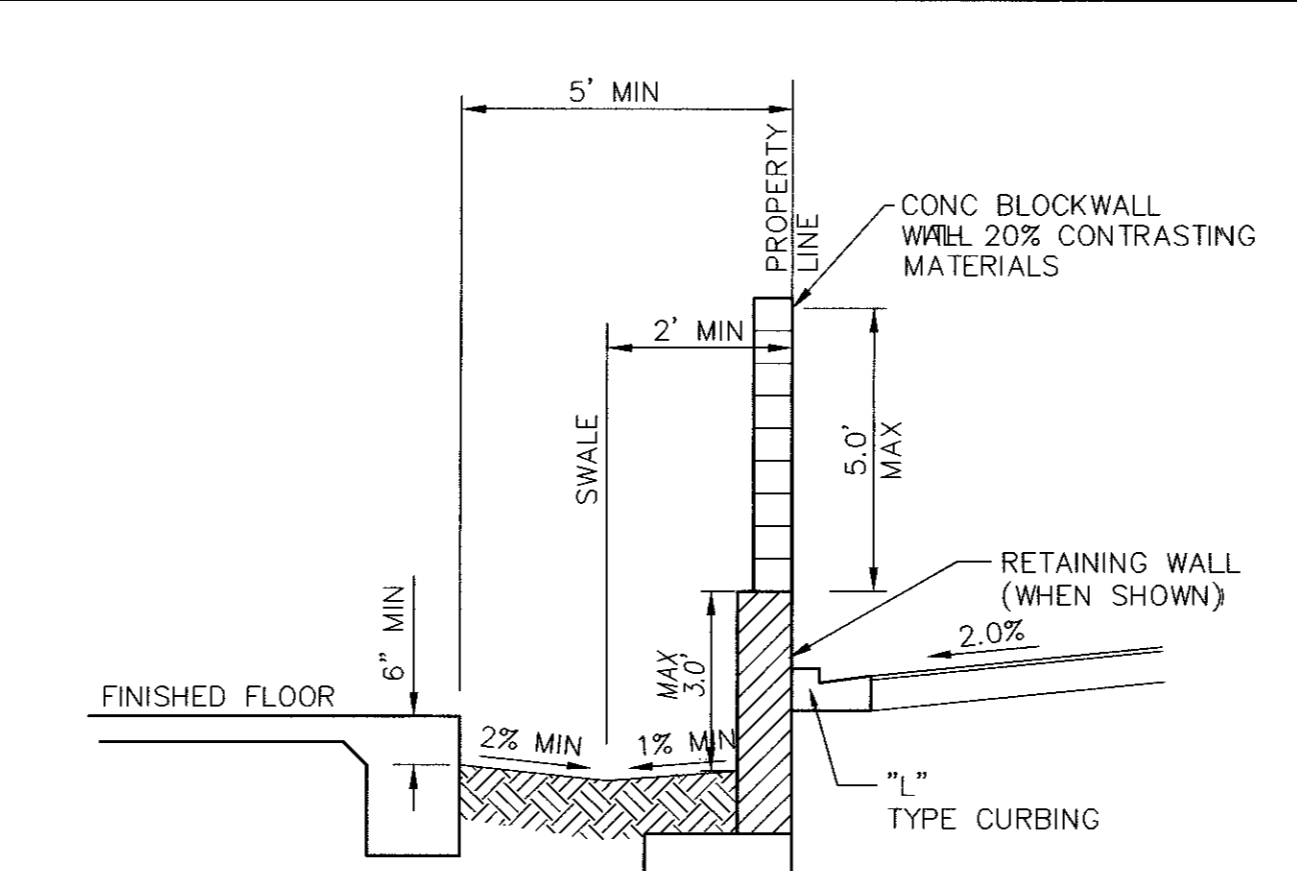

L SECTION
N.T.S.

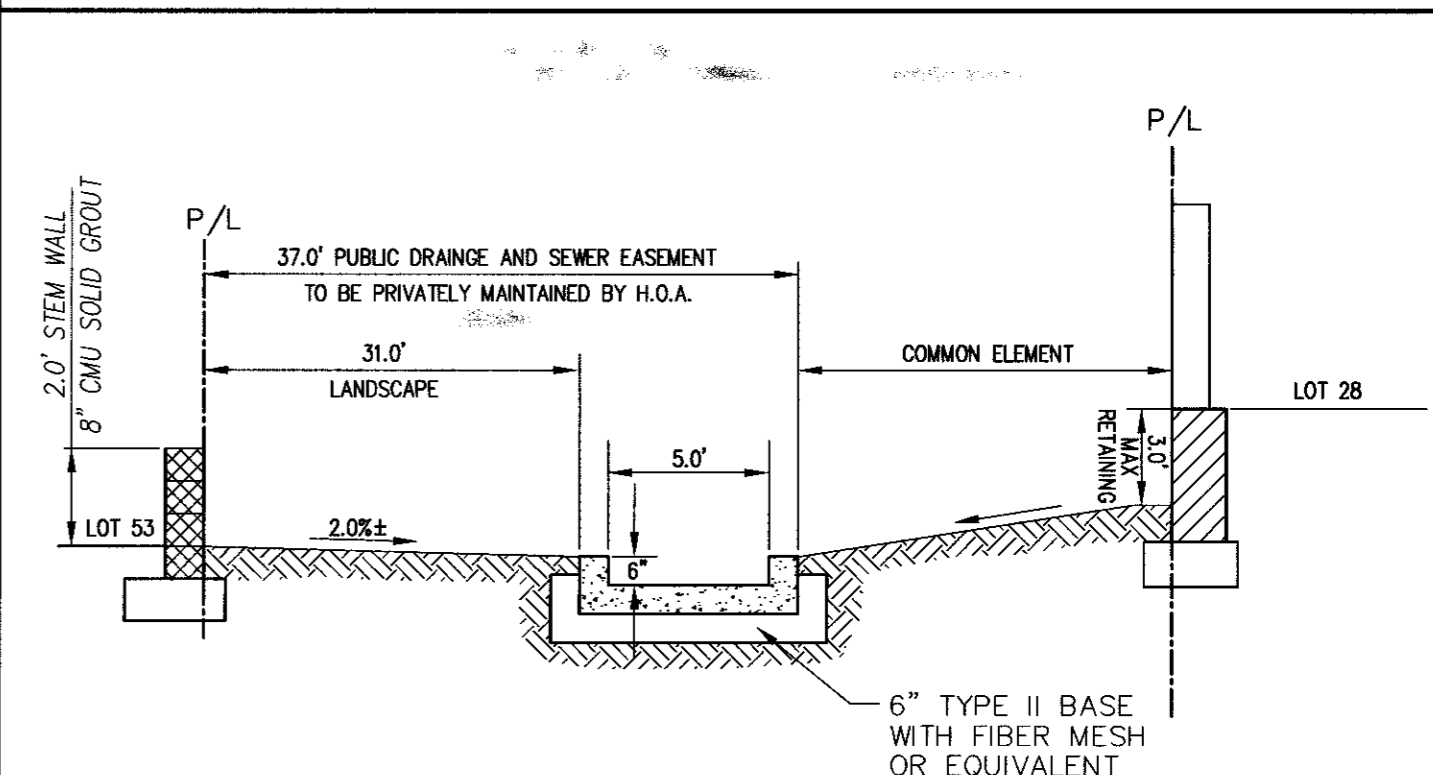

P SECTION
N.T.S.

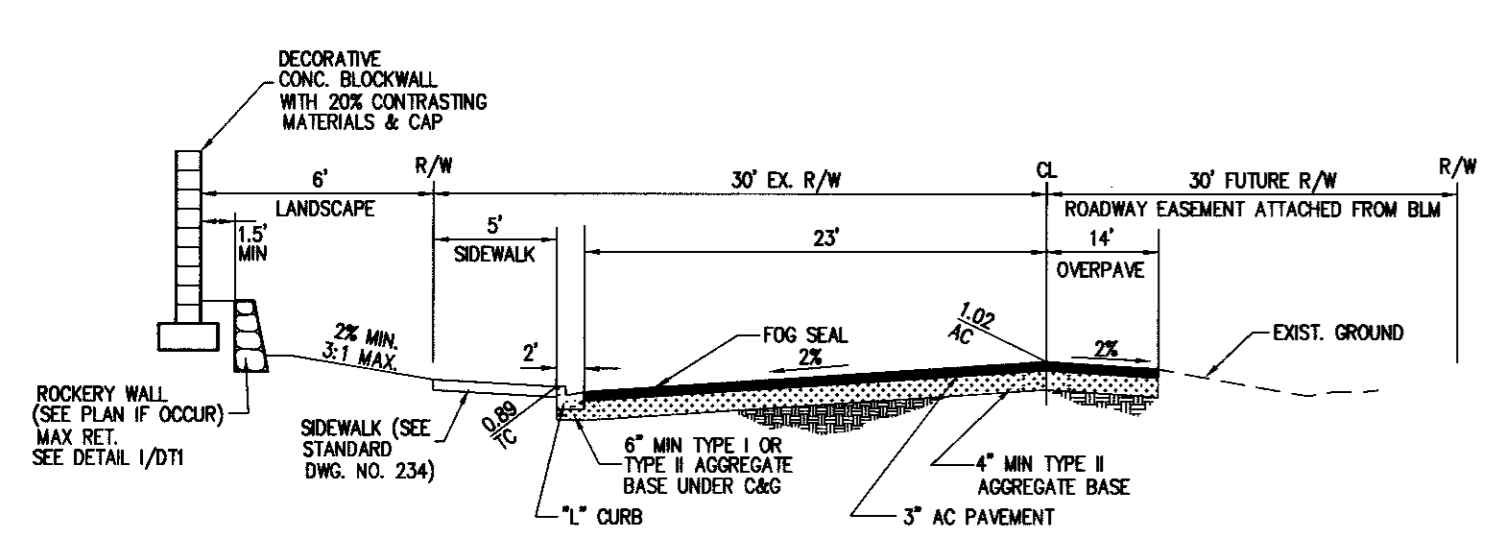

B 30' HALF STREET SECTION (BATH DRIVE)
PUBLIC STREET (ROADWAY EASEMENT ATTACHED FROM BLM) N.T.S.

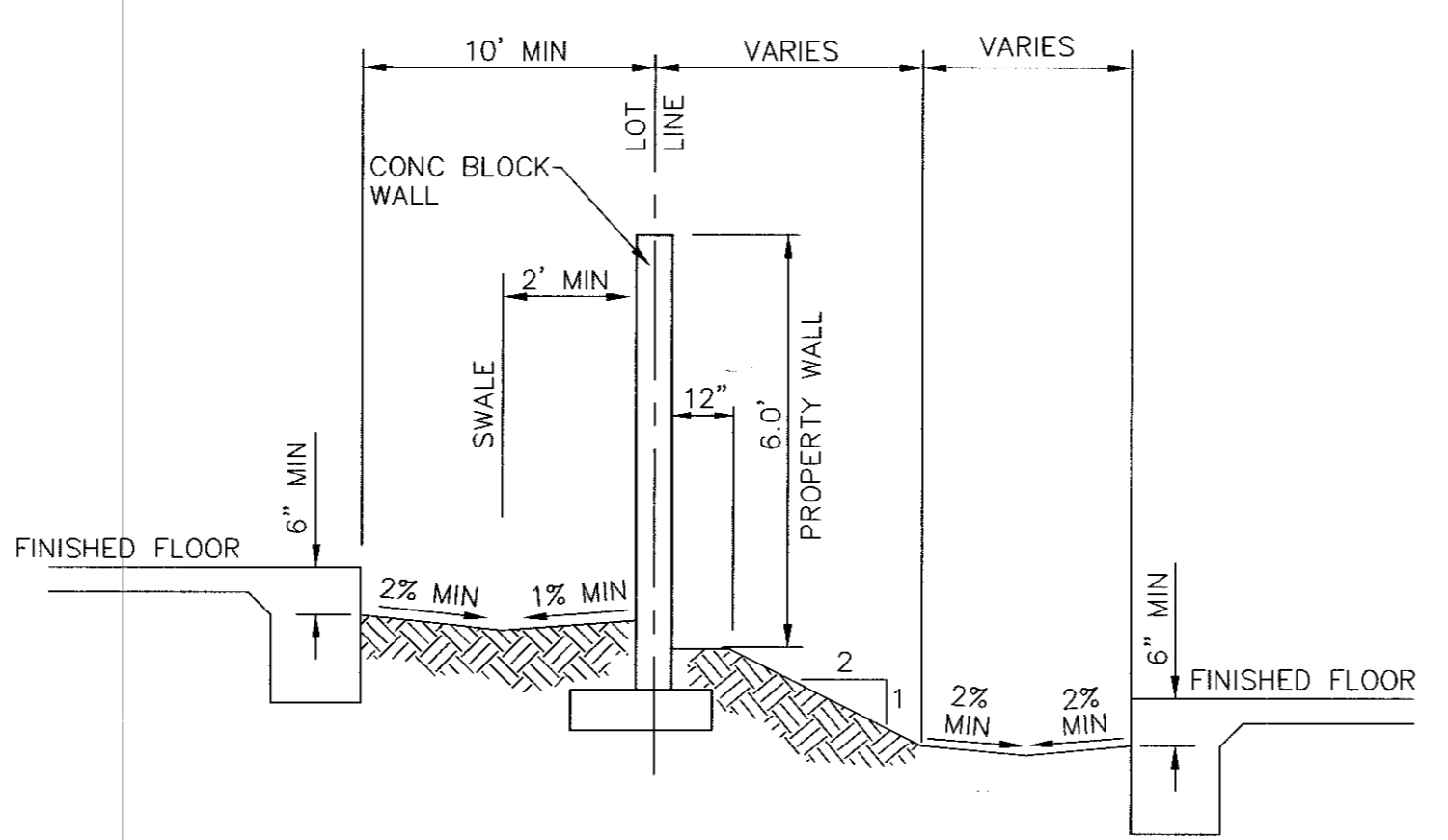

H SECTION
N.T.S.

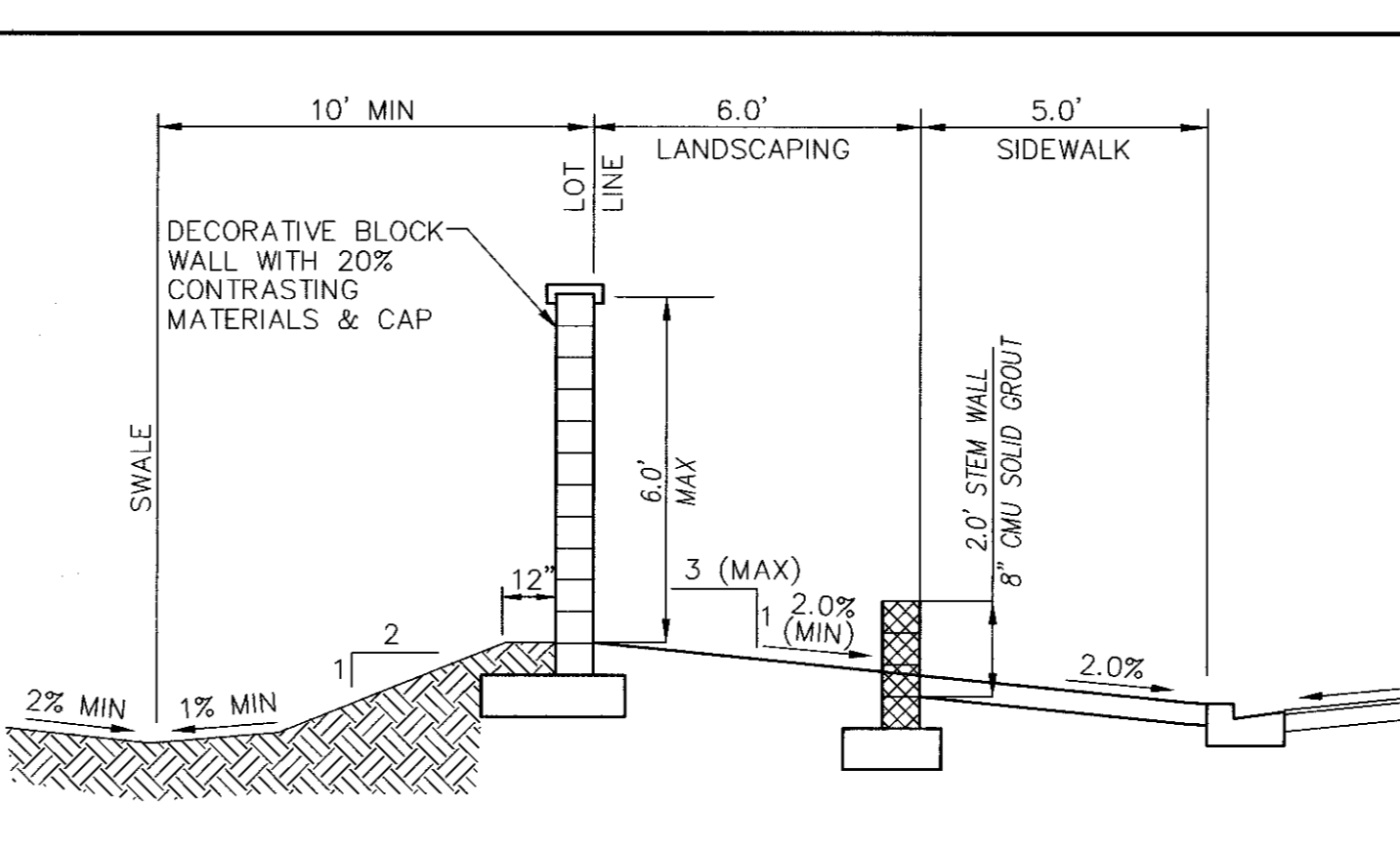

M SECTION
N.T.S.

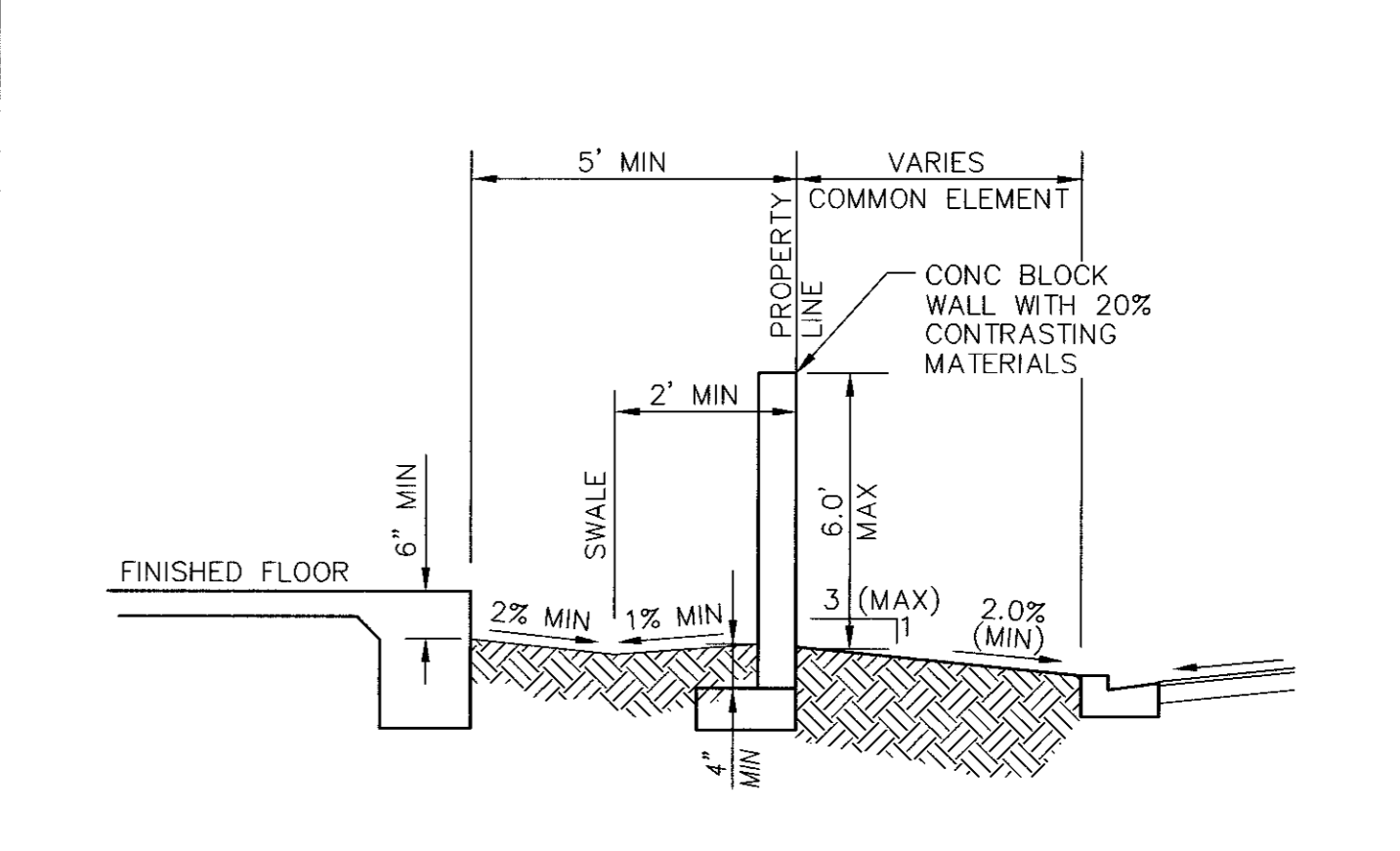

Q SECTION
N.T.S.

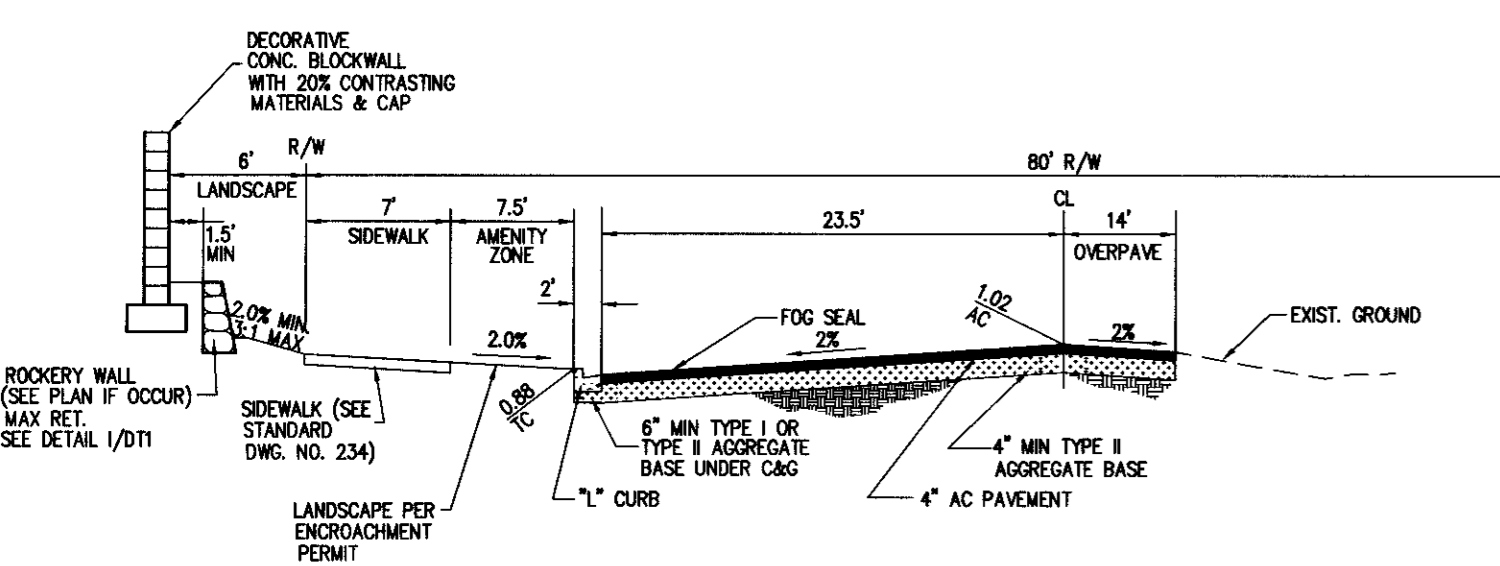

C 40' HALF STREET SECTION (TEE PEE LANE)
PUBLIC STREET N.T.S.

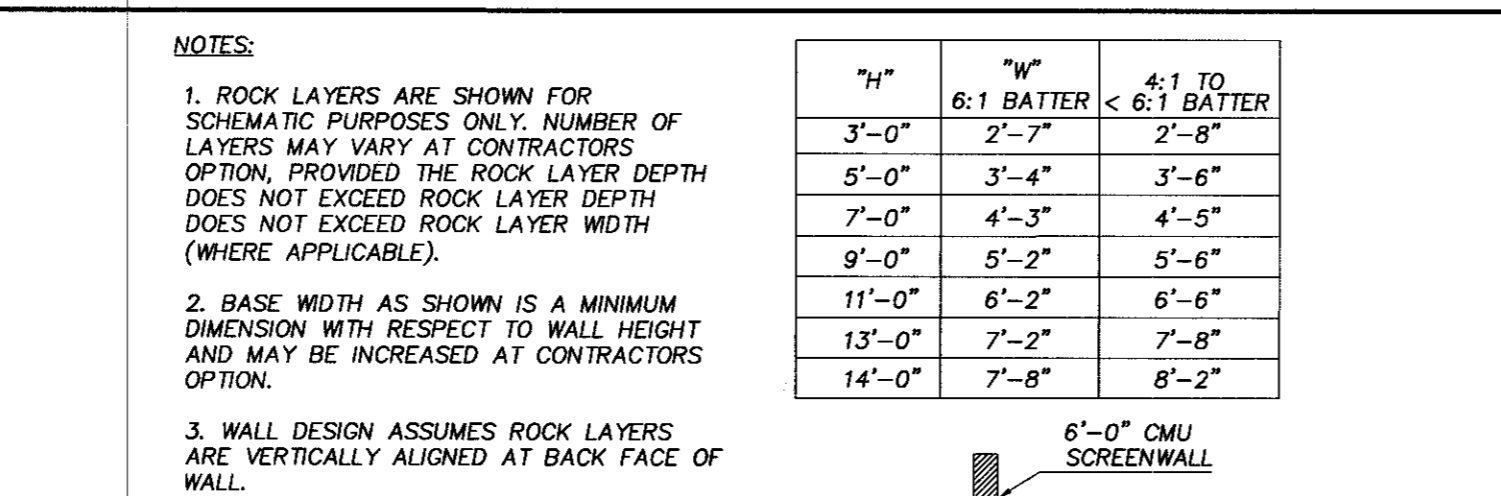

I ROCK RETAINING WALL
LEVEL BACKFILL W/ SCREENWALL-35 PCF N.T.S.

NOTES:

- ROCK LAYERS ARE SHOWN FOR SCHEMATIC PURPOSES ONLY. NUMBER OF LAYERS MAY VARY AT CONTRACTORS OPTION, PROVIDED THE ROCK LAYER DEPTH DOES NOT EXCEED ROCK LAYER WIDTH (WHERE APPLICABLE).
- BASE WIDTH AS SHOWN IS A MINIMUM DIMENSION WITH RESPECT TO WALL HEIGHT AND MAY BE INCREASED AT CONTRACTORS OPTION.
- WALL DESIGN ASSUMES ROCK LAYERS ARE VERTICALLY ALIGNED AT BACK FACE OF WALL.

"H"	"W"	4:1 TO 6:1 BATTER
3'-0"	2'-7"	2'-8"
5'-0"	3'-4"	3'-6"
7'-0"	4'-3"	4'-6"
9'-0"	5'-2"	5'-6"
11'-0"	6'-2"	6'-6"
13'-0"	7'-2"	7'-8"
14'-0"	7'-8"	8'-2"

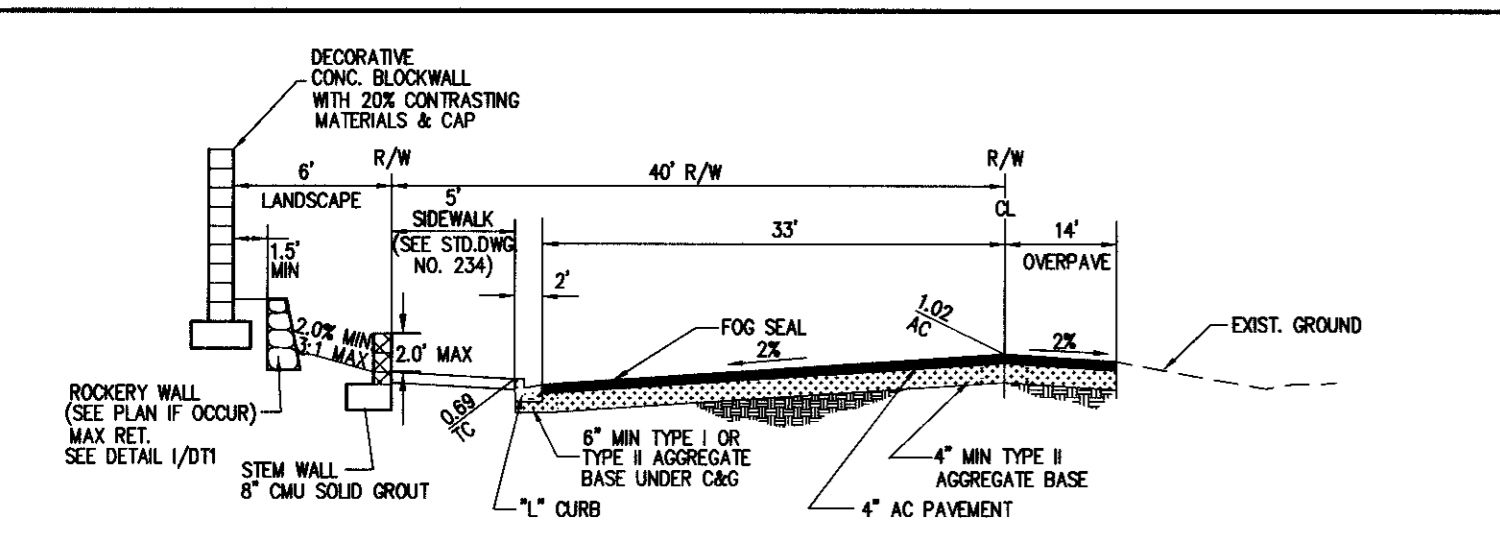

D 40' HALF STREET SECTION (DEER SPRINGS WAY)
PUBLIC STREET N.T.S.

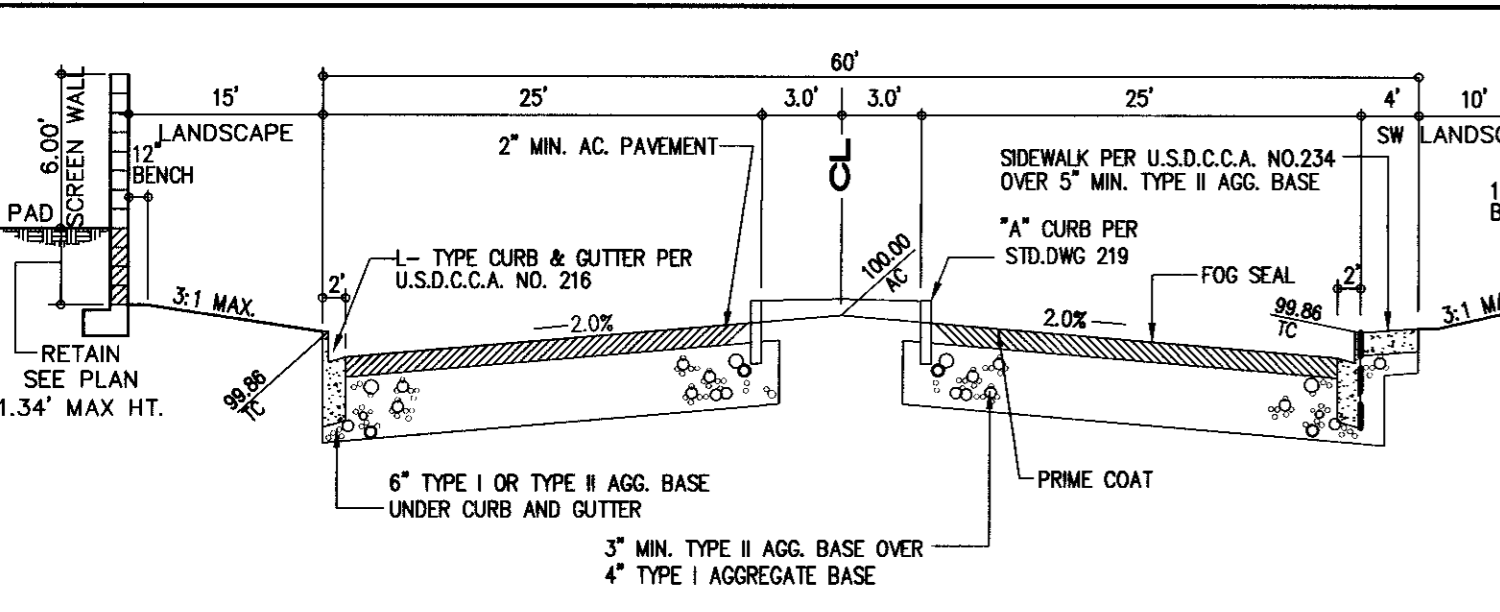

E 60' STREET SECTION (ENTRY)
PRIVATE STREET N.T.S.

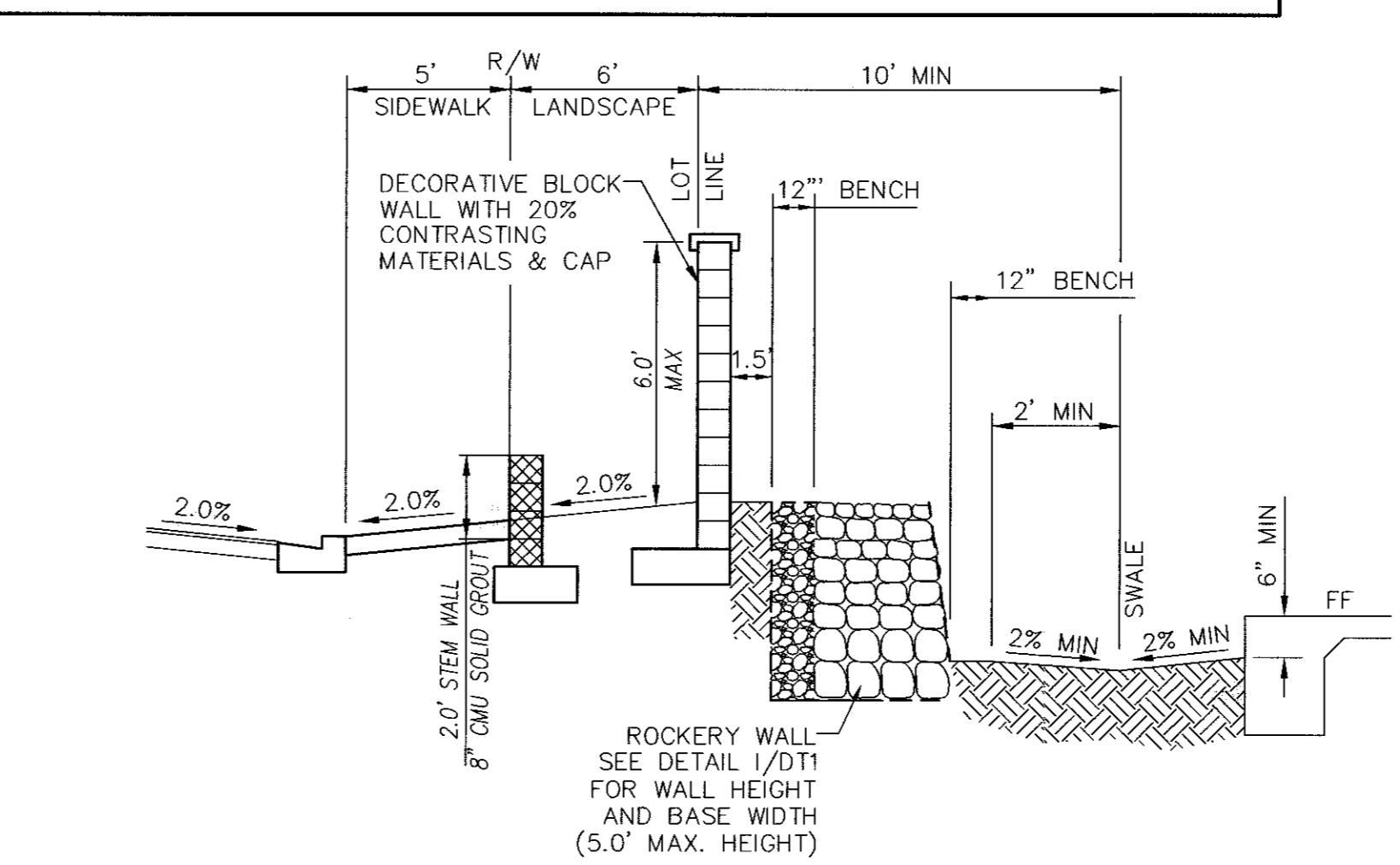

N SECTION
N.T.S. DEER SPRINGS WAY STA. 11+93.01- STA. 14+93.01

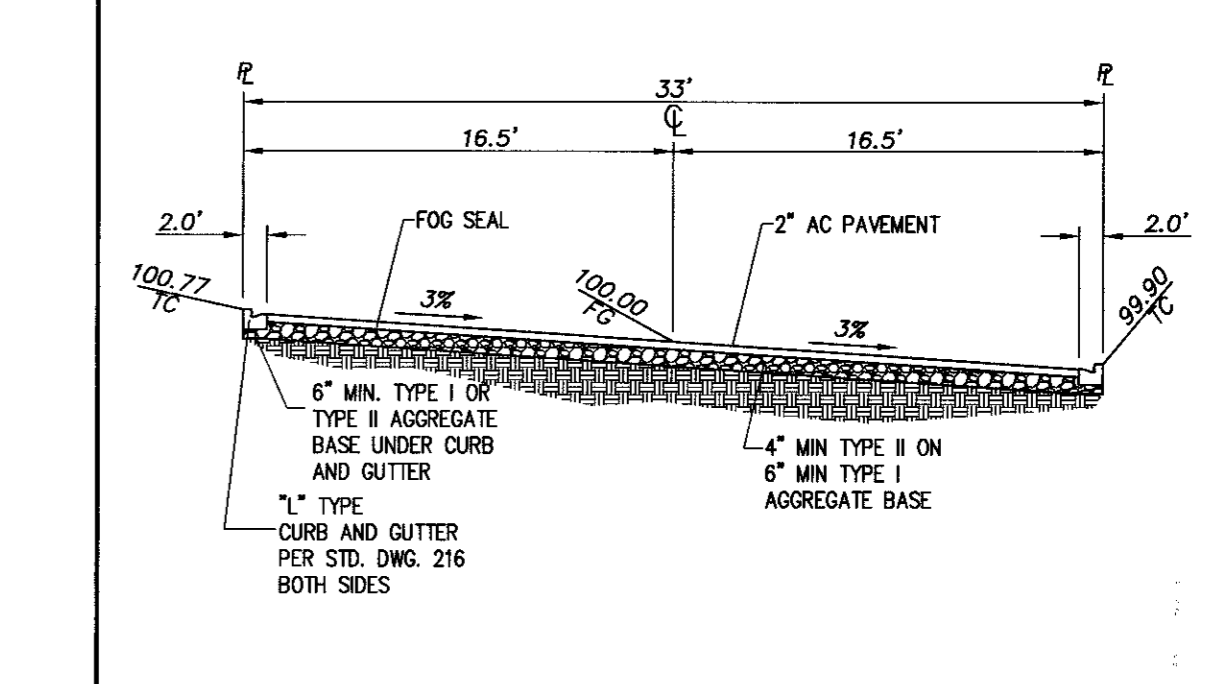

R 33' STREET SECTION (INTERIOR)
PRIVATE DRIVE N.T.S.

REV.	DATE	BY	REVISION

KIMBALL HILL HOMES
8 SUNSET WAY, SUITE 101
LAS VEGAS, NEVADA 89104
(702) 436-4582

TETRA TECH, INC.
I.L.P.R.A.S.T.R.U.C.T.U.R.E.S. & E.N.G.I.N.E.E.R.S.
401 N. BUFFALO DR., SUITE 100, LAS VEGAS, NEVADA 89145
(702) 436-4582

DETAILS AND SECTIONS

ARROYO CANYON
CITY OF LAS VEGAS

QUALITY CONTROL BY:	DESIGNED BY:	CHECKED BY:	SCALE:
SSS/KEA	SSS/KEA	SSS/KEA	

PROJECT NO. **P08719-0013**

SEAL

PROFESSIONAL ENGINEER
ANDREW ANDERSON
No. 6012
CIVIL

SHEET **DT1**
20 OF 21
DRAWING NO. **1074828**

71734