

PALISADES CIRCLE

SCALE: 1"=40' HORIZ.

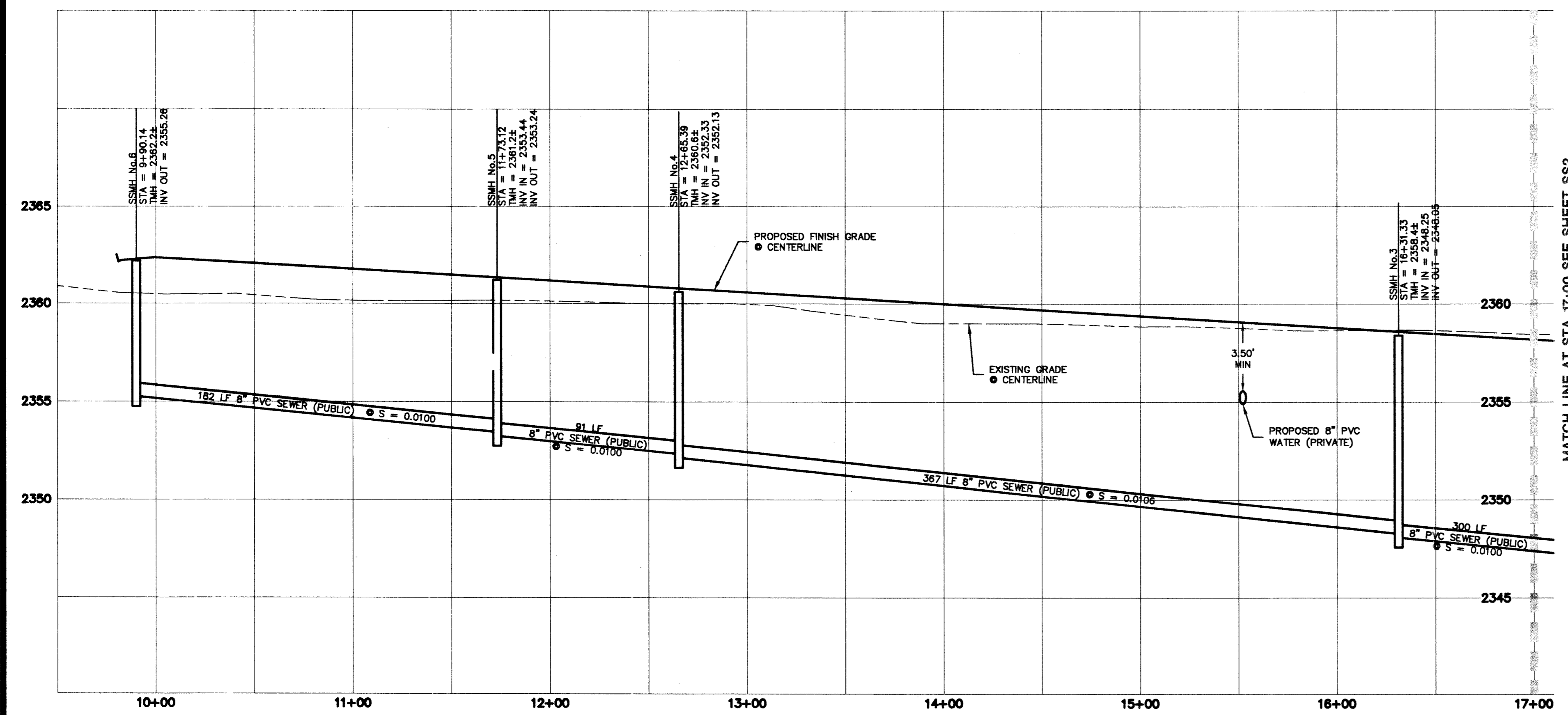

PALISADES CIRCLE

SCALE: 1"=40' HORIZ.
1"=4' VERT.

Call before you Overhead
1-702-593-6111

Call before you Dig
1-800-227-2800

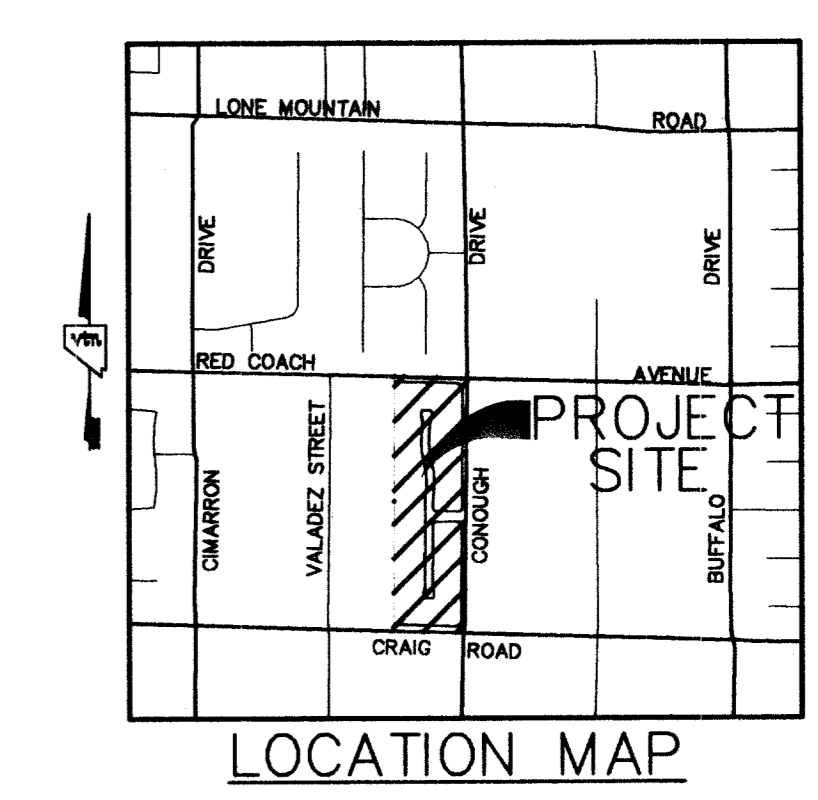
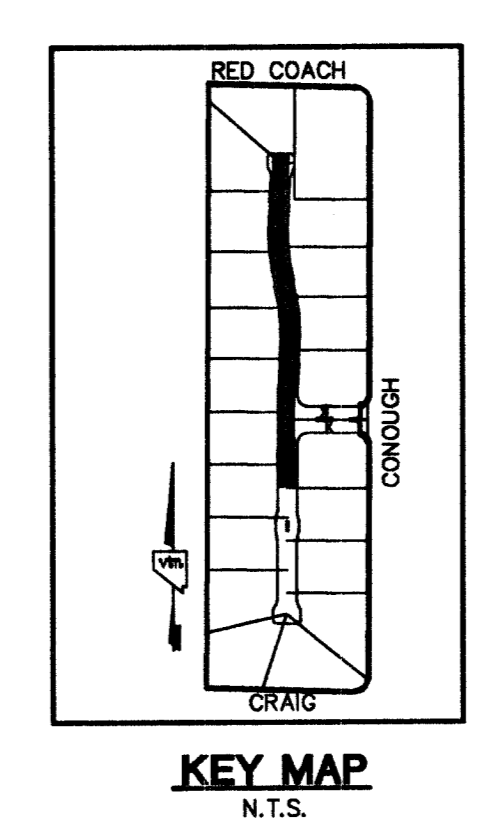

BENCHMARK
PROJECT DATUM: NORTH AMERICAN VERTICAL DATUM (NAVD88)
CITY OF LAS VEGAS BENCHMARK #BLV00-4E6
NAVD88 ELEVATION: 718.0830 METERS (2355.91 FEET)
RIVET AND PLATE IN CONCRETE CYLINDER AT SOUTHEAST CORNER OF CRAIG AND CONOUGH

BASIS OF BEARINGS
THE BASIS OF BEARINGS FOR THIS PROJECT IS NORTH 0019°04' EAST BEING EAST LINE OF THE SOUTHWEST QUARTER (SW 1/4) OF THE NORTHEAST QUARTER (NE 1/4) OF SECTION 4, TOWNSHIP 20 SOUTH, RANGE 60 EAST, M.D.M., CLARK COUNTY, NEVADA, AS SHOWN ON A FINAL MAP ON FILE IN THE CLARK COUNTY, NEVADA, RECORDER'S OFFICE IN FILE 9 AT PAGE 40.

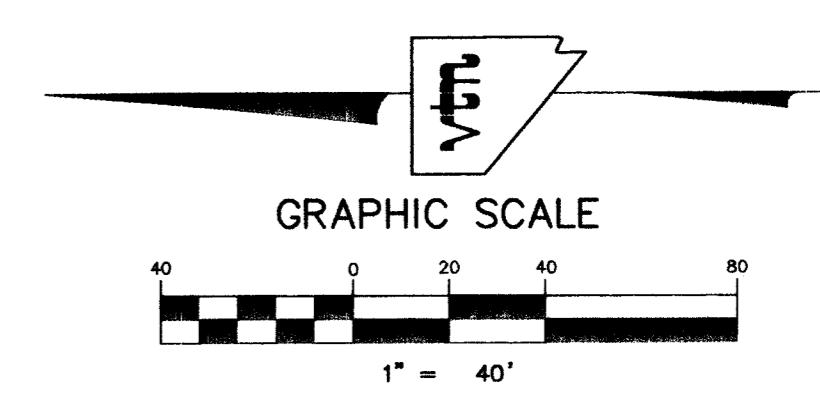

FOR ALL ADDITIONAL NOTES AND LEGEND / QUANTITIES SEE SHEET NO. UT1 OR UT2

SANITATION SEWER NOTE
1. ALL SEWER STATIONING IS BASED ON CENTER OF PIPE LENGTHS FROM MANHOLE TO MANHOLE AND IS NOT RELATIVE IN ANY WAY TO STREET CENTERLINE STATIONING. STREET CENTERLINE STATIONING IS SHOWN ON PLAN FOR ROAD REFERENCE ONLY.
2. ALL MANHOLES ARE 48" SIZED MANHOLES PER STD.DWG# SD-1, UNLESS OTHERWISE NOTED ON PLAN.

UTILITY NOTE
ALL SEWER/STORM DRAINS CROSSING WATER LINES MUST CONFORM TO SECTION 2.19 OF UNIFORM DESIGN AND CONSTRUCTION STANDARDS PER WATER DISTRIBUTION SYSTEMS (UDACS) FOR WATER AND STORM MAIN CROSSINGS AND CLEARANCES.

STREET NOTE
NOTE: ALL ONSITE DRIVES ARE COMMON LOTS, PUBLIC SEWER EASEMENTS & P.U.E. TO BE PRIVATELY OWNED & MAINTAINED.

PUBLIC WORKS UTILITY NOTES

- INSPECTIONS ARE REQUIRED. CALL 24 HOURS IN ADVANCE, 455-4610.
- PROPER SIGNS, BARRIERS, BARRICADES AND LIGHTS SHALL BE PLACED AND MAINTAINED IN ACCORDANCE WITH THE LATEST MANUAL ON UNIFORM TRAFFIC CONTROL DEVICES FOR STREETS AND HIGHWAYS.
- THIS PLAN DOES NOT AUTHORIZE CLOSURE OF ANY ROAD OR STREET.
- TRAFFIC, SCHOOL, OR STREET SIGNS OF ANY KIND ARE NOT TO BE MOVED FOR ANY REASON WITHOUT FIRST OBTAINING PERMISSION FROM THE DEPARTMENT OF PUBLIC WORKS, TRAFFIC MANAGEMENT DIVISION.
- ALL WORK AUTHORIZED BY THIS PLAN SHALL CONFORM TO THE UNIFORM STANDARD SPECIFICATIONS AND STANDARD DRAWINGS, CLARK COUNTY AREA, NEVADA AND CLARK COUNTY SUPPLEMENT TO UNIFORM STANDARD DRAWINGS AND SPECIFICATIONS, LATEST REVISIONS.
- NO OPEN TRENCH SHALL BE ALLOWED ACROSS ANY STREET OR WITHIN TEN FEET (10) OF ANY TRAVEL-WAY, EXCEPT WHEN WORK IS IN ACTUAL PROGRESS. AREAS COVERED BY ACCEPTABLE STEEL PLATES ARE NOT TO BE CONSTRUCTED AS A TRENCH. NO OPEN TRENCH PERMITTED IN EXCESS OF 500 FEET OR LENGTH NECESSARY TO ACCOMMODATE PIPE INSTALLATION IN A SINGLE DAY, WHICHEVER IS GREATER.
- A TEMPORARY PATCH IS TO BE IN PLACE AT THE END OF EACH WORK DAY WHERE THE BACK FILL IN THE TRENCH HAS BEEN COMPLETED AND PRIOR TO OPENING THE WORK AREA BACK TO TRAFFIC AND IS TO BE MAINTAINED BY THE PERMITTEE. A PERMANENT PATCH IS TO BE IN PLACE WITHIN THIRTY (30) DAYS AFTER THE INSTALLATION OF THE TEMPORARY PATCH.
- COMPACTION TESTS ARE REQUIRED.
- YOUR PERMIT, APPROVED PLANS, AND BARRICADE PLAN FOR THIS WORK MUST BE ON THE JOB SITE AT ALL TIMES.
- ALL TRENCH CROSSINGS AND BACK FILL SHALL MEET THE STANDARD SPECIFICATIONS UNLESS OTHERWISE STATED.

LAS VEGAS VALLEY WATER DISTRICT STANDARD NOTES

- NO WORK SHALL BEGIN UNTIL THE WATER PLANS HAVE BEEN RELEASED FOR CONSTRUCTION BY THE LVVWD FOLLOWING WATER PLAN APPROVAL. 48 HOUR NOTICE SHALL BE GIVEN TO THE LVVWD COMMUNICATION SUPPORT CENTER (258-7171) PRIOR TO THE START OF CONSTRUCTION. NOTICE MUST BE GIVEN BY THE WORK AREA BACK TO TRAFFIC AND IS TO BE MAINTAINED BY THE PERMITTEE. A PERMANENT PATCH IS TO BE IN PLACE WITHIN THIRTY (30) DAYS AFTER THE INSTALLATION OF THE TEMPORARY PATCH.
- ALL WORK SHALL CONFORM TO THE LVVWD'S STANDARD PLATES, DRAWINGS, AND SPECIFICATIONS, AND THE UNIFORM DESIGN AND CONSTRUCTION STANDARDS FOR WATER DISTRIBUTION SYSTEMS (UDACS), LATEST EDITION.
- ALL WORK, EXCEPT AS MODIFIED BY THESE PLANS OR BY NOTE 2, SHALL BE DONE IN ACCORDANCE WITH THE MOST CURRENT DRAFT OR EDITION OF THE UNIFORM STANDARD SPECIFICATIONS FOR PUBLIC WORKS CONSTRUCTION OFF SITE IMPROVEMENTS, CLARK COUNTY AREA.
- A SINGLE PIPE MATERIAL SHALL BE USED THROUGHOUT THE PROJECT UNLESS OTHERWISE APPROVED BY THE LVVWD.
- ALL SERVICE LATERALS TWO (2) INCHES IN DIAMETER AND SMALLER SHALL BE COPPER TUBING WITH LVVWD APPROVED SERVICE SADDLES.
- ALL WATER METER BOXES SHALL BE LOCATED OUTSIDE OF DRIVEWAY AREAS.
- ALL VALVES SHALL BE LOCATED OUTSIDE OF DRIVEWAYS, VALLEY AND CURB GUTTERS.
- THE FOLLOWING REQUIREMENTS MUST BE MET IN THE EVENT A WATER LINE AND A SANITARY OR STORM SEWER LINE CROSS:
A. MINIMUM EIGHTEEN (18) INCH VERTICAL SEPARATION (OUTSIDE TO OUTSIDE) MUST BE MAINTAINED WHEN THE WATER LINE IS INSTALLED OVER THE SANITARY OR STORM SEWER LINE. IF THE VERTICAL SEPARATION CANNOT BE MAINTAINED OR THE WATER LINE MUST BE PLACED UNDER THE SANITARY OR STORM SEWER LINE, THE SANITARY OR STORM SEWER LINE MUST BE CONSTRUCTED WITH ONE OF THE FOLLOWING OR, AS SHOWN ON THESE PLANS:
A. POTABLE WATER SUPPLY QUALITY MATERIAL.
B. ENCASEMENT, WITH FOUR (4) INCH CONCRETE (MINIMUM)
C. SLEEVING WITH POTABLE WATER SUPPLY QUALITY PIPE.
EACH PROVISION MUST EXTEND ALONG THE SANITARY OR STORM SEWER, ON EITHER SIDE OF THE MAIN, A MINIMUM 10 FOOT DISTANCE PERPENDICULAR TO THE WATER MAIN EXTERIOR.
D. WARNING TAPE SHALL BE REQUIRED OVER ALL MAINS. ALL SIX (6) INCH DIAMETER AND LARGER SERVICE LATERALS, AND ANY SERVICE LATERAL NOT INSTALLED PERPENDICULAR TO THE MAIN IN ACCORDANCE WITH STANDARD PLATE NO. 27.
- ALL WATER FACILITIES SHALL BE FILLED, DISINFECTED, PRESSURE TESTED, FLUSHED, FILLED AND AN ACCEPTABLE WATER SAMPLE OBTAINED PRIOR TO CONNECTION TO THE LVVWD'S DISTRIBUTION SYSTEM.
- THE CONTRACTOR MUST OBTAIN ALL METERS TWO (2) INCHES AND SMALLER FROM LVVWD CENTRAL STORES. TELEPHONE 258-3152 FORTY-EIGHT (48) HOURS PRIOR TO PICKUP.
- CONSTRUCTION MAY INTERRUPT SERVICE, WITH LVVWD APPROVAL AND PROPER NOTIFICATION, BETWEEN THE HOURS OF 10 PM AND 5 AM, SUNDAY THROUGH THURSDAY. CIRCUMSTANCES MAY REQUIRE TEMPORARY SERVICE FEEDS BE INSTALLED, WITHOUT LVVWD REIMBURSEMENT. ANY TEMPORARY SERVICE FEED MUST HAVE PRIOR LVVWD APPROVAL.
- ALL WATER FACILITY CONSTRUCTION MATERIALS USED MUST BE AS LISTED ON THE LVVWD'S PRE-APPROVED MATERIALS AND MANUFACTURERS LISTING FOR NEW FACILITIES, LATEST REVISION, OR SPECIFICALLY APPROVED ON THESE PLANS.

ENGINEER DISCLAIMER NOTE

UTILITY LOCATIONS SHOWN HEREON ARE APPROXIMATE ONLY. IT SHALL BE THE CONTRACTOR'S RESPONSIBILITY TO DETERMINE THE EXACT HORIZONTAL AND VERTICAL LOCATION OF ALL EXISTING UNDERGROUND AND OVERHEAD UTILITIES AND NOTIFY THE DESIGN ENGINEER IMMEDIATELY OF ANY DISCREPANCIES PRIOR TO COMMENCING CONSTRUCTION.
NO REPRESENTATION IS MADE THAT ALL EXISTING UTILITIES ARE SHOWN HEREON. THE ENGINEER ASSUMES NO RESPONSIBILITY FOR UTILITIES NOT SHOWN OR UTILITIES NOT SHOWN IN THEIR PROPER LOCATION.

D & S DEVELOPMENT L L C
CLARK COUNTY, NEVADA
3638 N. RANCHO DR. LAS VEGAS, NEVADA 89130-3168
(702) 382-0586

CLARK COUNTY, NEVADA

SEWER PLAN AND PROFILE
CONOUGH / CRAIG

DRAWN BY: JMM DEC. 2003
DESIGNED BY: JMM DEC. 2003
CHECKED BY: IKJ DEC. 2003
PROJECT NO: 6202

SCALE: 1"=40' HORIZ.
1"=4' VERT.

HTE# 04-15163

307 V 874 CLV #7120

70248

H:\6202\6202SS.DWG (BR-SS1)