

CONOUGH LANE PLAN (60' PUBLIC RW)

SCALE: 1"=40' HORIZ.

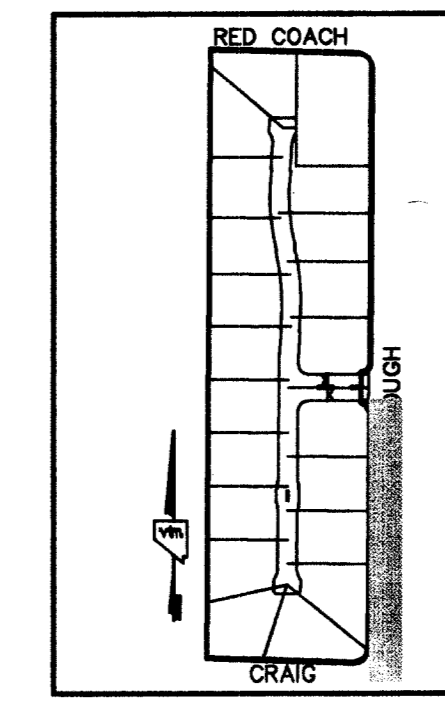

KEY MAP
N.T.S.

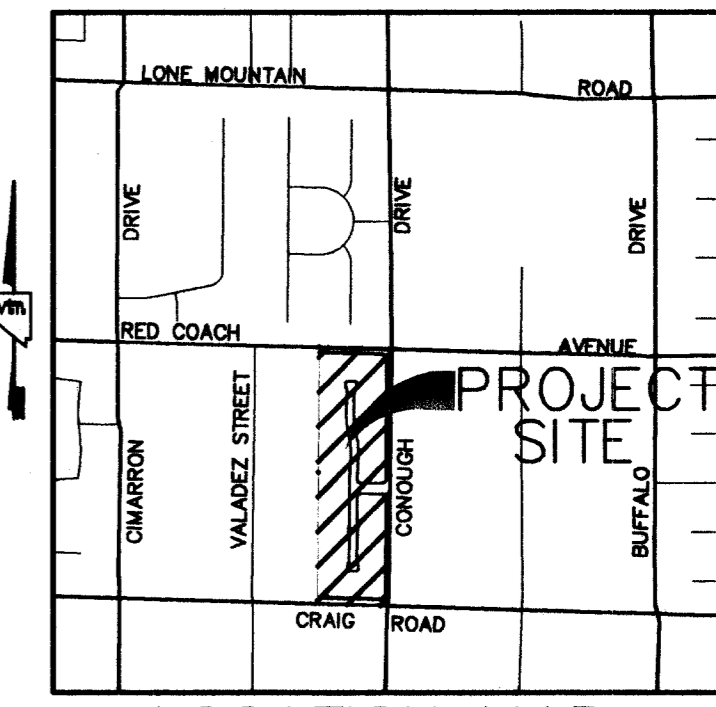

LOCATION MAP

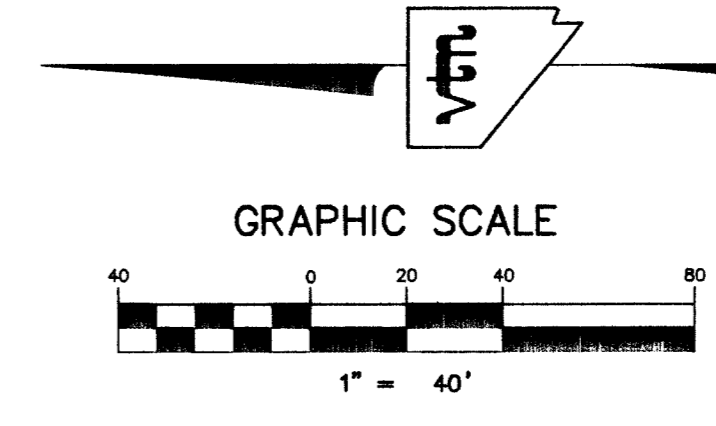

BENCHMARK
PROJECT DATUM: NORTH AMERICAN VERTICAL DATUM (NAVD83)
CITY OF LAS VEGAS BENCHMARK #BLV00-466
NAVD83 ELEVATION: 718.0830 METERS (2355.91 FEET)
RIVET AND PLATE IN CONCRETE CYLINDER AT SOUTHEAST CORNER OF CRAIG AND CONOUGH

BASIS OF BEARINGS
THE BASIS OF BEARINGS FOR THIS PROJECT IS NORTH 00°19'04" EAST BEING EAST LINE OF THE SOUTHWEST QUARTER (SW 1/4) OF THE NORTHEAST QUARTER (NE 1/4) OF SECTION 4, TOWNSHIP 20 SOUTH, RANGE 60 EAST, W.D.M., CLARK COUNTY, NEVADA, AS SHOWN ON A FINAL MAP ON FILE IN THE CLARK COUNTY, NEVADA, RECORDER'S OFFICE IN FILE 9 AT PAGE 40.

Call before you Dig
1-800-227-2600

Call before you Overhead
1-702-593-6111

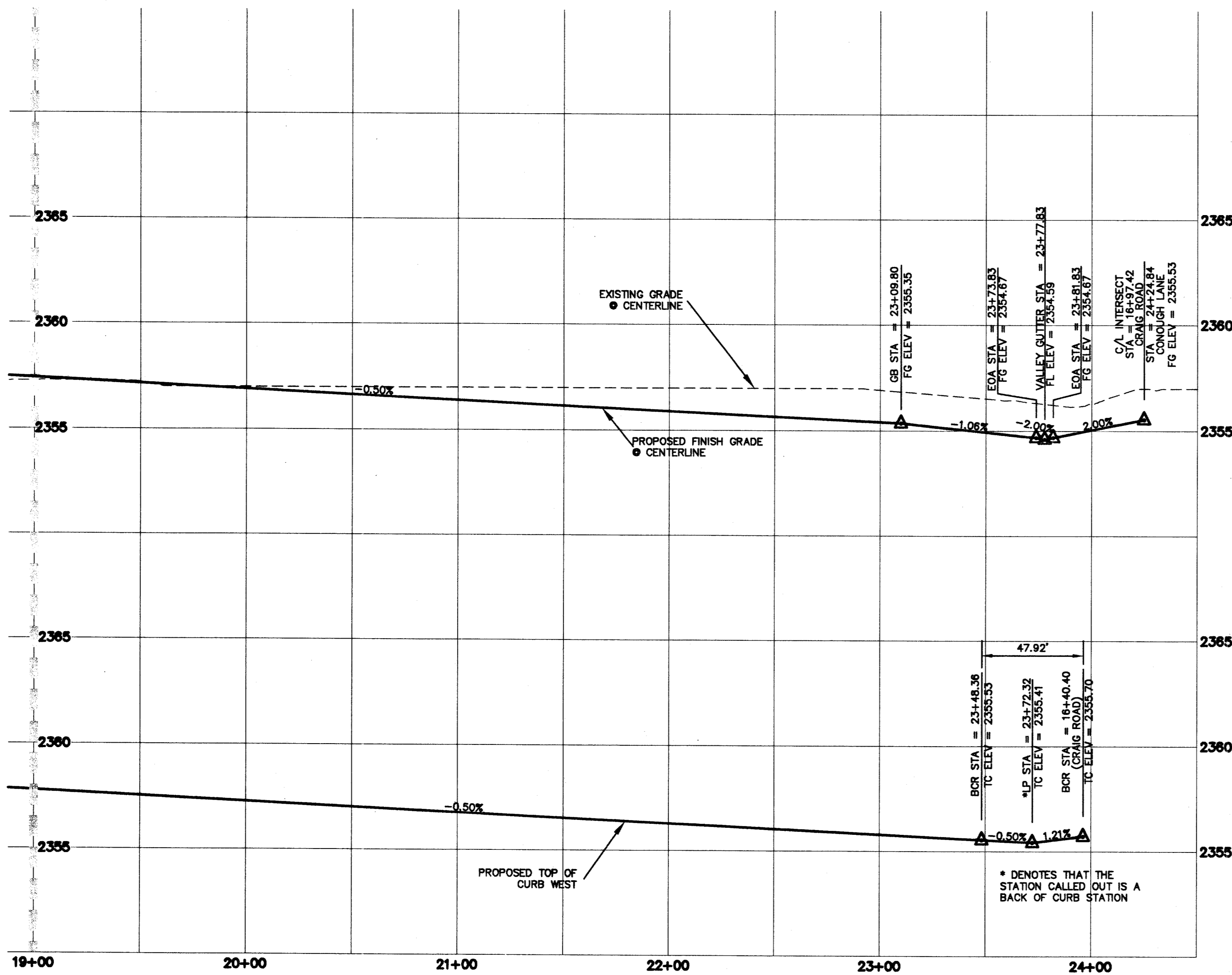

CONOUGH LANE PROFILE (60' PUBLIC RW)

SCALE: 1"=40' HORIZ.
1"=4' VERT.

- CONSTRUCTION KEY NOTES**
(PER U.S.D.C.C.A. STANDARD DRAWINGS)
- (A) CONSTRUCT "L" CURB & GUTTER PER STD. # 216
 - (B) CONSTRUCT "A" ISLAND CURB PER STD. # 219
 - (C) CONSTRUCT SIDEWALK PER STD. # 234
 - (D) CONSTRUCT "ROLL" CURB & GUTTER PER STD. # 217A
 - (E) CONSTRUCT 8" CROSS GUTTER PER STD. # 228
 - (F) CONSTRUCT 2' SIDEWALK UNDER DRAIN PER SHEET DET 236
 - (G) CONSTRUCT DEPRESSURE CURB PER SHEET DET 1 "O"
 - (H) CUT & MATCH 2' BEYOND EXIST. A.C.
 - (I) CONSTRUCT 10' CURB TYPE TRANSITION PER SHEET DET 1 "P"
 - (J) CONSTRUCT 4' X 16" DRAINAGE OPENING IN BLOCK WALL PER SHEET DET 1 "J" & "K"
 - (K) CONSTRUCT REMOVABLE BOLLARDS PER SHEET DET 1 "L"
 - (L) CONSTRUCT CONCRETE "U" CHANNEL PER SHEET DET 1 "J" & "L"
 - (M) CONSTRUCT SIDEWALK RAMP USING ARMOR TILE TRUNCATED DOMES OR EQUIVALENT PER CCAUSD # 235 CASE 1
 - (N) CONSTRUCT RESIDENTIAL DRIVEWAY PER STD. # 222A & 225
 - (O) CONSTRUCT 6' HIGH IRON GATE PER SHEET DET 1 "F" & "G"
 - (P) CONSTRUCT CHANNEL STEM WALL SEE SHEET DET 1 "M"
 - (Q) CONSTRUCT DRIVEWAY WITH MIN. LENGTH OF 25'
 - (R) CONSTRUCT DRIVEWAY WITH MIN. LENGTH OF 36'
 - (S) CONSTRUCT DRIVEWAY WITH MIN. LENGTH OF 60'
 - (T) CONSTRUCT 8" CROSS GUTTER PER STD. # 229
 - (U) CONSTRUCT RESIDENTIAL DRIVEWAY PER STD. # 222 & 223

LEGEND

FG FINISH GRADE	EX. CONTOUR(5' INTERVAL)
FL FLOW LINE	EX. CONTOUR(1' INTERVAL)
TC TOP OF CURB	PROPOSED CONTOUR
TRC TOP OF ROLL CURB	PROPOSED PAD GRADE
EAC EDGE OF ASPHALT PAVEMENT	FUT./EXIST. PAD GRADE
FUT. FUTURE	SLOPE AND FLOW DIRECTION
EXIST. EXISTING (EX.)	EDGE OF EXIST. A.C.
NG NATURAL GROUND	SAW CUT & MATCH A.C.
H.P. HIGH POINT	SIDEWALK RAMP
L.P. LOW POINT	PAD SWALE SLOPES
C/L CENTER LINE	SCARP AREA
O/C OFFSET CROWN	LOT NUMBER
BC BACK OF CURB	BLOCK NUMBER
BCR BEGIN CURB RETURN	RETAINING HEIGHT (FEET)
TF TOP OF FOOTING	SIGHT VISIBILITY ZONES
GB GRADE BREAK	PROJECT BOUNDARY LINE
PC POINT OF CURVATURE	SETBACK LINE
PRC POINT OF REVERSE CURVATURE	R/W OR P/L
PCC POINT OF COMPOUND CURVATURE	EXIST. IMPROVEMENTS
BVC BEGIN VERTICAL CURVE	FUTURE IMPROVEMENTS
MVC MID-POINT OF VERTICAL CURVE	CENTER LINE
EVC END VERTICAL CURVE	RETAINING WALL
PRVC POINT OF REVERSE VERTICAL CURVE	CONC. BLOCK WALL
VPI VERTICAL POINT OF INTERSECTION	EXIST. CONC. BLOCK WALL
TPW TOP OF PLANTER WALL	EXIST. DIRT ROAD
TRW TOP OF RETAINMENT WALL	EXIST. AC
TOP TOP OF CHANNEL/SCARP	CONSTRUCTION PHASE LINE
TOE TOP OF CHANNEL/SCARP	OR UNIT BOUNDARY LINE
TOB TOP OF BOX	MATCHLINE
PP POWER POLE	SAW CUT MATCH & REPLACE EXIST. ASPHALT
TRANS. TRANSITION	
RET. RETAINMENT	
INT. INTERSECTION	
D.G. DESIGN GRADE	
TSW TOP OF SIDEWALK	
FF FINISH FLOOR	
GF GARAGE FINISH FLOOR	
BFE BASE FLOOD ELEVATION	
R/W RIGHT-OF-WAY	
S/W SIDEWALK	

LINE TABLE

LINE	LENGTH	BEARING
L34	490.86	S00°19'04"W

CURVE TABLE

CURVE	LENGTH	RADIUS	TANGENT	DELTA
C39	31.40	20.00	89°57'34"	19.99
C40	47.92	30.00	91°31'14"	30.81

ENGINEER DISCLAIMER NOTE:
UTILITY LOCATIONS SHOWN HEREON ARE APPROXIMATE ONLY. IT SHALL BE THE CONTRACTOR'S RESPONSIBILITY TO DETERMINE THE EXACT HORIZONTAL AND VERTICAL LOCATION OF ALL EXISTING UNDERGROUND AND OVERHEAD UTILITIES AND NOTIFY THE DESIGN ENGINEER IMMEDIATELY OF ANY DISCREPANCIES PRIOR TO COMMENCING CONSTRUCTION.
NOTE: Power poles and/or other existing facilities not in proper location based on proposed improvements shown hereon will be relocated at no expense to Clark County.

CLARK COUNTY DEVELOPMENT SERVICES DEPARTMENT OF CIVIL ENGINEERING

Acceptance of plans for filing
By: _____
I, _____, Engineer, do hereby certify that the above is a true and correct copy of the original plans as filed for filing.

D&S DEVELOPMENT
3638 N. RANCHO DRIVE
CLARK COUNTY, NEVADA
(702) 382-0566

CONOUGH / CRAIG

DRAWN BY: JMM 6-4-03
DESIGNED BY: JMM 6-4-03
CHECKED BY: DEN 6-4-03
PROJECT NO: 04-17-181
SCALE: 1"=40' HORIZ.
1"=4' VERT.

HTe 04-15163

70246

\\2002\2020251.dwg (ST-5)