

PALISADES CANYON CIRCLE PLAN (PRIVATE STREET)
SCALE: 1"=40' HORIZ.

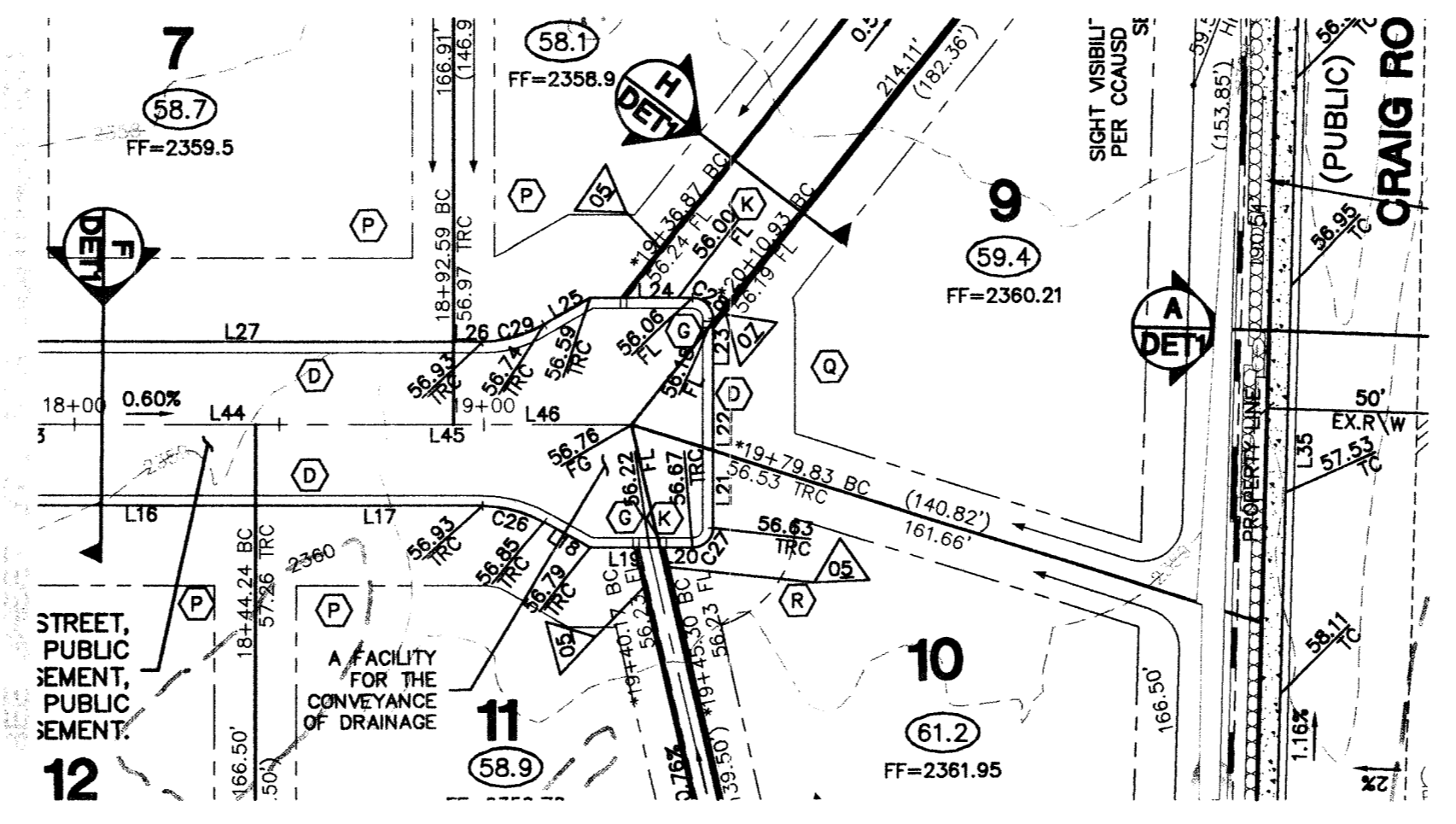

PALISADES CANYON CIRCLE PLAN (PRIVATE STREET)
SCALE: 1"=40' HORIZ.

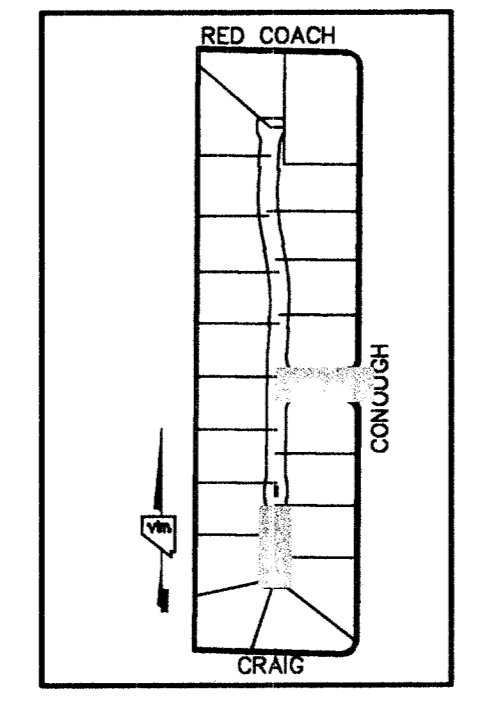

KEY MAP
N.T.S.

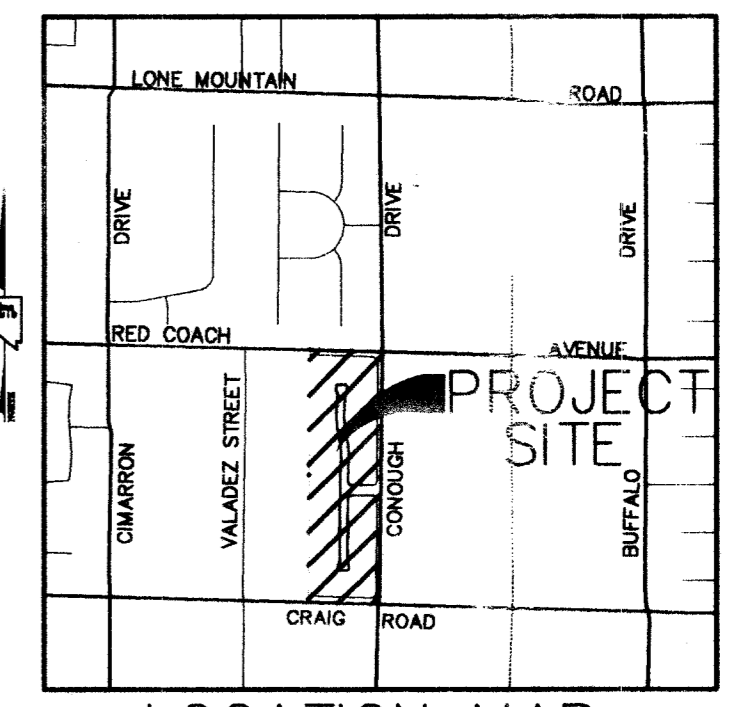

LOCATION MAP

BENCHMARK
PROJECT DATUM: NORTH AMERICAN VERTICAL DATUM (NAVD88)
CITY OF LAS VEGAS BENCHMARK #8100 466
NAVD88 ELEVATION: 718.0830 METERS (2355.91 FEET)
RIVET AND PLATE IN CONCRETE CURB AT SOUTHEAST CORNER OF CRAIG AND CONOUGH

BASIS OF BEARINGS
THE BASIS OF BEARINGS FOR THIS PROJECT IS NORTH 00°19'04" EAST BEING EAST LINE OF THE SOUTHWEST QUARTER (SW 1/4) OF THE NORTHEAST QUARTER (NE 1/4) OF SECTION 4, TOWNSHIP 20 SOUTH, RANGE 60 EAST, M.D.M., CLARK COUNTY, NEVADA, AS SHOWN ON A FINAL MAP ON FILE IN THE CLARK COUNTY, NEVADA, RECORDER'S OFFICE IN FILE 9 AT PAGE 40.

ENGINEER DISCLAIMER NOTE
UTILITY LOCATIONS SHOWN HERON ARE APPROXIMATE ONLY. IT SHALL BE THE CONTRACTOR'S RESPONSIBILITY TO DETERMINE THE EXACT HORIZONTAL AND VERTICAL LOCATION OF ALL EXISTING UNDERGROUND AND OVERHEAD UTILITIES AND NOTIFY THE DESIGN ENGINEER IMMEDIATELY OF ANY DISCREPANCIES PRIOR TO COMMENCING CONSTRUCTION.
NO REPRESENTATION IS MADE THAT ALL EXISTING UTILITIES ARE SHOWN HERON. THE ENGINEER ASSUMES NO RESPONSIBILITY FOR UTILITIES NOT SHOWN OR UTILITIES NOT SHOWN IN THEIR PROPER LOCATION.

Call before you Dig
1-800-227-2600

Call before you Overhead
1-702-593-6111

LINE TABLE

LINE	LENGTH	BEARING
L1	11.63	N89°38'30"W
L16	60.68	S00°21'30"E
L17	55.54	S00°21'30"E
L18	12.96	S30°21'30"W
L19	17.10	S00°21'30"W
L20	7.90	S00°21'30"E
L21	19.17	S89°38'30"E
L22	31.09	S89°38'30"E
L23	0.74	S89°38'30"E
L24	25.00	N00°21'30"E
L25	12.96	N29°38'30"W
L26	7.19	N00°21'30"E
L27	109.07	N00°21'30"E
L31	111.63	S89°38'30"E
L44	109.07	S00°21'30"W
L45	91.91	S00°21'30"W
L46	43.56	S00°21'30"W
L47	196.66	S89°38'30"E

CURVE TABLE

CURVE	LENGTH	RADIUS	TANGENT	DELTA
C1	31.42	20.00	90°00'00"	20.00
C26	15.71	30.00	30°00'00"	8.04
C27	7.85	5.00	90°00'00"	5.00
C28	7.85	5.00	90°00'00"	5.00
C29	15.71	30.00	30°00'00"	8.04
C34	31.42	20.00	90°00'00"	20.00
C38	31.42	20.00	90°01'33"	20.01
C39	31.40	20.00	89°57'34"	19.99

- CONSTRUCTION KEY NOTES**
(PER U.S.D.C.C.A. STANDARD DRAWINGS)
- (A) CONSTRUCT "L" CURB & GUTTER PER STD. # 216
 - (B) CONSTRUCT "A" ISLAND CURB PER STD. # 219
 - (C) CONSTRUCT SIDEWALK PER STD. # 234
 - (D) CONSTRUCT "ROLL" CURB & GUTTER PER STD. # 217A
 - (E) CONSTRUCT 6" GROSS GUTTER PER STD. # 228
 - (F) CONSTRUCT 2' SIDEWALK UNDER DRAIN PER STD. # 236
 - (G) CONSTRUCT DEPRESSED CURB PER SHEET DET1 DETAIL "O" CUT & MATCH 2' BEYOND EXIST. A.C.
 - (H) CONSTRUCT 10' CURB TYPE TRANSITION PER SHEET DET1 DETAIL "P"
 - (I) CONSTRUCT 4' X 16" DRAINAGE OPENING IN BLOCK WALL PER SHEET DET1 DETAILS "J" & "K"
 - (J) CONSTRUCT REMOVABLE BOLLARDS PER SHEET DET1
 - (K) CONSTRUCT CONCRETE "U" CHANNEL PER SHEET DET1 DETAILS "J" & "L"
 - (L) CONSTRUCT SIDEWALK RAMP USING ARMOR TILE TRUNCATED DOMES OR EQUIVALENT PER CCAUSD # 235 CASE 1
 - (M) CONSTRUCT RESIDENTIAL DRIVEWAY PER STD. # 222A & 225
 - (N) CONSTRUCT 6' HIGH IRON GATE SHEET DET1 DETAILS "F" & "G"
 - (O) CONSTRUCT CHANNEL STEM WALL SEE SHEET DET1 DETAIL "M"
 - (P) CONSTRUCT DRIVEWAY WITH MIN. LENGTH OF 25'
 - (R) CONSTRUCT DRIVEWAY WITH MIN. LENGTH OF 36'
 - (S) CONSTRUCT DRIVEWAY WITH MIN. LENGTH OF 60'

FOR ALL GRADING & STREET SECTIONS SEE DETAIL SHEET DET1

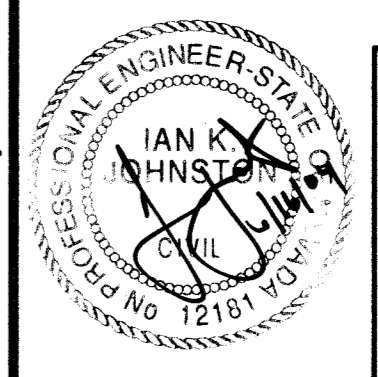

CLARK COUNTY DEVELOPMENT SERVICES DEPARTMENT OF CIVIL ENGINEERING
Acceptance of plans for filing
By: _____
NOTE: Power poles and/or other existing facilities not in proper location based on proposed improvements shown hereon will be re-located at no expense to Clark County.

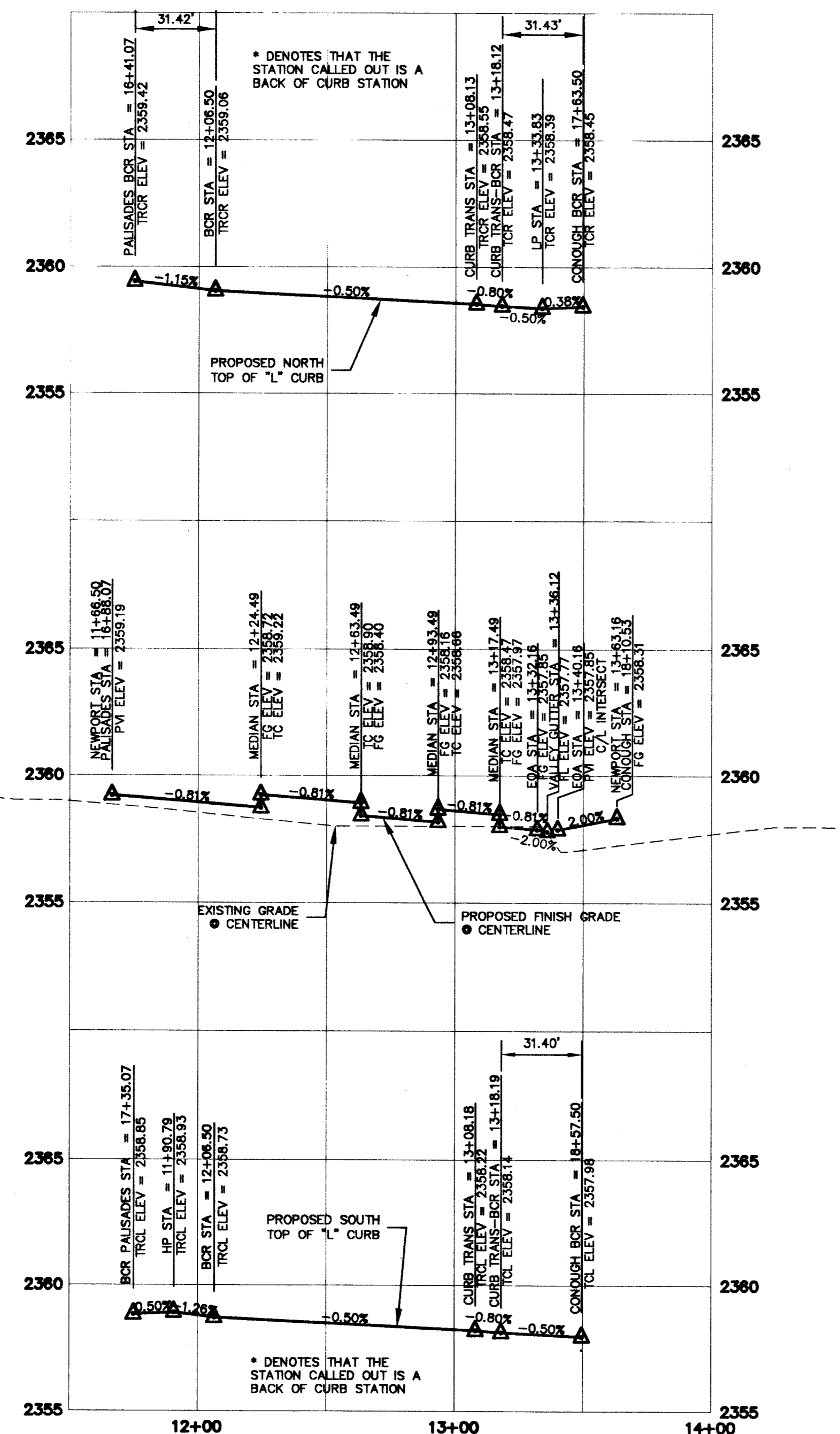

PALISADES CANYON CIRCLE PROFILE (PRIVATE STREET)
SCALE: 1"=40' HORIZ.
1"=4' VERT.

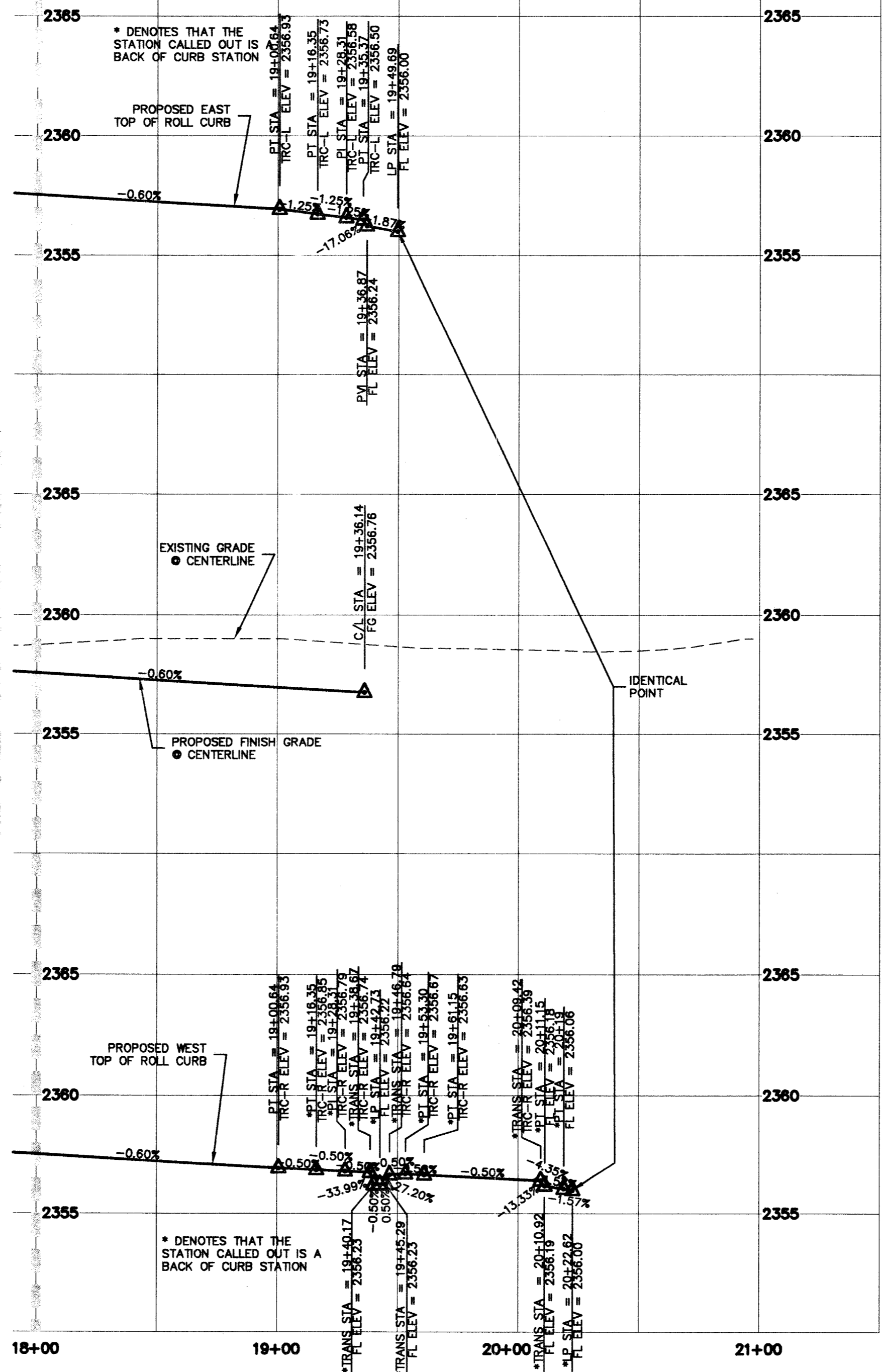

PALISADES CANYON CIRCLE PROFILE (PRIVATE STREET)
SCALE: 1"=40' HORIZ.
1"=4' VERT.

D&S DEVELOPMENT
3638 N. RANCHO DRIVE
LAS VEGAS, NV 89130-3168
(702) 362-0566

CLARK COUNTY, NEVADA
2727 SOUTH RAINBOW BOULEVARD LAS VEGAS, NEVADA 89146-5148
PH. (702) 873-7550 FAX (702) 362-2597

STREET PLAN & PROFILE PALISADES CANYON CIRCLE

CONOUGH / CRAIG

DRAWN BY: JMN 2004
DESIGNED BY: BEH 2004
CHECKED BY: IKI 2004
PROJECT NO: 9202
SCALE: 1"=40' HORIZ.
1"=4' VERT.

PROFESSIONAL ENGINEER STATE OF NEVADA
IAN K. JOHNSON
LICENSE NO. 12181
EXPIRES 6-30-05

SHEET ST1
8 OF 17 SHEETS
DRAWING NO. HTE# 04-15163

307 N 874