

UNSUBDIVIDED  
APN 125-07-401-001  
USA  
WASHINGTON D.C.

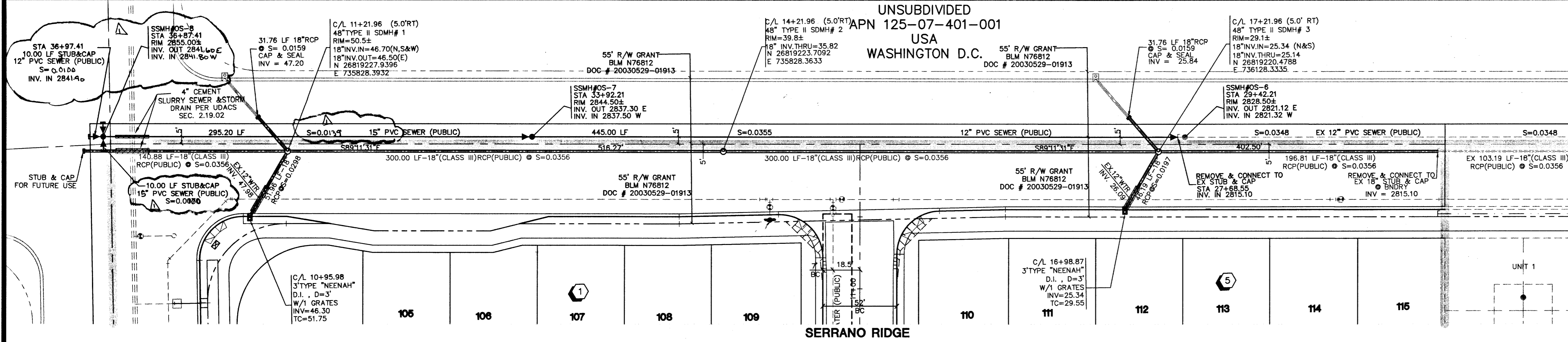

GRAND TETON DRIVE  
(PUBLIC STREET)

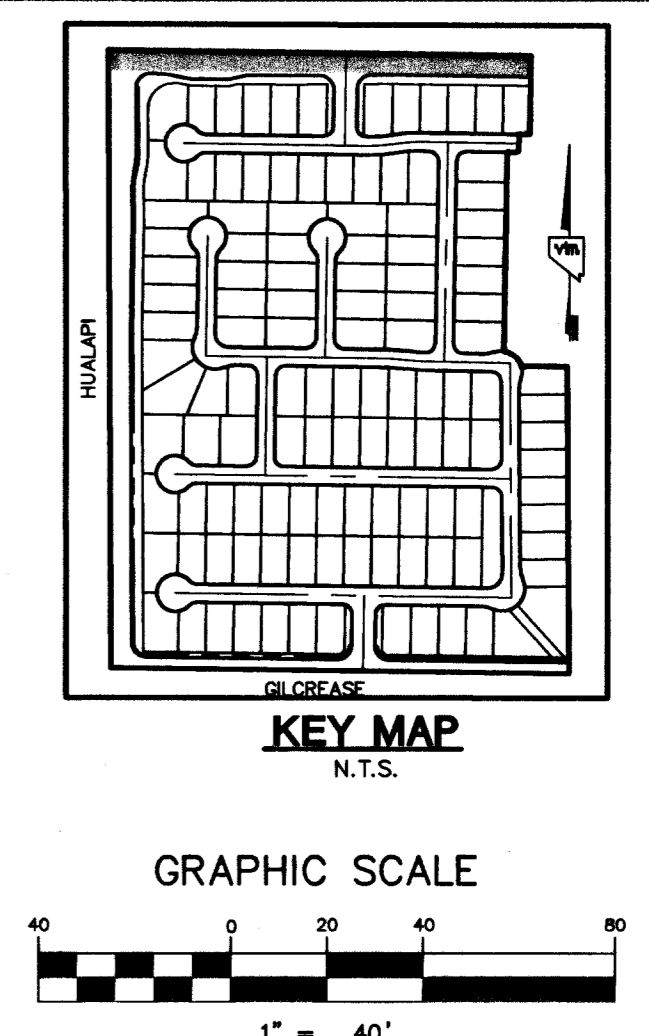
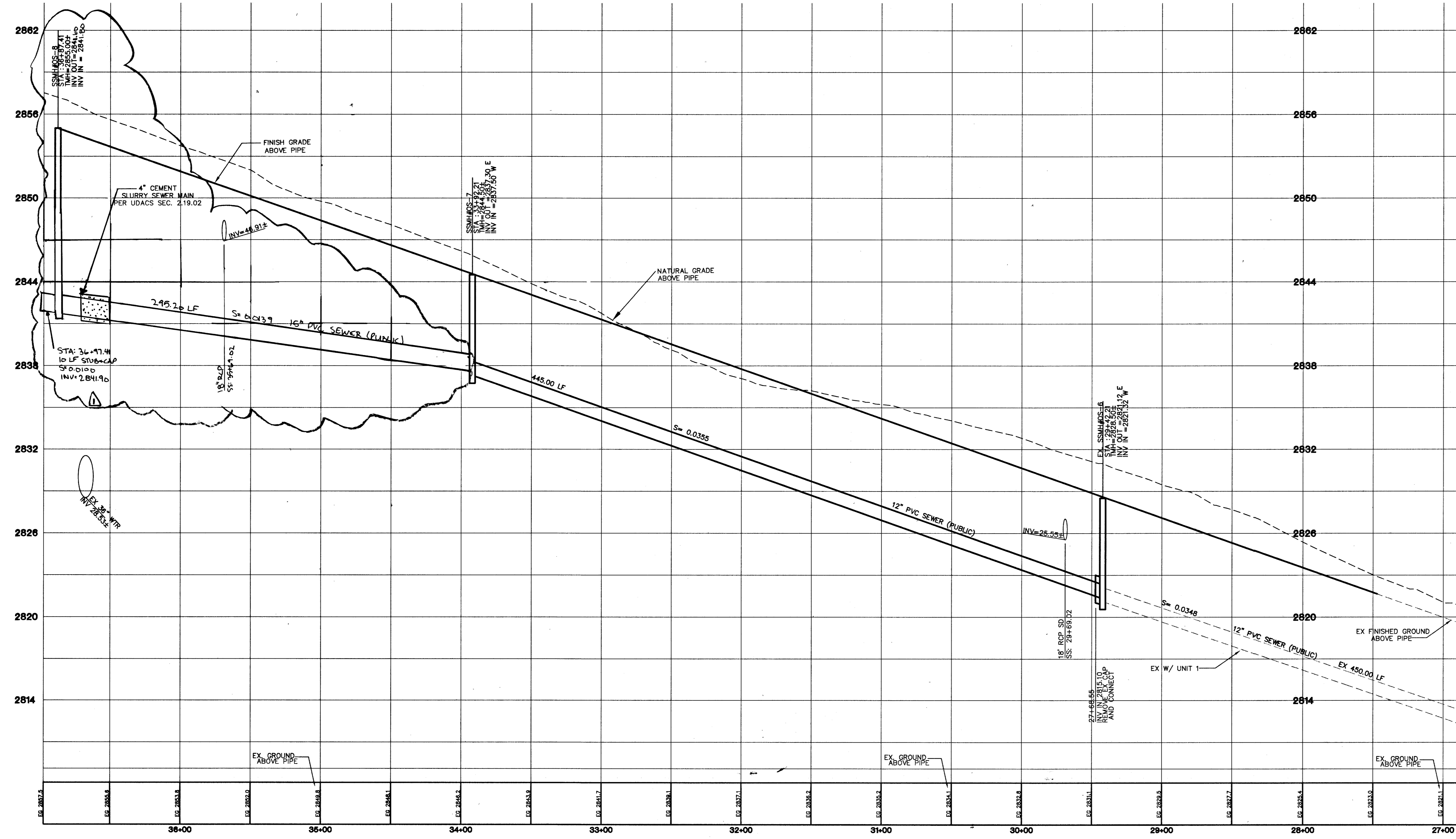

PROFILE SCALES:  
HORZ. = 1"=40'  
VERT. = 1"=4'

**Call before you Dig**  
1-800-227-2600

**Call before you Overhead**  
1-702-593-6111

**Call before you Underground**  
1-702-455-7511  
CLARK COUNTY TRAFFIC OPERATIONS

**Call before you Overhead**  
1-702-229-6611  
LAS VEGAS AREA COMPUTERIZED TRAFFIC SYSTEM

**PROJECT BENCHMARK**  
PROJECT DATUM: NORTH AMERICAN VERTICAL DATUM OF 1988 (NAVD88)  
CITY OF LAS VEGAS BENCHMARK: 003017N8  
ELEVATION: 799.0857 METERS (2,621.67 FEET)  
RIVET AND SQUARE ALUMINUM PLATE IN TOP CENTER OF HEADWALL ON THE WEST SIDE OF U.S. 95 NEAR MILE MARKER 90.15.

**BASIS OF BEARINGS**  
SOUTH 00°14'47" EAST, BEING THE BEARING OF THE WEST LINE OF THE NORTHWEST QUARTER (NW 1/4) OF SECTION 18, TOWNSHIP 19 SOUTH, RANGE 60 EAST, M.D.M., CITY OF LAS VEGAS, CLARK COUNTY, NEVADA, AS SHOWN ON THAT CERTAIN RECORD OF SURVEY ON FILE IN THE OFFICE OF THE COUNTY RECORDER, CLARK COUNTY, NEVADA, IN FILE 114 OF SURVEYS, AT PAGE 57.

**ENGINEER DISCLAIMER NOTE:**  
UTILITY LOCATIONS SHOWN HEREON ARE APPROXIMATE ONLY. IT SHALL BE THE CONTRACTOR'S RESPONSIBILITY TO DETERMINE THE EXACT HORIZONTAL AND VERTICAL LOCATION OF ALL EXISTING UNDERGROUND AND OVERHEAD UTILITIES AND NOTIFY THE DESIGN ENGINEER IMMEDIATELY OF ANY DISCREPANCIES PRIOR TO COMMENCING CONSTRUCTION.  
NO REPRESENTATION IS MADE THAT ALL EXISTING UTILITIES ARE SHOWN HEREON. THE ENGINEER ASSUMES NO RESPONSIBILITY FOR UTILITIES NOT SHOWN OR UTILITIES NOT SHOWN IN THEIR PROPER LOCATION.

**SEWER NOTE:**  
MANHOLE STATIONING IS BASED ON SEWER LENGTHS FROM MANHOLE TO TO MANHOLE. ALL MANHOLES ARE 48" SIZED MANHOLES PER STD.DWG# SD-1.

**PRIVATE STREET NOTE:**  
ALL PRIVATE STREETS ARE P.U.E.'S, PUBLIC SEWER EASEMENT AND PUBLIC DRAINAGE EASEMENTS TO BE PRIVATELY MAINTAINED BY H.O.A.

**CITY OF LAS VEGAS**

**BEAZER HOMES**  
4870 S. FORT APACHE SUITE 200  
LAS VEGAS, NEVADA 89147  
(702) 837-7100

**BEAZER & ASSOCIATES**  
CONSULTING ENGINEERS • PLANNERS • LAND SURVEYORS  
nevada

**SEWER PLAN AND PROFILE**  
GRAND TETON DRIVE

**BEAZER & ASSOCIATES**  
GRAND TETON VILLAGE  
UNIT 2

DRAWN BY: AUGUST, 2003  
DESIGNED BY: AUGUST, 2003  
CHECKED BY:  
PROJECT NO: 6152-Z  
SCALE: 1"=40' HORZ.  
1"=4' VERT.

**PROFESSIONAL ENGINEER STATE OF NEVADA**  
DEBORAH KALEKINI-JOHNSON  
CIVIL  
No. 14571  
EXPIRES 06-30-05

SHEET  
**SS9**  
35 OF 35 SHEETS  
DRAWING NO. 92-2  
10747

H:\6145.DWG\UNIT2\6145SS-2.dwg, 12/17/2003 04:47:59 PM, cdebram, TDS400.WPLAB.pcb

RGM  
61961 66865