

- NOTES:**
1. DEPTH TO MATCH EXIST. AC PAVEMENT, BUT NOT LESS THAN 4". PLACED IN MULTIPLE LIFTS OF EQUAL THICKNESS.
 2. PATCH WIDTH SHALL BE SUFFICIENT TO ACCOMMODATE MECHANICAL PLACEMENT, ROLLING AND COMPACTION PER UNIFORM STANDARD SPECIFICATION SECTION 401.03.11.
 3. IF SAWCUT IS WITHIN 3 FEET OF EDGE OF EXISTING ASPHALT CONCRETE SURFACE OR OTHER PATCH, REMOVE EXISTING PAVEMENT TO THAT EDGE AND REPLACE ENTIRE SECTION.
 4. IF 24" COVER IS NOT POSSIBLE, THAN RED CONCRETE ENCASUREMENT MIN. 4" ABOVE CONDUIT REQUIRED.
 5. FLOWABLE FILL MAY BE INSTALLED TO FINAL GRADE FOR TEMPORARY PATCHING.
 6. PERMANENT PATCH MIX DESIGN SHALL BE AS REQUIRED BY ENGINEER.

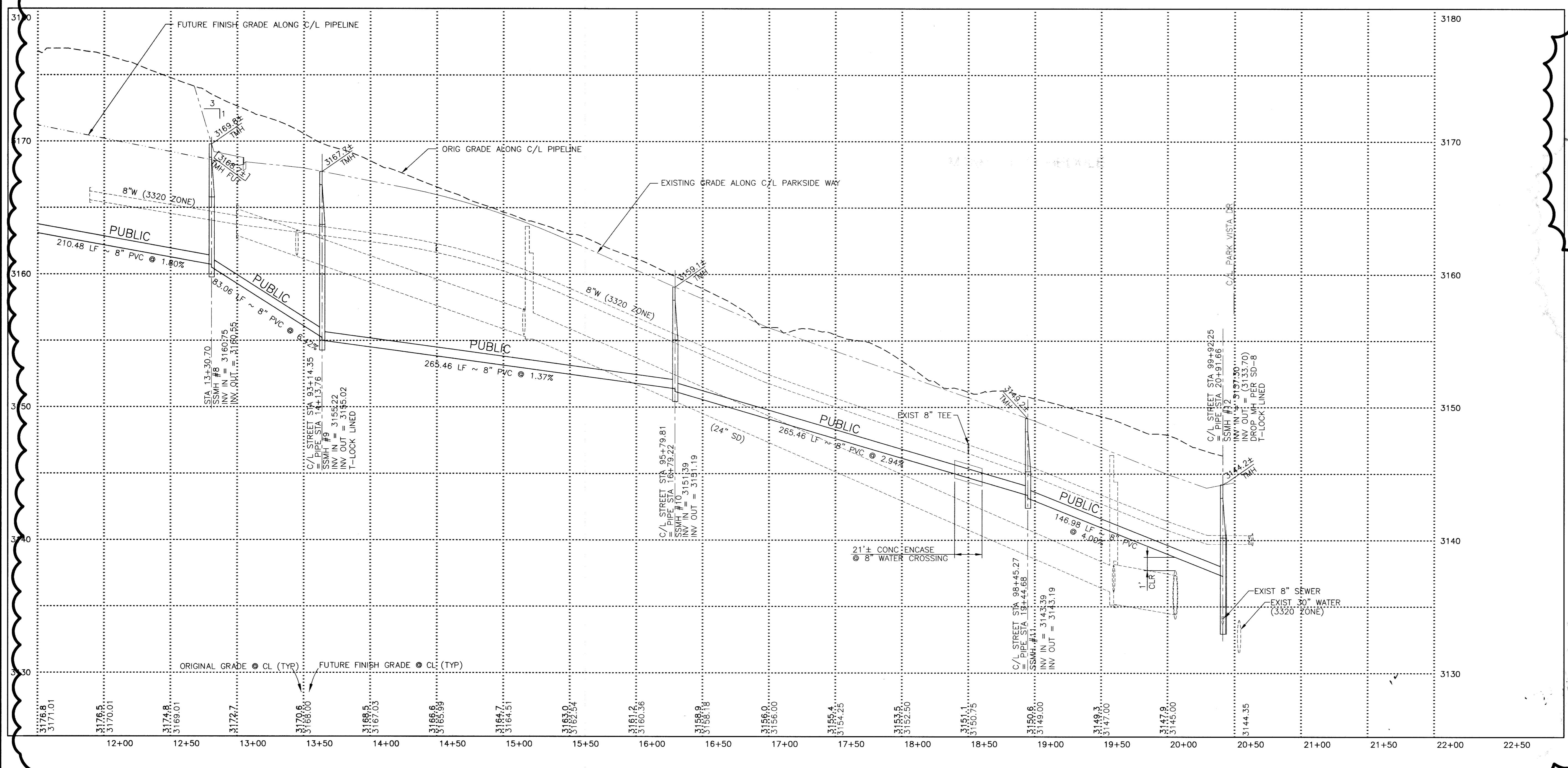

Call before you Dig
1-800-227-2600
UNDERGROUND SERVICE ALERT (USA)

CALL BEFORE YOU DO OVERHEAD
1-702-593-6111

LAS VEGAS VALLEY WATER DISTRICT

G.C. WALLACE, INC.
Engineers/Planners/Surveyors
1555 SOUTH RAINBOW BLVD., LAS VEGAS, NEVADA 89146
TELEPHONE: (702) 804-2000 • FAX: (702) 804-2599

VERIFY SCALE
1/2" = 10'
1/2" = 10'

3205 ZONE RESERVOIR EXPANSION

PLAN AND PROFILE - PARKSIDE WAY
STA. 12+56.57 TO STA. 16+55.34

1046C13.DWG Plot @ XX/XX/XX XX:XX
REVISION: REVISE OFFSITE SEWER ALIGNMENT AND PROFILE 04/12/02

DRAWN BY: R. A. BERGER	DATE: 04/12/02
CHECKED BY: M. W. MAIZE	DATE: 04/12/02
RECOMMENDED BY: L. STEVEN ANDERSON	DATE:
ACCEPTED BY: A. STEVEN ANDERSON	DATE:
DESIGN MANAGER: rberger	DATE: 14:35:03 '02-24-04

CONTRACT NUMBER: **C1046**

CLV DRAWING #565-388
CLV CIVIL SHEET 27 OF 30

REVISIONS: DRAWING NUMBER C21 SHEET 27 OF 95

65477