

APN: 125-07-401-001
U.S.A. (R-E)

GRAND TETON DRIVE
(PUBLIC STREET)

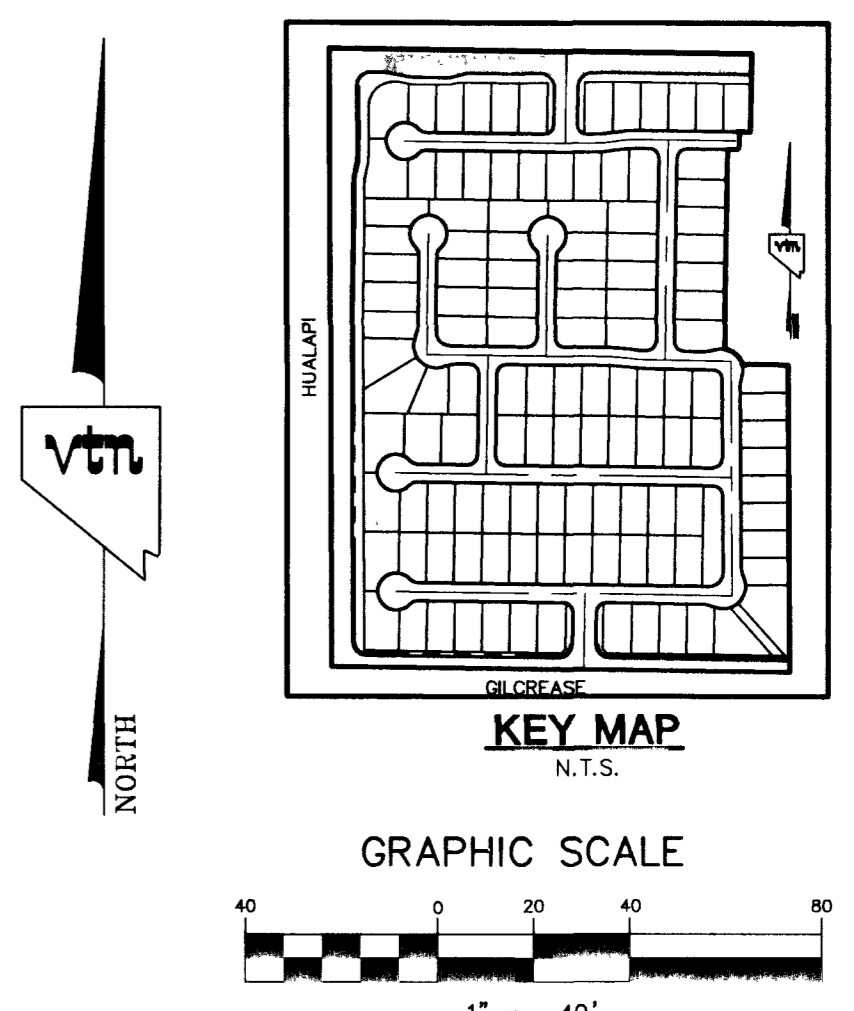

PROFILE SCALES:
HORZ. = 1"=40'
VERT. = 1"=4'

Call before you Overhead
1-702-593-6111

Call before you Dig
1-800-227-2600

PROJECT BENCHMARK
PROJECT DATUM: NORTH AMERICAN VERTICAL DATUM OF 1988 (NAVD88)
CITY OF LAS VEGAS BENCHMARK: 009017N6
ELEVATION: 799.0857 METERS (2,621.67 FEET)
RIVET AND SQUARE ALUMINUM PLATE IN TOP CENTER OF HEADWALL ON THE WEST SIDE OF U.S. 95 NEAR MILE MARKER 90.15.

BASIS OF BEARINGS
SOUTH 00°14'47" EAST, BEING THE BEARING OF THE WEST LINE OF THE NORTHWEST QUARTER (NW 1/4) OF SECTION 18, TOWNSHIP 19 SOUTH, RANGE 60 EAST, M.D.M., CITY OF LAS VEGAS, CLARK COUNTY, NEVADA, AS SHOWN ON THAT CERTAIN RECORD OF SURVEY ON FILE IN THE OFFICE OF THE COUNTY RECORDER, CLARK COUNTY, NEVADA, IN FILE 114 OF SURVEYS, AT PAGE 57.

ENGINEER DISCLAIMER NOTE:
UTILITY LOCATIONS SHOWN HEREON ARE APPROXIMATE ONLY. IT SHALL BE THE CONTRACTOR'S RESPONSIBILITY TO DETERMINE THE EXACT HORIZONTAL AND VERTICAL LOCATION OF ALL EXISTING UNDERGROUND AND OVERHEAD UTILITIES AND NOTIFY THE DESIGN ENGINEER IMMEDIATELY OF ANY DISCREPANCIES PRIOR TO COMMENCING CONSTRUCTION.
NO REPRESENTATION IS MADE THAT ALL EXISTING UTILITIES ARE SHOWN HEREON. THE ENGINEER ASSUMES NO RESPONSIBILITY FOR UTILITIES NOT SHOWN OR UTILITIES NOT SHOWN IN THEIR PROPER LOCATION.

FOR ALL GRADING & STREET SECTIONS SEE SHEET # DT 1

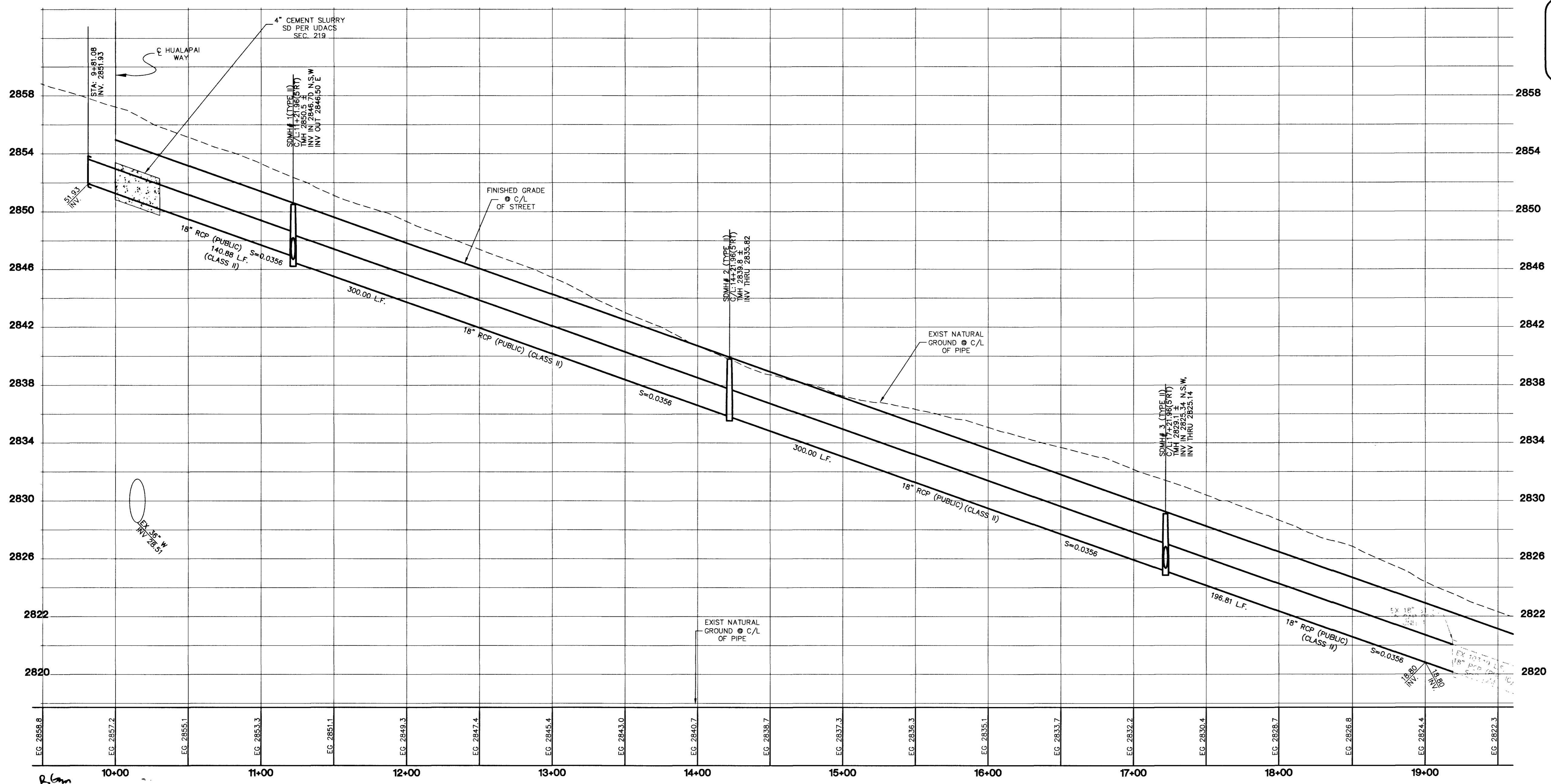

BEAZER HOMES
4670 S. FORT APACHE SUITE # 200
LAS VEGAS, NEVADA 89147
(702) 837-2100

STORM DRAIN PLAN & PROFILE
GRAND TETON DRIVE

BEAZER
GRAND TETON VILLAGE
UNIT 2

DRAWN BY: [] AUGUST, 2003
DESIGNED BY: [] AUGUST, 2003
CHECKED BY: []
PROJECT NO: 6145-2
SCALE: 1"=40' HORIZ.
1"=4' VERT.

PROFESSIONAL ENGINEER STATE OF NEVADA
DEBORAH KALEIKINI-JOHNSON
CIVIL
No. 14571
EXPIRES 06-30-05

APPROVED FOR CONSTRUCTION
[Signature]
LAS VEGAS VALLEY WATER DISTRICT (PROJ# 28084) DATE: 1/20/04

SHEET **SD1**
11 OF 35 SHEETS
DRAWING NO. 92-2
107/47

CITY OF LAS VEGAS
2727 SOUTH RAINBOW BOULEVARD LAS VEGAS, NEVADA 89146-5148
PH. (702) 873-7550 FAX (702) 362-2597

neveda CONSULTING ENGINEERS • PLANNERS • LAND SURVEYORS

Rlan
6/9/07

H:\6145\DWG\UNIT2\6145-SD02.dwg, 12/17/2003 03:10:57 PM, rcbarrin, TDS400.WY.LAR.pcs