

**CHARLESTON BOULEVARD  
(SR-159)**

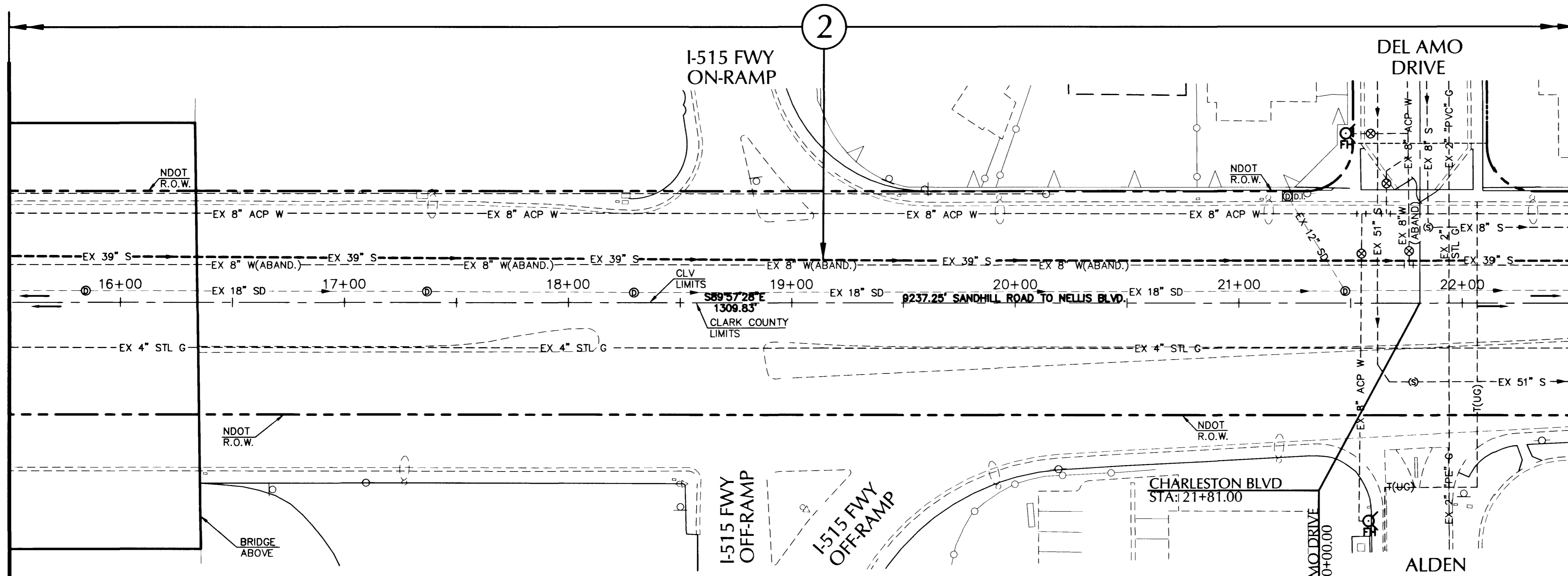

**CHARLESTON BOULEVARD  
(SR-159)**

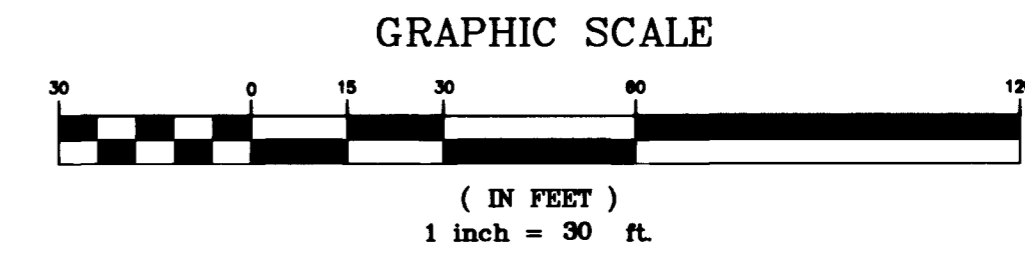

**BASIS OF BEARING**  
 N 89°53'41\"/>

**BENCHMARK**  
 CITY OF LAS VEGAS DATUM BM CLV 2LV02-32SWS A RIVET AND SQUARE PLATE IN TOP OF CURB NE CORNER OF CHARLESTON & LAMB. NAVD 88 ELEVATION 534.458 METERS (1753.47 FEET)

**CONSTRUCTION NOTES - BID ALTERNATE A**

No.	ITEM	QUANTITY
1	INSTALL 36\"/>	28 LF
2	INSTALL 39\"/>	1203.19 LF
3	INSTALL 45\"/>	— LF
4	INSTALL 51\"/>	— LF
5	CONSTRUCT 60\"/>	1 EA
6	RAISE EXISTING MANHOLE FRAME AND COVER TO GRADE. SEE SPECIAL PROVISIONS SECTION 630 AND BID ITEM 630.01.	EA

**CONSTRUCTION NOTES - BID ALTERNATE B**

No.	ITEM	QUANTITY
1	INSTALL 36\"/>	28 LF
2	INSTALL 39\"/>	1203.19 LF
3	INSTALL 45\"/>	— LF
4	INSTALL 51\"/>	— LF
5	CONSTRUCT 60\"/>	1 EA
6	RAISE EXISTING MANHOLE FRAME AND COVER TO GRADE. SEE SPECIAL PROVISIONS SECTION 630 AND BID ITEM 630.01.	EA

**AVOID CUTTING UNDERGROUND UTILITY LINES. IT'S COSTLY.**  
 Call before you Dig—  
 1-800-227-2600  
 UNDERGROUND SERVICE ALERT (U.S.A.)

**AVOID OVERHEAD POWER LINE CONTACT**  
 Call before you OVERHEAD  
 1-702-593-6111  
 NEVADA POWER ENVIRONMENT AND SAFETY SERVICES DEPARTMENT

MARTIN & MARTIN ASSUMES NO RESPONSIBILITY FOR EXISTING UTILITY LOCATIONS AND ELEVATIONS. THE UTILITIES SHOWN ON THIS DRAWING HAVE BEEN PLOTTED FROM THE BEST AVAILABLE INFORMATION. IT IS, HOWEVER, THE CONTRACTOR'S RESPONSIBILITY TO FIELD VERIFY THE LOCATION AND ELEVATION OF ALL UTILITIES PRIOR TO THE COMMENCEMENT OF ANY CONSTRUCTION. CONTRACTOR TO FIELD VERIFY ALL EXISTING SITE CONDITIONS PRIOR TO CONSTRUCTION. IF A CONFLICT EXISTS BETWEEN WHAT IS SHOWN ON THESE DRAWINGS AND WHAT EXISTS IN THE FIELD, THE CONTRACTOR IS TO NOTIFY THE ARCHITECT OR ENGINEER IMMEDIATELY.

no.	description of revisions	date	name

PROJECT NO. 1939.00  
 DATE 06-23-03  
 DRAWN BY JDM  
 DESIGN BY ARS  
 CHECKED BY DHM

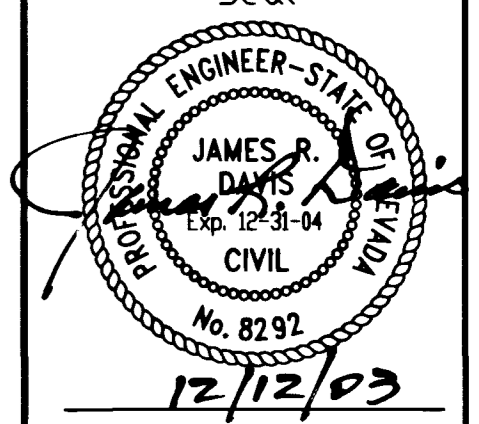

**MARTIN & MARTIN**  
 CIVIL ENGINEERS  
 2101 SOUTH JONES BLVD.  
 SUITE 120  
 LAS VEGAS, NEVADA 89146  
 PHONE (702) 248-8000  
 FAX (702) 248-8070  
 E-MAIL: MARTIN@VCM.COM

**CHARLESTON BOULEVARD  
SEWER REHABILITATION PLAN  
SANDHILL ROAD TO NELLIS BOULEVARD**

STA: 8+50.00 TO STA: 22+50.00

sheet  
**C9**  
SHEET 9 OF 45  
drawing number  
307-V841