

FED. ROAD REG. NO.	STATE	PROJECT NO.	COUNTY	CONTROL SECTION	STATE ROUTE	SHEET NO.	TOTAL SHEETS
7	NEVADA	US-456 824 (2)	CLARK	03-015	5	10	

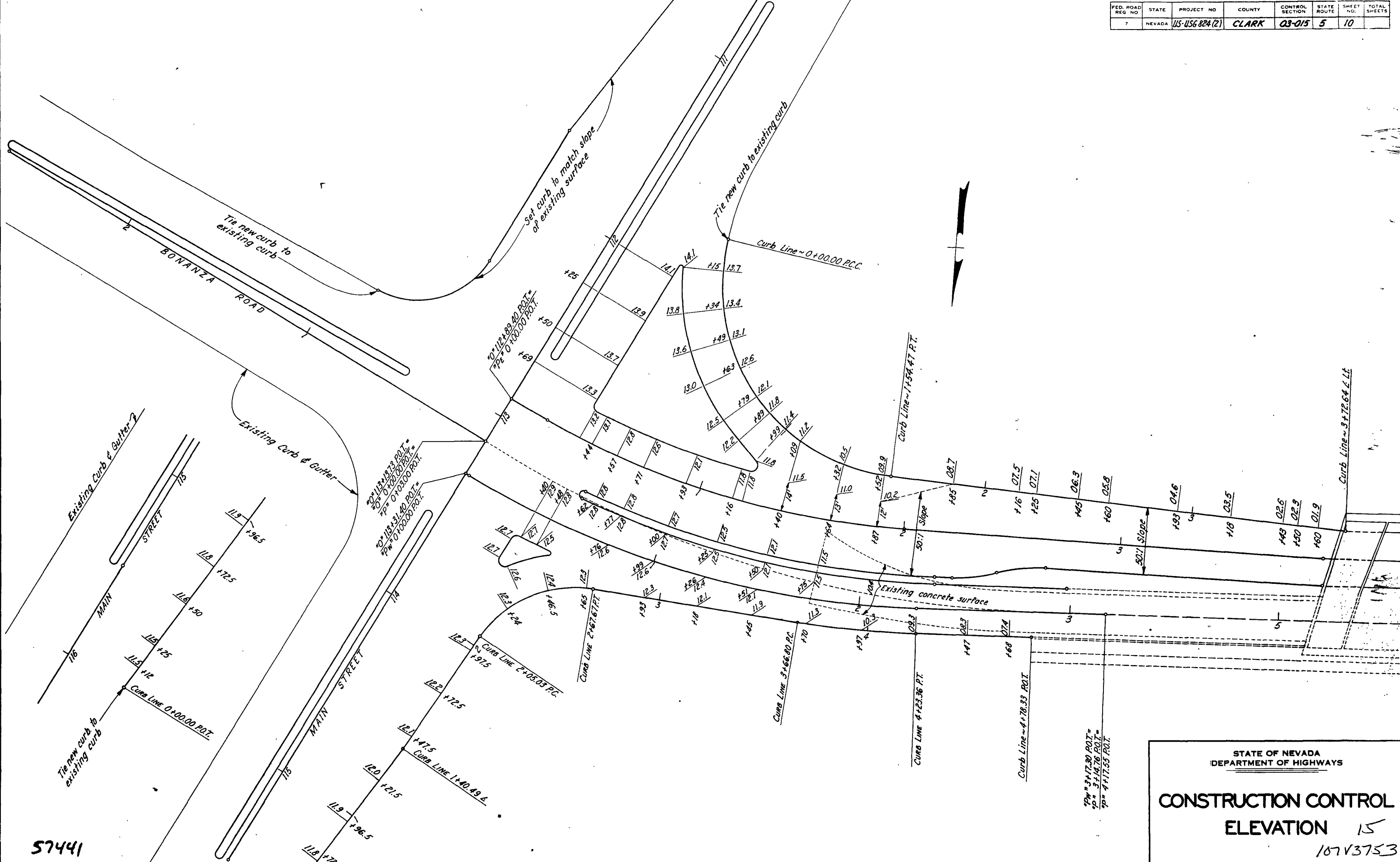

57441

STATE OF NEVADA
DEPARTMENT OF HIGHWAYS

CONSTRUCTION CONTROL
ELEVATION 15
107V3753

PTA 3+17.30 P.O.T. =
PTA 3+14.76 P.O.T. =
PTA 4+17.53 P.O.T. =