

FED. ROAD REG. NO.	STATE	PROJECT NO.	COUNTY	CONTROL SECTION	STATE ROUTE	SHEET NO.	TOTAL SHEETS
7	NEVADA	US-506824(2)	CLARK	03-015	5	9	

"Pe" 5+72 ~ Type 2 drop inlet Lt, New 24"x64' RCP.
 "Pe" 6+36 ~ Type 2 drop inlet Lt, New 24"x56' RCP.
 "Pe" 6+55 to "Pe" 9+95 ~ Median island Rt.
 "Pe" 6+73 to "Pe" 9+95 ~ Retaining wall Lt. (See Sheet No. 36)
 "Pe" 6+34 ~ Type 2 drop inlet Lt.
 "Pe" 5+30.50 to "P" 10+33.85 ~ Sidewalk Lt.
 "Pe" 5+20 to "Pe" 6+55 ~ Curb and gutter Rt.

"Pe" 5+21 to "Pe" 9+95 ~ New 6" Perforated CMP underdrain Lt. (See Sheet No. 19)
 "Pe" 6+00 to "Pe" 9+95 ~ New 6" Perforated CMP underdrain Rt. Connect to transverse inlet. (See Sheet No. 19)
 "Pe" 5+30.50 to "P" 10+33.85 ~ Curb & Gutter Lt.
 "Pe" 5+93 ~ Construct U.P.R.R. Structure No G-195 (See Sheets No. 18 through 43)
 "Pe" 6+73± and "Pe" 6+91± ~ Construct Shoofly. Remove when no longer needed. (See Sheets No. 22, 22A and 23)

"Pe" 7+11± to "Pe" 7+10± ~ Construct temporary fence 15'± Lt. to 95'± Lt. (No Direct Payment) (See sheet No. 22)

"Pe" 9+95 ~ Median island nose Rt. (See Sheet No. 14)

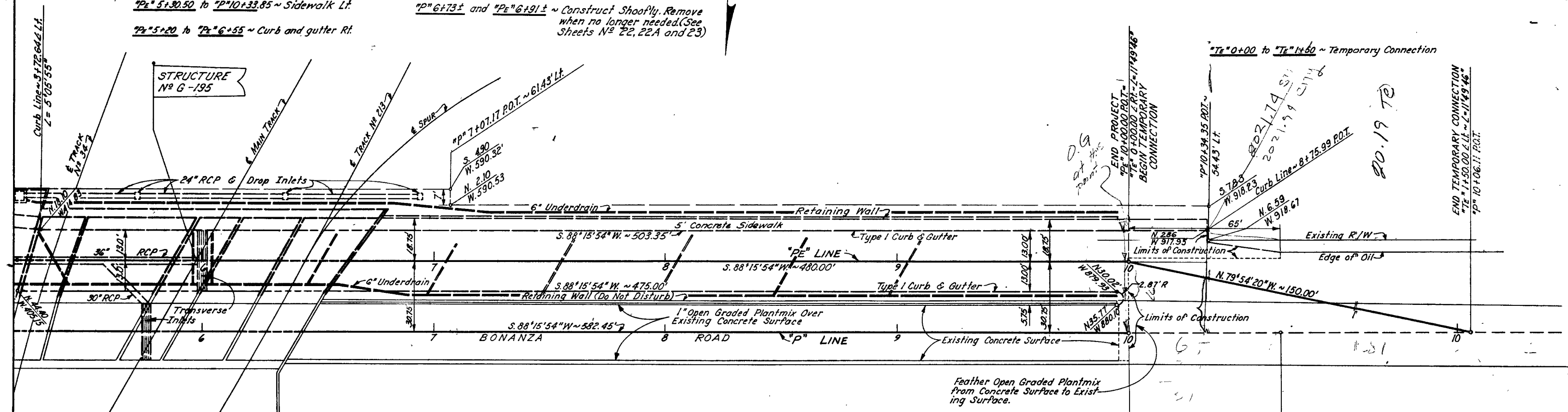

"P" 4+60± to "P" 6+75± ~ Construct temporary fence west of Shoofly 300'± Rt. to 36'± Rt. (No Direct Payment) (See Sheet No. 23)

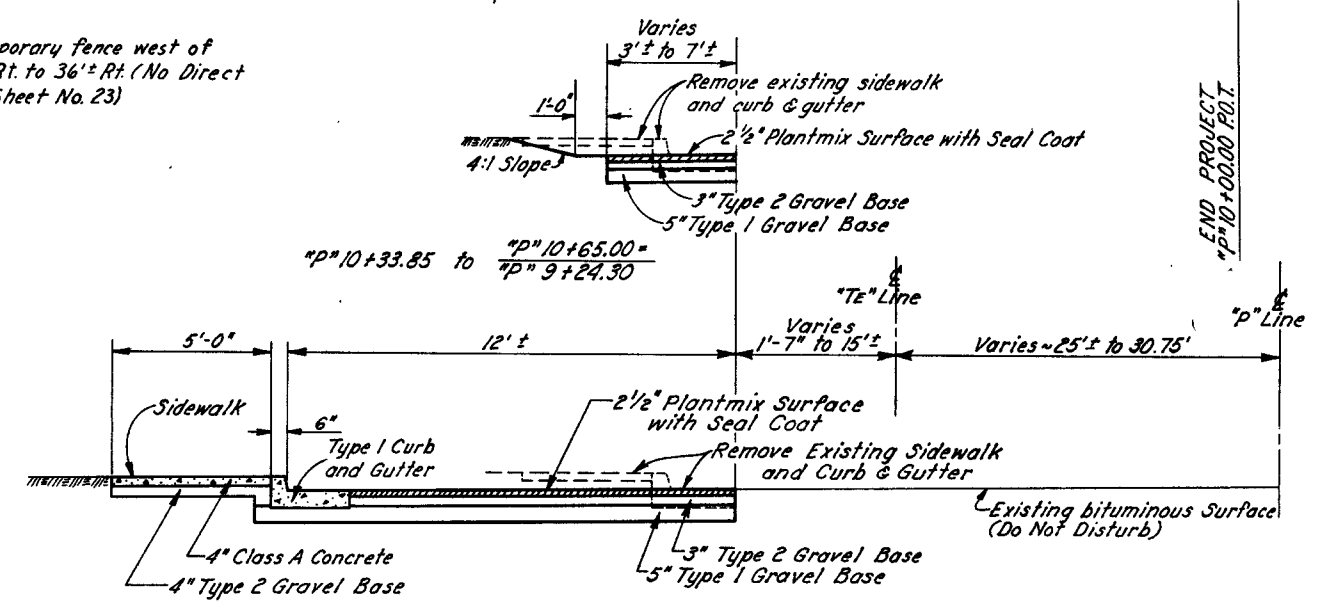

STATE OF NEVADA
 DEPARTMENT OF HIGHWAYS

CONSTRUCTION CONTROL PLAN

14

107N3753

57440