

"Pe" 3+33± to "Pe" 5+62± ~ Remove 24" x 112" CMP and headwall Lt.

"Pe" 6+15± ~ Remove R.C. Drain Box and 24" CMP and headwall Lt.

"Pe" 7+00± to "Pe" 10+65 ~ Remove curb and gutter Lt. and Rt.

"Pe" 7+08± to "Te" 0+36± ~ Remove fence Lt. Reconstruct on New R/W line Lt.

"Pe" 7+28± ~ Remove R.C.B. and drop inlet Lt.

"Te" 0+13± ~ Remove sign and barricade Rt.

REG. NO.	STATE	PROJECT NO.	COUNTY	SECTION	ROUTE	NO.	SHEETS
7	NEVADA	US-USG 824(2)	CLARK	03-015	5	6	

**END PROJECT US-USG 824 (2)
STA "P" & "Pe" 10+00.00 P.O.T.**

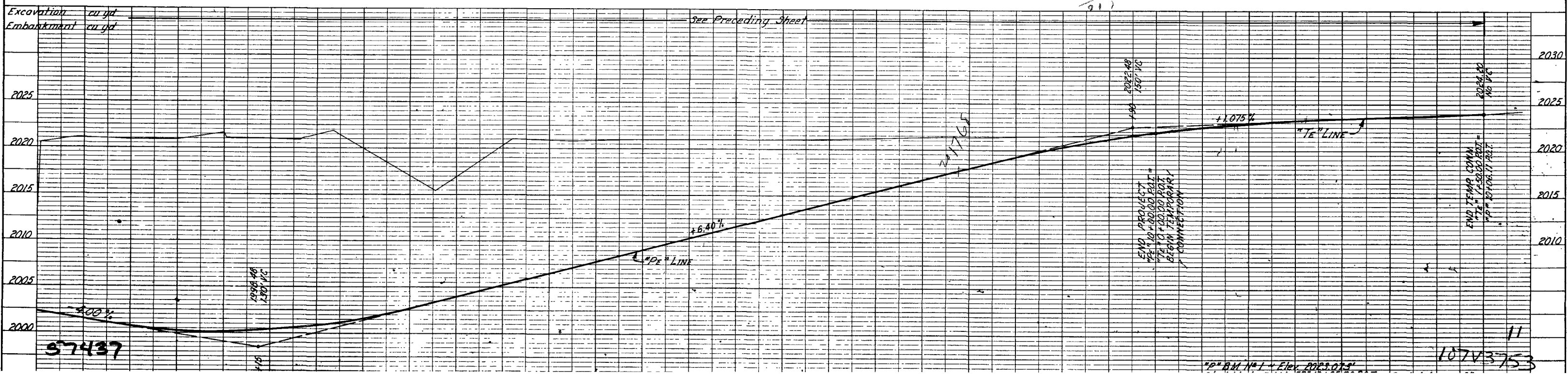
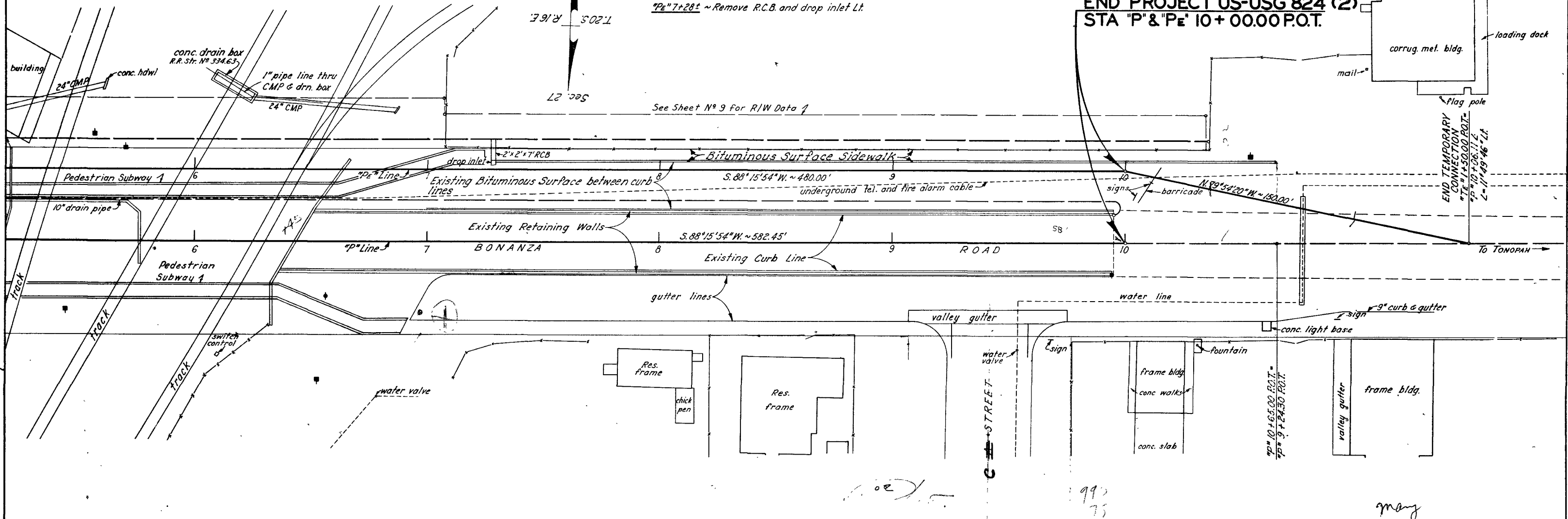

may

990
75
610

"P" B.M. N° 1 ~ Elev. 2023.075'

11
107V3753