

NOTES

- UTILITY EXHIBIT PROVIDED FOR INFORMATIONAL PURPOSES ONLY. ALL INFORMATION SHOWN HEREON IS REPRESENTATIVE OF LOCAL ENTITY RESEARCH AND COMPILATION OF EXISTING CONSTRUCTION DRAWINGS AND AS-BUILTS PROVIDED BY THE CLIENT/LOCAL ENTITY.
- UTILITY LOCATIONS SHOWN HEREON ARE APPROXIMATE ONLY AND SHALL BE THE CONTRACTOR'S RESPONSIBILITY TO DETERMINE THE EXACT HORIZONTAL AND VERTICAL LOCATION OF ALL EXISTING UNDERGROUND UTILITY PRIOR TO COMMENCING CONSTRUCTION. NO REPRESENTATION IS MADE THAT ALL EXISTING UTILITIES ARE SHOWN HEREON. THE ENGINEER ASSUMES NO RESPONSIBILITY FOR UTILITIES NOT SHOWN OR UTILITIES NOT SHOWN IN THEIR PROPER LOCATION.
- SEWER MANHOLE AND RIM ELEVATION ARE BASED OFF DESIGN INFORMATION AND FOR REFERENCE ONLY. CONTRACTOR SHOULD TAKE CARE TO VERIFY ACTUAL BENCHMARK LOCATION AND FIELD ELEVATIONS TO AVOID DIFFERENCES IN DATUM, ETC.

- WATER NOTES**
- INSTALL 8" FIRE HYDRANT ASSEMBLY (INCLUDES TEE, 6" GATE VALVE) PER UDACS STD. PLATE No. 7 & 8. PROVIDE A MINIMUM 3.00' CLEARANCE AROUND HYDRANT.
 - SEE FIRE SAFETY CONTRACTOR NOTE ON THIS SHEET.
 - INSTALL 2" RPPA PER UDACS STD. PLATE No. 11A. (POTABLE)
 - INSTALL 2" METER PER UDACS STD. PLATE No. 10. (POTABLE)
 - INSTALL 8" CDDA (FEBCO 876V) ABOVE FG. ON A CONC. PAD PER UDACS STD. PLATE No. 20B.
 - REFER TO MECHANICAL/PLUMBING PLANS FOR ADDITIONAL INFORMATION.
 - PROVIDE A MINIMUM OF 18" VERTICAL CLEARANCE BETWEEN SEWER, STORM DRAIN AND WATER LINES, WITH WATER LINES PLACED ABOVE SEWER LINES.
 - INSTALL 3" TURBO METER AND VAULT PER UDACS STD. PLATE No. 18A AND C-475. (IRRIGATION)
 - INSTALL 3" RPPA PER UDACS PLATE No. 11B. (LANDSCAPE)
 - REFER TO LANDSCAPE PLANS FOR CONTINUATION.
 - INSTALL 2" TYPE K COPPER SERVICE LATERAL WITH CORPORATION STOP AND 2" SERVICE SADDLE PER UDACS STD. PLATE No. 10.
 - INSTALL 8" 45° BEND
 - INSTALL 8" 90° BEND
 - INSTALL 4" 90° BEND
 - INSTALL 8"x8"x8" TEE
- STORM DRAIN NOTES**
- CONSTRUCT TYPE I MANHOLE (80" DIA) PER CCAUSD No. 406
 - CONSTRUCT CONCRETE COLLAR PER CCAUSD No. 406
 - INSTALL ADS 12" INLINE DRAIN WITH 12" PEDESTALIAN N-10 RATED HINGED LOCKING GRATE (REFER TO DETAIL "A" ON SHEET C6.02) TYP. ON ALL COURTYARD DRAINS
 - CONSTRUCT TYPE II MANHOLE (80" DIA) PER CCAUSD No. 405
 - NOT USED
 - NOT USED
 - NOT USED
 - THE STORM DRAIN LATERAL TO BLDG. ROOF DRAIN - REFER TO MECH./PLUMBING PLANS FOR CONTINUATION. INSTALL REDUCER AS NECESSARY TO MATCH BLDG. SD STUBS.
- SANITARY SEWER NOTES**
- CONSTRUCT STANDARD ECCENTRIC MANHOLE (48") PER D.C.S.W.C.S. DRAWING No. SD-1.
 - INSTALL C900 WATER QUALITY PIPE. BACKFILL TRENCH PER STD. DWG. 304.1 AND CONSTRUCT PERMANENT AC PATCH.
 - REFER TO MECHANICAL/PLUMBING PLANS FOR LOCATION AND ADDITIONAL INFORMATION
 - CONSTRUCT LATERAL CONNECTION PER DCSWCS No. SD-17
- GENERAL UTILITY CONSTRUCTION NOTES**
- TRENCH BACKFILL FOR WATER LINES TO BE CONSTRUCTED PER UDACS PLATE No. 6B.
 - CONTRACTOR TO LOCATE AND VERIFY SIZE, LINE TYPE, CONDITION, DEPTH, PRESSURE, AND LOCATION OF ALL EXISTING UTILITY LINES WITHIN THE CONSTRUCTION AREA PRIOR TO CONSTRUCTION. THE CIVIL ENGINEER SHALL BE CONTACTED ONCE THE UTILITY LINE IS LOCATED.
 - THESE DRAWINGS MAY NOT INDICATE ALL EXISTING BURIED UTILITY LINES. CONTRACTOR IS TO EXERCISE GREAT CARE DURING EXCAVATION IN ORDER TO AVOID MAKING CONTACT WITH ANY EXIST. UTILITY LINES. IF UTILITY LINES ARE DAMAGED BY THE CONTRACTOR, SUCH DAMAGE SHALL BE REPLACED TO THE SATISFACTION OF THE OWNER AT THE CONTRACTOR'S EXPENSE.
 - CONTRACTOR TO SAWCUT AND REMOVE EXISTING ASPHALT AND CONCRETE AS NECESSARY FOR UTILITY TRENCHES. BACKFILL AND PATCH ALL TRENCHES AS INDICATED IN DETAILS AND/OR ACCORDING TO EXIST. SITE, AC STRUCTURAL SECTIONS.
 - ALL DIMENSIONS TO UTILITIES ARE TO CENTERLINE OF PIPE UNLESS INDICATED OTHERWISE.
 - THE EXISTING UTILITIES SHOWN HEREON ARE SHOWN FOR REFERENCE PURPOSES ONLY. THIS INFORMATION WAS OBTAINED FROM THE AVAILABLE RECORDS PROVIDED BY THE GOVERNING ENTITIES. PBS&J DOES NOT IMPLY NOR GRANT ANY WARRANTIES TO THE ACCURACY OF THIS INFORMATION. THE USER OF THIS INFORMATION SHALL BE SOLELY RESPONSIBLE FOR VERIFYING THE EXISTING CONDITIONS TO HIS OWN SATISFACTION PRIOR TO CONSTRUCTION ACTIVITIES SHOWN ON THESE PLANS.
 - SECTIONAL CONTROL VALVES ON THE ON-SITE 10" WATER TRANSMISSION LINE SHALL BE EQUIPPED WITH A DEBRIS CAP LOCK OUT DEVICE AS APPROVED BY THE CLARK COUNTY FIRE DEPARTMENT.
 - CONTRACTOR TO REPAIR ANY CONCRETE CURBING, AND LANDSCAPE AREAS THAT WERE DAMAGED DURING THE WATER LINE INSTALLATION TO THE OWNER'S SATISFACTION.
 - ALL WATER MAINS SHALL BE C900 WATER QUALITY.
 - CONTRACTOR TO REPLACE ALL DAMAGED LANDSCAPING TO THE OWNER'S SATISFACTION. DURING CONSTRUCTION ACTIVITIES CONTRACTOR SHALL INSURE THAT ALL DISTURBED LANDSCAPE IRRIGATION LINES REMAIN ACTIVE. IF CONTRACTOR CANNOT MAINTAIN ACTIVE IRRIGATION MAINS THEN CONTRACTOR SHALL INSURE PROPER WATERING OF EXISTING LANDSCAPING.
 - WATER LINES TO HAVE THRUST BLOCKS CONSTRUCTED PER UDACS PLATE No. 5. THRUST BLOCKS TO BE LOCATED AT ALL ANGLE FITTINGS (BENDS), TEES & FIRE HYDRANTS. ANCHOR BLOCKS TO BE LOCATED AT ALL IN-LINE REDUCERS AND GATE VALVES.
 - WET TAPS TO BE CONSTRUCTED IN CONFORMANCE WITH UDACS PLATE No. 22.
 - WATER AND SEWER SEPARATION OF TRENCHES MUST BE AT LEAST 10" MIN. (TYP). SEE DCSWCS 2.2.21 "A1", UDACS 2.19.01 "A".
 - THE PROPOSED AND EXISTING GAS LINE LOCATIONS SHOWN ON THESE PLANS ARE APPROXIMATIONS ONLY.
 - CONTRACTOR/OWNER TO OBTAIN A CCPW OFF-SITE IMPROVEMENT PERMIT FOR ALL WORK WITHIN PUBLIC RIGHT-OF-WAY.

558/6

CLARK COUNTY FIRE DEPARTMENT SIGN-OFF

BUILDING DATA - CLARK COUNTY FIRE DEPARTMENT
 TYPE OF CONSTRUCTION - I-N/A-1HR. MAX. SQ. FT. - 62,034 (48,808 SQ. FT. - NUMBER OF FLOORS - ONE I-N/A-1HR. MAX. SQ. FT. - 15,225 SQ. FT. - PLANNED USE - SCHOOL BUILDING
 FIRE RESISTIVE RATING OF SEPARATION WALLS - N/A
 AUTOMATIC FIRE SPRINKLER SYSTEM - YES

CLARK COUNTY FIRE DEPARTMENT
 APPROVED BY: *Kenny Chapman*
 APPROVAL OF THESE PLANS SHALL NOT BE CONSTRUED TO BE A PERMIT FOR, OR AN APPROVAL OF, ANY VIOLATION OF ANY OF THE PROVISIONS OF THE STATE OR COUNTY LAWS.
 FIRE FLOW .2825 GPM AT 20 P.S.I. RESIDUAL 7/17/03 DATE

NOTE:
 ALL SEWER/STORM DRAINS CROSSING WATER LINES MUST CONFORM TO SECTION 2.19 OF UNIFORM DESIGN AND CONSTRUCTION STANDARDS FOR WATER DISTRIBUTION SYSTEMS (UDACS) FOR WATER AND STORM DRAIN CROSSINGS AND CLEARANCES.

CLARK COUNTY FIRE DEPARTMENT SIGN-OFF

BUILDING DATA - CLARK COUNTY FIRE DEPARTMENT
 TYPE OF CONSTRUCTION - I-N/A-1HR. MAX. SQ. FT. - 62,034 (48,808 SQ. FT. - NUMBER OF FLOORS - ONE I-N/A-1HR. MAX. SQ. FT. - 15,225 SQ. FT. - PLANNED USE - SCHOOL BUILDING
 FIRE RESISTIVE RATING OF SEPARATION WALLS - N/A
 AUTOMATIC FIRE SPRINKLER SYSTEM - YES

CLARK COUNTY FIRE DEPARTMENT
 APPROVED BY: *Kenny Chapman*
 APPROVAL OF THESE PLANS SHALL NOT BE CONSTRUED TO BE A PERMIT FOR, OR AN APPROVAL OF, ANY VIOLATION OF ANY OF THE PROVISIONS OF THE STATE OR COUNTY LAWS.
 FIRE FLOW .2825 GPM AT 20 P.S.I. RESIDUAL 7/17/03 DATE

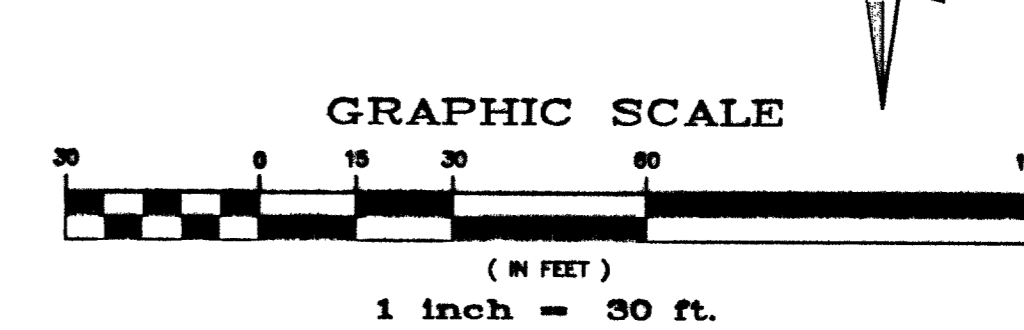

BASIS OF BEARINGS

NORTH 89°11'27" WEST - BEING THE SOUTH LINE OF THE SOUTHEAST QUARTER (SE 1/4) OF THE SOUTHWEST QUARTER (SW 1/4) OF SECTION 11, TOWNSHIP 19 SOUTH RANGE 80 EAST, M.D.M., CLARK COUNTY, NEVADA AS SHOWN BY A MAP ON FILE IN THE OFFICE OF THE CLARK COUNTY RECORDER IN FILE 73 OF SURVEYS, PAGE 14, OFFICIAL RECORDS.

BENCHMARK

CITY OF LAS VEGAS BENCHMARK 1LV90 14N4
 ELEVATION = BLM BRASS CAP, GRAND TETON DRIVE AND TORREY PINES DRIVE.
 NAVD 1988 DATUM
 ELEVATION = 722.7231 METERS / 2371.13 FEET

APPROVED FOR CONSTRUCTION

Pete J. Jarama
 LAS VEGAS VALLEY WATER DISTRICT
 7/22/03 DATE

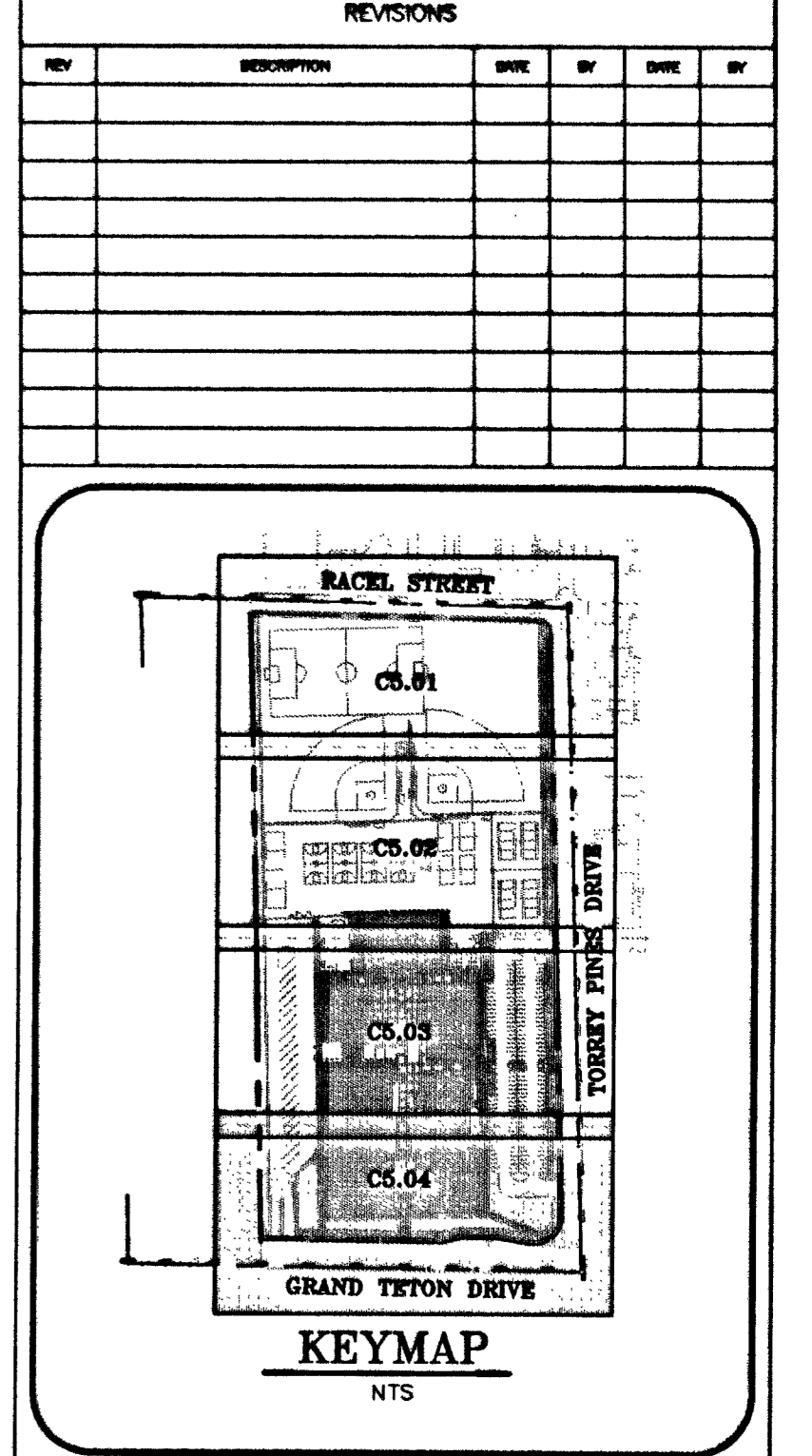

NOT A PART
 APR 125-11-804-001

Call before you DIG
 1-800-227-2900

Call before you OVERHEAD
 1-702-227-2929

VERMONT ENGINEERING & SURVEYING
 1000 W. 10TH AVENUE
 SUITE 100
 DENVER, CO 80202
 (303) 733-7777

VERMONT ENGINEERING & SURVEYING
 1000 W. 10TH AVENUE
 SUITE 100
 DENVER, CO 80202
 (303) 733-7777

PBS&J
 2240 COMMERCIAL DRIVE
 LAS VEGAS, NEVADA 89121
 (702) 435-1150

CLARK COUNTY SCHOOL DISTRICT
 CONSTRUCTION MANAGEMENT 4828 PEARL STREET LAS VEGAS, NEVADA 89121

ANTHONY SAVILLE MIDDLE SCHOOL
 FORMERLY KNOWN AS GRAND TETON - TORREY PINES MIDDLE SCHOOL

UTILITY PLAN

Architecture Design Planning
2480 EAST TOMPKINS AVENUE SUITE 222
LAS VEGAS, NEVADA 89121
MELLES - PURSLEY ARCHITECTS
 (702) 435-1150

APPROVED FOR CONSTRUCTION
 75-150
C5.03