

TORREY PINES DRIVE  
SEE SHEET C4.02 - C4.03  
FOR ADDITIONAL INFO

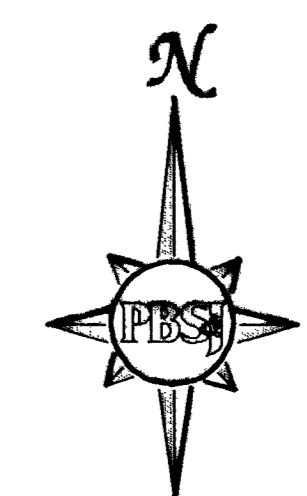

REVISIONS				
NO.	DESCRIPTION	DATE	BY	CHK

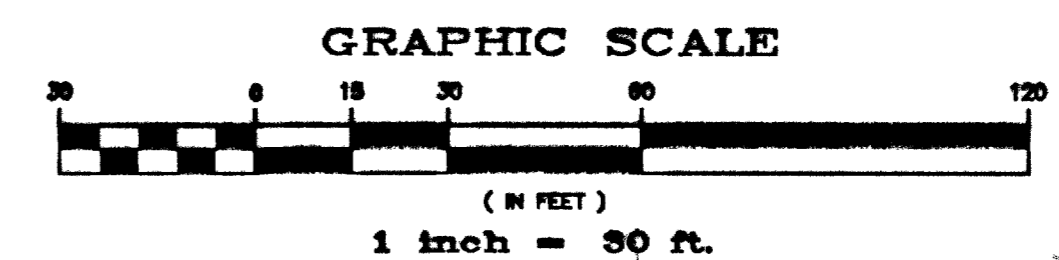
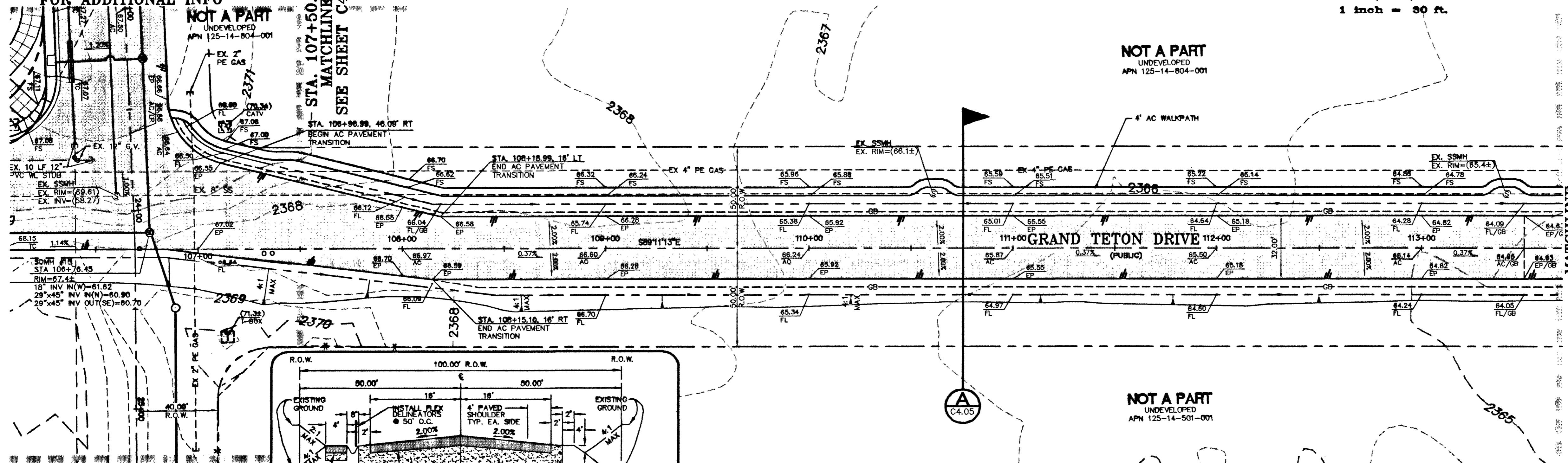
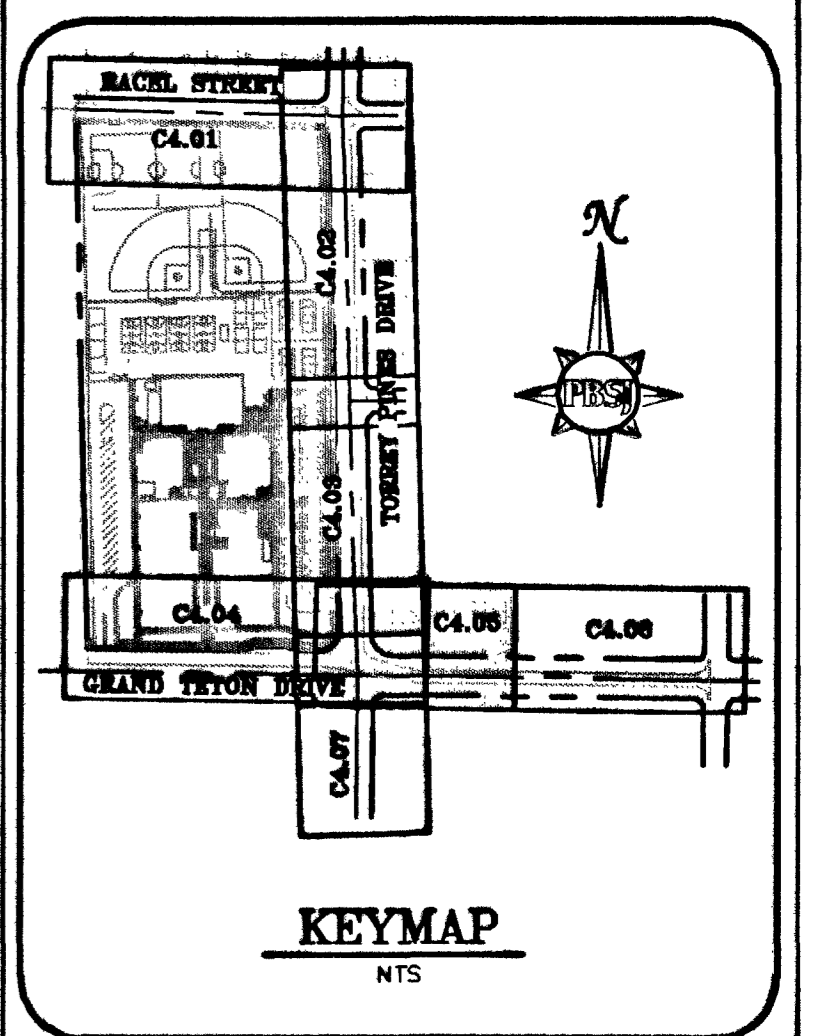

TORREY PINES DRIVE  
SEE SHEET C4.07  
FOR ADDITIONAL INFO

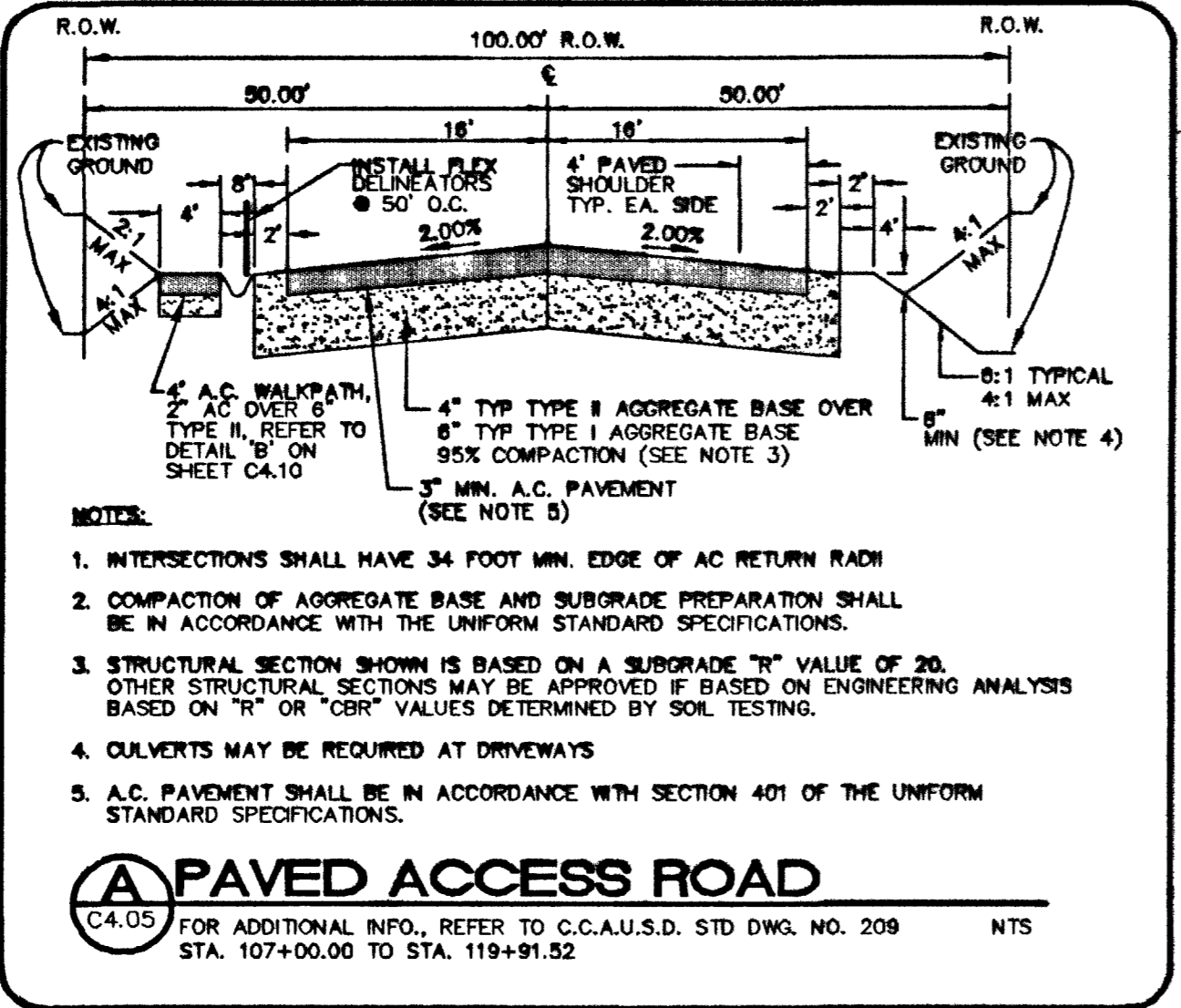

**BENCHMARK**  
CITY OF LAS VEGAS BENCHMARK 11V90 14N4  
ELEVATION = BLM BRASS CAP, GRAND TETON DRIVE  
AND TORREY PINES DRIVE.  
NAVD 1988 DATUM  
ELEVATION = 722.7231 METERS / 2371.13 FEET

**BASIS OF BEARINGS**  
NORTH 89°11'27" WEST - BEING THE SOUTH LINE OF THE  
SOUTHEAST QUARTER (SE 1/4) OF THE SOUTHWEST QUARTER  
(SW 1/4) OF SECTION 11, TOWNSHIP 19 SOUTH RANGE 60  
EAST, M.D.M., CLARK COUNTY, NEVADA AS SHOWN BY A MAP  
ON FILE IN THE OFFICE OF THE CLARK COUNTY RECORDER IN  
FILE 73 OF SURVEYS, PAGE 14, OFFICIAL RECORDS.

**LEGEND**  
  
**NOTE:**  
ALL SEWER/STORM DRAINS CROSSING WATER LINES MUST CONFORM TO SECTION 2.19 OF UNIFORM DESIGN AND CONSTRUCTION STANDARDS FOR WATER DISTRIBUTION SYSTEMS (UDAS) FOR WATER AND STORM DRAIN CROSSINGS AND CLEARANCES.

**CLARK COUNTY DEPT. OF DEVELOPMENT**  
**SERVICES ENGINEERING DIVISION**  
ACCEPTANCE OF PLANS FOR FILING BY:  
ACCEPTANCE OF THESE PLANS FOR FILING SHALL NOT BE CONSIDERED AS A PROMISE FOR OR AN APPROVAL OF ANY RELATION OF ANY OF THESE PROVISIONS OF THE STATE OR COUNTY LAWS AND/OR SPECIFICATIONS. CLARK COUNTY SHALL BE HELD FREE FROM DAMAGES WHICH MAY RESULT FROM CONSTRUCTION OF THE IMPROVEMENTS FROM THE ENGINEERING DESIGN DEPICTED HEREIN.  
NOTE: POWER POLES AND/OR OTHER EXISTING FACILITIES NOT PROPERLY LOCATED BASED ON PROPOSED IMPROVEMENTS SHOWN HEREON WILL BE RELOCATED AT NO EXPENSE TO CLARK COUNTY.

**APPROVED FOR CONSTRUCTION**  
*[Signature]* 7-22-03  
LAS VEGAS VALLEY WATER DISTRICT DATE

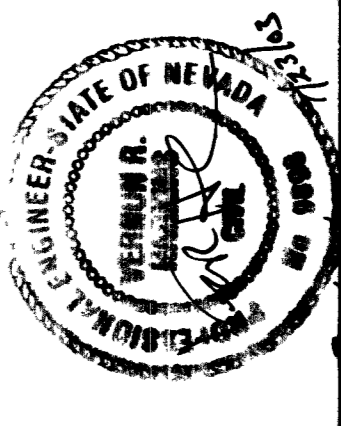

**Call before you DIG**  
1-800-727-2800  
**Call before you OVERHEAD**  
1-702-727-2828

**GRAND TETON DRIVE** SCALE: 1"=30' HORZ.  
1"=3' VERT.

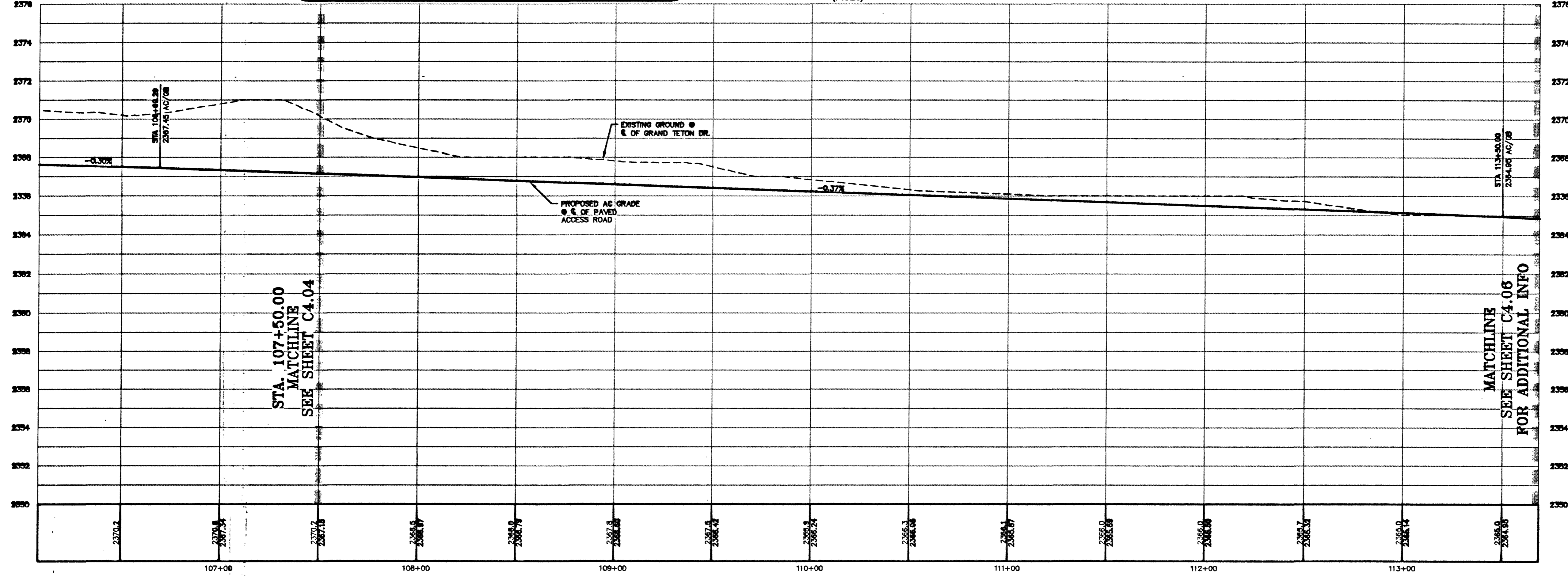

STA. 107+50.00  
MATCHLINE  
SEE SHEET C4.04

MATCHLINE  
SEE SHEET C4.06  
FOR ADDITIONAL INFO

NO.	DATE	BY	CHK

**PBS&J**  
2225 Corporate Center Drive  
Las Vegas, NV 89121  
Tel: 702-735-7272  
Fax: 702-735-7273  
www.pbsandj.com

**CLARK COUNTY SCHOOL DISTRICT**  
CONSTRUCTION MANAGEMENT 4828 PEARL STREET LAS VEGAS, NEVADA 89121  
**ANTHONY SAVILLE MIDDLE SCHOOL**  
FORMERLY KNOWN AS GRAND TETON - TORREY PINES MIDDLE SCHOOL  
**OFFSITE, GRAND TETON DRIVE**

**WELLES - PUSLEY ARCHITECTS**  
2480 EAST TOMPKINS AVENUE SUITE 222  
LAS VEGAS, NEVADA 89121  
(702) 435-1150

**715-150 C4.05**

50805