

ALTESSA AT THE VISTAS

VILLAGE 20 PARCEL "S"

IMPROVEMENT PLANS

FOR

PACIFIC PROPERTIES

IN THE

CITY OF LAS VEGAS, STATE OF NEVADA

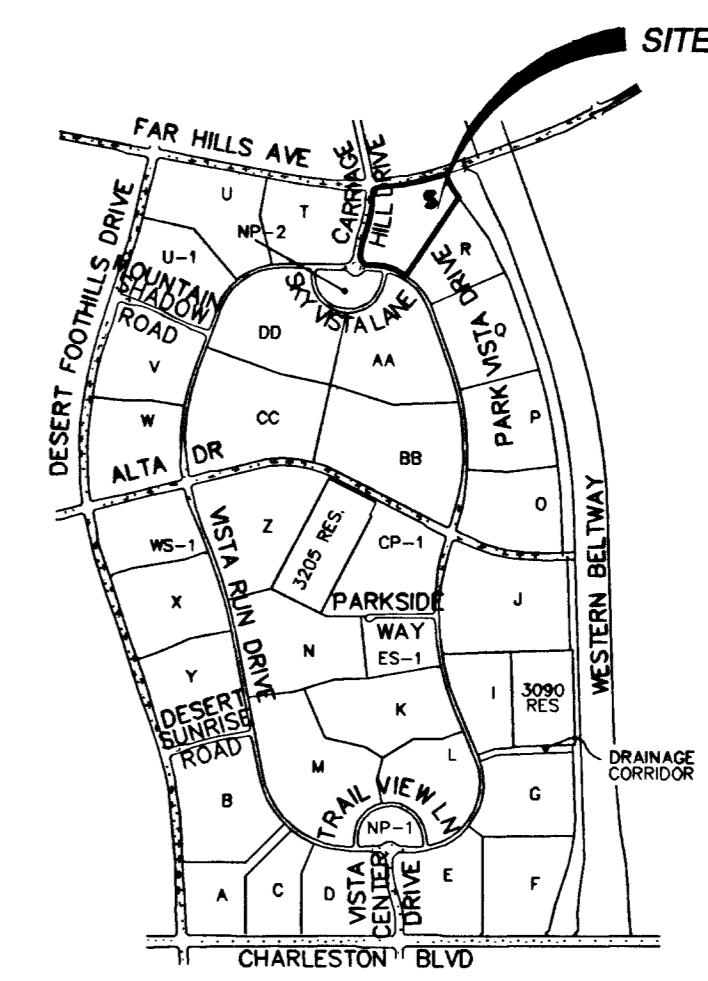

VICINITY MAP

BENCHMARK

CITY OF LAS VEGAS VERTICAL CONTROL v6-02
RIVET & PLASTE IN CONCRETE BASE OF STEEL
POWER POLE. (X433)

STATION 9LV09
26N6
ELEVATION= 978.178 METERS (NAVD88)
3209.24 FEET

PROJECT BENCHMARK = CLV BM - 0.74'

BASIS OF BEARINGS

SOUTH 07°28'00"WEST BEING THE CHORD BEARING FROM
THE INTERSECTION OF CARRIAGE HILL DRIVE AND FAR
HILLS AVENUE TO THE PT ON CARRIAGE HILL DRIVE,
449.72' SOUTH, AS SHOWN ON THE PLAT OF THE VISTAS
AT SUMMERLIN VILLAGE 20 UNIT NO. 2, BOOK 98 PAGE
11 IN THE OFFICE OF THE CLARK COUNTY NEVADA
RECORDER.

LEGAL DESCRIPTION

LOT ONE (1) IN BLOCK A OF THE VISTAS AT SUMMERLIN VILLAGE 20 UNIT NO. 2,
AS SHOWN BY MAP THEREOF ON FILE IN BOOK 98 OF PLATS, PAGE 11, IN THE
OFFICE OF THE COUNTY RECORDER OF CLARK COUNTY, NEVADA, SITUATE IN THE
SOUTH HALF (S 1/2) OF SECTION 26, TOWNSHIP 20 SOUTH, RANGE 59 EAST, M.D.M.,
CITY OF LAS VEGAS, CLARK COUNTY, NEVADA.

OWNER/DEVELOPER

PACIFIC PROPERTIES
C/O MARK TOMLINSON
3993 HOWARD HUGHES
PARKWAY, #200
LAS VEGAS, NV

DEVIATIONS FROM STANDARDS

NONE



SITE ACREAGE: 16.4 GROSS
APN 137-26-719-001, APN 137-26-310-001

SITE PLAN

SHEET INDEX

1. COVER SHEET
2. NOTES, ABBREVIATIONS, AND LEGEND
3. GRADING PLAN
4. GRADING NOTES AND DETAILS
5. GRADING NOTES AND DETAILS
6. UTILITY PLAN

APPROVALS

Gerald M. Robbins 3.28.03
SUMMERLIN SDR
GERALD M. ROBBINS DATE

Charles K. Kowalski 4/21/2003
CHARLES KAJKOWSKI, JR.; PE #4784
CITY ENGINEER DATE

APPROVAL OF THESE PLANS IS LIMITED TO THOSE IMPROVEMENTS CONSTRUCTED
IN THE DEDICATED RIGHT-OF-WAY AND/OR DEDICATED EASEMENTS. THIS
APPROVAL DOES NOT AUTHORIZE THE CONSTRUCTION OF ANY IMPROVEMENTS
THAT DEVIATE FROM ADOPTED STANDARDS AND/OR SPECIFICATIONS, EXCEPT
THOSE SPECIFICALLY LISTED UNDER DEVIATIONS FROM STANDARD. THE
ENGINEER SHALL RESOLVE ANY DEVIATION OTHER THAN THOSE LISTED IN
DEVIATIONS FROM STANDARDS IN FAVOR OF THE UNIFORM STANDARD DRAWINGS
AND SPECIFICATIONS CLARK COUNTY AREA, NEVADA.

M. Margo Wheeler
M. MARGO WHEELER, AICP, CURRENT PLANNING MANAGER DATE

THIS PLAN MEETS THE APPLICABLE STANDARDS OF THE PLANNING AND
DEVELOPMENT DEPARTMENT.
Jeff Marshall 3.7.03
CITY FIRE MARSHAL DATE

LAS VEGAS VALLEY WATER DISTRICT DATE
Richard A. Crumling 3/4/03
NEVADA POWER COMPANY DATE

Joel Martell 3/10/03
SOUTHWEST GAS DATE

THE ENGINEER'S KNOWLEDGE
THAT WE HAVE REVIEWED THESE PLANS AND
WILL PROVIDE SERVICE TO THE ELECTRICAL
SYSTEM ASSOCIATED WITH THE PROJECT.
NEVADA POWER COMPANY RESERVES THE
RIGHT TO ADDRESS ANY EXISTING OR FUTURE
CONFLICTS ONCE THE FINAL DESIGN IS COMPLETED.
THE NEW SERVICE AND THE RESOLUTION OF ANY
CONFLICTS WILL BE ACCORDING TO THE NEVADA PUBLIC UTILITY COMMISSION'S RULES
AND REGULATIONS.

NO.	DATE	BY	APPROV.	REVISION DESCRIPTION

3610 North Rancho Drive
Las Vegas, Nevada 89130
Telephone: (702) 648-9700
Fax: (702) 648-4143

ENGINEERING
SOUTHWEST
LAND PLANNING • MAPPING • DEVELOPMENT

COVER SHEET

PROJECT: ALTESSA AT THE VISTAS
PACIFIC PROPERTIES

CITY OF LAS VEGAS

TITLE: COVER SHEET

WORK ORDER NO.: 020426

DESIGN BY: CP

DATE: 2-15-03

SCALE: N.T.S.

CADFILE: ppcov

SHEET 1 OF 6 SHEETS

CLV DWG NO.: 107-V3688

NOTICE TO CONTRACTOR !

EXISTING UTILITY LOCATIONS SHOWN HEREON ARE APPROXIMATE ONLY. IT SHALL BE THE CONTRACTOR'S RESPONSIBILITY TO DETERMINE THE EXACT VERTICAL AND HORIZONTAL LOCATION OF ALL EXISTING UNDERGROUND UTILITIES PRIOR TO COMMENCING CONSTRUCTION. NO REPRESENTATION IS MADE THAT ALL EXISTING UTILITIES ARE SHOWN HEREON. THE ENGINEER ASSUMES NO RESPONSIBILITY FOR UTILITIES NOT SHOWN OR UTILITIES NOT SHOWN IN THEIR PROPER LOCATION. **58555**

AVOID CUTTING UNDERGROUND UTILITIES. IT'S COSTLY.
CALL before you Dig
1-800-227-2600
UNDERGROUND SERVICE (USA)

AVOID HITTING OVERHEAD POWER LINES. IT'S COSTLY.
CALL BEFORE YOU DO OVERHEAD
CALL 1-702-593-6111