

INDEX OF SHEETS

SHEET	NO	1	TITLE SHEET
SHEET	NO	2	SPECIAL DETAILS(MANHOLE)
SHEET	NO	3	SPECIAL DETAILS(INLET BOX)
SHEET	NO	4	PLAN AND PROFILE
SHEET	NO	5	PLAN AND PROFILE
SHEET	NO	6	PLAN AND PROFILE
SHEET	NO	7	PLAN AND PROFILE
SHEET	NO	8	PLAN AND PROFILE
SHEET	NO	9	PLAN AND PROFILE
SHEET	NO	10	PLAN AND PROFILE
SHEET	NO	11	STREET IMPROVEMENTS
SHEET	NO	12	STREET IMPROVEMENTS

CITY OF LAS VEGAS, NEVADA

OFFICE OF THE CITY ENGINEER

**PLAN AND PROFILE OF PROPOSED
STORM SEWER COLLECTION SYSTEM**

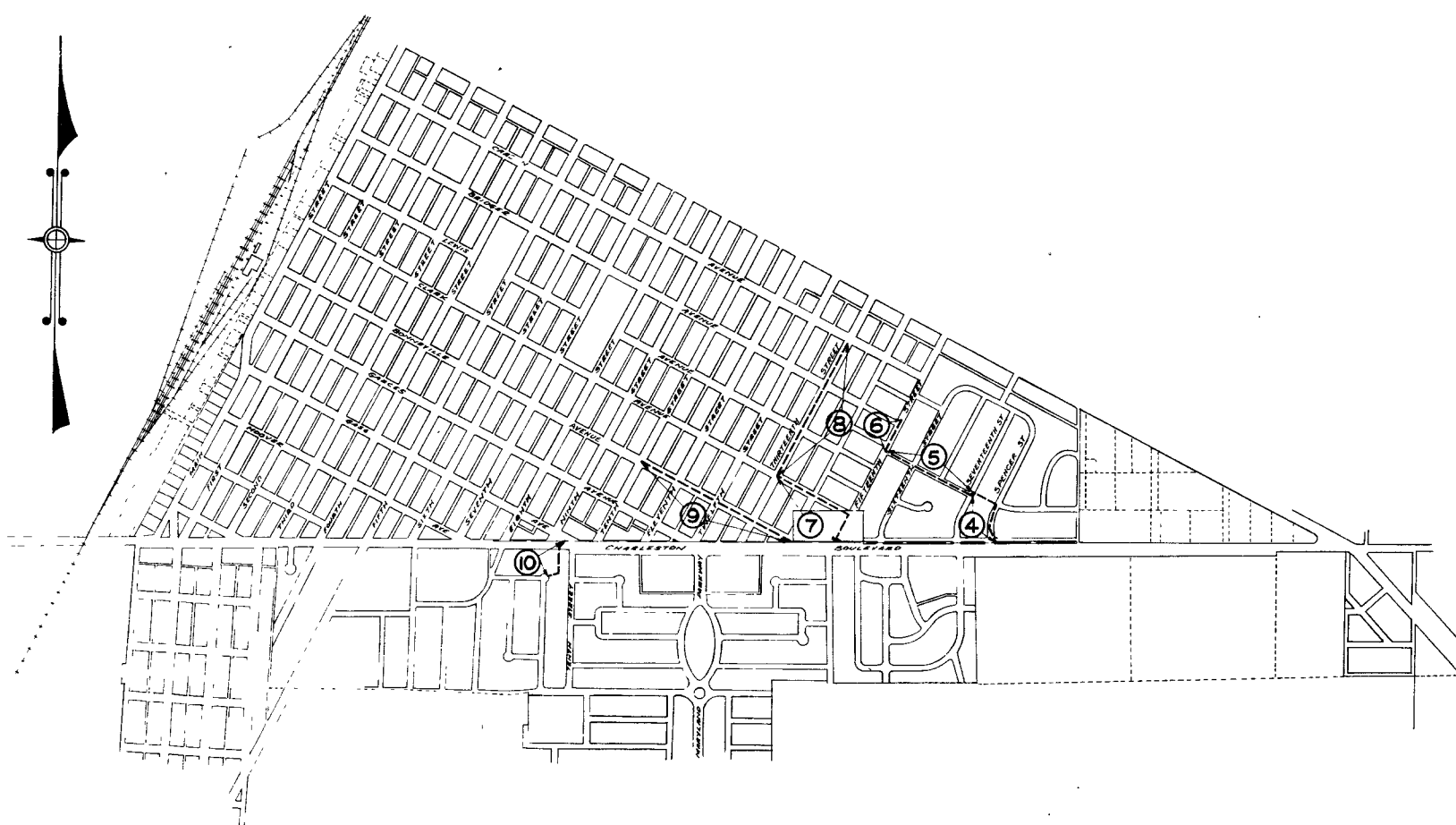

LEGEND

- STORM SEWER
- STORM SEWER MANHOLE
- STORM SEWER DROP INLET
- SANITARY SEWER
- WATER LINE
- GAS MAIN

APPROVED *July 1, 1948*

J. M. Murphy
J. M. MURPHY - CITY MANAGER

C. G. Petrie
C. G. PETRIE - CITY ENGINEER

51545

107-V3689