

NOTE:

- A.C. SERVICE CONDUCTORS TO BE 3 BLACK AND ONE WHITE AND SHALL BE NO. 4 A.W.G. THW.
- CONTRACTOR IS TO REMOVE ALL PRESSURE PADS COMPLETELY.
- A.C. SERVICE TO BE LOCATED BY POWER COMPANY.
-
- THE CONTRACTOR SHALL REMOVE ALL EXISTING SIGNAL EQUIPMENT AND DELIVER TO THE SIGNAL SHOP AT THE CITY YARD.
- THE CONTRACTOR SHALL INSTALL ALL WIRE AND CABLE TERMINAL TO TERMINAL WITH NO SPLICING OTHER THAN LOOP LEAD-IN INTO P.B. ADJACENT TO ROADWAY.
- ALL ISLAND FLASHERS HAVE AMBER LENSES.
- THE CONTRACTOR SHALL BE RESPONSIBLE FOR DAMAGE TO EXISTING UNDERGROUND UTILITIES.
-
-
-
- ALL LIGHTING CIRCUITS SHALL HAVE 10 A.W.G. WIRE AND BE FUSED IN CABINET USING IN-LINE FUSE HOLDER.
- EXISTING POLE TO BE REMOVED AND BROUGHT TO SIGNAL SHOP AT CITY YARD AND WIRING TO BE PULLED BACK TO THE NEXT POLE NORTH OF INTERSECTION.
- EXISTING POLE IS TO BE MOVED ACCORDING TO STREET LIGHTING DESIGN DRAWING
- ALL LOOPS TO BE LOCATED BY ENGINEER IN THE FIELD.
- PED. SIGNALS ARE TO BE PORTLAND ORANGE AND LUNAR WHITE. PUSH BUTTON SIGNS SHALL BE 9"X12" WITH FULL MOUNTING BRACKET.
- THE ROUTING AND TERMINATION OF CONDUIT SHALL BE AS INDICATED ON THE PLANS UNLESS OTHERWISE DIRECTED BY ENGINEER.
- THE LOCATION OF THE CONTROLLER, PULLBOXES AND CONDUIT RUNS ARE TO BE WITHIN THE EXISTING RIGHT OF WAY.
- THE ACTUAL LOCATION OF SIGNAL POLES ARE SUBJECT TO A SLIGHT VARIATION
- IT SHALL BE THE CONTRACTOR'S RESPONSIBILITY, IN PLACING CONDUIT, TO AVOID ANY AND ALL CONFLICTS WITH OBSTRUCTIONS.
- SIGNAL CABLE SHALL BE EITHER A 10 OR 20 CONDUCTOR (NO. 14 A.W.G.) CABLE (I.M.S.A. SPEC. 20-1).
- LOOP DETECTOR LEADS SHALL BE ONE TWISTED PAIR OF NO. 12 A.W.G. CABLE (I.M.S.A. SPEC. 20-2).
- 15' COILED INTERCONNECT CABLE IN PULLBOX TO BE PLACED IN RUN 34 TO CONTROLLER
- ALL VEHICLE SIGNAL LENSES SHALL BE 12"
- LUMINAIRES SHALL HAVE 400 WATT HIGH-PRESSURE SODIUM LAMPS WITH M-C-11 DISTRIBUTION AND INDIVIDUAL P.E. CONTROL AND BUILT-IN BALLASTS (120 V.A.C.).
- FOUR R3-10 SIGNS (24 X 30) REQUIRED.
- CONTROLLER SHALL BE HOUSED IN A TYPE "R" CABINET COMPLETE WITH EXHAUST FAN AND THERMOSTAT CONTROL. CABINET SHALL BE PAINTED WHITE INSIDE AND OUTSIDE.
- EACH LOOP DETECTOR LEAD-IN CABLE REPRESENTS A SEPARATE AMPLIFIER UNIT REQUIRED (FOURTEEN REQUIRED).
- ALL NECESSARY AMPLIFIER UNITS, MODULES, LIGHT CONTROL UNITS, SWITCHES, FLASHERS, ECT. SHALL BE WIRED IN CABINET TO ACTIVATE THE EIGHT PHASE OPERATION SHOWN IN DIAGRAM.
- A.C. SERVICE SHALL HAVE 1/8" RISER CONDUCTORS WITH A 200 AMP. SERVICE (CHARLESTON AND EASTERN USE THE SAME SERVICE AS EASTERN AND FRENCH).
- POLES A,C,E,G SHALL HAVE INTERNALLY LUMINATED STREET NAME SIGN INSTALLED. THE SIGN SHALL BE WIRED TO THE LUMINAIRE PHOTO CELL FOR CONTROL. SIGNS ON POLES "B" & "C" SHALL READ EASTERN AVE AND ON POLES "A" & "E" SHALL READ CHARLESTON BL (SEE DRAWING NO. 208-V211).

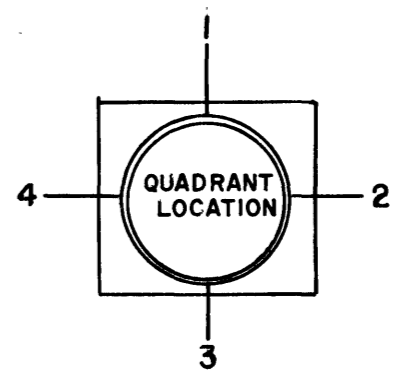
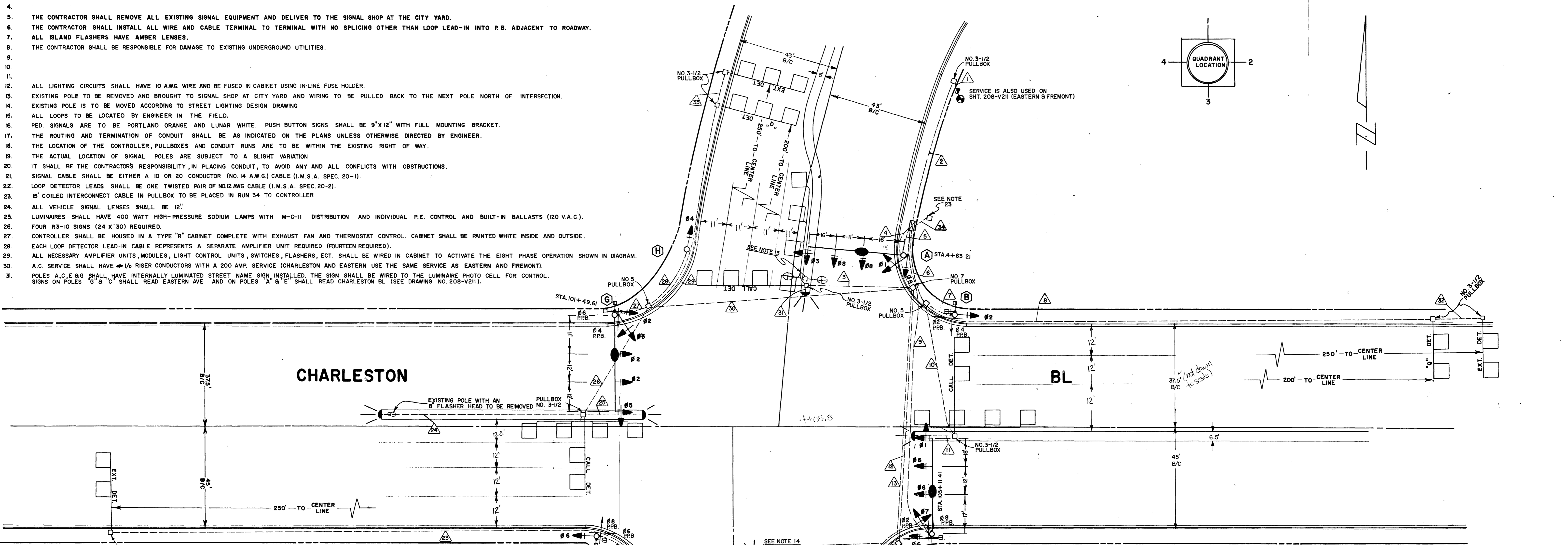

RUN NO	FROM	TO	CONDUIT SIZE	SIGNAL CABLE	DET LEADS	LIGHTING	CR	INTERCONNECT	SERVICE
1	A.C. SERVICE	PULLBOX	2"						X
2	PULLBOX	CONTROLLER	2"						X
3	PULLBOX	PULLBOX	2"						
4	CONTROLLER	PULLBOX	3 EACH 2"	XX	XX XX	XX	XXXX		
5	CONTROLLER	POLE "A"	2"	X				X	
6	CONTROLLER	PULLBOX	2"	X		XXXX		X	
7	PULLBOX	POLE "B"	2"	X					
8	PULLBOX	PULLBOX	1"			XX			
9	CONTROLLER	POLE "C"	2"	X				X	
10	PULLBOX	PULLBOX	2"			XX		X	
11	PULLBOX	ISLAND FLASHER	1"					X	
12	PULLBOX	PULLBOX	2"	X		XX		X	
13	PULLBOX	PULLBOX	2"			XX		XX	
14	POLE "C"	POLE "D"	2"	X					
15	PULLBOX	PULLBOX	2"						X
16	PULLBOX	PULLBOX	1"					X	
17	PULLBOX	PULLBOX	2"			XX		XX	
18	PULLBOX	ISLAND FLASHER	1"					X	
19	PULLBOX	ISLAND FLASHER	1"					X	
20	PULLBOX	PULLBOX	2"	X		X		X	
21	PULLBOX	POLE "E"	2"	X	X			X	
22	PULLBOX	POLE "F"	2"	X					
23	PULLBOX	PULLBOX	1"					X	
24	PULLBOX	ISLAND FLASHER	1"					X	
25	PULLBOX	ISLAND FLASHER	1"					X	
26	PULLBOX	PULLBOX	2"			XX		XX	
27	PULLBOX	POLE "G"	2"	X	X			X	
28	PULLBOX	POLE "H"	2"	X					
29	PULLBOX	PULLBOX	1"					XX	
30	PULLBOX	PULLBOX	2"	X		XXXX		X	XX
31	PULLBOX	ISLAND FLASHER	1"					X	
32	PULLBOX	PULLBOX	1"					X	
33	PULLBOX	PULLBOX	1"					X	
34	PULLBOX	CONTROLLER	2"						X

STATION	NO.	GA.	TYPE	POLE		SIGNALS (VEH)		SIGNALS (PED)		PED. PUSH BUTTON	
				SIGNAL ARM QUAD. LENGTH	LUM. ARM QUAD. LENGTH	QUADRANT	TYPE	QUADRANT	MOUNTING	QUADRANT	ARROW
4+63.21	A	II	XX	4 43'	4 15'	MA	(2)M-2, M-3				
	B	II	I-A			2	B-7T			4	RT.
	C	II	I-A			3	A-2T	1	W-3T	3	LT.
	D	II	I-A			3	A-2T			3	LT.
103+11.41	E	II	XX	1 47'	1 15'	MA	(2)M-2, M-3				
	F	II	I-A			4	B-7T				
	G	II	I-A			3	A-2T	3	W-3T	2	RT.
	H	II	I-A			1	B-7T			1	LT.
3+06.4	E	II	XX	2 43'	2 15'	MA	(2)M-2, M-3				
	F	II	I-A			4	B-7T				
101+49.61	G	II	XX	3 35'	3 15'	MA	(2)M-2, M-3				
	H	II	I-A			1	B-7T	1	W-3T	2	LT.

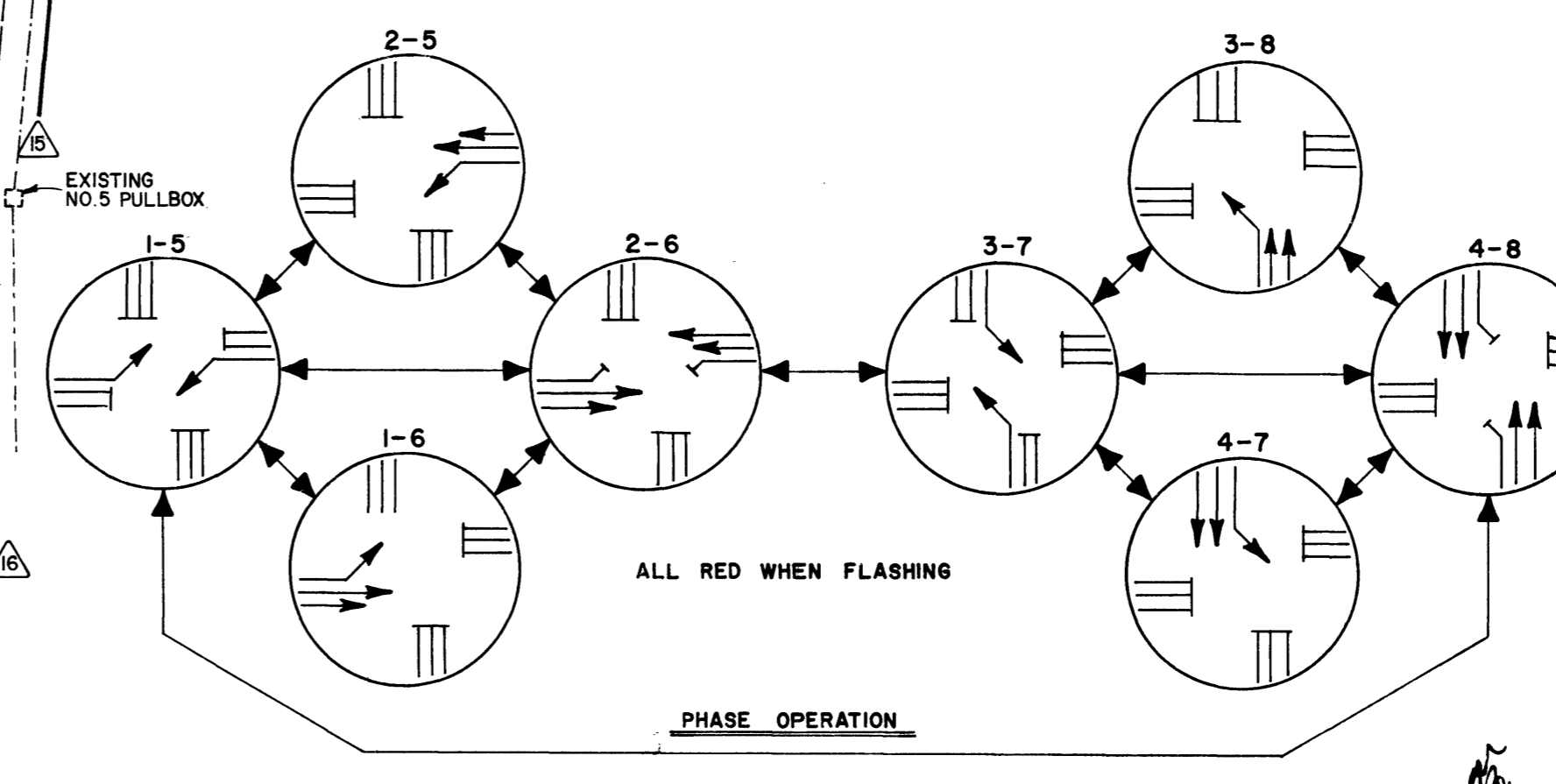

AS BUILT

EXISTING UTILITIES ARE LOCATED ON THE PLANS FOR THE CONTRACTOR'S INFORMATION ONLY. THE CONTRACTOR SHALL VERIFY THE LOCATION AND DEPTH OF ALL UTILITIES BY FIELD SURVEY. UTILITIES NOT SHOWN ON THE PLANS OR NOT IN THE LOCATION SHOWN ON THE PLANS.

[Signature]
7/28/76

CITY OF LAS VEGAS NEVADA
DEPARTMENT OF PUBLIC WORKS
TRAFFIC ENGINEERING DIVISION

TRAFFIC SIGNALS
CHARLESTON BL & EASTERN AVE

W.O. NO.	SCALE 1" = 20'	DATE	DRAWING NO.
DR. ANTONIO SMITH		7-2-76	208-V211 B
APPROVED BY TRAFFIC ENGINEER		11-23-76	FILE NO.
APPROVED BY DIRECTOR OF PUBLIC WORKS		12/6/76	SHEET OF

[Signature]
DATE