

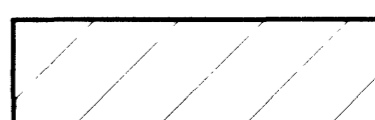

**LEGEND**

-  NEW A.C. PAVEMENT (SEE TYPICAL X-SECTIONS)
-  EXISTING A.C. PAVEMENT TO BE REMOVED
-  EXISTING A.C. PAVEMENT TO REMAIN WITH NEW 3" MIN. A.C. OVERLAY (SEE TYPICAL X-SECTIONS)
-  EXISTING A.C. PAVEMENT TO REMAIN WITH NEW 1 1/2" MIN. A.C. OVERLAY (SEE TYPICAL X-SECTIONS)
-  NEW TEMPORARY A.C. (SEE TYPICAL X-SECTIONS)
-  NEW CONCRETE MEDIAN
-  EXISTING A.C. PAVEMENT TO BE MILLED AND OVERLAYED WITH NEW A.C.
-  NEW TYPE II AGGREGATE

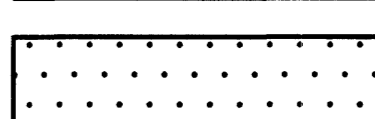
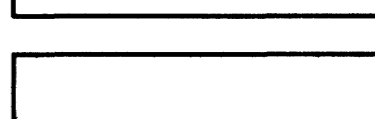
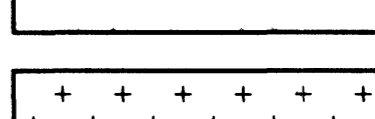
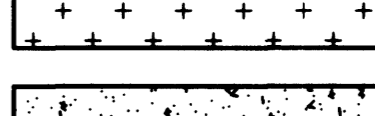
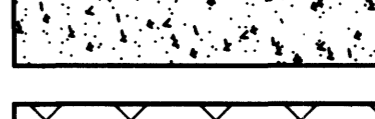

**CURVE TABLE**

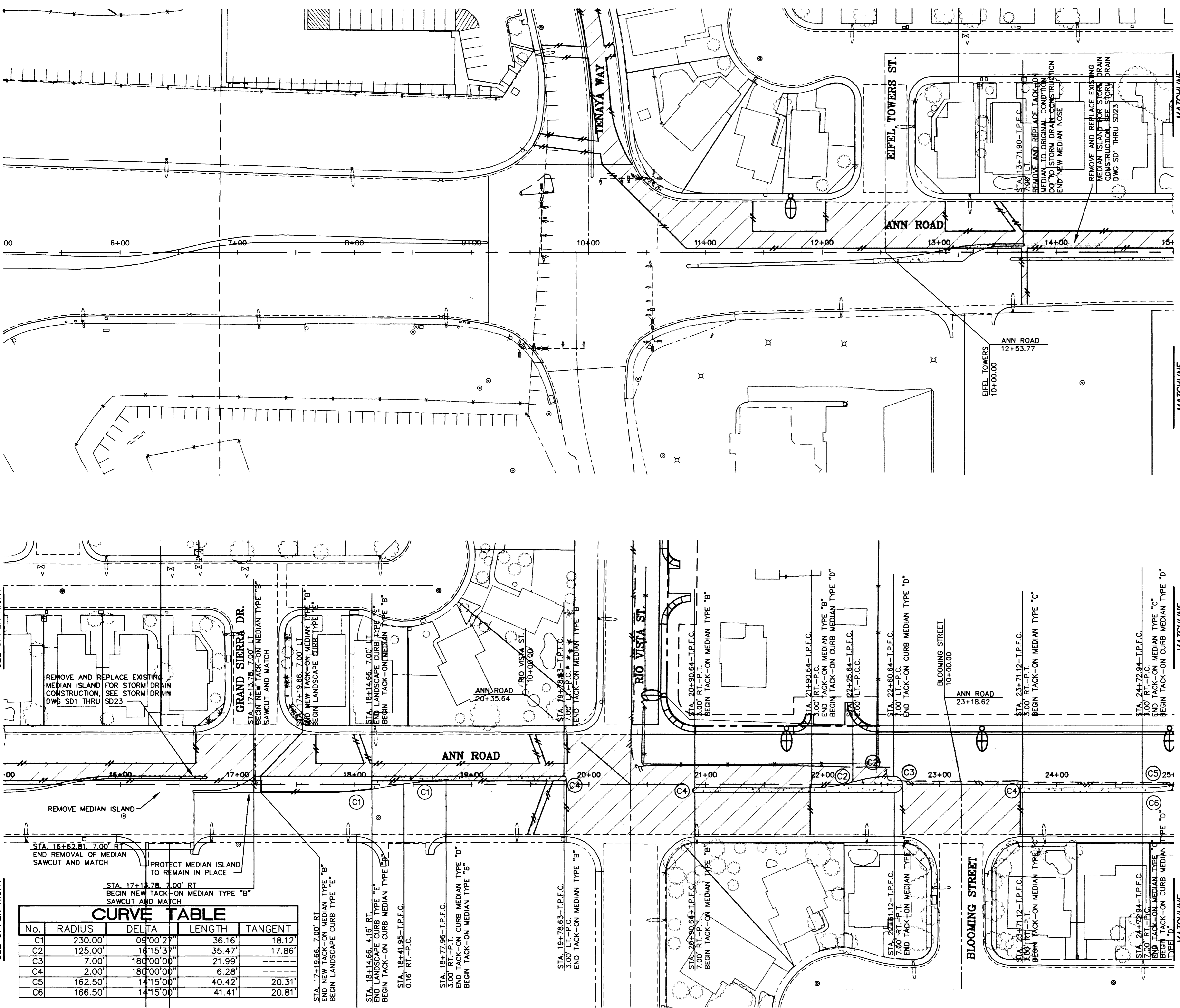
No.	RADIUS	DELTA	LENGTH	TANGENT
C1	230.00'	09°00'27"	36.16'	18.12'
C2	125.00'	16°15'37"	35.47'	17.86'
C3	7.00'	180°00'00"	21.99'	---
C4	2.00'	180°00'00"	6.28'	---
C5	162.50'	14°15'00"	40.42'	20.31'
C6	166.50'	14°15'00"	41.41'	20.81'

DEPARTMENT OF PUBLIC WORKS  
CITY OF LAS VEGAS

CONSULTING ENGINEERS • PLANNERS • LAND SURVEYORS  
2727 SOUTH RAINBOW BOULEVARD  
LAS VEGAS, NEVADA 89102-5148 PHONE (702) 873-7550 FAX (702) 362-2597

**vtn nevada**

REV	DATE	BY	REVISION

TITLE: **MEDIAN ISLAND GEOMETRICS**  
STA 10+00.00 TO STA. 25+00.00

PROJECT: **ANN ROAD IMPROVEMENTS**  
US 95 TO DECATUR BLVD.

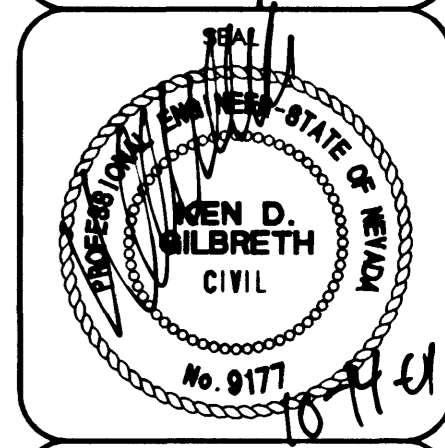

NO. NO.	5548
BY	LMW
DATE	10/05/01
SCALE	HORIZ. 1"=40' VERT. NONE
DRAWING SHEET	R28 74 OF 163 SHEETS