

- ### LEGEND
- NEW A.C. PAVEMENT (SEE TYPICAL X-SECTIONS)
 - EXISTING A.C. PAVEMENT TO BE REMOVED
 - EXISTING A.C. PAVEMENT TO REMAIN WITH NEW 3" MIN. A.C. OVERLAY (SEE TYPICAL X-SECTIONS)
 - EXISTING A.C. PAVEMENT TO REMAIN WITH NEW 1 1/2" MIN. A.C. OVERLAY (SEE TYPICAL X-SECTIONS)
 - NEW TEMPORARY A.C. (SEE TYPICAL X-SECTIONS)
 - NEW CONCRETE MEDIAN
 - EXISTING A.C. PAVEMENT TO BE MILLED AND OVERLAIN WITH NEW A.C.
 - NEW TYPE II AGGREGATE

- ### CONSTRUCTION NOTES
- 1 PROTECT IN PLACE
 - 3 REMOVE
 - 5 CONSTRUCT SIDEWALK PER USD NO. 235
 - 6 CONSTRUCT "L" TYPE CURB AND GUTTER PER USD NO. 216
 - 21 EDGE OF NEW AC PAVEMENT
 - 33 SAWCUT & MATCH EXISTING AC

VIN PROJECT BENCHMARK

PROJECT DATUM: NAVD88
 CITY OF LAS VEGAS BENCHMARK 1LV90-36NES
 NAVD88 ELEVATION: 681.303 METERS (2235.24 FEET)
 (PENTACORE - 2235.24 FEET)

RIVET AND PLATE IN TOP OF CURB, SW CORNER OF ANN ROAD AND DECATUR BLVD.

PENTACORE PROJECT BENCHMARK

PROJECT DATUM: NAVD88
 CITY OF LAS VEGAS BENCHMARK 1LV90-36NES
 NAVD88 ELEVATION: 681.303 METERS (2235.24 FEET)
 (VIN - 2235.24 FEET)

RIVET AND PLATE IN TOP OF CURB, SW CORNER OF ANN ROAD AND DECATUR BLVD.

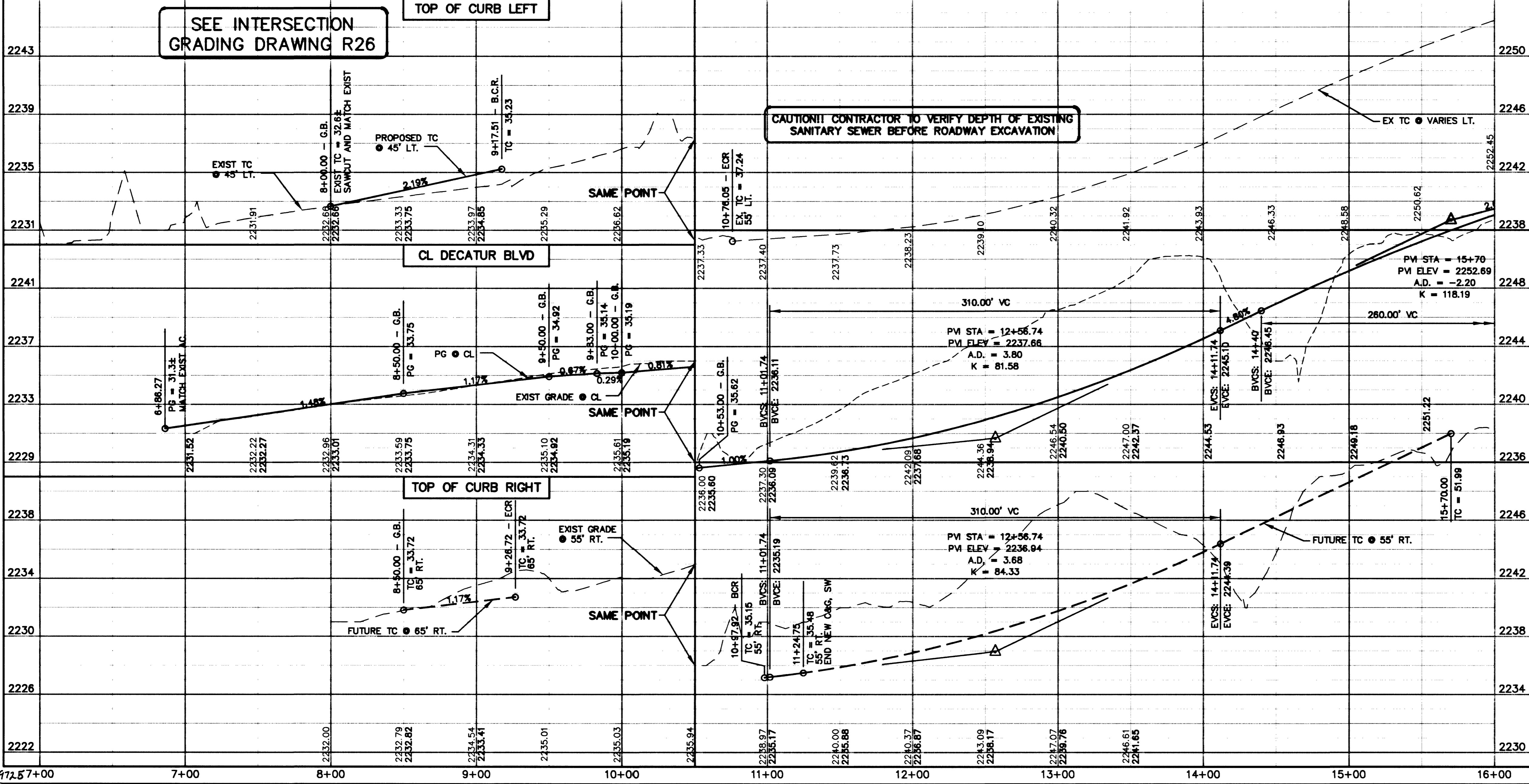

APPROVED

Ken D. Gilbreth 10/2/01
 LAS VEGAS VALLEY WATER DISTRICT DATE

DEPARTMENT OF PUBLIC WORKS
 CITY OF LAS VEGAS

CONSULTING ENGINEERS • PLANNERS • LAND SURVEYORS
 2727 SOUTH RAINBOW BOULEVARD
 LAS VEGAS, NEVADA 89146-5148 PHONE (702) 873-7550 FAX (702) 362-2597

vti novada

TITLE ROADWAY PLAN & PROFILE
 STA 7+00.00 TO STA. 17+00.00
 DECATUR BLVD.

PROJECT ANN ROAD IMPROVEMENTS
 US 95 TO FERRELL STREET

KEN D. GILBRETH
 CIVIL
 No. 9177

WO. NO. 5546
 BY LMW
 DATE 10/05/01
 SCALE HORIZ. 1"=40'
 VERT. 1"=4'

DRAWING SHEET
R23 69 OF 163
 SHEETS

PS: PLOT, MS, W, PRE-W, PRE-WZ, A, CAD, PUBWMS, USAG, USAG-DWG