

SHILOH CHRISTIAN SCHOOL
A.P.N. #138-07-301-014
C.L.V. # 715-102

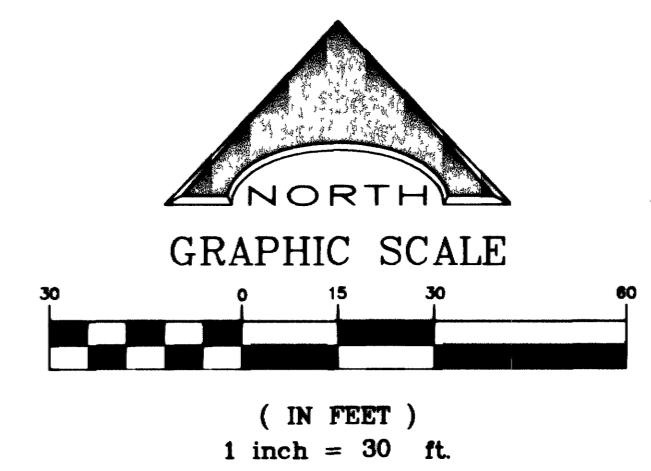

LEGEND

- PROPOSED WATER LINE
- PROPOSED WATER VALVE
- EXISTING WATER LINE
- EXISTING WATER VALVE
- EXISTING SANITARY SEWER W/ CLEANOUT
- EXISTING SANITARY SEWER MANHOLE
- PROPOSED FIRE HYDRANT
- PROPOSED SANITARY SEWER W/ CLEANOUT
- PROPOSED FINISHED FLOOR ELEVATION
- CONSTRUCTION NOTE - WATER
- CONSTRUCTION NOTE - SEWER

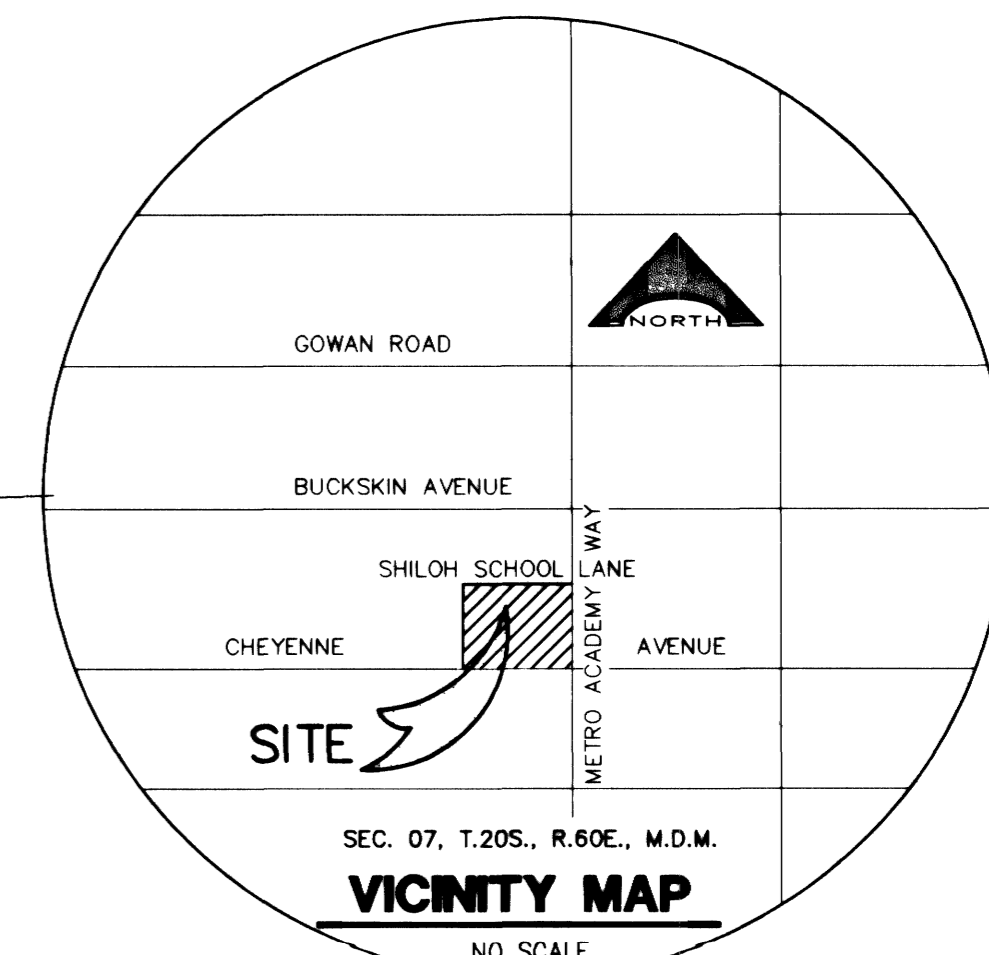
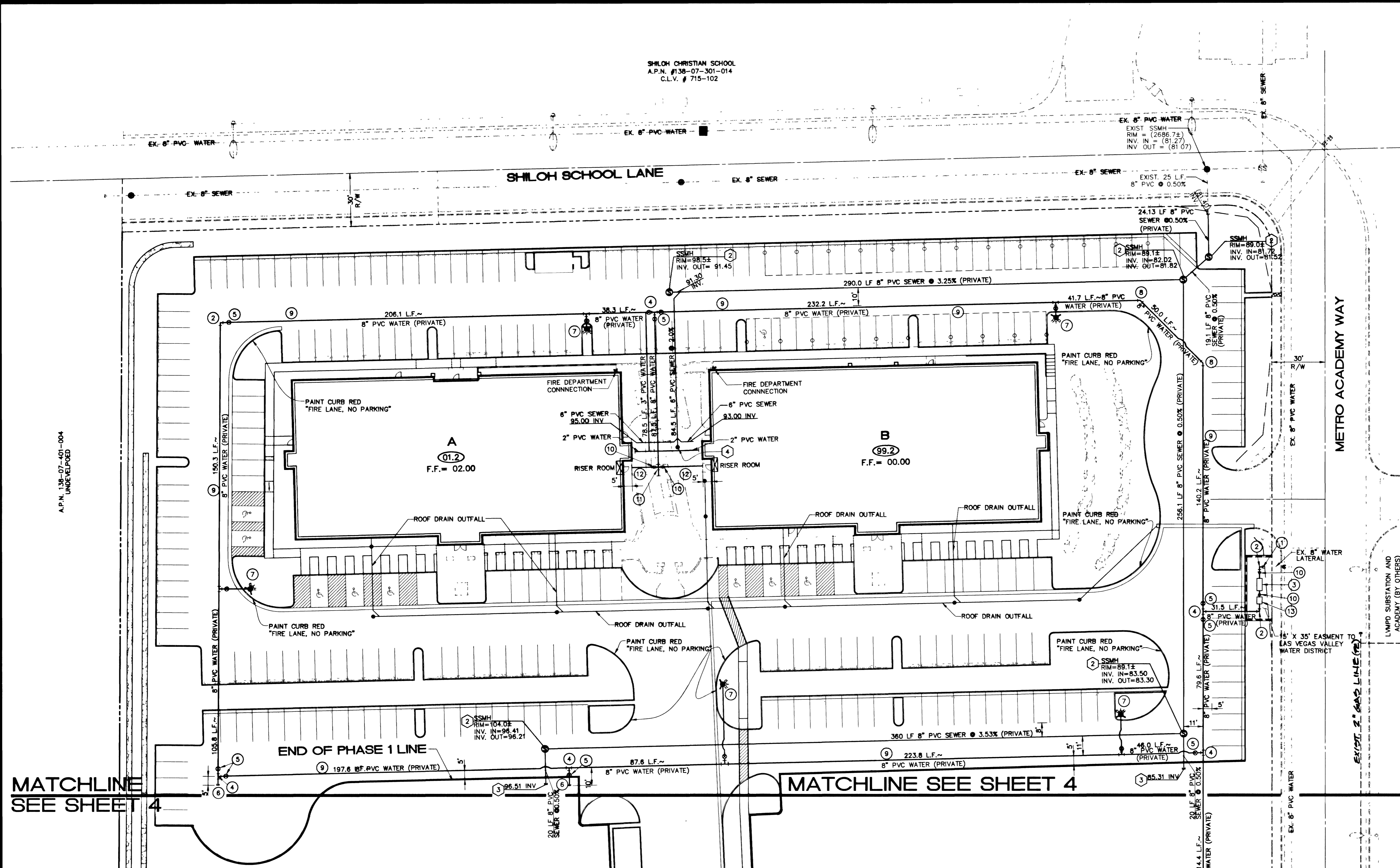
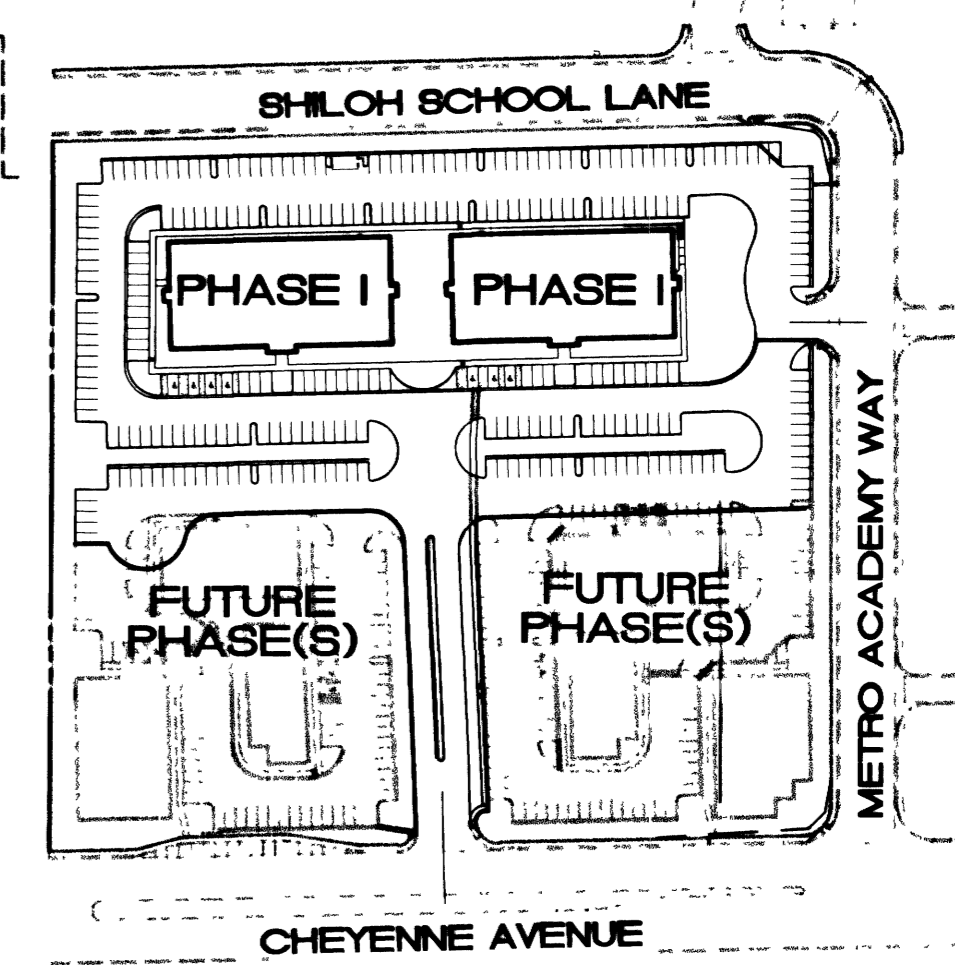

MATCHLINE SEE SHEET 4

MATCHLINE SEE SHEET 4

(2) 8" REDUCED PRESSURE PRINCIPLE ASSEMBLY

APPROVED REDUCED PRESSURE PRINCIPLE ASSEMBLY(S) SHALL BE INSTALLED PER THE UDACS PLATE NO. 11B. NO WATER SHALL BE TAKEN FROM A SERVICE REQUIRING BACKFLOW PREVENTION UNTIL THE REDUCED PRESSURE PRINCIPLE ASSEMBLY HAS BEEN SUCCESSFULLY TESTED BY THE LVWWD.

ANY BLOCK WALL OR OTHER FENCE MATERIAL SHALL BE DESIGNED AND CONSTRUCTED AROUND THE OUTSIDE OF THE EASEMENT(S) TO ALLOW THE DISTRICT DIRECT ACCESS FROM THE ADJACENT RIGHT-OF-WAY.

SEWER - CONSTRUCTION NOTES

- | QTY. | DESCRIPTION |
|------|--|
| 1 | REMOVE PLUG FROM EXISTING 8" SERVICE LATERAL |
| 2 | CONSTRUCT SEWER MANHOLE PER U.S.D. NO. 403 |
| 2 | STUB AND PLUG |
| 1 | INSTALL 6" CLEANOUT |

WATER - CONSTRUCTION NOTES

- 1 REMOVE EXISTING CAP AND INSTALL NEW 8" PVC SERVICE MAIN
- 2 8" ELL
- 3 6" x 2" COMBINATION METER WITH RPPA ASSEMBLY PER UDACS WATER, STANDARD PLATE, WITH ENCLOSURE APPROVED BY THE LAS VEGAS VALLEY WATER DISTRICT
- 4 8" TEE
- 5 8" GATE VALVE
- 6 8" CAP
- 7 FIRE HYDRANT ASSEMBLY - INCLUDES TEE, VALVE, LATERAL, RISER, THRUST BLOCKS, AND ALL ASSOCIATED HARDWARE.
- 8 8" 45° BEND
- 9 8" PVC WATER
- 10 8" x 6" REDUCER
- 11 8" CROSS
- 12 8" PVC WATER
- 13 8" R.P.P.A.

OWNER

CHAISSON FAMILY TRUST
C/O TERRA WEST REALTY & DEVELOPMENT
2685 S. RAINBOW BOULEVARD, #212
LAS VEGAS, NV 89146
(702) 362-8774

BENCHMARK

BM 1000 17NNW6
ELEVATION = 2519.82 (NAVD 88)
RIVET AND SQUARE ALUMINUM PLATE IN TOP OF CURB, ON THE SOUTH SIDE OF CHEYENNE AVE. AND THE EXTENDED ALIGNMENT OF CAMPBELL ROAD.

FIRE FLOW CALCULATIONS

FIRE FLOW REQUIREMENT IS: 2,500 GALLONS PER MINUTE AT 20 PSI RESIDUAL PRESSURE.

BASED ON:	VALUE
SQUARE FOOTAGE:	32,690 SF
LAREA AREA BETWEEN 4-HR AREA SEPARATION WALLS:	32,690 SF
BUILDING HEIGHT:	34 FT
NUMBER OF STORIES:	2 FLOORS
TYPE OF CONSTRUCTION:	TYPE V-N
OCCUPANCY:	OFFICE/COMMERCIAL
FULL AUTOMATIC FIRE SPRINKLER SYSTEM:	<input checked="" type="checkbox"/> YES <input type="checkbox"/> NO

REVIEWED BY: *[Signature]* DATE: 10/31/01
LAS VEGAS FIRE DEPARTMENT

QUANTITIES (PRIVATE)

8" WATER PVC WATER	1,884.1 LF
FIRE HYDRANT ASSEMBLY -	5 EA.
8" PVC SANITARY SEWER	969.3 LF

SEWER CONTRIBUTION

PHASE 1 - BUILDINGS A & B
AVERAGE FLOW = 6,570 GPD
PEAK FLOW = 19,710 GPD

APPROVALS

[Signature] 12/14/01
LAS VEGAS VALLEY WATER DISTRICT DATE

[Signature] 10/31/01
C.L.V. DEPARTMENT DATE

DISCLAIMER NOTE

UTILITY LOCATIONS SHOWN HEREON ARE APPROXIMATE ONLY. IT SHALL BE THE CONTRACTOR'S RESPONSIBILITY TO DETERMINE THE EXACT HORIZONTAL AND VERTICAL LOCATION OF ALL EXISTING UNDERGROUND AND OVERHEAD UTILITIES PRIOR TO COMMENCING CONSTRUCTION. NO REPRESENTATION IS MADE THAT ALL EXISTING UTILITIES ARE SHOWN HEREON. THE ENGINEER ASSUMES NO RESPONSIBILITY FOR UTILITIES NOT SHOWN OR UTILITIES NOT SHOWN IN THEIR PROPER LOCATION.

Avoid cutting underground utility lines. It's costly.
Call before you Dig
1-800-227-2800
UNDERGROUND SERVICE (USA)

Avoid overhead power line contact.
Call before you OVERHEAD
1-702-593-6111
PRIVATE POWER EQUIPMENT AND SAFETY SERVICES DEPARTMENT

DEVELOPER: CONQUISTADOR PLAZA, L.L.C.
2685 S. RAINBOW BOULEVARD - SUITE 212
LAS VEGAS, NV 89146
TEL: (702) 362-8774 FAX: (702) 362-8011

STRUCTURAL
L. R. NELSON CONSULTING ENGINEERS, INC.
3035 East Patrick Lane
Las Vegas, Nevada 89120
TEL: (702) 451-2268 FAX: (702) 451-2268

UTILITY PLAN 2
CONQUISTADOR PLAZA
PHASE I

DRAWN BY: REN
DESIGNED BY: KEA
CHECKED BY: KEA
PROJECT NO.: 1077-001-014
SCALE: 1" = 30'

REVISION

DATE

BY

REVISION

SHEET
C5
5 OF 9 SHEETS
DRAWING NO.
107-V-3369-1

ITEM NO.	DESCRIPTION	QTY.
1.	FLANGED SCHED 40 FABRICATED STEEL EPOXY COATED AND LINED WALL SPOOL WITH THRUST RING.	2
2.	FLANGED GATE VALVE.	2
3.	SENSUS 6" x 2" OR APPROVED EQUAL.	1
4.	FLANGED X PLAIN END SCHED 40 FABRICATED STEEL EPOXY COATED AND LINED SPOOL.	2
5.	SLEEVE TYPE COUPLING	1
6.	INSTALL ADJUSTABLE PIPE SUPPORTS, GRINNEL NO. 264 OR APPROVED EQUAL.	2

NOTES: ALL PIPING, FITTINGS, AND APPURTENANCES SHALL CONFORM TO APPLICABLE DISTRICT SPECIFICATIONS.
THIS INSTALLATION IS FOR USE ONLY IN SYSTEMS HAVING ANOTHER SOURCE OF SUPPLY.
35733 (R) 38708