

02-2001-603

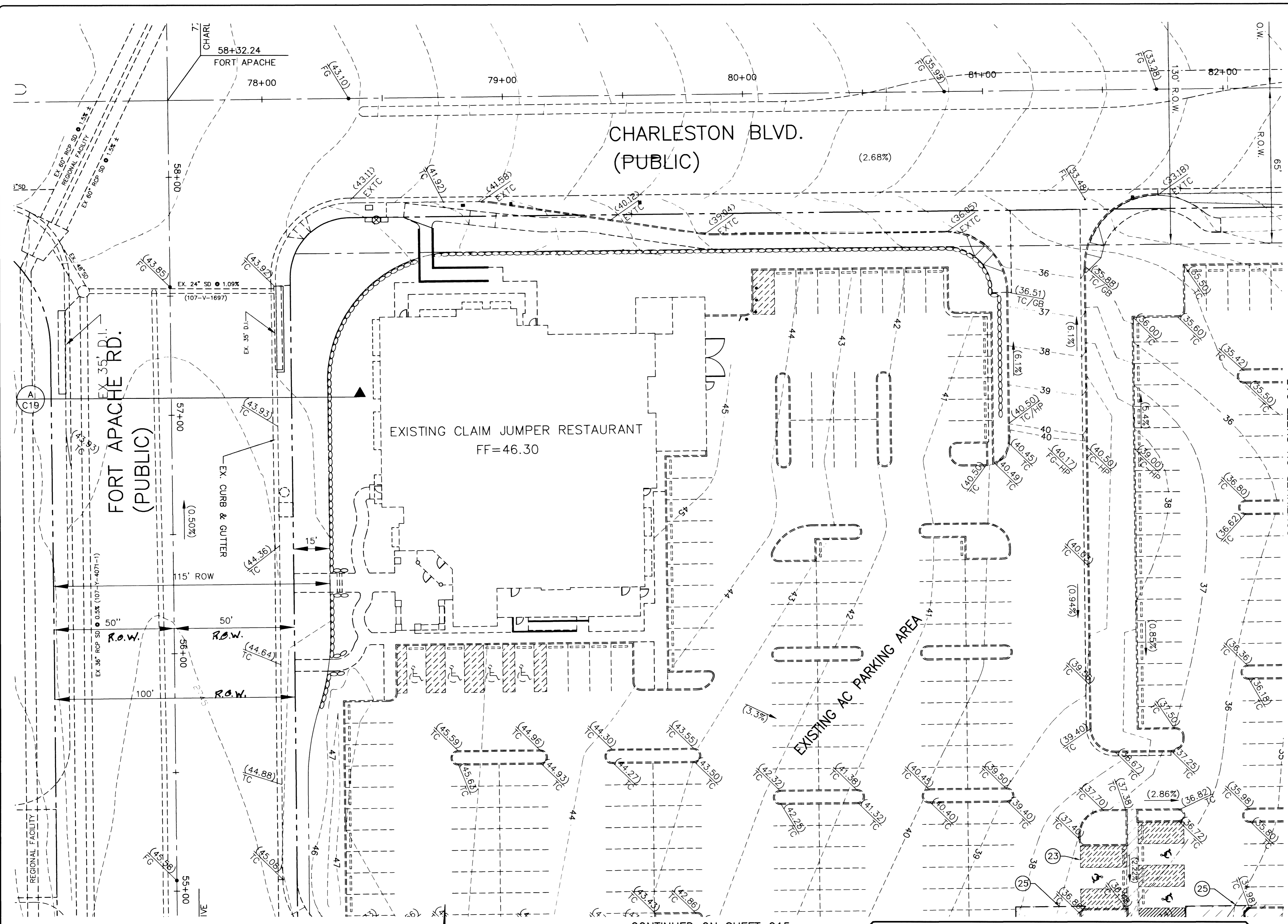

**BENCHMARK**  
 NATIONAL GEODETIC VERTICAL DATUM OF 1929 (USED)  
 1LV105NWB, RIVET & PLATE IN TOP OF CURB ON THE EAST SIDE OF FORT APACHE & ±370 FEET NORTH OF PECCOLE STRADA, CITY OF LAS VEGAS DATUM  
 ELEVATION = 2755.528  
 (FOR CONVERSION TO 1988 DATUM, ADD 2.52')

**BASIS OF BEARINGS**  
 NORTH 89°40'03" EAST, BEING THE BEARING OF THE NORTH LINE OF THE NORTHEAST QUARTER (NE 1/4) OF THE NORTHEAST QUARTER (NE 1/4) OF SECTION 5, TOWNSHIP 21 SOUTH, RANGE 60 EAST, M.D.M., CLARK COUNTY, NEVADA, AS SHOWN ON THAT CERTAIN MAP ON FILE IN THE CLARK COUNTY RECORDER'S OFFICE IN FILE 81 OF SURVEYS, AT PAGE 62.

- CONSTRUCTION NOTES**
- CONSTRUCT 24" "L" TYPE CURB & GUTTER PER STD DWG #216
  - CONSTRUCT "A" TYPE CURB PER STD DWG #219
  - CONSTRUCT 0" CURB PER DETAIL "M" SHEET C18
  - CONSTRUCT 8" WIDE CROSS GUTTER PER STD DWG #228
  - CONSTRUCT 3" CONCRETE TROUGH PER DETAIL "I", SHEET C19
  - CONSTRUCT 6"-10" CONCRETE CHANNEL PER DETAIL "H", SHEET C19
  - CONSTRUCT 8"-10" CONCRETE TROUGH PER DETAIL "G", SHEET C19
  - CONSTRUCT CONCRETE SIDEWALK PER STD DWG #234
  - CONSTRUCT TYPICAL 8" PRECAST BUMPER BLOCK PER STD DWG #238
  - CONSTRUCT RETAINING BLOCK WALL PER STD DWG# B-101 BLOCK & FINISH PER ARCHITECT PLANS
  - CONSTRUCT WROUGHT IRON/BLOCK WALL PER DETAIL "F", SHEET C19. BLOCK AND FINISH PER ARCHITECT PLANS
  - CONSTRUCT TRASH ENCLOSURE PER ARCHITECT PLANS
  - CONSTRUCT AC PAVEMENT PER DETAIL "H", SHEET C18
  - CONSTRUCT PUBLIC HANDICAP CURB RAMP PER STD DWG #235, CASE III SEE TABLE, THIS SHEET
  - CONSTRUCT BOLLARD PER DETAIL "G", SHEET C18
  - CONSTRUCT 24" SIDEWALK UNDERDRAIN PER STD DWG #236
  - CONSTRUCT 6"-3" TRIPLE SIDEWALK UNDERDRAIN PER DETAIL "J" SHEET C18
  - CONSTRUCT 8"-3" QUAD SIDEWALK UNDERDRAIN PER DETAIL "I" SHEET C18
  - CONSTRUCT ON-SITE HARDSCAPE/LANDSCAPE AREA, SEE ARCHITECT PLANS FOR DETAILS
  - CONSTRUCT CURB/PAVEMENT TRANSITION PER DETAIL "B", SHEET C18
  - CONSTRUCT 3" VALLEY GUTTER PER DETAIL "E", SHEET C18
  - CONSTRUCT GENERAL PARKING AREA STRIPING PER ARCHITECT PLANS
  - CONSTRUCT HANDICAP STRIPING & PARKING SPACE PER DETAIL "B", SHEET C27
  - CONSTRUCT LOADING ZONE STRIPING PER ARCHITECTS PLAN
  - SAWCUT AND MATCH EXISTING AC PAVEMENT
  - SAWCUT AND MATCH EXISTING CURB AND GUTTER
  - SAWCUT AND MATCH EXISTING SIDEWALK
  - CONSTRUCT ROCKERY WALL PER DETAIL "J" SHEET C19
  - HANDI-CAP PASSENGER LOADING PER DETAIL "9" SHEET C27
  - CONSTRUCT SPILL CURB PER DETAIL "K" SHEET C18
  - CONSTRUCT BEEHIVE DROP INLET PER DETAIL "K" SHEET C19
  - CONSTRUCT WALL DRAIN PER DETAIL "D" SHEET C18
  - CONSTRUCT HANDI-CAP ACCESS RAMP PER ARCHITECT PLANS

**SIDEWALK RAMP TRANSITION TABLE**

| RAMP NO. | GRADE (%) "B" TO "A" | "A" (FT) MIN. | "B" (FT) MIN. |
|----------|----------------------|---------------|---------------|
| H1       | -6 TO -5.01          | 4.5           | 21.5          |
| H2       | -5 TO -4.01          | 4.5           | 15.0          |
| H3       | -4 TO -3.01          | 4.5           | 12.0          |
| H4       | -3 TO -2.01          | 4.5           | 9.5           |
| H5       | -2 TO 2              | 8.0           | 8.0           |
| H6       | 2.01 TO 3            | 9.5           | 4.5           |
| H7       | 3.01 TO 4            | 12.0          | 4.5           |
| H8       | 4.01 TO 5            | 15.0          | 4.5           |
| H9       | 5.01 TO 6            | 21.5          | 4.5           |

SEE CLARK COUNTY AREA STANDARD DRAWING NO. 235

SIGHT VISIBILITY RESTRICTION ZONE PER C.C. STD DWG. 201.2

**NOTE**  
 NDOT PERMIT IS REQUIRED FOR CONSTRUCTION WORK IN CHARLESTON BLVD. RIGHT OF WAY.

**LEGEND NOTE**  
 SEE SHEET C2 OF 27 FOR LEGEND

**ADA NOTE**  
 ALL SIDEWALKS AND HANDICAP ACCESS RAMPS SHALL MEET ADA REQUIREMENTS. CONTRACTOR SHALL NOTIFY THE ENGINEER OF ANY DISCREPANCIES BETWEEN DESIGN INFORMATION AND ADA REQUIREMENTS PRIOR TO CONSTRUCTION.

- ENGINEER'S NOTES**
- SEE ARCHITECT'S PLANS FOR ADDITIONAL HANDICAP ACCESSIBILITY INFORMATION AND DETAILS.
  - THE PROPOSED AC GRADES ARE 0.5' LOWER THAN THE TOP OF CURB GRADES UNLESS OTHERWISE NOTED.
  - CONTRACTOR TO VERIFY SITE CONDITIONS PRIOR TO CONSTRUCTION.
  - CONTRACTOR IS RESPONSIBLE FOR DUST AND EROSION CONTROL DURING CONSTRUCTION.
  - SEE LANDSCAPE PLANS FOR LANDSCAPING AND ONSITE IRRIGATION. CONTRACTOR TO PROTECT EXISTING LANDSCAPING.
  - SEE DETAIL SHEET FOR ONSITE PAVEMENT SECTION. CONTRACTOR TO VERIFY WITH SOILS REPORT.
  - ENGINEER TO BE NOTIFIED OF ANY DISCREPANCIES IMMEDIATELY.
  - THESE PLANS SHALL NOT, IN PART OR IN WHOLE, BE USED FOR CONSTRUCTION UNTIL APPROVED AND SIGNED BY THE GOVERNING AGENCIES.
  - ALL WORK SHALL CONFORM WITH THE SOILS REPORT PREPARED BY WESTERN TECHNOLOGIES, INC., PROJECT No. 4128JS228, DATED DECEMBER 18, 1998

**APPROVAL:**  
 I CERTIFY THIS GRADING PLAN IS IN CONFORMANCE WITH THE APPROVED DRAINAGE STUDY FOR THIS PROJECT ON FILE AT THE CITY OF LAS VEGAS.  
 [Signature] 12/30/01  
 JAMES T. ANSPACH, P.E. 4255 DATE

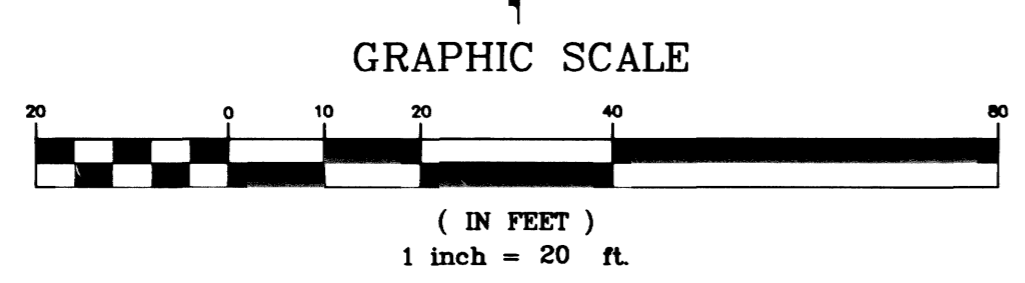

**PECOLE NEVADA CORPORATION**  
 851 SOUTH RAMPART, SUITE 220  
 LAS VEGAS, NEVADA 89145

**AMEC Infrastructure, Inc.**  
 3016 WEST CHARLESTON BLVD., SUITE 180  
 LAS VEGAS, NEVADA 89102  
 PHONE (702) 878-3617 FAX (702) 878-3716

**GRADING PLAN No. 1**

**CROSSROAD COMMONS & FORT APACHE**

**S.E. COR. - CHARLESTON & FORT APACHE**  
 LAS VEGAS, NEVADA

DESIGNER:  
 DRAWN BY:

**Call before you OVERHEAD**  
 1-702-593-6111  
 SAFETY. SERVICE. STRATEGIC.

**Call before you Dig.**  
 1-800-227-2600  
 MEMORANDUM SERVICE ALERT CALL  
 107-V-3578

**PROFESSIONAL ENGINEER**  
 JAMES T. ANSPACH  
 CIVIL  
 No. 4255  
 12/30/01

JOB NO.  
 02-2001-603

SHEET NO.  
**C12**  
 of 27