

MATCHLINE SEE SHEET G4

33804 34681

MATCHLINE SEE SHEET G5

MATCHLINE SEE SHEET G8

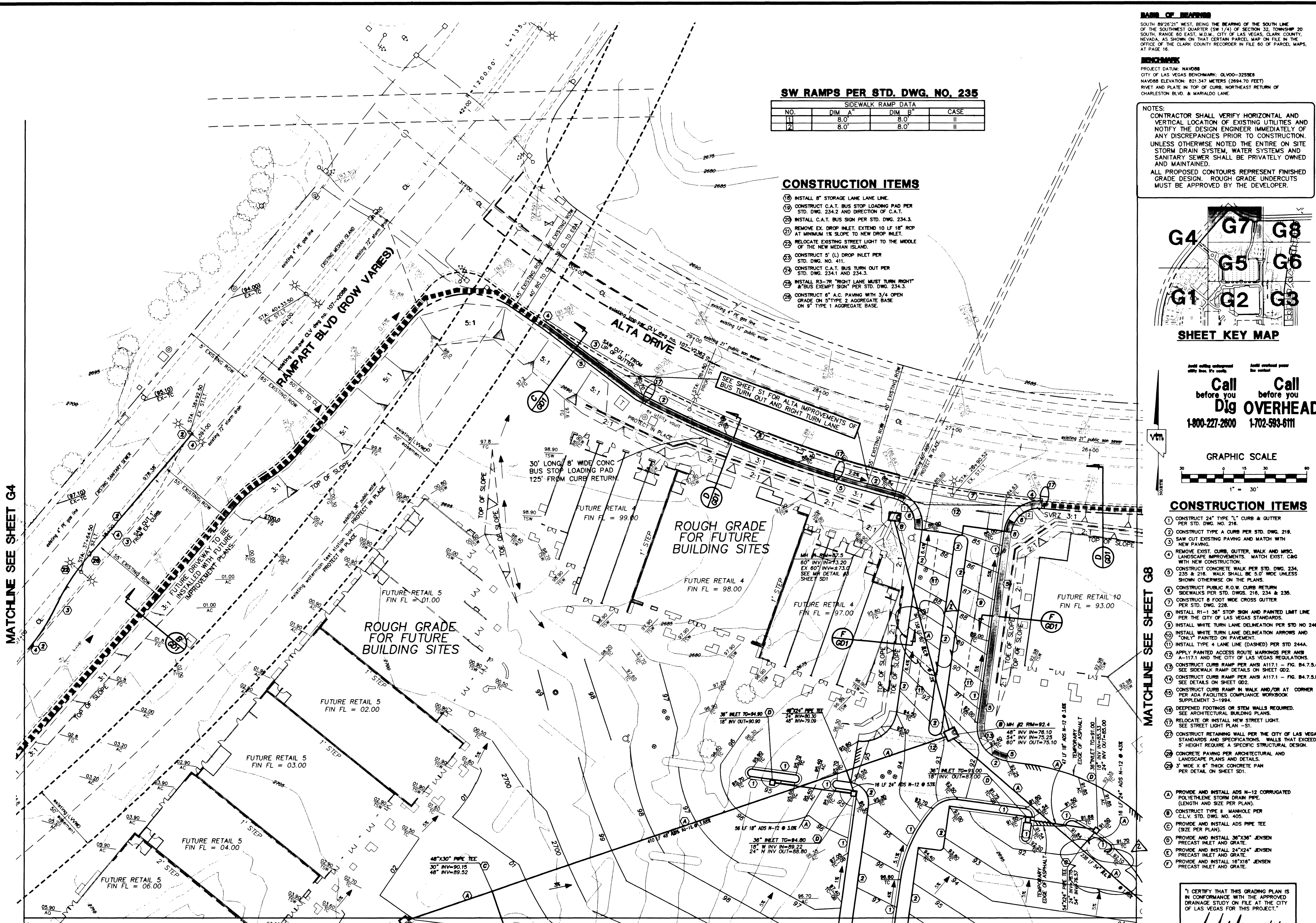

SW RAMP PER STD. DWG. NO. 235

SIDEWALK RAMP DATA			
NO.	DIM A'	DIM B'	CASE
1	8.0'	8.0'	II
2	8.0'	8.0'	II

CONSTRUCTION ITEMS

- 10 INSTALL 8" STORAGE LANE LINE.
- 11 CONSTRUCT C.A.T. BUS STOP LOADING PAD PER STD. DWG. 234.2 AND DIRECTION OF C.A.T.
- 12 INSTALL C.A.T. BUS SIGN PER STD. DWG. 234.3.
- 13 REMOVE EX. DROP INLET. EXTEND 10 LF 18" RCP AT MINIMUM 1% SLOPE TO NEW DROP INLET.
- 14 RELOCATE EXISTING STREET LIGHT TO THE MIDDLE OF THE NEW MEDIAN ISLAND.
- 15 CONSTRUCT 5' (L) DROP INLET PER STD. DWG. NO. 411.
- 16 CONSTRUCT C.A.T. BUS TURN OUT PER STD. DWG. 234.1 AND 234.3.
- 17 INSTALL R3-7R TRIGHT LANE MUST TURN RIGHT & BUS EXEMPT SIGN PER STD. DWG. 234.3.
- 18 CONSTRUCT 8" A.C. PAVING WITH 3/4 OPEN GRADE ON 5" TYPE 2 AGGREGATE BASE ON 9" TYPE 1 AGGREGATE BASE.

BASE OF BEARING
 SOUTH 89°28'21" WEST, BEING THE BEARING OF THE SOUTH LINE OF THE SOUTHWEST QUARTER (SW 1/4) OF SECTION 32, TOWNSHIP 20 SOUTH, RANGE 60 EAST, M.D.M., CITY OF LAS VEGAS, CLARK COUNTY, NEVADA, AS SHOWN ON THAT CERTAIN PARCEL MAP ON FILE IN THE OFFICE OF THE CLARK COUNTY RECORDER IN FILE 80 OF PARCEL MAPS, AT PAGE 16.

BENCHMARK
 PROJECT DATUM: NAVD83
 CITY OF LAS VEGAS BENCHMARK: OLVOO-325568
 NAVD83 ELEVATION: 821.347 METERS (2694.70 FEET)
 RIVET AND PLATE IN TOP OF CURB, NORTHEAST RETURN OF CHARLESTON BLVD. & MARIALDO LANE.

NOTES:
 CONTRACTOR SHALL VERIFY HORIZONTAL AND VERTICAL LOCATION OF EXISTING UTILITIES AND NOTIFY THE DESIGN ENGINEER IMMEDIATELY OF ANY DISCREPANCIES PRIOR TO CONSTRUCTION. UNLESS OTHERWISE NOTED THE ENTIRE ON SITE STORM DRAIN SYSTEM, WATER SYSTEMS AND SANITARY SEWER SHALL BE PRIVATELY OWNED AND MAINTAINED.
 ALL PROPOSED CONTOURS REPRESENT FINISHED GRADE DESIGN. ROUGH GRADE UNDERCUTS MUST BE APPROVED BY THE DEVELOPER.

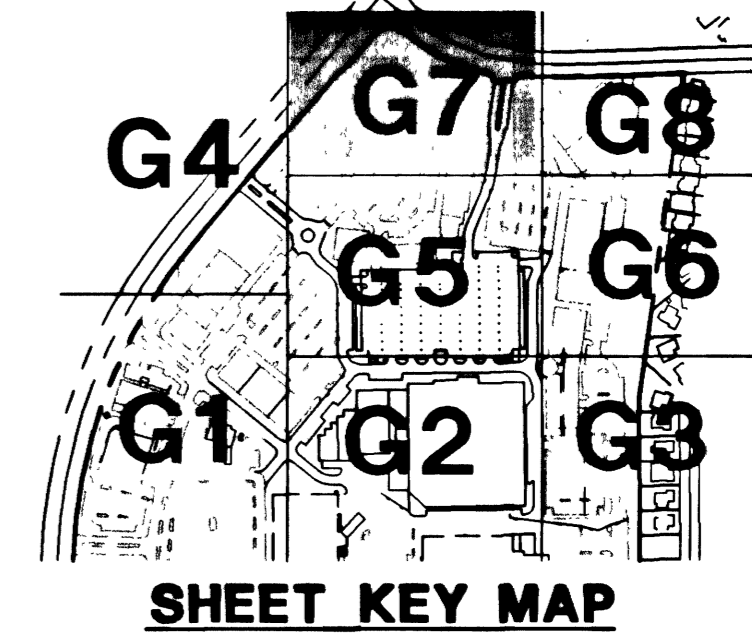

Call before you Dig OVERHEAD
 1-800-227-2600 1-702-593-6111

GRAPHIC SCALE
 1" = 30'

CONSTRUCTION ITEMS

- 1 CONSTRUCT 24" TYPE "L" CURB & GUTTER PER STD. DWG. NO. 218.
- 2 CONSTRUCT TYPE A CURB PER STD. DWG. 218.
- 3 SAW CUT EXISTING PAVING AND MATCH WITH NEW PAVING.
- 4 REMOVE EXIST. CURB, GUTTER, WALK AND MISC. LANDSCAPE IMPROVEMENTS. MATCH EXIST. CURB WITH NEW CONSTRUCTION.
- 5 CONSTRUCT CONCRETE WALK PER STD. DWG. 234.235 & 216. WALK SHALL BE 5.0' WIDE UNLESS SHOWN OTHERWISE ON THE PLANS.
- 6 CONSTRUCT PUBLIC R.O.W. CURB RETURN SIDEWALKS PER STD. DWGS. 216, 234 & 235.
- 7 CONSTRUCT 8 FOOT WIDE CROSS GUTTER PER STD. DWG. 228.
- 8 INSTALL RI-1 36" STOP SIGN AND PAINTED LIMIT LINE PER THE CITY OF LAS VEGAS STANDARDS.
- 9 INSTALL WHITE TURN LANE DELINEATION PER STD NO. 244.
- 10 INSTALL WHITE TURN LANE DELINEATION ARROWS AND "ONLY" PAINTED ON PAVEMENT.
- 11 INSTALL TYPE 4 LANE LINE (DASHED) PER STD 244A.
- 12 APPLY PAINTED ACCESS ROUTE MARKINGS PER ANS 117.1 AND CITY OF LAS VEGAS REGULATIONS.
- 13 CONSTRUCT CURB RAMP PER ANS 117.1 - FIG. B4.7.3.a. SEE SIDEWALK RAMP DETAILS ON SHEET G02.
- 14 CONSTRUCT CURB RAMP PER ANS 117.1 - FIG. B4.7.3.b. SEE DETAILS ON SHEET G02.
- 15 CONSTRUCT CURB RAMP IN WALK AND/OR AT CORNER PER ADA FACILITIES COMPLIANCE WORKBOOK SUPPLEMENT 3-1994.
- 16 DEEPENED FOOTINGS OR STEM WALLS REQUIRED. SEE ARCHITECTURAL BUILDING PLANS.
- 17 RELOCATE OR INSTALL NEW STREET LIGHT. SEE STREET LIGHT PLAN - S1.
- 18 CONSTRUCT RETAINING WALL PER THE CITY OF LAS VEGAS STANDARDS AND SPECIFICATIONS. WALLS THAT EXCEED 5' HEIGHT REQUIRE A SPECIFIC STRUCTURAL DESIGN.
- 19 CONCRETE PAVING PER ARCHITECTURAL AND LANDSCAPE PLANS AND DETAILS.
- 20 3" WIDE X 8" THICK CONCRETE PAN PER DETAIL ON SHEET S01.
- 21 PROVIDE AND INSTALL ADS N-12 CORRUGATED POLYETHYLENE STORM DRAIN PIPE (LENGTH AND SIZE PER PLAN).
- 22 CONSTRUCT TYPE II MANHOLE PER C.L.V. STD. DWG. NO. 405.
- 23 PROVIDE AND INSTALL ADS PIPE TEE (SIZE PER PLAN).
- 24 PROVIDE AND INSTALL 36"x36" JENSEN PRECAST INLET AND GRATE.
- 25 PROVIDE AND INSTALL 24"x24" JENSEN PRECAST INLET AND GRATE.
- 26 PROVIDE AND INSTALL 18"x18" JENSEN PRECAST INLET AND GRATE.

"I CERTIFY THAT THIS GRADING PLAN IS IN CONFORMANCE WITH THE APPROVED DRAINAGE STUDY ON FILE AT THE CITY OF LAS VEGAS FOR THIS PROJECT."
 Date: 8/1/01
 Signature: [Handwritten Signature]

TREBLE FIVE NAVADA DEVEL. CORP.
 9810 WEST SAHARA LAS VEGAS, NEVADA 89117
 702-242-6937 FAX 702-360-8128

CITY OF LAS VEGAS
 2727 SOUTH RAINBOW BOULEVARD LAS VEGAS, NEVADA 89146-5148
 PH: (702) 873-7550 FAX (702) 362-2597

BOCA PARK NORTH AT PECOCLE RANCH TOWN CENTER

nvtn nevada CONSULTING ENGINEERS • PLANNERS • LAND SURVEYORS
 PH: (702) 873-7550 FAX (702) 362-2597

SEAL
 PROFESSIONAL ENGINEER
 CIVIL
 NO. 12181

SHEET 07 OF 21 SHEETS
 DRAWING NO. 327Y-4657
 RE-PLAT

REVISIONS

NO.	DATE	BY	REVISION
1	8-13-01	JPS	overall adjustments per new site plan
2	9-21-01	TAB	54" x 36" SD PIPE CHANGED TO 36" x 36" x 3.0" PER STD. DWG. NO. 218