

GRADING LEGEND

---	SITE BOUNDARY LINE
---	EXISTING R/W LINE
---	EXISTING 5' CONTOUR
---	EXISTING 1' CONTOUR
---	PROPOSED WALL
---	PROPOSED 5' CONTOUR
---	PROPOSED 1' CONTOUR
---	PROPOSED FLOW LINE
---	PROPOSED GRADE BREAK
---	EXISTING TOP OF CURB ELEVATION
---	PROPOSED TOP OF CURB ELEVATION
---	PROPOSED TOP OF CURB ELEVATION WITH 0" CURB FACE
---	PROPOSED BOTTOM OF WALL
---	PROPOSED SIDEWALK ELEVATION
---	PROPOSED TOP OF WALL ELEVATION
---	PROPOSED TOP OF FOOTING ELEVATION
---	PROPOSED FINISH GRADE SPOT ELEVATION
---	PROPOSED FLOW LINE ELEVATION
---	CATCH BASIN/MANHOLE RIM ELEVATION
---	PROPOSED GROUND SLOPE
---	PROPOSED SITE VISIBILITY ESMT.

APPROVALS

I CERTIFY THAT THIS GRADING PLAN CONFORMS TO THE APPROVED TECHNICAL DRAINAGE STUDY FOR "COSTCO WHOLESALE CANYON POINTE" ON FILE AT THE CITY OF LAS VEGAS.

JERRY SLATER, P.E. 014167 3/8/01
DATE

GRADING CONSTRUCTION NOTES

- 1 SAWCUT EXISTING CURB & MATCH. CONTRACTOR SHALL VERIFY EXISTING CURB ELEVATION AND REPORT ANY DISCREPANCIES TO THE ENGINEER PRIOR TO COMMENCEMENT OF CONSTRUCTION.
- 2 CONSTRUCT COMMERCIAL DRIVEWAY AND 8' WIDE VALLEY GUTTER PER SUMMERLIN DWG NO. S-81, AND S-84.
- 3 CONSTRUCT "L" TYPE CURB & GUTTER PER ARCHITECTURAL PLANS.
- 4 CONSTRUCT TYPE "A" ARCHITECTURAL PLANS.
- 5 CONSTRUCT 2' WIDE CURB OPENING FOR DRAINAGE.
- 6 CONSTRUCT ADA ACCESSIBLE RAMP PER A.D.A.A.G. SECTION 4.8 (RAMPS)
- 7 CONSTRUCT HANDRAILS & CURB ALONG ADA ACCESSIBLE RAMP PER A.D.A.A.G. SECTION 4.8.4 (HANDRAILS)
- 8 CONSTRUCT DROP IN CURB FOR SIDEWALK RAMP PER SUMMERLIN DWG NO. S-75
- 9 FUTURE SIDEWALK BY SUMMERLIN H.O.A. (APPROXIMATE LOCATION SHOWN)
- 10 CONSTRUCT 2' WIDE CONCRETE VALLEY GUTTER PER DETAIL SHT. C14
- 11 CONSTRUCT TEMPORARY DITCH PER DETAIL THIS SHEET

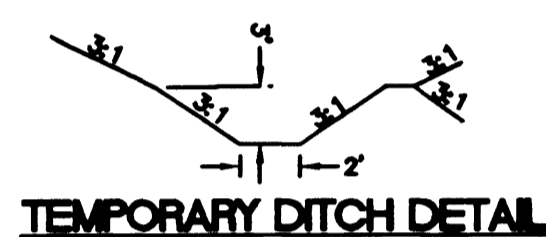

CALL BEFORE YOU DIG

Call before you Dig.

1-800-227-2600

CALL BEFORE YOU OVERHEAD

Call before you OVERHEAD

1-702-593-6111

BENCHMARK

CITY OF LAS VEGAS BENCHMARK OLVD9 3655WS
 NAVD 88 ELEVATION = 919.3486 METERS, 3016.23 FT
 SUMMERLIN DATUM ELEVATION = 3014.08 FT

BASIS OF BEARING

SOUTH 08°05'51" EAST, BEING THE BEARING OF THE EAST LINE OF SECTION 36, TOWNSHIP 20 SOUTH, RANGE 59 EAST, M.D.M., AS SHOWN BY MAP THEREOF ON FILE IN BOOK 74 OF PLATS, OFFICIAL RECORDS OF CLARK COUNTY, NEVADA

NOTE:
FOR STORM DRAIN CONSTRUCTION SEE STORM PLANS.

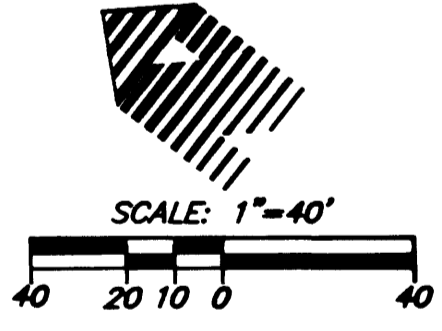

30354

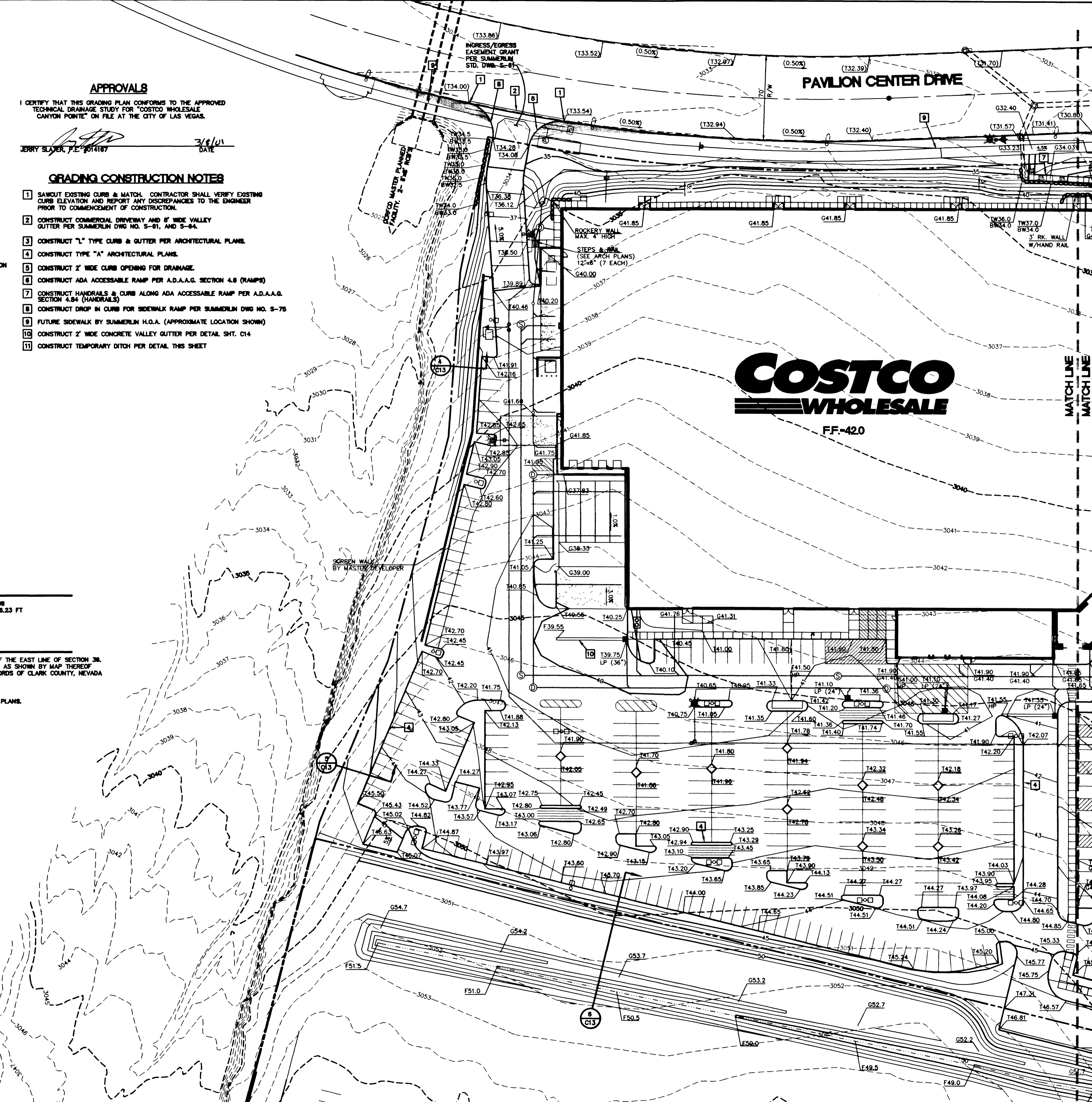

<p>COSTCO WHOLESALE 999 Lake Drive Henderson, NV 89014 (702) 313-8052</p>	<p>W R G</p>	<p>GRADING PLAN (NORTH) COSTCO WHOLESALE AT CANYON POINTE</p>	<p>CITY OF LAS VEGAS PORTION OF SECTION 35 AND 36, TOWNSHIP 20 SOUTH, RANGE 59 EAST M.D.M., CLARK COUNTY, NEVADA</p>
<p>DATE: 3/09/01 DESIGNED: J. SLATER ENGINEER: J. SLATER CHECKED: [] SCALE: 1" = 40' HORIZ</p>		<p>NRG PROJECT NO: MUL014</p>	
		<p>SHEET TITLE: GRADING PLAN SHEET NUMBER: C6 OF 14 CLV DRAWING NO. 107-V3367</p>	

REPL0T

GENERAL NOTES

1. ALL CONSTRUCTION SHALL BE IN ACCORDANCE WITH THE LATEST EDITIONS OF THE CALIFORNIA CIVIL ENGINEERING BOARD'S SPECIFICATIONS FOR HIGHWAY AND BRIDGE CONSTRUCTION.
2. THE CONTRACTOR SHALL BE RESPONSIBLE FOR OBTAINING ALL NECESSARY PERMITS AND APPROVALS FROM THE APPROPRIATE AGENCIES.
3. THE CONTRACTOR SHALL MAINTAIN ACCESS TO ALL ADJACENT PROPERTIES AND UTILITIES AT ALL TIMES.
4. ALL UTILITIES SHOWN ON THIS PLAN SHALL BE PROTECTED AND DEEPENED AS NECESSARY TO MAINTAIN ADEQUATE COVER.
5. THE CONTRACTOR SHALL BE RESPONSIBLE FOR VERIFYING THE LOCATION AND DEPTH OF ALL UTILITIES PRIOR TO CONSTRUCTION.
6. ALL EROSION CONTROL MEASURES SHALL BE INSTALLED AND MAINTAINED THROUGHOUT CONSTRUCTION.
7. THE CONTRACTOR SHALL MAINTAIN ADEQUATE DRAINAGE AND EROSION CONTROL MEASURES TO PREVENT SOIL EROSION AND POLLUTION.
8. ALL CONSTRUCTION SHALL BE COMPLETED WITHIN THE SPECIFIED TIME FRAME.
9. THE CONTRACTOR SHALL MAINTAIN ADEQUATE RECORDS OF ALL CONSTRUCTION ACTIVITIES.
10. ALL MATERIALS AND WORKMANSHIP SHALL BE SUBJECT TO INSPECTION AND APPROVAL BY THE ENGINEER.



LEGEND

	EXISTING STRUCTURE
	PROPOSED STRUCTURE
	UTILITY
	EASEMENT
	BOUNDARY
	SPOT ELEVATION
	CONTOUR LINE



PROPOSED COSTCO WHOLESALE CENTER

GENERAL NOTES

1. THE PROPOSED WHOLESALE CENTER SHALL BE CONSTRUCTED IN ACCORDANCE WITH THE LATEST EDITIONS OF THE CALIFORNIA CIVIL ENGINEERING BOARD'S SPECIFICATIONS FOR HIGHWAY AND BRIDGE CONSTRUCTION.
2. THE CONTRACTOR SHALL BE RESPONSIBLE FOR OBTAINING ALL NECESSARY PERMITS AND APPROVALS FROM THE APPROPRIATE AGENCIES.
3. THE CONTRACTOR SHALL MAINTAIN ACCESS TO ALL ADJACENT PROPERTIES AND UTILITIES AT ALL TIMES.
4. ALL UTILITIES SHOWN ON THIS PLAN SHALL BE PROTECTED AND DEEPENED AS NECESSARY TO MAINTAIN ADEQUATE COVER.
5. THE CONTRACTOR SHALL BE RESPONSIBLE FOR VERIFYING THE LOCATION AND DEPTH OF ALL UTILITIES PRIOR TO CONSTRUCTION.
6. ALL EROSION CONTROL MEASURES SHALL BE INSTALLED AND MAINTAINED THROUGHOUT CONSTRUCTION.
7. THE CONTRACTOR SHALL MAINTAIN ADEQUATE DRAINAGE AND EROSION CONTROL MEASURES TO PREVENT SOIL EROSION AND POLLUTION.
8. ALL CONSTRUCTION SHALL BE COMPLETED WITHIN THE SPECIFIED TIME FRAME.
9. THE CONTRACTOR SHALL MAINTAIN ADEQUATE RECORDS OF ALL CONSTRUCTION ACTIVITIES.
10. ALL MATERIALS AND WORKMANSHIP SHALL BE SUBJECT TO INSPECTION AND APPROVAL BY THE ENGINEER.

COSTCO
WHOLESALE
875-01

	DAVID J. SMITH CIVIL ENGINEER No. 12345 State of California
	PROJECT INFORMATION PROJECT NO. 2024-001 SHEET NO. 1 OF 1
CLIENT INFORMATION COSTCO WHOLESALE 1000 MAIN ST. COSTCO CITY, CA 90001	DATE 10/26/2024
PROJECT LOCATION 1000 MAIN ST. COSTCO CITY, CA 90001	SCALE AS SHOWN