

CONSTRUCTION NOTES AND QTY.-PAVING

ITEM	UNIT	QUANTITY
1 CONSTRUCT 3" ASPHALTIC CONCRETE PAVEMENT PER U.S.D. STD. NO. 218.	S.Y.	3310
2 CONSTRUCT 5" ASPHALTIC CONCRETE PAVEMENT PER U.S.D. STD. NO. 218.	S.Y.	2877
3 CONSTRUCT 24" "L" TYPE CURB & GUTTER PER U.S.D. STD. NO. 218.	L.F.	2220
4 A.C. MEDIAN PER U.S.D. STD. NO. 218	S.Y.	851
5 CONSTRUCT 8" WIDE CROSS GUTTER PER U.S.D. STD. NO. 228.	S.Y.	185
6 CONSTRUCT 5" WIDE SIDEWALK PER U.S.D. STD. NO. 234.	S.Y.	1014
7 CONSTRUCT SIDEWALK DRAIN PER U.S.D. STD. NO. 236	EA.	2
8 CONSTRUCT "A" TYPE ISLAND CURB PER U.S.D. STD. NO. 218.	L.F.	584
9 CONSTRUCT HANDICAP RAMP PER U.S.D. STD. NO. 235, CASE 1, A=8', B=8'	EA.	2
11 CONSTRUCT HANDICAP RAMP PER U.S.D. STD. NO. 235, CASE 1, A=21.5', B=4.5'	EA.	2
12 CONSTRUCT HANDICAP RAMP PER U.S.D. STD. NO. 235, CASE 1, A=12', B=4.5'	EA.	1
13 CONSTRUCT HANDICAP RAMP PER U.S.D. STD. NO. 235, CASE 1, A=4.5', B=9.5'	EA.	1
14 CONSTRUCT BUS TURNOUT PER U.S.D. STD. NO. 234.1 AND BUS STOP LANDING PAD AND OPTIONAL SIDEWALK RAMP PER D.W. NO. 234.2	EA.	1
15 CONSTRUCT 2" MIN. A.C. PAVEMENT OVER 4" TYPE II S.Y.	S.Y.	863

LEGEND AND ABBREVIATIONS

AC	ASPHALT CONCRETE
TC	TOP OF CURB
FG	FINISH GRADE
FL	FLOW LINE
EP	EDGE OF PAVEMENT
GB	GRADE BREAK
FF	FINISH FLOOR
SW	SIDEWALK
XXXX	PROPOSED ELEVATION
XXXX	EXISTING ELEVATION
XXXX	FUTURE ELEVATION
XXXX	EXISTING CONTOUR
XXXX	PROPOSED CONTOUR
XXXX	BLOCK WALL
1.72%	DIRECTION OF FLOW & SLOPE
①	CONSTRUCTION NOTE
---	PROPERTY LINE
---	STREET CENTERLINE
---	EXISTING EDGE OF PAVING
---	PROPOSED EDGE OF PAVING
---	SAWCUT LINE
---	GRADE BREAK

BASIS OF BEARINGS

NORTH 00°32'19" WEST BEING THE EAST LINE OF THE SOUTHEAST QUARTER (SE 1/4) OF THE SOUTHWEST QUARTER (SW 1/4) OF SECTION 7, TOWNSHIP 20 SOUTH, RANGE 80 EAST, M.D.M., CLARK COUNTY, NEVADA, AS SHOWN ON A MAP ON FILE IN THE CLARK COUNTY RECORDER'S OFFICE AS FILE 91, PAGE 29 OF RECORDS OF SURVEY.

BENCH MARK

BM 1000 17NNWS
ELEVATION = 2519.82 (NAVD 88)
RIVET AND SQUARE ALUMINUM PLATE IN TOP OF CURB, ON THE SOUTH SIDE OF CHEYENNE AVE. AND THE EXTENDED ALIGNMENT OF CAMPBELL ROAD.

OWNER

CHAISSON FAMILY TRUST
C/O TERRA WEST REALTY & DEVELOPMENT
2685 S. RAINBOW BOULEVARD, #212
LAS VEGAS, NV. 89146
(702) 362-6014

DRAINAGE CERTIFICATION

I CERTIFY THAT THE GRADING PLAN IS IN CONFORMANCE WITH THE APPROVED DRAINAGE STUDY ON FILE AT THE CITY OF LAS VEGAS FOR THIS PROJECT.

Gregory G. Radt 8-28-00
GREGORY G. RADT, P.E. No. 7474 DATE

DISCLAIMER NOTE

UTILITY LOCATIONS SHOWN HEREON ARE APPROXIMATE ONLY. IT SHALL BE THE CONTRACTOR'S RESPONSIBILITY TO DETERMINE THE EXACT HORIZONTAL AND VERTICAL LOCATION OF ALL EXISTING UNDERGROUND AND OVERHEAD UTILITIES PRIOR TO COMMENCING CONSTRUCTION. NO REPRESENTATION IS MADE THAT ALL EXISTING UTILITIES ARE SHOWN HEREON. THE ENGINEER ASSUMES NO RESPONSIBILITY FOR UTILITIES NOT SHOWN OR UTILITIES NOT SHOWN IN THEIR PROPER LOCATION.

Call before you dig
1-800-227-2600
UNCOMMON SERVICE (USA)

Call before you overhead
1-702-593-6111
WHILE WEAS OPERATES AND SAFETY SERVICES DEPARTMENT

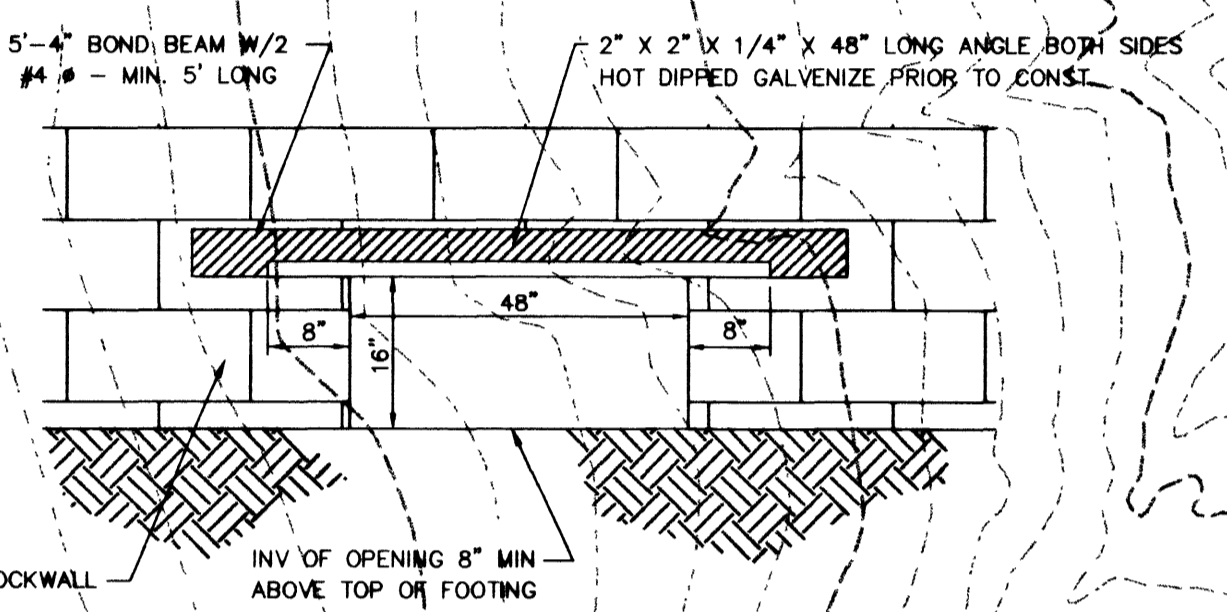

WALL OPENING
NO. SCALE.

NOTE: RELOCATE ALL EXISTING TELEPHONE AND CABLE PEDESTALS. EXISTING WATER VALVES ARE TO BE RAISED TO FINISHED GRADE.

FOR SVZ DIMENSIONS SEE HORIZONTAL CONTROL PLAN (SHEET C5)

FOR SVZ DIMENSIONS SEE HORIZONTAL CONTROL PLAN (SHEET C5)

TERRA WEST REALTY & DEVELOPMENT
2685 S. RAINBOW BOULEVARD - SUITE 212
LAS VEGAS, NV. 89145
TEL (702) 362-6014 FAX (702) 362-6011

L. R. NELSON CONSULTING ENGINEERS, INC.
3035 East Patrick Lane Suite 9
Las Vegas, NV 89120
(702) 798-7978
• CIVIL • SURVEY •

GRADING PLAN

CONQUISTADOR PLAZA-OFFSITE COMMERCIAL SITE

SHEET 1077-001-992

SCALE: 1" = 40'

DRAWING NO. 107-V3369