

**CONSTRUCTION NOTES:**

- 50 INSTALL 36" RCP STORM DRAIN
- 51 INSTALL 9" DROP INLET PER DETAIL 4 ON SHEET DS-1
- 52 INSTALL 60" TYPE I MANHOLE PER STD. DWG. 403
- 53 CUT & JOIN 1 STD. 18" RCP PIPE LENGTH @ 1.00% MIN. PER DETAILS ON SHEET SD-10
- 54 ADJUST VALVE BOX PER UDACS STD. PLATE No. 8
- 55 REMOVE EXISTING 18" RCP STORM DRAIN PER SECTION 3.14.1 AND PLUG MANHOLE
- 56 INSTALL 18" RCP STORM DRAIN
- 57 CONNECT TO EXISTING MANHOLE PER STD. DWG. SD-9, REGROUT MANHOLE BASE PER STD. DWG. SD-7
- 58 INSTALL 1 STD. 18" RCP PIPE LENGTH @ 1.00% MIN. AND CAP END
- 59 FUTURE 18" RCP STORM DRAIN
- 60 FUTURE 3" DROP INLET PER DETAIL 3 ON SHEET DS-1
- 61 FUTURE 9" DROP INLET PER DETAIL 4 ON SHEET DS-1

**PIPE TRENCH NOTES:**

- 1. IN UNPAVED AREAS INSTALL PIPE PER STD. DETAIL #502
- 2. IN EXISTING PAVED AREAS & STREET CROSSING INSTALL PIPE PER STD. DETAIL #504 EXCEPT USE TYPE II AGGREGATE IN AREA 2 FEET BELOW PAVEMENT. COMPACTED TO 95%.

**GRAPHIC SCALE**

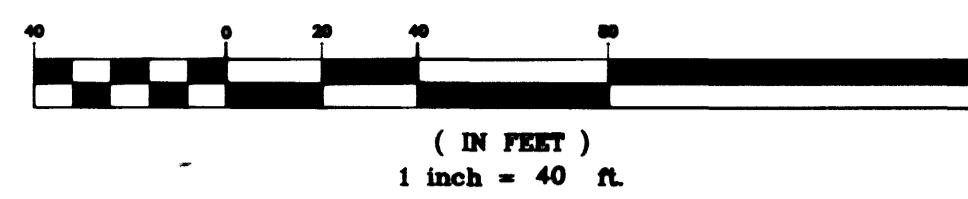

**BASIS OF BEARING**

NORTH 39°40'38" WEST BEING THE BEARING OF THE LINE FROM POINT B25 TO POINT No. 808 AS SHOWN BY THAT CERTAIN RECORD OF THE SURVEY ON FILE IN THE OFFICE OF THE CLARK COUNTY RECORDER, CLARK COUNTY, NEVADA IN FILE 88, PAGE 53. SAID BEARING BEING BASED ON THE NORTH AMERICAN DATUM OF 1983 (NAD '83), NEVADA STATE PLANE EAST ZONE(2701)

**BENCHMARK**

NAVD 88- CLV BENCH 1LV003W4  
CLV PIN & PLATE IN TOP OF ELEC. BASE  
SOUTH SIDE OF CRAIG RD., 250' +/- EAST  
OF BUFFALO DR.  
ELEVATION 714.730 METERS, 2344.91 FEET

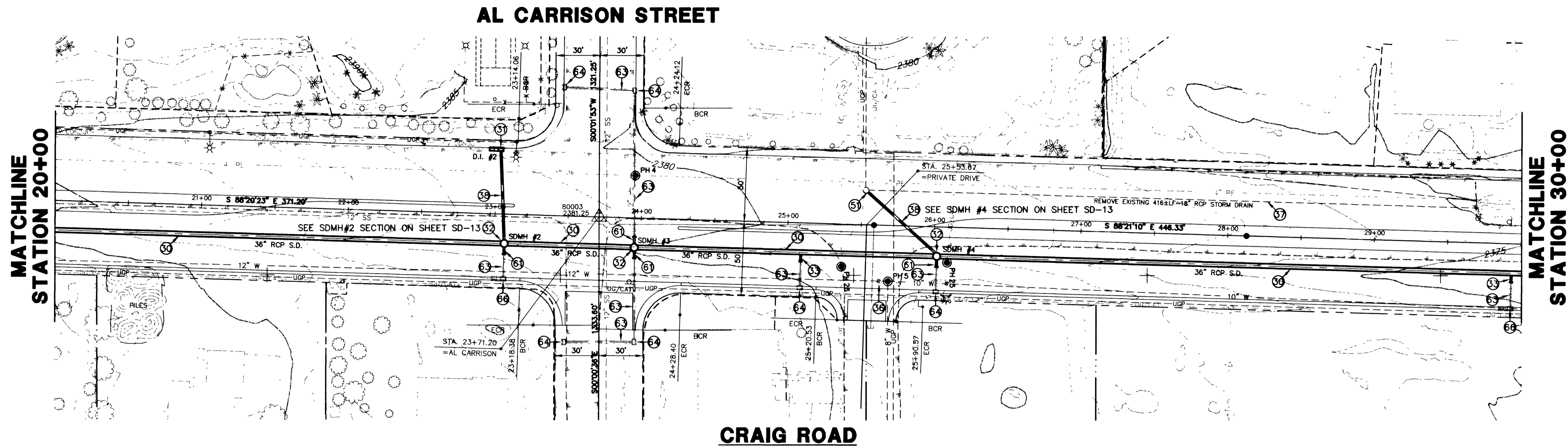

\*\*\*\* CAUTION \*\*\*\*  
2" POLYETHYLENE GAS LINE. CONTRACTOR TO COORDINATE WITH SOUTHWEST GAS - CONTACT 7 DAYS PRIOR TO BEGINNING OF CONSTRUCTION. (365-2296)

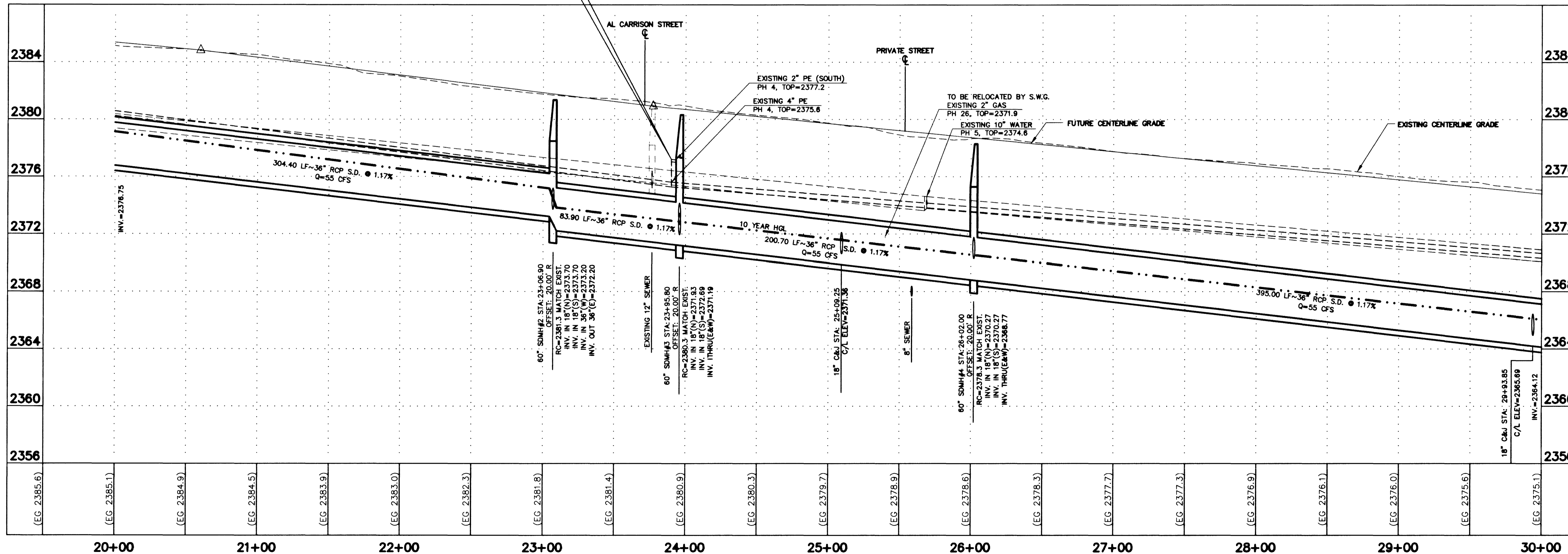

Call before you Overhead

1-702-583-6111

Avoid cutting underground utility lines. It's costly.

Call before you Dig

1-800-227-2800

CITY OF LAS VEGAS	
731 SOUTH FOURTH STREET LAS VEGAS, NEVADA 89101	
URS Greiner 2785 EAST DESERT INN ROAD LAS VEGAS, NEVADA 89121 (702)-796-7775 FAX (702)-796-1803	
36" STORM DRAIN PLAN AND PROFILE	STATIONING TO STA. 30+00
CRAIG ROAD IMPROVEMENTS	
BID NO. 00.1730.23	
SHEET	TITLE
DRAWN BY: DMS/AMR	DESIGNED BY: DMS/AMR
CHECKED BY: DM	PROJECT NO: 44300
SCALE: 1"=40' HOR. 1"=4' VERT.	
SHEET SD-2	
38 OF 55 SHEETS	
DRAWING NO. 107-V3048	

24367