

CONSTRUCTION NOTES:

- 15 SAWCUT & MATCH EXISTING PAVEMENT
- 22 INSTALL 8" SEWER LATERAL PER STD. DWG(S) 504, SD-12 & SD-17
- 23 CONSTRUCT 48" SANITARY SEWER MANHOLE PER STD. DWG(S) SD-1, SD-6, & SD-7
- 24 INSTALL 6" SEWER LATERAL PER DETAILS SD-12 & SD-17
- 25 INSTALL 15" SANITARY SEWER LINE
- 26 REMOVE EXISTING 15" SANITARY SEWER LINE
- 28 ADJUST MANHOLE RIM PER STD. DWG(S) SD-6 AND SD-38

PIPE TRENCH NOTES:

- 1. IN EXISTING AND NEW PAVED AREAS & STREET CROSSING INSTALL PIPE PER STD. DETAIL #504 EXCEPT USE TYPE II AGGREGATE IN AREA 2 FEET BELOW PAVEMENT.

GRAPHIC SCALE

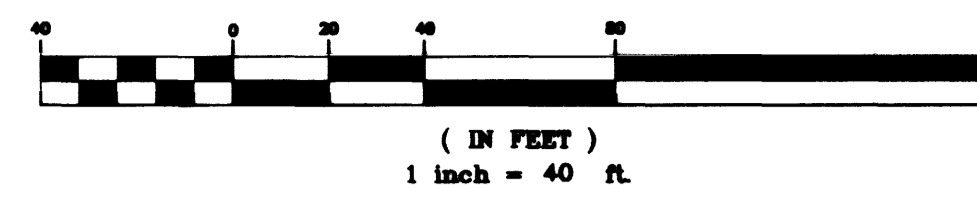

BASIS OF BEARING

NORTH 39°40'38" WEST BEING THE BEARING OF THE LINE FROM POINT 825 TO POINT No. 808 AS SHOWN BY THAT CERTAIN RECORD OF THE SURVEY ON FILE IN THE OFFICE OF THE CLARK COUNTY RECORDER, CLARK COUNTY, NEVADA IN FILE 88, PAGE 53. SAID BEARING BEING BASED ON THE NORTH AMERICAN DATUM OF 1983 (NAD '83), NEVADA STATE PLANE EAST ZONE(2701)

BENCHMARK

NAVD 88- CLV BENCH 1LV003W4
CLV PIN & PLATE IN TOP OF ELEC. BASE
SOUTH SIDE OF CRAIG RD., 250' +/- EAST
OF BUFFALO DR.
ELEVATION 714.730 METERS, 2344.91 FEET

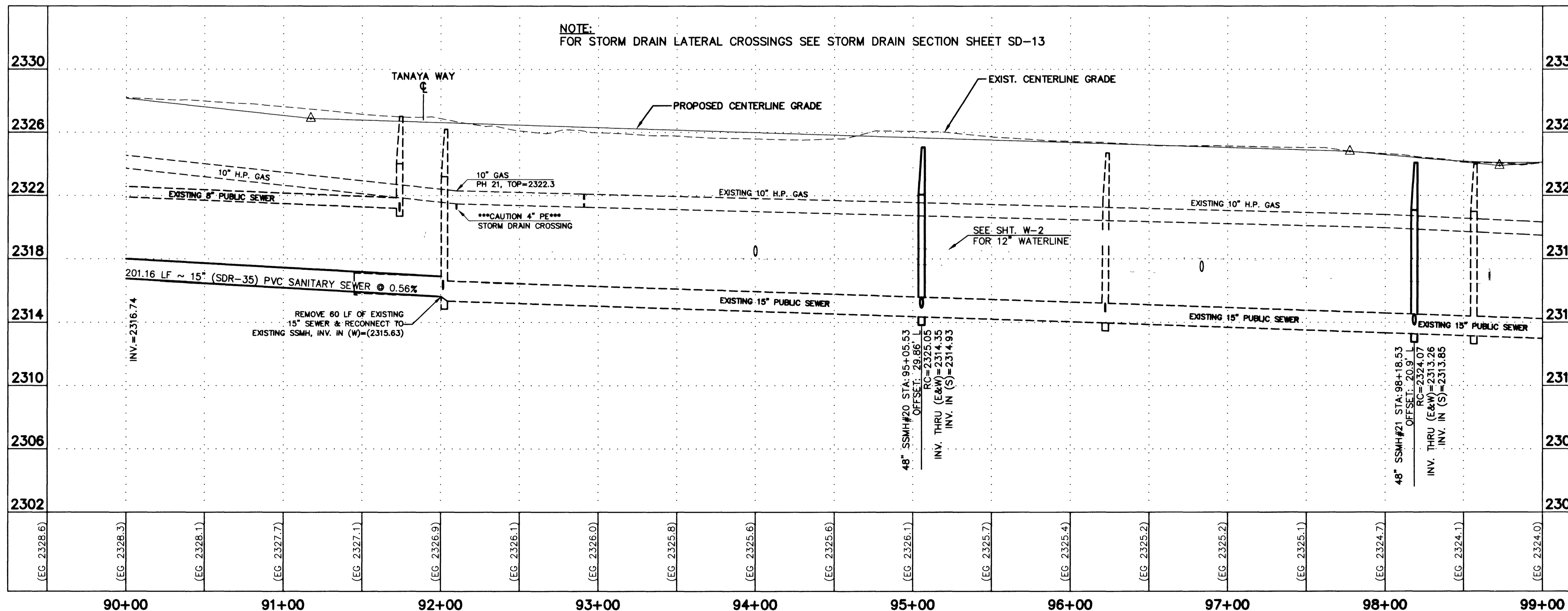
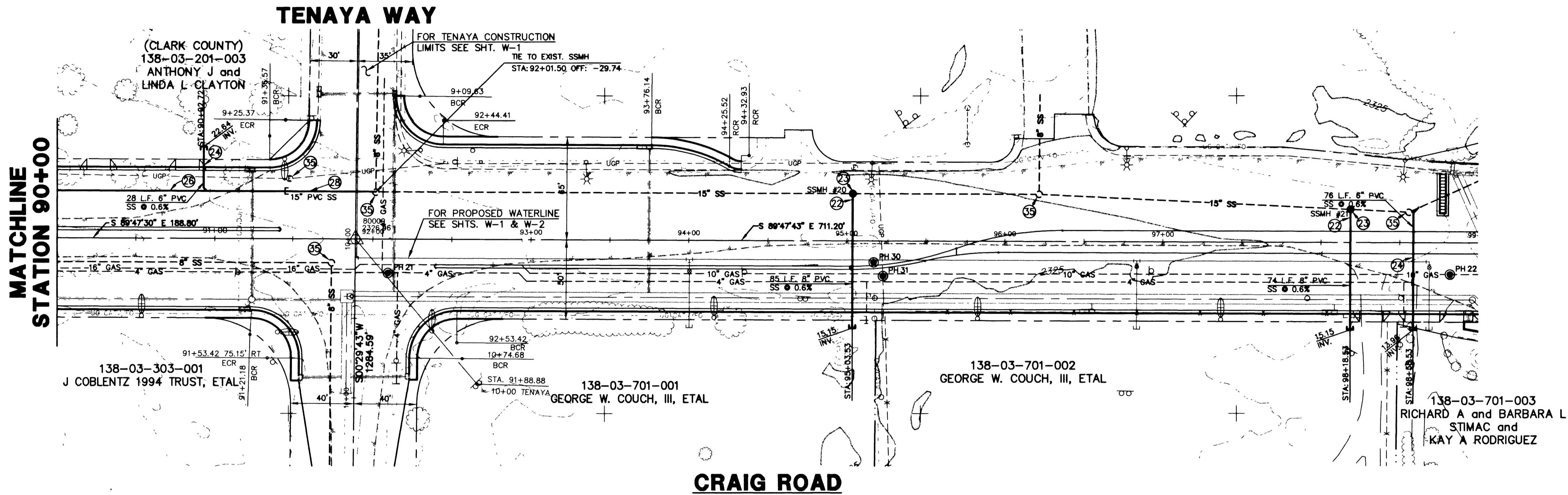

Call before you Overhead

1-702-593-6111

NEVADA POWER CORPORATION
A DIVISION OF NV ENERGY

Call before you Dig.

1-800-227-2800

NEVADA POWER CORPORATION
A DIVISION OF NV ENERGY

REV.	DATE	BY	REVISION

CITY OF LAS VEGAS
731 SOUTH FOURTH STREET
LAS VEGAS, NEVADA 89101

URS Greiner
2785 EAST DESERT INN ROAD
LAS VEGAS, NEVADA 89121
(702)-796-7775 FAX (702)-796-1803

8' & 15" SANITARY SEWER PLAN AND PROFILE STA. 90+00 TO STA. 99+00
CRAIG ROAD IMPROVEMENTS
BID NO. 00.1730.23

PROFESSIONAL ENGINEER
DOYLE MECHANICAL
2/2/2009
No. 7401

DRAWN BY: DMS/MRA 7/20/98
DESIGNED BY: DMS/MRA 7/20/98
CHECKED BY: DM 7/20/98
PROJECT NO: 44300
SCALE: 1"=40' HOR.
1"=4' VERT.

SHEET **SS-8**
OF 55 SHEETS
DRAWING NO. **107-V3048**

28365