

**CONSTRUCTION NOTES:**

- 1 CONSTRUCT CURB/GUTTER & SIDEWALK PER STD. DWG. 216 AND 234
- 2 CONSTRUCT GLUE DOWN TYPE "A" CURB SEE DETAIL SHT. TSS-2
- 3 CONSTRUCT CASE 1 SIDEWALK RAMP STD. DWG. NO. 235
- 4 CONSTRUCT PAVEMENT SECTION 4 SHEET TSS-1
- 5 CONSTRUCT RESIDENTIAL DRIVEWAY PER STD. DWG. 223
- 6 INSTALL DECORATIVE ROCK PER PAVEMENT SECTIONS AND SPEC SECTION 305
- 7 CONSTRUCT PAVEMENT TRANSITIONS PER SECTION 6 AND DETAIL ON SHEET G-2
- 8 REMOVE EXISTING VALLEY GUTTER & CURB RETURNS
- 9 REMOVE EXIST. SIDEWALK
- 10 SAWCUT & MATCH EXIST. PAVEMENT
- 11 CLEAR & GRUB PER STD. SPEC. 201.03.02 (a)
- 12 REMOVE EXISTING SIGN AND ALL APPURTENANCES
- 13 REMOVE & RELOCATE MAIL BOX
- 14 CONSTRUCT 1' MEDIAN OPENING SEE DETAIL SHT. TSS-2
- 15 CONSTRUCT PAVEMENT SECTION 5 SHEET TSS-1
- 16 GLUE DOWN MEDIAN SEE SHT. TSS-2

**RELOCATION NOTE:**  
 TELEPHONE AND ELECTRICAL CONDUIT TO REMAIN  
 CABLE TV AND FIBER OPTIC CONDUIT TO BE  
 RELOCATED BY OTHERS. STREET LIGHTS AND  
 TRAFFIC CONTROL APPURTENANCES AND  
 CONDUIT TO BE RELOCATED BY CONTRACTOR.

CURVE	LENGTH	RADIUS	DELTA	TANGENT
C12	47.27	30.00	90°17'13"	30.15
C13	46.97	30.00	89°42'35"	29.85
C15	46.92	30.00	89°36'54"	29.80
C16	47.33	30.00	90°23'19"	30.20
C42	3.14	1.00	180°00'00"	INFINITE

CURVE	LENGTH	RADIUS	DELTA	TANGENT
C43	3.14	1.00	180°00'00"	INFINITE
C44	68.15	200.00	19°31'27"	34.41
C44A	68.15	200.00	19°31'27"	34.41
C45	47.36	202.00	13°26'04"	23.79
C45A	46.89	200.00	13°26'04"	23.79
C50	51.64	100.00	29°35'20"	26.41
C51	7.75	15.00	29°35'20"	3.96

GRAPHIC SCALE

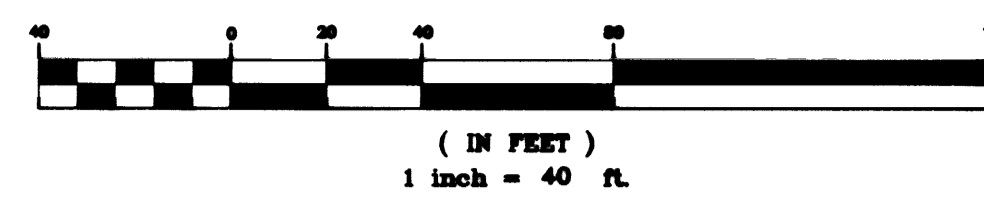

**BASIS OF BEARING**

NORTH 39°40'38" WEST BEING THE BEARING OF THE LINE FROM POINT 825 TO POINT No. 808 AS SHOWN BY THAT CERTAIN RECORD OF THE SURVEY ON FILE IN THE OFFICE OF THE CLARK COUNTY RECORDER, CLARK COUNTY, NEVADA IN FILE 88, PAGE 53. SAID BEARING BEING BASED ON THE NORTH AMERICAN DATUM OF 1983 (NAD '83), NEVADA STATE PLANE EAST ZONE(2701)

**BENCHMARK**

NAVD 88- CLY BENCH 1LV003W4  
 CLY PIN & PLATE IN TOP OF ELEC. BASE  
 SOUTH SIDE OF CRAIG RD., 250' +/- EAST  
 OF BUFFALO DR.  
 ELEVATION 714.730 METERS, 2344.91 FEET

MATCHLINE  
STATION 90+00

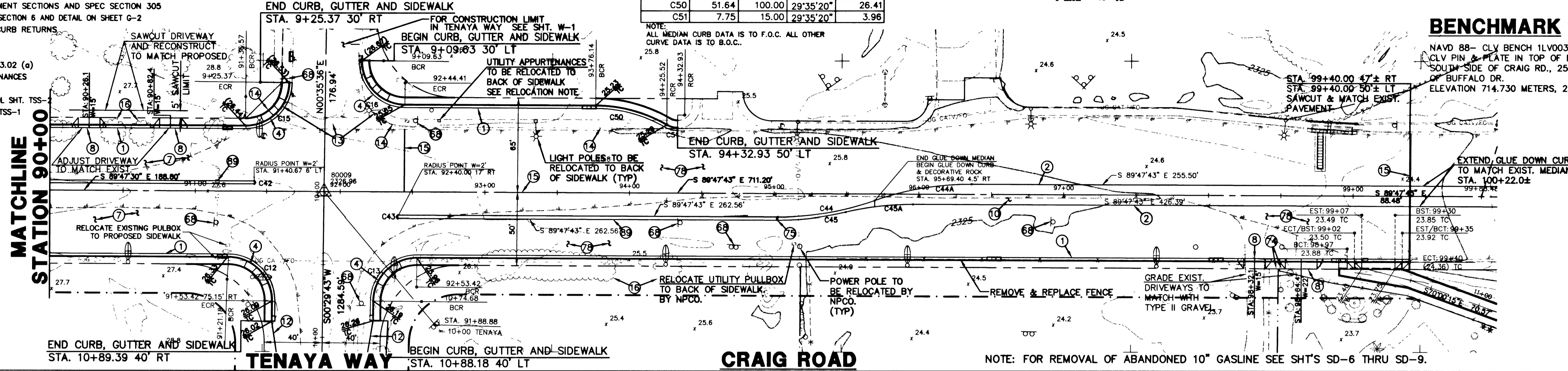

**SIDEWALK RAMP TABLE**

RAMP CURVE	"A" FT. MIN.	"B" FT. MIN.
C12	6.5	6.5
C13	6.5	6.5
C15	6.5	6.5
C16	6.5	6.5

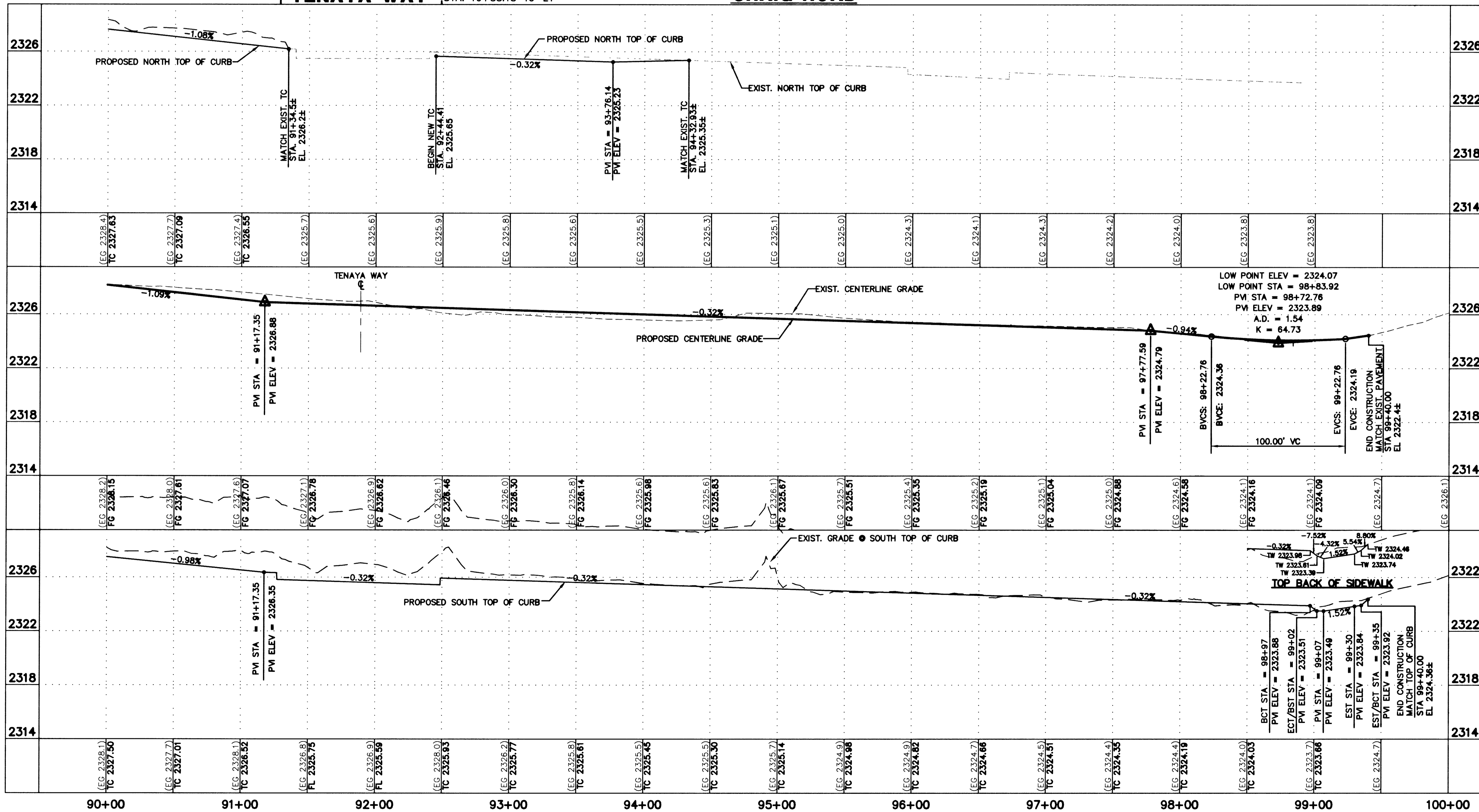

REV.	DATE	BY	REVISION

CITY OF LAS VEGAS  
 731 SOUTH FOURTH STREET  
 LAS VEGAS, NEVADA 89101

CRAIG ROAD  
 PLAN AND PROFILE  
 STA. 90+00 TO STA. 99+00

CRAIG ROAD  
 IMPROVEMENTS  
 BID NO. 00.1730.23

SHEET  
7/20/98

DESIGNED BY:  
DMS/MRA

CHECKED BY:  
DM

PROJECT NO:  
44300

SCALE:  
1"=40' HOR.  
1"=4' VERT.

DRAWING NO.  
107-V3048

**Call before you Overhead**

1-702-593-0111

**Call before you Dig**

1-800-277-2800

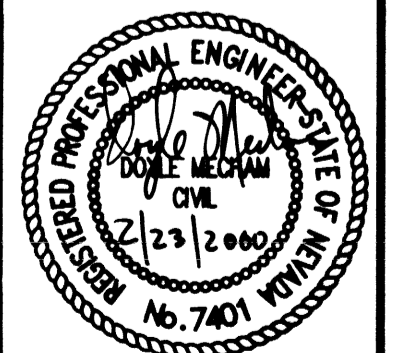

24347