

TRAFFIC SIGNAL POLE SCHEDULE										
NO.	STATION(1)	POLE TYPE	SIGNAL ARM		LUM. ARM *		SIGNALS (VEH)		SIGNALS (PED)	
			QUAD.	LENGTH	QUAD.	LENGTH	QUAD.	TYPE	QUAD.	TYPE
(A)	10+32.6 43.11 T	KX-30	4	35'	4	15'	MA	M-2(2)	4	W-3T
(B)	10+38.5 39 RT	KX-30	1	35'	1	15'	MA	M-2(2)	3	W-3T
(C)	9+67.9 42.9 RT	KX-30	2	35'	2	15'	MA	M-2(2)	4	W-3T
(D)	9+61.6 38.61 T	KX-30	3	35'	3	15'	MA	M-2(2)	1	W-3T

STATIONS MEASURED ALONG STEWART AVENUE CENTERLINE TO CENTER OF POLES  
\* USE 0' RISE LUMINAIRES

NOTES:

- CONTRACTOR TO VERIFY WITH POLE/MAST ARM MANUFACTURER LOADING FACTORS.
- SEE SHEET 5 OF 10 FOR ROADWAY IMPROVEMENT PLANS.
- SEE SHEET 9 OF 10 FOR STRIPING AND PAVEMENT MARKING PLAN.
- CONTRACTOR WILL REMOVE ALL STOP SIGNS, STREET NAME SIGNS & INTERSECTION STREET LIGHTS AFTER THE TRAFFIC SIGNAL IS FULLY FUNCTIONAL. THE SALVAGED MATERIAL SHALL BE DELIVERED TO 3104 E. BONANZA RD. CALL 229-6331 48 HOURS IN ADVANCE OF DELIVERING THE SALVAGED ITEMS.
- POLE LOCATIONS PER STD. DWG. #404.1300.

PHASE DIAGRAM

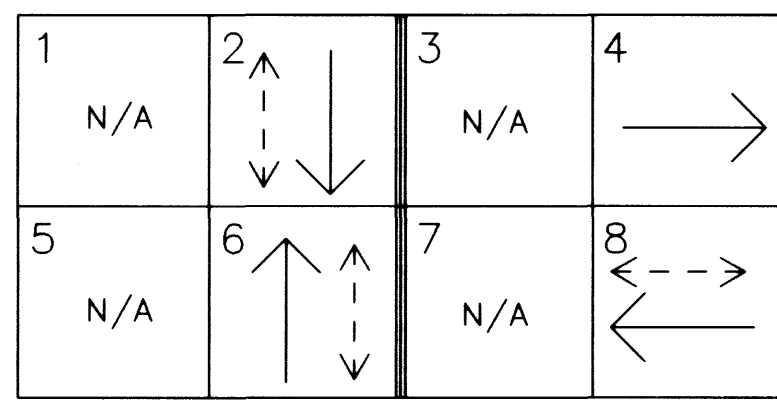

CONFLICT FLASH - ALL RED

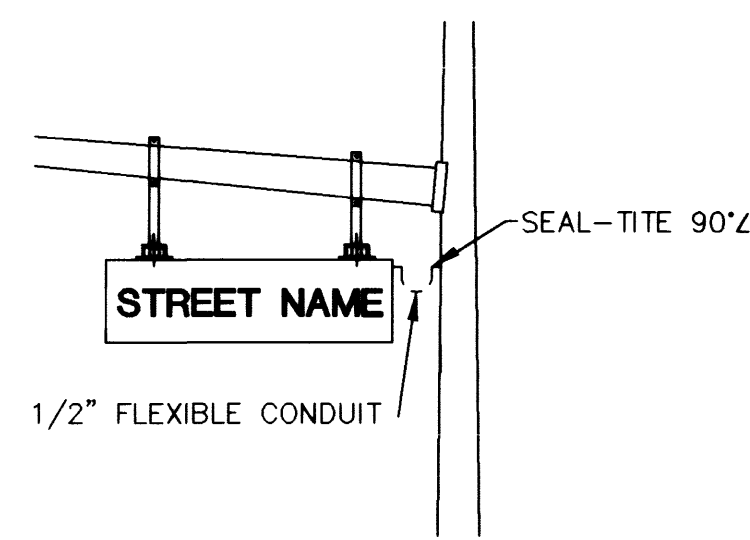
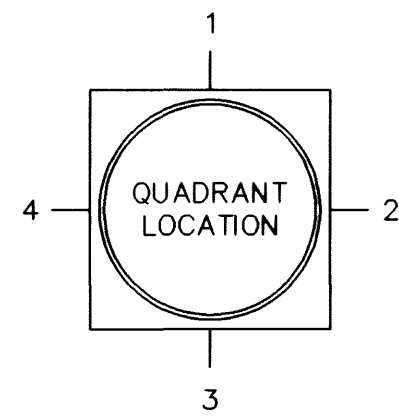

SIGN CONNECTION DETAIL

SIGN SCHEDULE			
POLE	INTERNALLY ILLUMINATED STREET NAME SIGN	BLOCK NUMBER SIGN LEGEND	SIGN WIDTH
(A)	STEWART	E 700	6'
(B)	7 TH ST.	N 200	6'
(C)	STEWART	E 600	6'
(D)	7TH ST.	N 300	6'

SEE USD DRAWINGS 404.417 AND 404.420.  
BLOCK NUMBER SIGN TO BE CENTERED ON ILLUMINATED STREET NAME SIGN.  
SEE SIGN CONNECTION DETAIL HEREON.

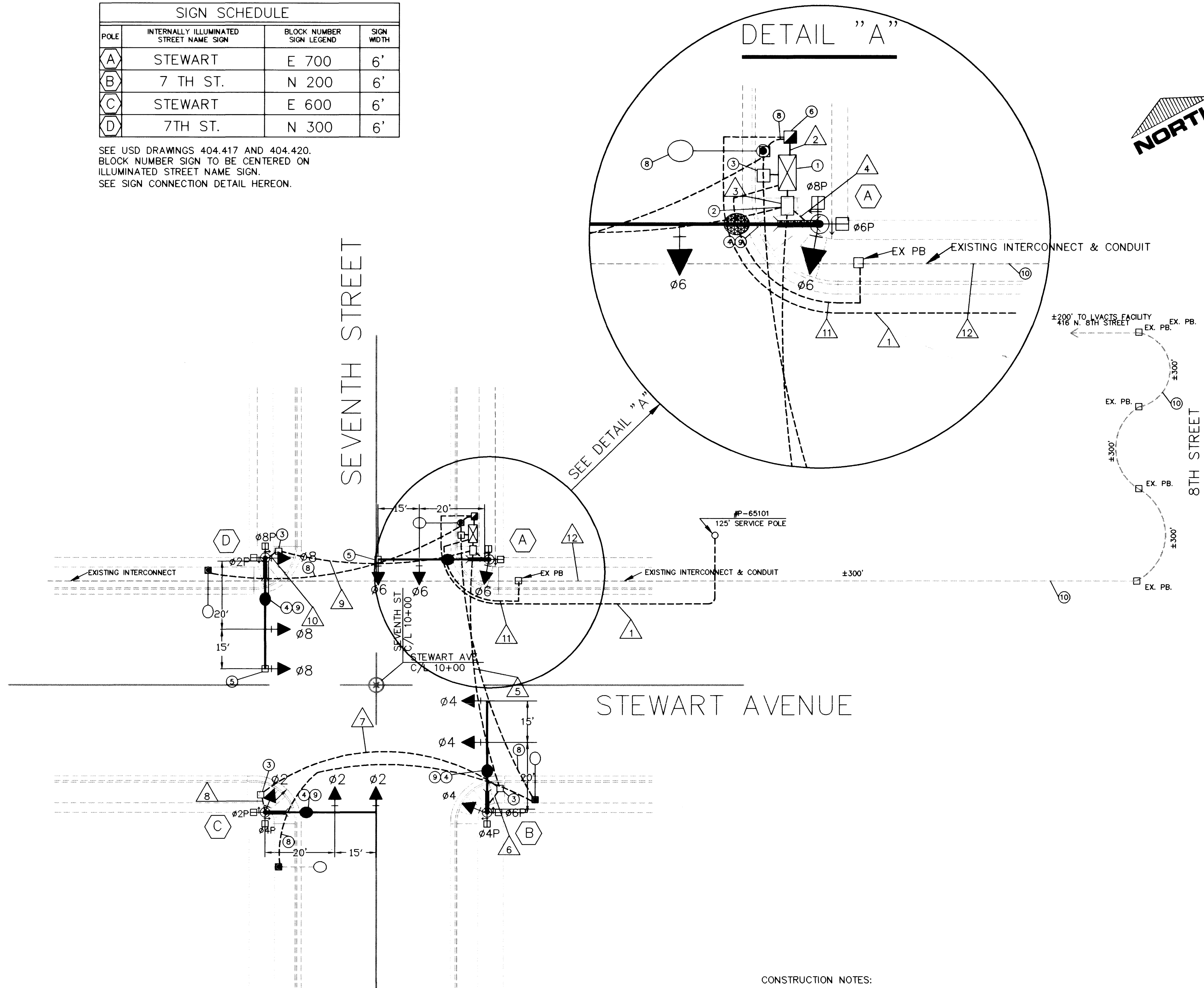

LVACTS NOTES

CONTRACTOR IS TO CALL 229-6611 BETWEEN 6:30AM AND 2:30PM MONDAY THROUGH FRIDAY TO COORDINATE WITH COMMUNICATION TECHNICIAN REGARDING CONNECTION AT LVACTS. A NEW CONNECTION (6-PAIR OVER-PULL IN EXISTING CONDUIT) MAY BE DONE BETWEEN THE HOURS OF 6:30AM AND 2:30PM MONDAY THROUGH FRIDAY.

ANY WORK THAT REQUIRES DISCONNECTION OF ANY EXISTING COMMUNICATION CIRCUITS SHALL BE DONE BETWEEN THE HOURS OF 9:00PM AND 5:00AM, SUNDAY THROUGH THURSDAY, UNLESS SPECIFICALLY AUTHORIZED BY LVACTS.

CONSTRUCTION NOTES:

- INSTALL TYPE 'R' CONTROL CABINET PER CLV SPECS.
- NO. 7 PULLBOX
- NO. 5 PULLBOX
- INSTALL EITHER "PEEKVISION VIDEOTRAK 900" OR "AUTOSCOPE 2004" VIDEO DETECTION SYSTEM. 8281 COAXIAL CABLE AND 3-#14 S/J CHORD SHALL BE RUN FROM THE CABINET TO THE CAMERA FOR THE VIDEO SYSTEM. THE CAMERA SHALL BE MOUNTED AT THE HIGHEST POINT ON THE LUMINAIRE ARM. PER CLV SPECS. 623.T.02.02.L ONLY BNC CONNECTOR SHALL BE USED IN COAXIAL CABLE.
- THE CONTRACTOR SHALL PROVIDE AND INSTALL OPTICOM EQUIPMENT FOR FIRE PRE-EMPTION AS SPECIFIED IN THE CONTRACT AND DOCUMENTS. INSTALLATION OF OPTICOM EQUIPMENT IS CONSIDERED PART OF CONTROLLER EQUIPMENT. THE OPTICOM DETECTORS SHALL BE MOUNTED ON TOP OF THE LEFT TURN SIGNAL HEADS OF POLES "A" & "D".
- INSTALL NEW 200 AMP PAD MOUNT SERVICE PEDESTAL FOR TRAFFIC SIGNALS AND STREET LIGHTING WITH 1-2P-60 AMP CIRCUIT BREAKERS (CB), 1-1P-15 AMP CB, 1-1P-40 AMP CB, 1-1P-60 AMP CB, 1-2P-60 AMP CONTACTORS AND 1 BY-PASS SWITCHER CONNECTOR.
- NEW POLE FOUNDATIONS FOR POLES "A", "B", "C" & "D" WILL BE TYPE "H" FOUNDATIONS PER CLV. STD. DRAWING NO. 404.208.
- INSTALL 2" CONDUIT WITH PULL STRING FOR STREET LIGHTING.
- STREETLIGHT LUMINAIRES SHALL BE FED FROM POWER AT THE SIGNAL CABINET. THERE SHALL BE #10 AWG THW TO EACH POLE. EACH CONDUCTOR IS INDIVIDUALLY FUSED IN THE CABINET, FED FROM A #4 AWG THW CONDUCTOR SEPARATE FROM THE SERVICE.
- INSTALL 6 PAIR INTERCONNECT CABLE FROM LVACTS BUILDING AT 416 N. 8 TH STREET TO CONTROLLER IN EXISTING CONDUIT.

CONDUIT AND WIRE SCHEDULE																
WIRE & CABLE	FROM	TO	VIA CONDUIT													
			1	2	3	4	5	6	7	8	9	10	11	12		
3/0 WIRE SERVICE DROP	SERVICE POINT	SERVICE PEDESTAL	X													
3 #4 AWG THW 1 #8 AWG THW	SERVICE PEDESTAL	CONTROLLER	X													
25 COND. #14 2-#10 AWG THW 1-#8 AWG THW GROUND OPTICOM CABLE 8281 COAX 3-#14 AWG S/J CHORD	CONTROLLER	POLE (A)		X												
25 COND. #14 2-#10 AWG THW 1-#8 AWG THW GROUND OPTICOM CABLE 8281 COAX 3-#14 AWG S/J CHORD	CONTROLLER	POLE (B)		X												
25 COND. #14 2-#10 AWG THW 1-#8 AWG THW GROUND OPTICOM CABLE 8281 COAX 3-#14 AWG S/J CHORD	CONTROLLER	POLE (C)		X												
25 COND. #14 2-#10 AWG THW 1-#8 AWG THW GROUND OPTICOM CABLE 8281 COAX 3-#14 AWG S/J CHORD	CONTROLLER	POLE (D)		X												
6 PAIR INTERCONNECT	LVACTS	CONTROLLER	X													
CONDUIT: NUMBER - SIZE			1-3"	1-2"	4-3" 2-2"	1-3"	2-3"	1-3"	1-3"	1-3"	1-3"	1-3"	1-3"	1-2"	(1-3")	



REVISIONS

DATE

W.A. # N/A

DESIGN BY HES

SCALE (V) N/A

DATE MAY 1997

SCALE (H) 1"=20'

F.D. BK. # N/A

ENGINEERING DESIGN DIVISION

DENNIS ANDERSON, P.E.

EDWARD C. NETTENSTROM, P.E.

DESIGN ENGINEER

DEPARTMENT OF PUBLIC WORKS

PROJECT: TRAFFIC SIGNALS

SHEET: STEWART & 7 TH ELECTRICAL LAYOUT

RESERVED PROFESSIONAL ENGINEER'S SEAL

CIVIL 8-21-97

NO. 8078

DRAWING NO. 208-7424

6

10

L:\NDRP\DESIGN\3\_51\grain16\_15\_275 Thu Aug 21 12:42:01 1997 .R5