

**INSTALLATION OF METER AND VAULT (2) 6" X 3" FRACT**

THE METER(S) AND VAULT(S) WITH NON-TRAFFIC BEARING COVER(S) SHALL BE INSTALLED IN ACCORDANCE WITH THE UDACS PLATE NO. 210 AND WITH STANDARD VAULT DRAWING C-475, LATEST REVISION.  
 ANY BLOCK WALL OR OTHER FENCE MATERIAL SHALL BE DESIGNED AND CONSTRUCTED AROUND THE OUTSIDE OF THE EASEMENT(S) TO ALLOW THE DISTRICT DIRECT ACCESS TO THE VAULT(S) FROM THE ADJACENT RIGHT-OF-WAY.

METERS MUST BE SET IN A HORIZONTAL POSITION. AT LEAST EIGHT (8) DIAMETERS OF STRAIGHT PIPE ARE REQUIRED AT THE INLET END.

**DRIVEWAY AND LATERAL STATION TABLE**

\* ALL STATIONS IN THIS TABLE ARE AT BACK OF CURB

LOT NUMBER	DRIVEWAY		SEWER		WATER	
	CENTERLINE STATION	WIDTH	LATERAL STATION	LATERAL STATION	LATERAL STATION	LATERAL STATION
10	STA: 19+26.74		STA: 19+08.78	STA: 19+13.82		
11	STA: 19+53.78		STA: 19+38.83	STA: 19+43.87		
12	STA: 19+83.83		STA: 19+71.20	STA: 19+68.10		
13	STA: 20+20.09		STA: 20+02.77	STA: 20+07.56		
14	STA: 20+46.88		STA: 20+31.98	STA: 20+36.86		
15	STA: 20+77.66		STA: 20+61.66	STA: 20+66.66		
16	STA: 21+19.47		STA: 21+01.66	STA: 21+06.66		
17	STA: 21+46.88		STA: 21+31.66	STA: 21+36.66		
18	STA: 21+77.66		STA: 21+59.66	STA: 21+64.66		
60	STA: 23+86.63		STA: 23+59.47	STA: 23+64.47		
61	STA: 23+59.24		STA: 23+41.46	STA: 23+46.46		
62	STA: 22+28.46		STA: 22+18.46	STA: 22+23.46		
63	STA: 22+28.31		STA: 22+18.31	STA: 22+23.31		
64	STA: 22+50.19		STA: 22+40.19	STA: 22+45.19		
65	STA: 22+18.60		STA: 22+08.60	STA: 22+13.60		
66	STA: 21+73.19		STA: 21+63.19	STA: 21+68.19		
67	STA: 21+46.79		STA: 21+36.79	STA: 21+41.79		
68	STA: 21+15.01		STA: 21+05.01	STA: 21+10.01		
69	STA: 20+73.19		STA: 20+63.19	STA: 20+68.19		
70	STA: 20+45.79		STA: 20+35.79	STA: 20+40.79		
71	STA: 20+15.01		STA: 20+05.01	STA: 20+10.01		
72	STA: 19+62.13		STA: 19+52.13	STA: 19+57.13		
73	STA: 19+34.01		STA: 19+24.01	STA: 19+29.01		
74	STA: 19+02.84		STA: 19+15.76	STA: 19+20.81		
125	STA: 18+62.21		STA: 18+49.53	STA: 18+54.53		
126	STA: 18+90.12		STA: 18+80.01	STA: 18+85.01		
127	STA: 19+08.62		STA: 19+08.62	STA: 19+13.62		
128	STA: 19+62.18		STA: 19+50.30	STA: 19+55.30		
129	STA: 19+88.78		STA: 19+73.73	STA: 19+78.78		
130	STA: 20+18.92		STA: 20+01.08	STA: 20+06.08		
131	STA: 20+60.64		STA: 20+42.64	STA: 20+47.64		
132	STA: 20+88.04		STA: 20+72.82	STA: 20+77.82		
133	STA: 21+18.82		STA: 21+00.82	STA: 21+05.82		
134	STA: 21+61.97		STA: 21+44.15	STA: 21+49.15		
135	STA: 21+89.37		STA: 21+74.15	STA: 21+79.15		
136	STA: 22+20.12		STA: 22+02.15	STA: 22+07.15		
137	STA: 22+58.63		STA: 22+46.60	STA: 22+51.60		
138	STA: 22+85.17		STA: 22+69.95	STA: 22+74.95		
139	STA: 23+15.21		STA: 22+97.30	STA: 23+02.30		
157	STA: 24+16.31		STA: 24+34.12	STA: 24+39.12		
158	STA: 23+88.90		STA: 24+04.12	STA: 24+09.12		
159	STA: 23+58.12		STA: 23+76.12	STA: 23+81.12		
160	STA: 23+16.31		STA: 23+34.12	STA: 23+39.12		
161	STA: 22+88.90		STA: 23+04.12	STA: 23+09.12		
162	STA: 22+58.12		STA: 22+76.12	STA: 22+81.12		
163	STA: 21+16.31		STA: 21+28.12	STA: 21+33.12		
164	STA: 21+16.31		STA: 21+28.12	STA: 21+33.12		
165	STA: 21+58.12		STA: 21+76.12	STA: 21+81.12		
166	STA: 21+16.31		STA: 21+28.12	STA: 21+33.12		
167	STA: 21+16.31		STA: 21+28.12	STA: 21+33.12		
168	STA: 20+58.12		STA: 20+76.12	STA: 20+81.12		
169	STA: 20+15.32		STA: 20+28.71	STA: 20+33.71		
170	STA: 19+88.90		STA: 19+97.80	STA: 20+02.80		
171	STA: 19+54.79		STA: 19+72.86	STA: 19+77.86		

**FIRE HYDRANT INSTALLATION**

FIRE HYDRANTS TO BE INSTALLED IN ACCORDANCE WITH THE UDACS STANDARD PLATE NO. 7

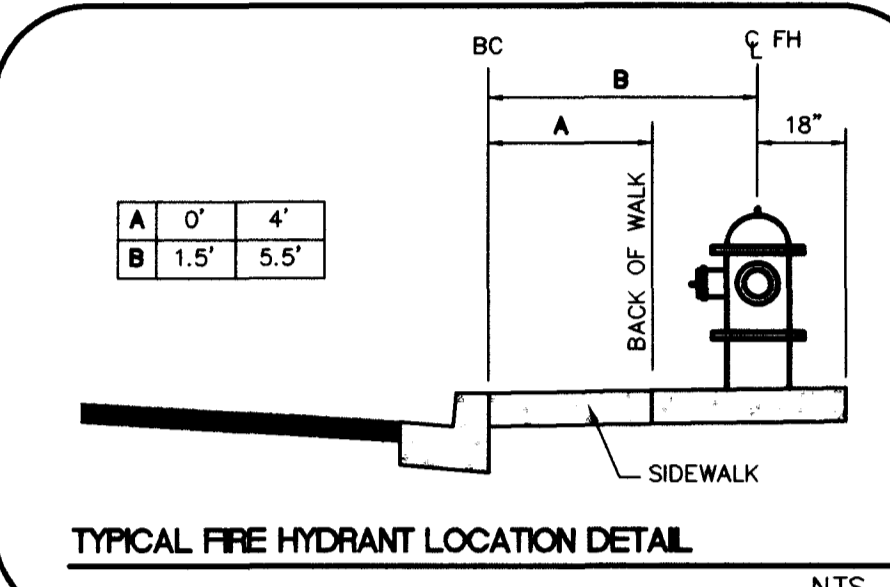

**WATER UTILITY CONSTRUCTION NOTES**

- 1) 6" F.H. ASSEMBLY (INCLUDES 8" x 6" TEE AND 6" GATE VALVE)
- 2) 8" GATE VALVE
- 3) 8" WATER MAIN
- 4) 8" x 8" x 8" TEE WITH THRUST BLOCK
- 5) 8" 90° BEND WITH THRUST BLOCK
- 6) 1" WATER SERVICE
- 7) IRRIGATION SLEEVES PER SS# U-18
- 8) 8" x 10" REDUCER
- 9) 8" 18" FABRICATED BEND
- 10) 1" WATER SERVICE WITH RPPA PER UDACS PLATE NO. 10 AND IRRIGATION POWER SOURCE
- 11) 10" GATE VALVE
- 12) 8" x 6" REDUCER
- 13) 2" WATER SERVICE WITH RPPA PER UDACS PLATE NO. 10 AND IRRIGATION POWER SOURCE
- 14) 10" x 10" x 10" TEE
- 15) 10" WATER MAIN
- 16) 12" x 8" TAPPING TEE AND VALVE
- 17) 12" x 6" REDUCER
- 18) 6" 90° BEND
- 19) 4" SEWER LATERAL
- 20) 8" SEWER
- 21) 48" SEWER MANHOLE
- 22) 1 1/2" CONDUIT WITH 2 #4 AND 1 #6 CONDUCTOR
- 23) STREET LIGHT
- 24) 1 1/2" CONDUIT WITH 2 #4 AND 1 #6 CONDUCTOR
- 25) STREET SIGN
- 26) STOP SIGN (R1-1)
- 27) STREET NAME SIGN (D-3)

**APPROVALS**

APPROVAL OF THESE PLANS SHALL NOT BE CONSTRUED TO BE A PERMIT FOR OR AN APPROVAL OF ANY VIOLATION OF ANY OF THE PROVISIONS OF THE STATE OR COUNTY LAWS. G.F.M. 1/22/99

CLV: [Signature] FIRE DEPARTMENT DATE: 1/29/99

[Signature] DATE: 2-09-99

LAS VEGAS VALLEY WATER DISTRICT 1/27 APPROVED 1/27/99 DATE

**ABANDONED VALVE CUT AND CAP**

ALL VALVES TO BE ABANDONED IN THE CLOSED POSITION, UNLESS OTHERWISE, BY REMOVING A MINIMUM OF THE TOP 12 INCHES OF THE VALVE BOX AND THEN FILLING THE REMAINING PORTION OF THE VALVE BOX WITH CONCRETE HAVING A COMPRESSIVE STRENGTH OF AT LEAST 2,000 PSI.

THE CONTRACTOR SHALL CUT THE EXISTING PIPE 3' BEYOND THE ABANDONED VALVE AND INSTALL A CAP WHERE A JOINT OR COUPLING IN THE EXISTING PIPE IS UNCOVERED AT THE CUT AND CAP LOCATION. THE INSTALLATION OF A PLUG MAY BE PERMITTED WITH DISTRICT APPROVAL. THE CONTRACTOR SHALL INSTALL A CONCRETE THRUST BLOCK IN ACCORDANCE WITH THE PROVISIONS OF THE UDACS PLATE NO. 5 AT ALL CAP OR PLUG LOCATIONS.

**REDUCED PRESSURE PRINCIPLE ASSEMBLY (2) 8"**

APPROVED REDUCED PRESSURE PRINCIPLE ASSEMBLY(S) SHALL BE INSTALLED PER THE UDACS PLATE NO. 118. NO WATER SHALL BE TAKEN FROM A SERVICE REQUIRING BACKFLOW PREVENTION UNTIL THE REDUCED PRESSURE PRINCIPLE ASSEMBLY HAS BEEN SUCCESSFULLY TESTED BY THE LVWD.

ANY BLOCK WALL OR OTHER FENCE MATERIAL SHALL BE DESIGNED AND CONSTRUCTED AROUND THE OUTSIDE OF THE EASEMENT(S) TO ALLOW DISTRICT DIRECT ACCESS FROM THE ADJACENT RIGHT-OF-WAY.

**CITY OF LAS VEGAS FIRE DEPARTMENT FIRE FLOW DATA**

TYPE OF CONSTRUCTION	DESCRIPTION	V-N
NO. OF STORES		2
TOTAL FLOOR AREA (SQ.FT.)		4,857 sq.ft.
LARGEST SUCCESSIVE FLOOR AREA		4,558 sq.ft.
ESTIMATED FIRE FLOW		1750 GPM
BUILDING HEIGHT		38'
SPRINKLED		NO

**BENCHMARK**

CITY OF LAS VEGAS BENCHMARK  
 QLV001934 R/WIT & PLATE IN TOP OF CURB NW SIDE OF TOWN CENTER DRIVE & SOUTH CIRCLE ISLAND  
 2725.923 NAVD 1929 DATUM  
 2718.37 NAVD 1988 DATUM (831.6074 M)  
 2726.19 SUMMERLIN DATUM

**BASIS OF BEARING**

NORTH 15°23'46" EAST BEING THE BEARING OF THE CENTERLINE OF ANAZAZI DRIVE, AS SHOWN BY MAP THEREOF ON FILE IN BOOK 74, PAGE 70 OF PLATS IN THE CLARK COUNTY RECORDER'S OFFICE, CLARK COUNTY NEVADA

SEE SHEET C6, DRAWING NO. 6 FOR ESTIMATED UTILITY QUANTITIES

**LOTS WITH BACKWATER VALVES**

THE FOLLOWING LOTS REQUIRE SEWER BACKWATER VALVES  
 LOTS 10-12, 17, 18, 41-46, 52-61, 65-70, 73, 74, 126-128, 131-137, 141-148, 155, 156

**DISCLAIMER NOTE:**

UTILITY LOCATIONS SHOWN HEREON ARE APPROXIMATE ONLY. IT SHALL BE THE CONTRACTOR'S RESPONSIBILITY TO DETERMINE THE EXACT HORIZONTAL AND VERTICAL LOCATION OF ALL EXISTING UNDERGROUND OR OVER-HEAD UTILITIES PRIOR TO COMMENCING CONSTRUCTION. NO REPRESENTATION IS MADE THAT ALL EXISTING UTILITIES ARE SHOWN HEREON. THE ENGINEER ASSUMES NO RESPONSIBILITY FOR UTILITIES NOT SHOWN OR UTILITIES NOT SHOWN IN THEIR PROPER LOCATION. CONTRACTOR TO NOTIFY ENGINEER OF ANY CHANGES OR DISCREPANCIES.

Avoid cutting underground utility lines. It's costly. Call before you dig. 1-800-227-2600 (UTILITY SERVICE, USA)

Avoid overhead power line contact. Call before you Overhead. 1-702-593-6111 (NEVADA POWER DEPARTMENT AND SAFETY SERVICES DEPARTMENT)

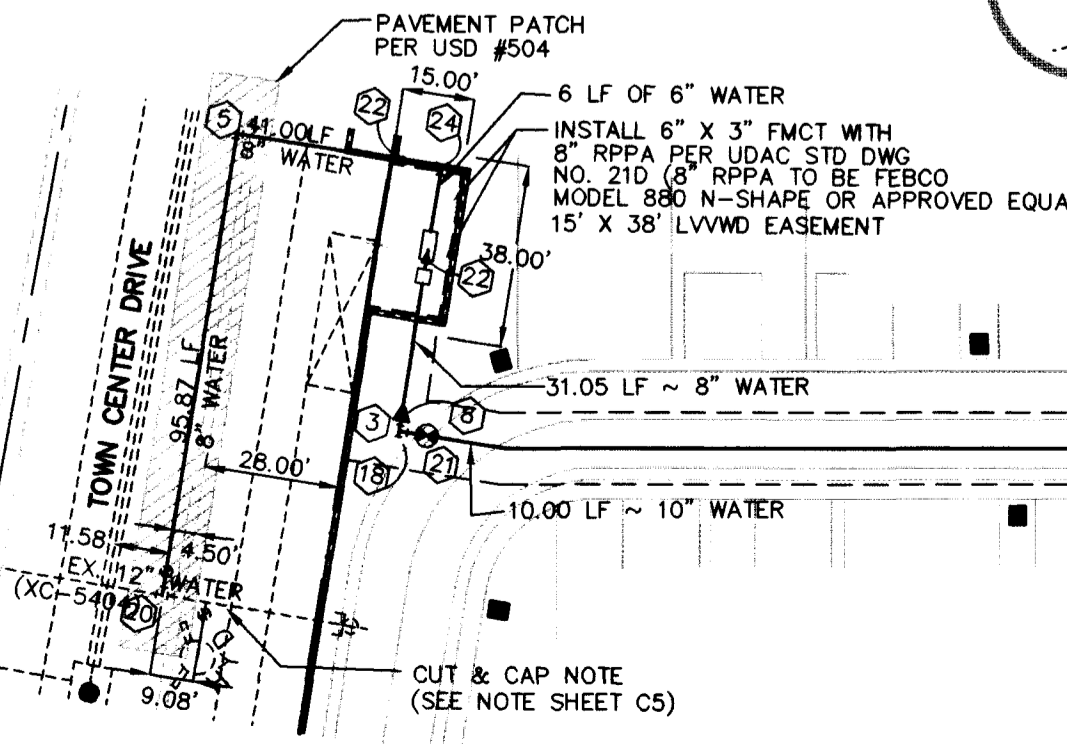
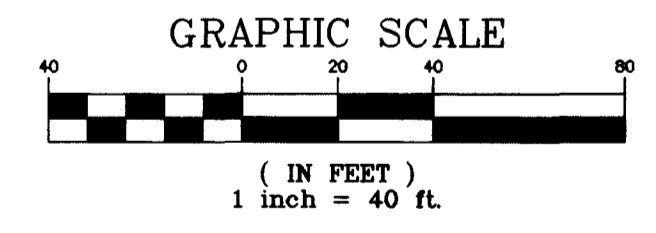
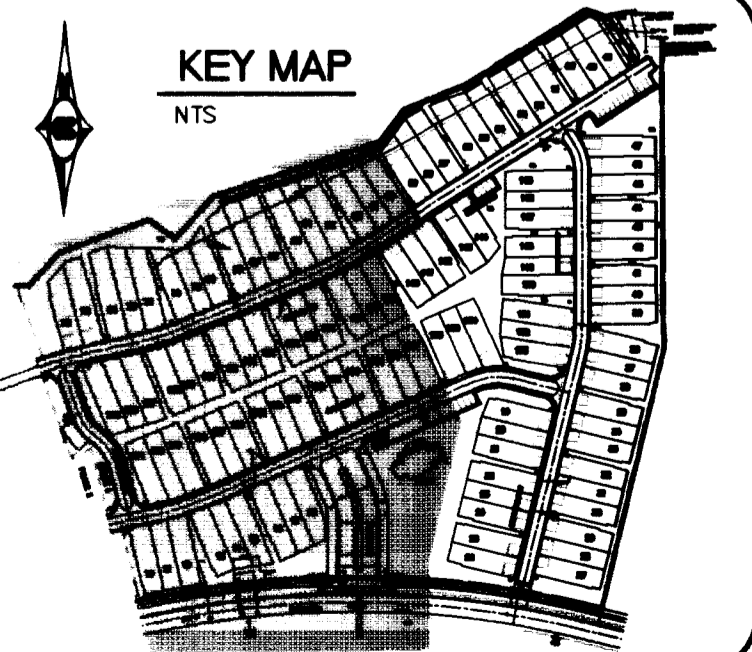

1376 14468

REVISED PROPERTY LINES  
 REVISED CLV ST. STREETLIGHT TO GAS LAMP  
 ADDED 2" SEWAGE WITH RPPA  
 REVISED STREET NAMES TO MATCH  
 1/23/99  
 2-5-99  
 2-5-99  
 2-5-99

FLITE HOMES CORPORATION  
 1835 Wagon Center Circle, Suite 250  
 Las Vegas, Nevada 89004  
 (702) 258-7900

An American Favorite

CL Carter :: Burgess  
 2955 East Sunset Road, Suite 105  
 Las Vegas, NV 89120  
 Consultants in Planning, Engineering, Architecture, Construction Management, and Related Services  
 (702) 798-1007 Fax (702) 798-7056

UTILITY PLAN

COTTONWOOD TERRACE PHASE I

DRAWN BY: DMR  
 DESIGNED BY: ES  
 CHECKED BY: BUT  
 PROJECT NO.: BRG0680  
 SCALE: 1"=40' HORIZ. VERT. N/A

1/29/99

SHEET C6  
 6 OF 19 SHEETS  
 DRAWING NO. 3074-4596-1

THIS IS A RE-PLAT

