

BENCHMARK			
B.M. No.	DESCRIPTION	NAVD88 DATUM	SUMMERLIN DATUM
OLV09-36ES	C.I.V. RIVET & PLATE IN TOP OF CURB, NE CORNER OF CHARLESTON BLVD. & HUALAPAI WAY	2912.23 FEET	2910.05 FEET
		887.650 MTRS	886.985 MTRS

NOTE: THIS SET OF DRAWINGS ARE BASED ON NAVD88 DATUM. PREVIOUS DRAWINGS MAY BE BASED ON SUMMERLIN DATUM. CARE SHOULD BE OBSERVED IN UTILIZING THIS SET OF DRAWINGS.

**CONSTRUCTION NOTES**

- IMPROVEMENTS**
- INSTALL "A" TYPE CURB (R-5.1.1) TYPE 2
  - INSTALL "L" TYPE CURB & GUTTER (R-5.1.1) TYPE 5
  - INSTALL AC PAVEMENT PER SECTION SHEET 17
  - CONSTRUCT HANDICAP RAMP CURB DEPRESSION (S-75)
  - RELOCATION OF OVERHEAD TO UNDERGROUND AND REMOVAL OF WOODEN POLES TO BE PROVIDED BY NPC AND SPRINT REFER TO NPC DESIGN DRAWINGS FOR FURTHER DETAILS
  - PROTECT EXISTING POWER POLE IN PLACE
  - INSTALL "A" TYPE ISLAND CURB (S-50)
  - CONSTRUCT CONCRETE CROSS GUTTER (S-84)
  - REMOVE EXISTING AC PAVEMENT
  - PROTECT IN PLACE

- WATER**
- INSTALL WATER PIPES PER LVWD UDACS STDS.
- INSTALL 12" DIA. GATE VALVE & BOX
  - INSTALL 12"x12"x45" ELBOW
  - INSTALL 12"x12"x12" TEE
  - INSTALL 12"x12" 90° ELBOW
  - INSTALL 12"x12"x6" TEE
  - INSTALL 12"x6" REDUCER
  - INSTALL 2" BLOW-OFF & CAP
  - INSTALL FIRE HYDRANT ASSEMBLY COMPLETE
  - INSTALL 12"x12"x12" CROSS
  - INSTALL 6" DIA. GATE VALVE

- STORM DRAIN**
- INSTALL STORM DRAINAGE PER N.D.O.T. STDS.
- INSTALL STORM DRAIN MANHOLE, TYPE 4 (R-4.7.2) NDOT
  - INSTALL TYPE 11 DROP INLET (R-4.6.2) NDOT
  - INSTALL TYPE 3 DROP INLET (R-4.3.1) NDOT

- IRRIGATION**
- INSTALL BANK "A" IRRIGATION SLEEVE, 1-6" AND 2-4", PVC (U-18)

- SEWER**
- INSTALL SEWER PIPES PER DCSWCS STDS.
- INSTALL SEWER MANHOLE (D-1)

- STREET LIGHTING**
- INSTALL STREET LIGHT, SEE ELECTRICAL PLANS
  - STREET LIGHT CONDUIT AND PULLBOXES, SEE ELECTRICAL PLANS

- TRAFFIC**
- INSTALL 2-3" CONDUIT FOR TRAFFIC SIGNAL WITH PULL STRING
  - INSTALL NO. 5 PULLBOX (E-32)
  - INSTALL 1-2" INTERCONNECT CONDUIT WITH PULL STRING, STUB AND CAP.
  - INSTALL TYPE XX-A POLE WITHOUT MAST ARM. PROVIDE 400 WATT HPS 120 V ARM MOUNTED CUTOFF INTERSECTION LUMINAIRE PER ELECTRICAL PLANS. TYPE XX-A POLE TO BE INSTALLED USING TYPE "L" FOUNDATIONS.

NOTE: N.D.O.T. ENCROACHMENT PERMIT REQUIRED

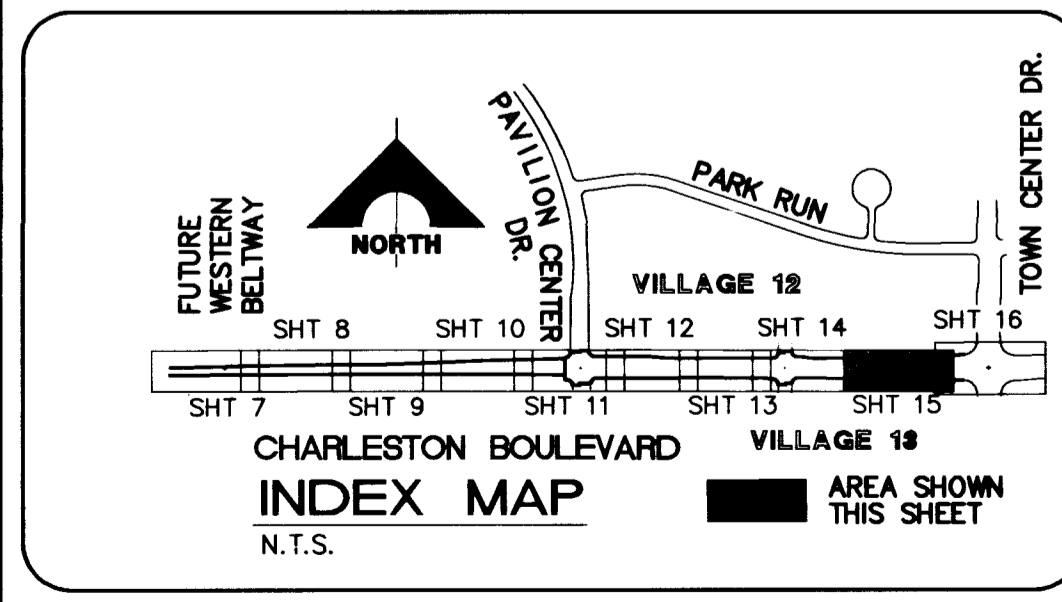

APPROVAL: *[Signature]* 11/10/98  
 LAS VEGAS VALLEY WATER DISTRICT DATE

MATCH LINE STA 879+50 SEE SHEET 14

MATCH LINE STA 884+50 SEE SHEET 16

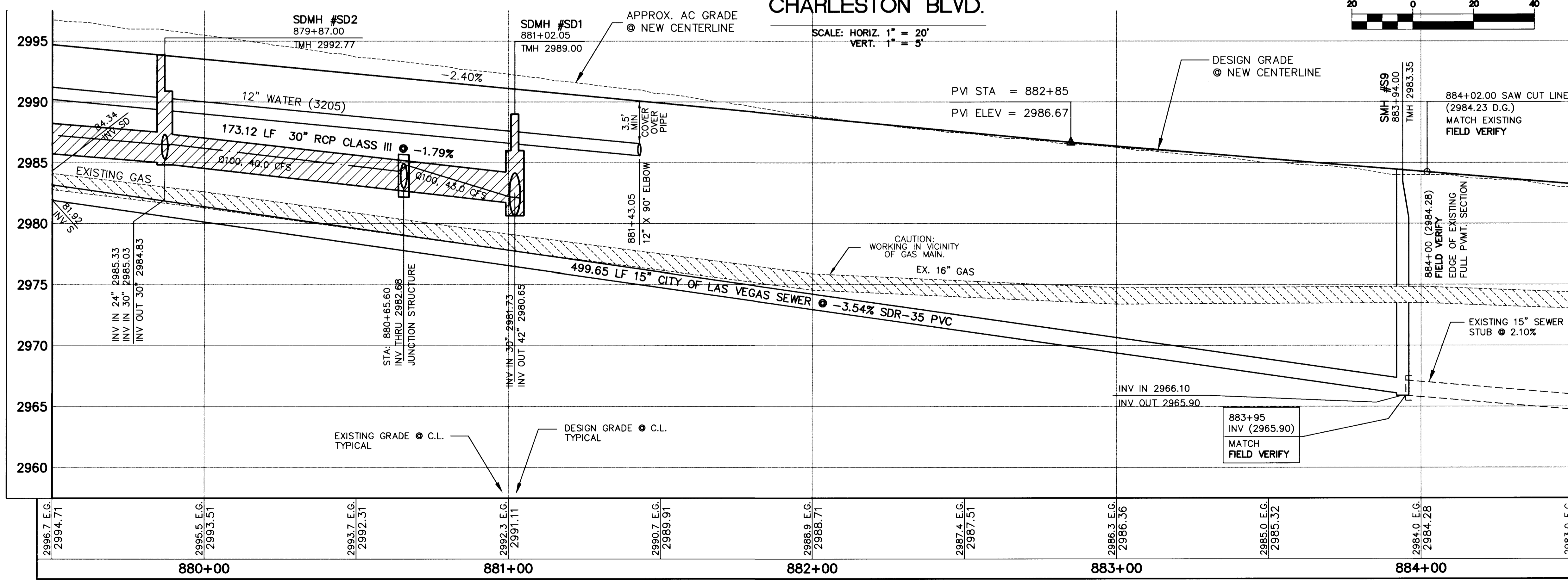

2996.7 E.G. 2994.71  
 2995.5 E.G. 2993.51  
 2993.7 E.G. 2992.31  
 2992.3 E.G. 2991.11  
 2990.7 E.G. 2989.91  
 2988.9 E.G. 2988.71  
 2987.4 E.G. 2987.51  
 2986.3 E.G. 2986.36  
 2985.0 E.G. 2985.32  
 2984.0 E.G. 2984.28  
 2983.0 E.G. 2983.24

RECOMMENDED  
 BERT A. WALLACE, INC.  
 ENGINEER/ARCHITECTURE  
 1555 SOUTH RAINBOW BLVD., LAS VEGAS, NEVADA 89102 (702) 363-1200  
 SUMMERLIN DIVISION: (702) 363-0991

STATE OF NEVADA  
 PROFESSIONAL ENGINEER  
 BERT A. WALLACE  
 LICENSE NO. 10259

SUMMERLIN  
 CHARLESTON BOULEVARD  
 PAVILION CENTER DRIVE TO TOWN CENTER DRIVE  
 PLAN & PROFILE  
 STA 879+50.00 TO 884+50.00

SHEET  
**15**  
 SHEET 15 OF 25

JOB NO. 62012.224

