

**GENERAL NOTES**

- ALL CONSTRUCTION AND MATERIALS SHALL BE IN ACCORDANCE WITH THE SUMMERLIN IMPROVEMENT STANDARDS AS APPROVED BY THE CITY COUNCIL ON 11/18/92, SIGNED BY CLV 2/2/93, "UNIFORM STANDARD SPECIFICATIONS FOR PUBLIC WORKS CONSTRUCTION OFF-SITE IMPROVEMENTS, CLARK COUNTY AREA NEVADA", LATEST ISSUE, THE "UNIFORM STANDARD DRAWINGS FOR PUBLIC WORKS CONSTRUCTION, CLARK COUNTY AREA NEVADA", LATEST ISSUE, AND OTHER APPLICABLE STANDARDS ISSUED BY THE CONTROLLING AGENCY; THE UNIFORM BUILDING CODE; AND ALL LOCAL CITY CODES AND ORDINANCES APPLICABLE, EXCEPT AS NOTED ON THIS SHEET AS "DEVIATIONS FROM STANDARDS".
- THE EXISTENCE AND LOCATION OF ANY OVERHEAD OR UNDERGROUND UTILITY LINES, PIPES, OR STRUCTURES SHOWN ON THESE PLANS ARE OBTAINED BY A RESEARCH OF THE AVAILABLE RECORDS. EXISTING UTILITIES ARE LOCATED ON PLANS ONLY FOR THE CONVENIENCE OF THE CONTRACTOR. EXISTING UTILITY SERVICE LATERALS MAY NOT BE SHOWN ON THE PLANS. THE CONTRACTOR SHALL, AT HIS OWN EXPENSE, LOCATE ALL UNDERGROUND AND OVERHEAD INTERFERENCES WHICH MAY AFFECT HIS OPERATION DURING CONSTRUCTION AND SHALL TAKE ALL NECESSARY PRECAUTIONS TO AVOID DAMAGE TO SAME. THE CONTRACTOR SHALL USE EXTREME CAUTION WHEN WORKING NEAR OVERHEAD OR UNDERGROUND POWER, GAS AND/OR OTHER UTILITIES SO AS TO SAFELY PROTECT ALL PERSONNEL AND EQUIPMENT, AND SHALL BE RESPONSIBLE FOR ALL COSTS AND LIABILITY IN CONNECTION THEREWITH.
- THE CONTRACTOR SHALL TAKE ALL PRECAUTIONARY MEASURES NECESSARY TO PROTECT EXISTING UTILITY LINES, STRUCTURES, AND STREET IMPROVEMENTS WHICH ARE TO REMAIN IN PLACE, FROM DAMAGE, AND ALL SUCH IMPROVEMENTS OR STRUCTURES DAMAGED BY THE CONTRACTOR'S OPERATIONS SHALL BE REPAIRED OR REPLACED SATISFACTORY TO THE CITY ENGINEER OR OWNING UTILITY COMPANY AT THE EXPENSE OF THE CONTRACTOR.
- ALL CONSTRUCTION SHALL BE AS SHOWN ON THESE PLANS, ANY REVISIONS SHALL HAVE THE PRIOR WRITTEN APPROVAL OF THE CITY ENGINEER.
- TYPE V CEMENT SHALL BE USED IN ALL OFF-SITE CONCRETE WORK. CONCRETE TO BE 3000 P.S.I. MINIMUM @ 28 DAYS. MIX DESIGN TO BE APPROVED BY THE QUALITY CONTROL DIVISION PRIOR TO USE ON THE PROJECT.
- PERMITS ARE REQUIRED FOR ANY WORK IN THE PUBLIC RIGHT-OF-WAY. THE CONTRACTOR SHALL SECURE ALL PERMITS AND INSPECTIONS REQUIRED FOR THIS CONSTRUCTION.
- EXPANSION JOINTS REQUIRED, MAXIMUM EVERY 150' IN EXTRUDED TYPE CURB.
- AC PAVEMENT TO BE 1/2" ABOVE LIP OF ALL GUTTERS AFTER COMPACTION, EXCEPT AT SIDEWALK RAMPS.
- APPLY FOG SEAL ONLY AFTER ALL CORRECTIONS AND ADJUSTMENTS HAVE BEEN MADE.
- CURB & GUTTER WITH A GRADE OF LESS THAN FIVE TENTHS OF ONE PERCENT SHALL BE WATER TESTED AS SOON AS POSSIBLE AFTER CONSTRUCTION. ANY CURB AND GUTTER FOUND TO BE UNACCEPTABLE TO THE CITY SHALL BE REMOVED AND REPLACED AT THE EXPENSE OF THE CONTRACTOR.
- SIDEWALK RAMPS SHALL BE CONSTRUCTED AS SHOWN ON PLANS PER SUMMERLIN STD. DRAWING NO. S-75. EXACT LOCATION OF RAMPS MAY BE ADJUSTED IN THE FIELD BY A CITY INSPECTOR.
- CONTRACTOR SHALL PROVIDE ALL NECESSARY HORIZONTAL AND VERTICAL TRANSITIONS BETWEEN NEW CONSTRUCTION AND EXISTING SURFACES TO PROVIDE PROPER DRAINAGE AND ACCESS TO NEW CONSTRUCTION. THE EXTENT OF TRANSITIONS TO BE AS SHOWN ON PLANS, OR AS DESIGNATED IN THE FIELD BY A CITY INSPECTOR.
- SOILS REPORT(S) PREPARED FOR THIS PROJECT ARE AVAILABLE FOR CONTRACTOR'S REVIEW AS DESCRIBED IN PARAGRAPH 1.4.2 OF THE CONSTRUCTION AGREEMENT.
- EXACT LOCATION OF ALL SAWCUT LINES MAY BE DETERMINED IN THE FIELD BY A CITY OF LAS VEGAS INSPECTOR IF LOCATION ON PLANS IS NOT CLEARLY SHOWN, OR EXISTING PAVEMENT CONDITION REQUIRES RELOCATION.
- THE CONTRACTOR SHALL TAKE ALL PRECAUTIONS NECESSARY TO PROTECT EXISTING PERMANENT SURVEY MONUMENTS. ANY MONUMENTS DISTURBED SHALL BE REPLACED AND ADJUSTED PER AVAILABLE RECORDS IN ACCORD. WITH N.R.S. STATUTE NO. 625.550.
- UTILITY COMPANY METER BOXES, MANHOLE LIDS, VALVE COVERS, ETC. SHALL BE LOCATED OUT OF DRIVEWAYS, DRIVEWAY APRONS, FLOWLINES, AND CROSS GUTTERS UNLESS WRITTEN APPROVAL IS GRANTED BY THE UTILITY COMPANY AND THE CITY ENGINEER.
- WALL NOTES:  
A. ALL WALLS, NEW OR EXISTING, ARE ONLY SHOWN FOR THE PURPOSE OF GRADING RELATIONSHIPS.  
B. THE STRUCTURAL AND ARCHITECTURAL DESIGN OF ALL WALLS (RETAINING OR NON-RETAINING) MUST BE APPROVED BY THE CLV BUILDING DEPARTMENT.
- ASPHALT MIX DESIGN MUST BE SUBMITTED AND APPROVED BY THE CITY ENGINEER PRIOR TO THE PLACEMENT OF ASPHALT ON CITY STREETS.
- 48 HOURS PRIOR TO THE START OF CONSTRUCTION, THE CONTRACTOR SHALL CONTACT:  
LAS VEGAS VALLEY WATER DISTRICT PHONE 870-2011  
NEVADA POWER COMPANY PHONE 1-800-227-2600  
SPRINT - CENTRAL TELEPHONE COMPANY PHONE 1-800-227-2600  
SOUTHWEST GAS CORPORATION PHONE 365-2206  
KERN RIVER GAS PHONE 801-584-6762
- CONTRACTOR TO SECURE AN ENCROACHMENT PERMIT FROM KERN RIVER GAS PRIOR TO COMMENCING WORK WITHIN THE LIMITS OF THE EXISTING KERN RIVER GAS LINE EASEMENT.
- CONTRACTOR TO VERIFY MAIN LINE AND SERVICE LATERAL CROSSINGS PRIOR TO INSTALLATION OF UTILITIES.
- ALL EXISTING UTILITY CROSSINGS MUST BE VERIFIED PRIOR TO CONSTRUCTION OF ANY MAIN LINES OR LATERALS THAT MAY BE ADVERSELY EFFECTED. ANY DISCREPANCIES IN LOCATION AND/OR ELEVATION MUST BE PROVIDED TO THE ENGINEER FOR ACCEPTANCE PRIOR TO CONSTRUCTION.
- SEE SHEET 7 FOR WATER NOTES, FIRE DEPARTMENT NOTES AND WATER QUANTITIES. SEE SHEET 9 FOR SEWER NOTES AND SEWER QUANTITIES. SEE SHEET 9 FOR STORM DRAIN QUANTITIES.

**DEVIATIONS**

THE PROPOSED STREET LIGHT LOCATIONS ARE A DEVIATION FROM THE SUMMERLIN IMPROVEMENT STANDARDS E-1 AND RELATED STANDARDS. THESE STANDARDS REQUIRE STREET LIGHTS TO BE LOCATED IN MEDIAN ISLANDS OF VILLAGE ARTERIALS (95-FOOT WIDE). IN ACCORDANCE WITH THE APPROVED TRAFFIC STUDY AND NDOT REQUIREMENTS, CHARLESTON BOULEVARD ACCOMMODATES DUAL LEFT TURN CAPACITY AND WIDE TRAVEL LANES. THE RESULTANT ARTERIAL WIDTH IS 121.34 FEET. TO PROVIDE ADEQUATE LIGHTING, THE LOCATIONS PROPOSED IN THESE DRAWINGS ARE LOCATED DOWN BOTH SIDES OF THE ROADWAY.

**BENCHMARK**

B.M. No.	DESCRIPTION	NAVD88 DATUM	SUMMERLIN DATUM
0LV09-36SES	C.L.V. RIVET & PLATE IN TOP OF CURB, NE RETURN OF CHARLESTON BLVD. & HUAPALAI WAY	2912.23 FEET 887.650 MTRS	2910.05 FEET 886.985 MTRS

**NOTE**

THIS SET OF DRAWINGS IS BASED ON NAVD 88 DATUM. PREVIOUS DRAWINGS MAY BE BASED ON SUMMERLIN DATUM. CARE SHOULD BE OBSERVED WHEN UTILIZING THIS SET OF DRAWINGS.

Avoid cutting underground utility lines.  
**Call before you Dig.**  
1-800-227-2600  
INTEGRATING SERVICE ALERT (ISA)



**LEGEND & ABBREVIATION**

**EMBANKMENT**  
TOP: YYY PROPOSED  
BOTTOM: YYY BY SEPARATE CONTRACT  
YYY EXISTING

**ABBREVIATION**  
I = IMPROVEMENTS  
W = WATER  
S = SEWER OR SUMMERLIN IMPROVEMENT STANDARDS  
SD = STORM DRAIN  
SL = STREET LIGHTING  
SIG = TRAFFIC SIGNAL  
SMH = SEWER MANHOLE  
SDMH = STORM DRAIN MANHOLE  
CC = CLARK COUNTY  
CLV = CITY OF LAS VEGAS  
LVVWD = LAS VEGAS VALLEY WATER DISTRICT  
NDOT = NEVADA DEPT. OF TRANSPORTATION  
TR = STREET LIGHT TRENCH (SEE ELECTRICAL PLANS)  
DG = DESIGN GRADE  
TC = TOP OF CURB  
FG = FINISHED GRADE  
MOC = MIDDLE OF CURVE  
USCS = UNIFORM STANDARD DRAWINGS - CLARK COUNTY AREA (LATEST EDITION)  
DCSWCS = DESIGN AND CONSTRUCTION STANDARDS FOR WASTEWATER COLLECTION SYSTEMS  
UDACS = UNIFORM DESIGN AND CONSTRUCTION STANDARDS FOR WATER DISTRIBUTION SYSTEMS  
ISBC = ISLAND BACK OF CURB  
LS = LANDSCAPE  
AP = ANGLE POINT

1 DETAIL DRAWING NUMBER  
1-1 DETAIL DRAWING NUMBER DRAWN ON SAME SHEET  
1-7 DETAIL DRAWING NUMBER WITH REFERENCE TO THE SHEET IT IS DRAWN ON  
1 S STANDARD DRAWING NUMBER (S) PER SUMMERLIN IMPROVEMENT STANDARDS, OR PER OTHER STANDARDS AS NOTED IN ABBREVIATION TABLE  
1 I INDICATES CONSTRUCTION NOTE  
1 R INDICATES REMOVAL NOTE  
1 C INDICATES CURVE NUMBER  
1 I INDICATES SEWER MANHOLE IN PROFILE  
1 I INDICATES STORM DRAIN MANHOLE IN PROFILE  
60.5 EXIST. SPOT ELEVATION  
TC STUB & CAP PIPE  
PAVEMENT REMOVAL  
STREET LIGHT  
STREET LIGHT MAST-ARM MOUNTED ON TRAFFIC SIGNAL POLE  
POLE  
CONCRETE ENCASEMENT

NOTE: LEGEND & ABBREVIATIONS IN THE "SUMMERLIN IMPROVEMENT STANDARDS", LATEST EDITION, WILL BE UTILIZED FOR ANY LEGEND & ABBREVIATION REQUIRED WHICH ARE NOT SHOWN.

**CLV TRAFFIC NOTES**

- ALL CONSTRUCTION SIGNING, BARRICADING, AND TRAFFIC DELINEATION SHALL CONFORM TO THE "NEVADA WORK ZONE TRAFFIC CONTROL HANDBOOK", LATEST EDITION, AND TO THE "MANUAL ON UNIFORM TRAFFIC CONTROL DEVICES", LATEST EDITION.
- THE STREET SIGN CONTRACTOR SHALL OBTAIN STREET NAMES AND BLOCK NUMBERING FROM THE PLANNING DEPARTMENT PRIOR TO CONSTRUCTION.
- BEFORE ANY WORK IS STARTED IN THE RIGHT-OF-WAY, THE CONTRACTOR SHALL INSTALL ALL ADVANCE WARNING SIGNS FOR THE CONSTRUCTION ZONE. THE CONTRACTOR SHALL INSTALL TEMPORARY STOP SIGNS AT ALL NEW STREET ENCROACHMENTS INTO EXISTING CITY STREETS WHERE WARRANTED IMMEDIATELY AFTER FIRST GRADING WORK IS ACCOMPLISHED, AND SHALL MAINTAIN SAID SIGNS UNTIL PERMANENT SIGNS ARE INSTALLED.
- WHEN A DESIGNATED "SAFE ROUTE TO SCHOOL" IS ENCLOSED UPON BY A CONSTRUCTION WORK ZONE AND PUBLIC WORKS STAFF IDENTIFIES A NEED FOR STUDENTS TO BE ASSISTED IN THE SAFE CROSSING THROUGH THAT WORK ZONE, THE CONTRACTOR SHALL BE REQUIRED TO PROVIDE A QUALIFIED "CROSSING GUARD". THE GUARD SHALL BE PRESENT FOR THE FULL DURATION OF TIME THAT CHILDREN ARE LIKELY TO BE PRESENT.
- IF THE IMPROVEMENTS NECESSITATE THE OBLITERATION, TEMPORARY OBSTRUCTION, TEMPORARY REMOVAL OR RELOCATION OF ANY EXISTING TRAFFIC PAVEMENT MARKING, SUCH PAVEMENT MARKING SHALL BE RESTORED OR REPLACED WITH LIKE MATERIALS TO THE SATISFACTION OF THE CITY TRAFFIC ENGINEER.
- THE CONTRACTOR SHALL BE RESPONSIBLE FOR PROVIDING AND INSTALLING ALL PERMANENT SIGNS SHOWN ON THE PLANS. STREET NAME SIGNS SHALL CONFORM IN THEIR ENTIRETY TO CURRENT CITY STANDARDS. ALL OTHER SIGNS SHALL BE STANDARD SIZE UNLESS OTHERWISE SPECIFIED ON THE PLANS. ALL SIGN POSTS SHALL BE INSTALLED IN ACCORDANCE WITH THE CURRENT CITY STANDARDS.
- WHEN A PROPOSED STREET LIGHT STANDARD IS LOCATED WITHIN FIVE (5') FEET OF ANY PROPOSED SIGN SHOWN ON THE PLANS TO BE MOUNTED ON A SIGNPOST, THE SIGN SHALL BE MOUNTED ON THE STREET LIGHT STANDARD AND THE SIGNPOST SHALL BE ELIMINATED.
- ALL PERMANENT TRAFFIC CONTROL DEVICES CALLED FOR HEREON SHALL BE IN PLACE AND IN FINAL POSITION PRIOR TO ALLOWING ANY PUBLIC TRAFFIC ONTO THE PORTIONS OF THE ROAD(S) BEING IMPROVED HEREUNDER, REGARDLESS OF THE STATUS OF COMPLETION OF PAVING OR OTHER OFF-SITE IMPROVEMENTS CALLED FOR BY THESE PLANS.
- STREET SIGNS AND STOP SIGNS SHALL BE INSTALLED PER CITY STANDARD SPECIFICATIONS FOR PLACEMENT OF STREET NAME SIGNS.
- THE CONTRACTOR SHALL PROVIDE BARRICADES, SIGNS, FLASHERS, OTHER EQUIPMENT AND FLAG PERSONS NECESSARY TO INSURE THE SAFETY OF WORKERS AND VISITORS.
- WORK IN PUBLIC STREETS, ONCE BEGUN, SHALL BE EXPEDITED TO COMPLETION SO AS TO PROVIDE MINIMUM INCONVENIENCE TO ADJACENT PROPERTY OWNERS AND TO THE TRAVELING PUBLIC.
- THE CONTRACTOR SHALL BE RESPONSIBLE FOR NOTIFYING CITIZENS AREA TRANSIT (C.A.T.) IF THE CONSTRUCTION INTERRUPTS OR RELOCATES A BUS STOP OR HAS AN ADVERSE EFFECT ON THAT STREET TO ARRANGE FOR TEMPORARY RELOCATION OF STOP.
- GUARDS SHALL BE OBTAINED BY CONTACTING THE METROPOLITAN POLICE DEPARTMENT SPECIAL EVENTS UNIT (PHONE NO. IS 229-3442) WHO WILL PROVIDE OFFICERS PROPERLY TRAINED IN TRAFFIC CONTROL. FEES FOR THE USE OF THESE OFFICERS SHALL BE SET UP BY METRO AND WILL BE PAID BY THE CONTRACTOR. THE CONTRACTOR IS RESPONSIBLE FOR ALL ARRANGEMENTS WITH METRO.

ENGINEER \_\_\_\_\_ DATE \_\_\_\_\_

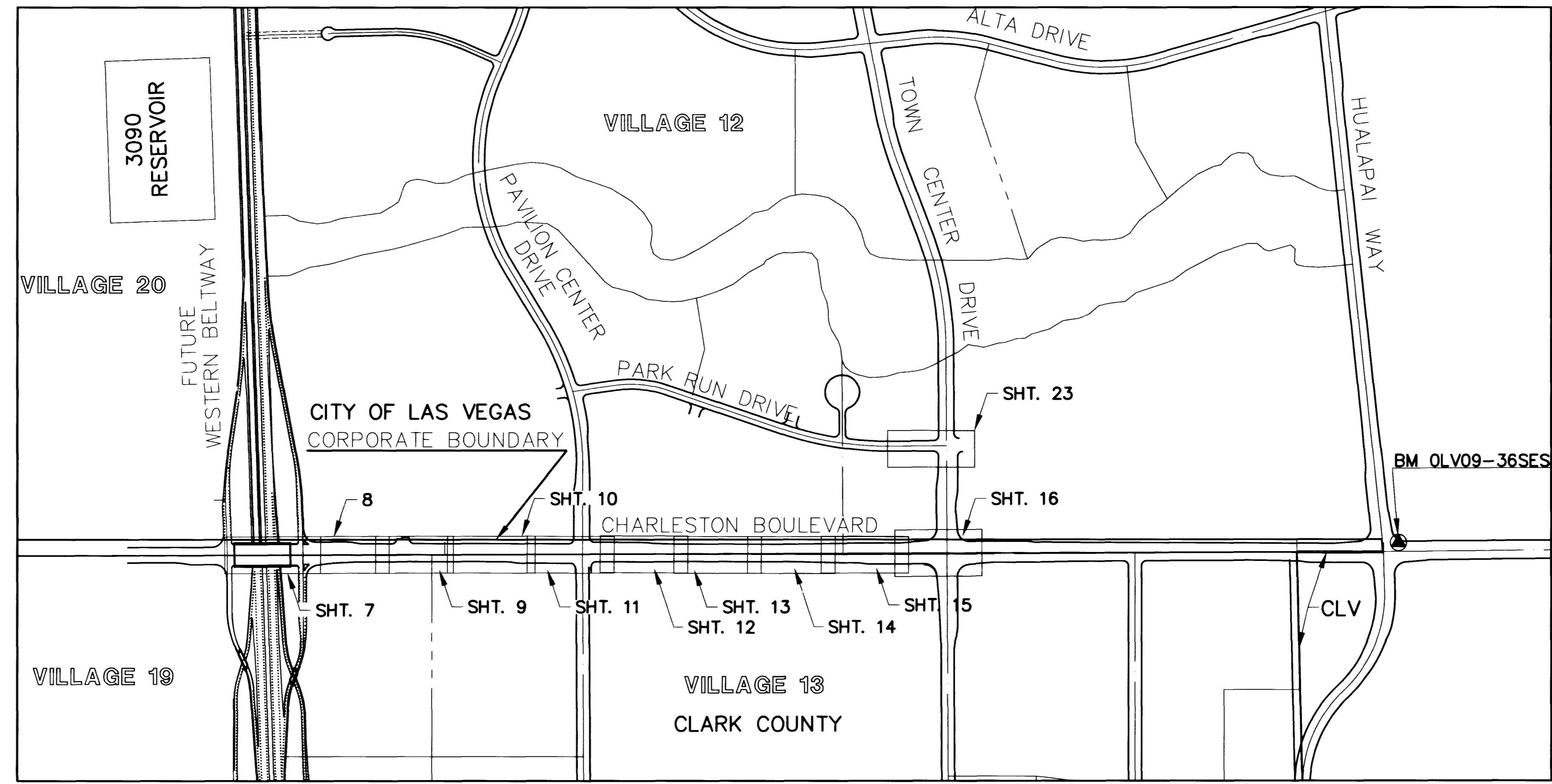

**SHEET INDEX MAP**

**BASIS OF BEARINGS**

NORTH 00'18'07" WEST, BEING THE BEARING OF THE CENTERLINE OF TOWN CENTER DRIVE, SHOWN BY MAP THEREOF ON FILE IN BOOK 74, PAGE 56 OF PLATS IN THE CLARK COUNTY RECORDER'S OFFICE, CLARK COUNTY, NEVADA.

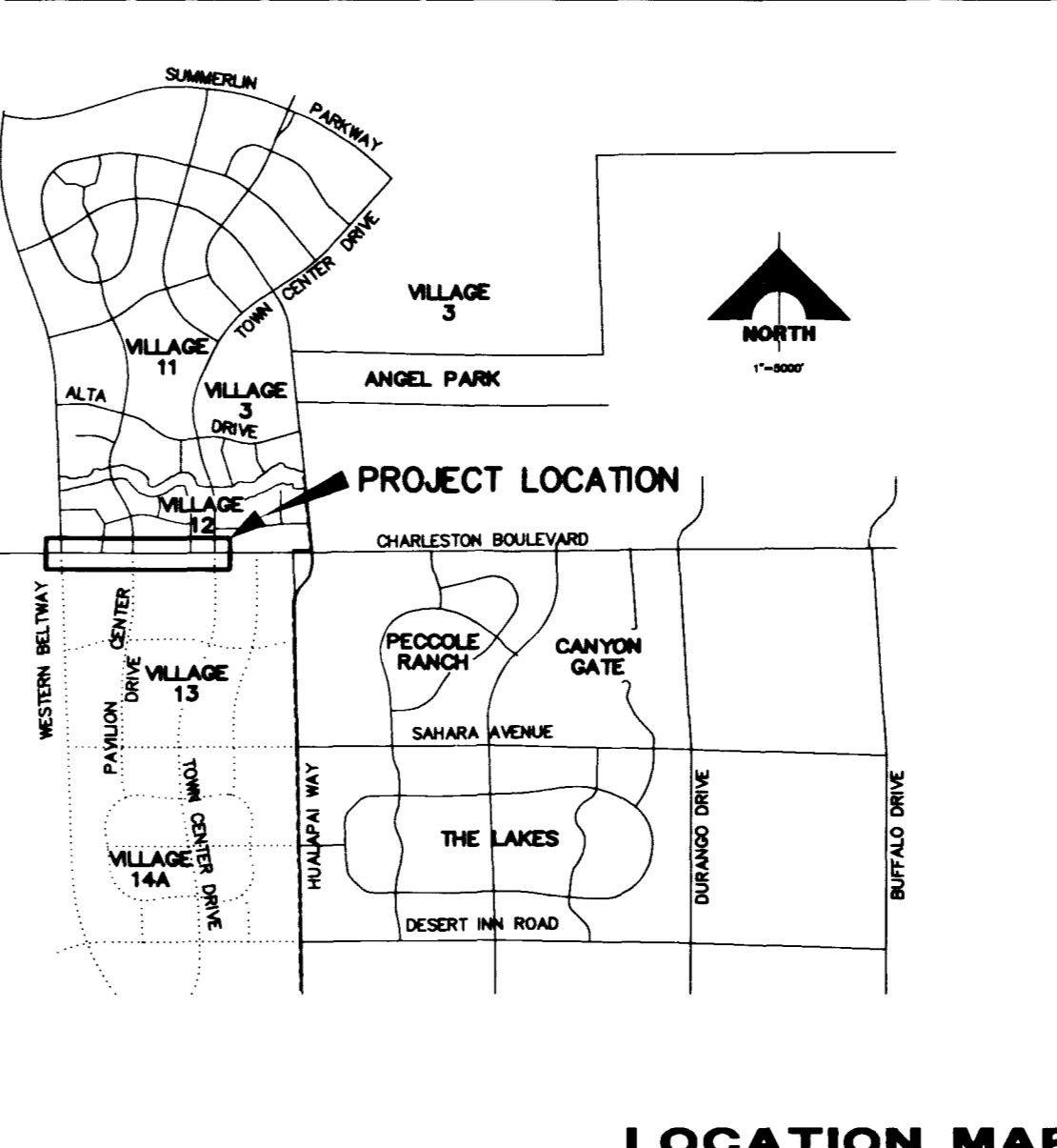

**LOCATION MAP**

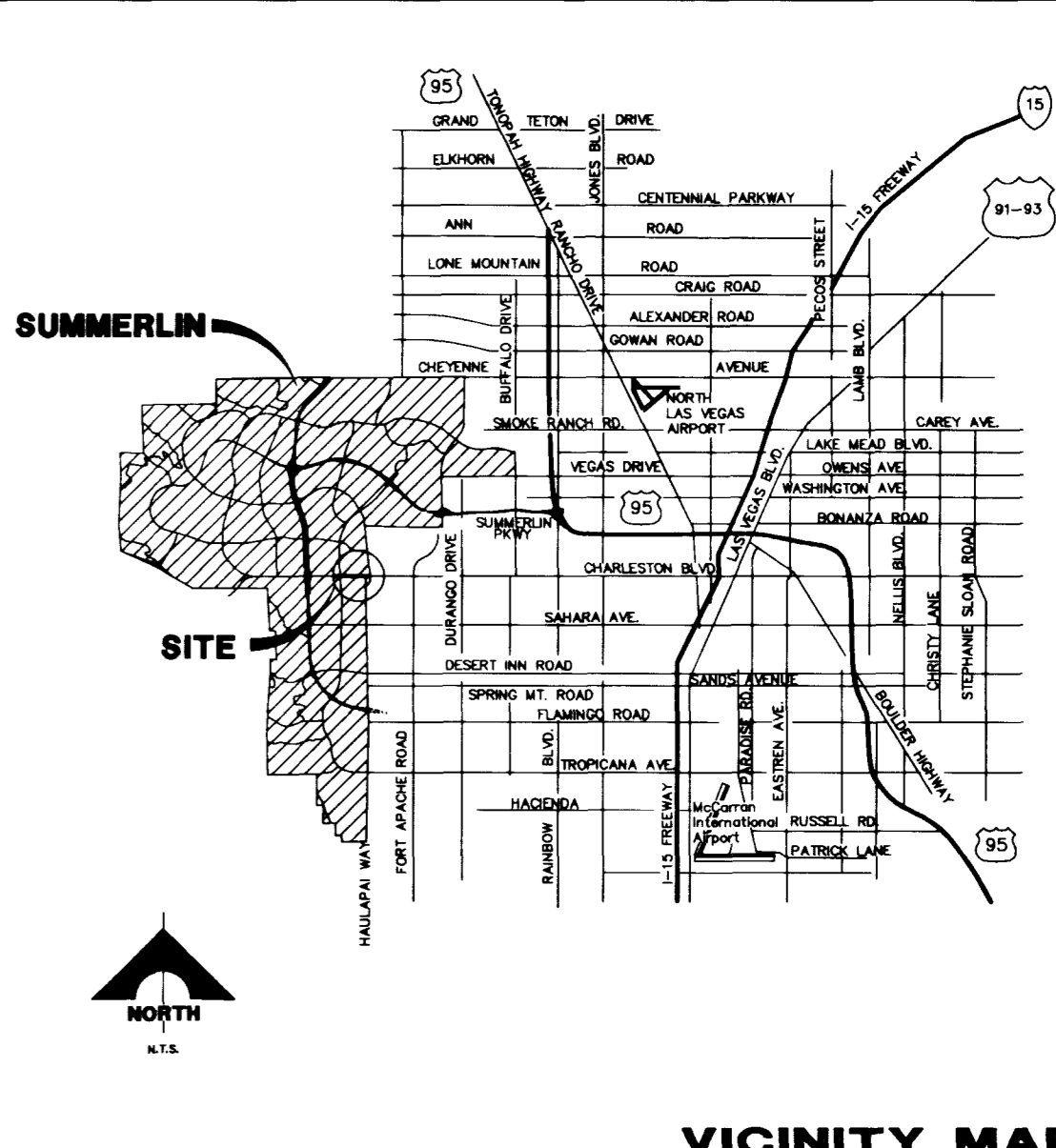

**VICINITY MAP**

**INDEX OF DRAWINGS**

- COVER SHEET
- PROJECT DATA SHEET
- HORIZONTAL CONTROL PLAN STA. 846+14.03 TO 885+96.11
- MASTER SEWER PLAN
- MASTER STORM DRAIN PLAN
- MASTER WATER PLAN
- PLAN & PROFILE STA. 842+52.00 TO 846+50.00
- PLAN & PROFILE STA. 846+50.00 TO 851+50.00
- PLAN & PROFILE STA. 851+50.00 TO 856+50.00
- PLAN & PROFILE STA. 856+50.00 TO 861+50.00
- PLAN & PROFILE STA. 861+50.00 TO 866+50.00
- PLAN & PROFILE STA. 866+50.00 TO 870+50.00
- PLAN & PROFILE STA. 870+50.00 TO 874+50.00
- PLAN & PROFILE STA. 874+50.00 TO 879+50.00
- PLAN & PROFILE STA. 879+50.00 TO 884+50.00
- PLAN & PROFILE STA. 884+50.00 TO 885+96.11
- TYPICAL STREET SECTIONS
- MISCELLANEOUS DETAILS
- SIGNAGE AND STRIPING PLAN 1 STA. 842+52.00 TO 867+34.00
- SIGNAGE AND STRIPING PLAN 2 STA. 867+34.00 TO 882+80.23
- UTILITY LATERAL PROFILES - 1
- UTILITY LATERAL PROFILES - 2
- UTILITY LATERAL PROFILES - 3 AND STORM DRAIN DETAILS
- E-1 ELECTRICAL PLAN
- E-2 ELECTRICAL PLAN

**DRAINAGE CERTIFICATION**

I CERTIFY THAT THIS PLAN IS IN CONFORMANCE WITH THE APPROVED DRAINAGE STUDY FOR THIS SITE ON FILE AT THE CLARK COUNTY PUBLIC WORKS DEPARTMENT, AND THE CITY OF LAS VEGAS.

*Bert A. Hughes*  
BERT A. HUGHES 9/11/98 DATE

**APPROVALS**

CLARK COUNTY	PUBLIC WORKS DIRECTOR	DATE
CITY OF LAS VEGAS		
<i>Charles Karkowski</i>	CHARLES KARKOWSKI, PE #1784 CITY PLANNING ENGINEER CITY OF LAS VEGAS, NEVADA	12-3-98 DATE
<i>Gerald M. Robbins</i>	GERALD M. ROBBINS SUMMERLIN DESIGN REVIEW COMMITTEE	9/23/98 DATE
<i>L.V. Valley Water District</i>	L.V. VALLEY WATER DISTRICT	11/11/98 DATE
<i>Nevada Power Company</i>	NEVADA POWER COMPANY	9-22-98 DATE
<i>Sprint Central Telephone - Nevada</i>	SPRINT CENTRAL TELEPHONE - NEVADA	9-21-98 DATE
<i>Southwest Gas Corporation</i>	SOUTHWEST GAS CORPORATION	9/21/98 DATE
<i>City Fire Marshall</i>	CITY FIRE MARSHALL	11/5/98 DATE

RECOMMENDED  
BERT A. HUGHES  
REGISTERED PROFESSIONAL ENGINEER  
STATE OF NEVADA  
CIVIL  
11988  
P.E. NO. 10259

G.C. WALLACE, INC.  
Engineering/Architecture  
SUMMERLIN DIVISION (702) 363-1200

SUMMERLIN  
CHARLESTON BOULEVARD  
PAVILION CENTER DRIVE TO TOWN CENTER DRIVE  
PROJECT DATA SHEET  
STA. 846+14.03 TO 892+90.00

SHEET  
**2**  
SHT 2 OF 25

JOB NO. 62012.224

107-V2818

