

SEE SHEET 4 OF FOR CONTINUATION

VILLAGE 8 - FUTURE SUMMERLIN (UNDER CONSTRUCTION) MEDICAL CENTER

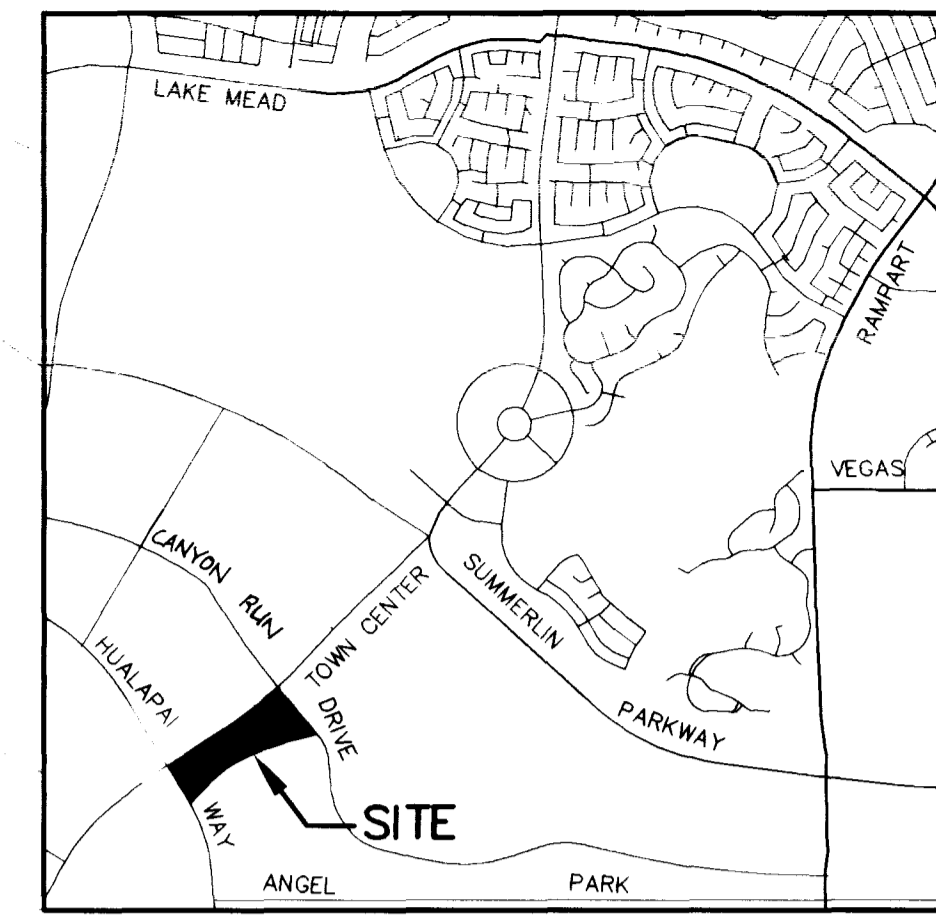

LOCATION MAP

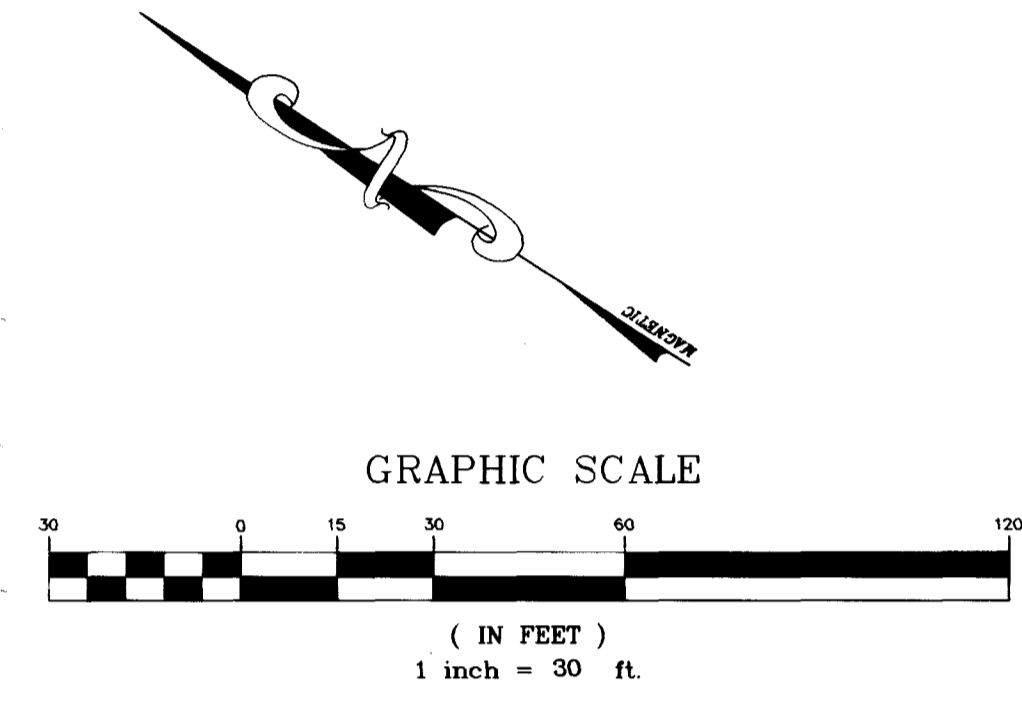

BASIS OF BEARINGS

SOUTH 87°00'00" EAST, BEING THE CENTERLINE OF TRAIL HOLLOW DRIVE AT THE INTERSECTION WITH TRAIL WOOD DRIVE, AS SHOWN ON THAT CERTAIN MAP ON FILE IN THE OFFICE OF THE CLARK COUNTY RECORDER, CLARK COUNTY, NEVADA, IN BOOK 63 OF PLATS AT PAGE 79.

BENCHMARK

CONTROL POINT "SPANKY" - A BRASS CAP SET IN CONCRETE STAMPED "#42". SET BY G.C. WALLACE ENGINEERING AND USED AS A BENCHMARK FOR SUMMERLIN CONSTRUCTION. ELEVATION = 2825.38 (SUMMERLIN DATUM) = PROTECT DATUM-1 ELEVATION EQUATION : SUMMERLIN ELEV. - 0.217 = NGVD'29 ELEV. ELEVATION EQUATION : NGVD ELEV. + 2.437 = NAVD'88 ELEV.

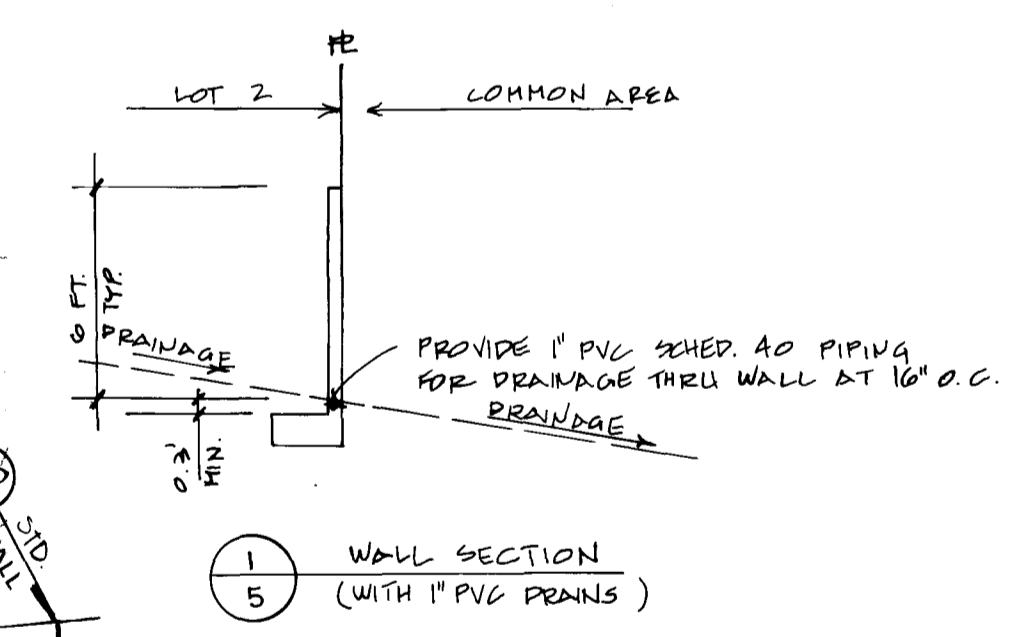

ALL ONSITE ACCESS DRIVES ARE PRIVATELY OWNED AND MAINTAINED

Call before you Dig 1-800-227-2600

GRADING PLAN IS IN CONFORMANCE TO THE ACCEPTED DRAINAGE STUDY

I CERTIFY THAT THIS GRADING PLAN IS IN CONFORMANCE WITH THE APPROVED DRAINAGE STUDY ON FILE AT THE CITY OF LAS VEGAS FOR THIS PROJECT.

WESTMARK HOMES CITY OF LAS VEGAS CONSULTING ENGINEERS • PLANNERS • LAND SURVEYORS 2727 SOUTH RAINBOW BOULEVARD LAS VEGAS, NEVADA 89102-5148 PHONE (702) 873-7550 FAX (702) 362-2597

GRADING PLAN CANYON RIDGE SUMMERLIN VILLAGE 3

Professional seal and signature area with date 4-30-99.

Project details: NO. 4914 BY JTG DATE 12-7-95 SCALE HORIZ. 1\"/>

RS 8562

11-32-54

107Y-4465

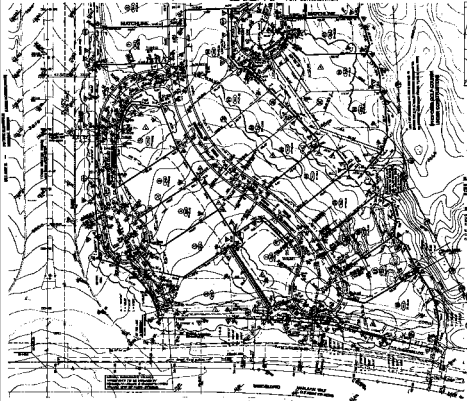

NAME OF ENGINEER
 STATE OF CALIFORNIA
 LICENSE NO. 11,801

ENGINEER
 JOHN W. WILSON, CIVIL ENGINEER
 1000 S. GATE AVENUE, PASADENA, CALIF. 91106
 LICENSE NO. 11,801



REPRODUCED FROM THE RECORDS OF THE CITY OF PASADENA

DATE: 11-12-57	PROJECT: CANYON RIDGE
DRAWN BY: [Name]	CITY OF PASADENA
CHECKED BY: [Name]	PLANNING DEPARTMENT
APPROVED BY: [Name]	1000 S. GATE AVENUE, PASADENA, CALIF. 91106

GRADING PLAN
CANYON RIDGE
 SUBMITTAL VOLUME 2

5 - 3