

CITY OF LAS VEGAS SEWER NOTES

- ALL CONSTRUCTION AND MATERIALS SHALL BE IN ACCORDANCE WITH THE LATEST EDITION OF THE DESIGN & CONSTRUCTION STANDARDS FOR WASTEWATER COLLECTION SYSTEMS AND THE UNIFORM STANDARD SPECIFICATIONS FOR PUBLIC WORKS' CONSTRUCTION OFF-SITE IMPROVEMENTS, CLARK COUNTY AREA, NEVADA, AS AMENDED. IN ALL CASES, THESE STANDARDS SHALL SUPERSEDE THE UNIFORM STANDARD SPECIFICATIONS. IT WILL BE THE RESPONSIBILITY OF THE CONTRACTOR TO BE AWARE OF THE CONTENTS OF THE ABOVE SPECIFICATION BOOKS.
- IT SHALL BE THE CONTRACTOR'S RESPONSIBILITY TO PERFORM CONSTRUCTION AS PER PLANS. ANY ADDITIONS, DELETIONS, OR CHANGES SHALL FIRST MEET WITH THE APPROVAL OF THE CONTROLLING AGENCY.
- CHISEL "S" OR "G" IN CURBS WHERE SEWER OR GAS LATERALS PASS UNDER THE CURB.
- POLYVINYL (PVC) SEWER PIPE SHALL MEET ASTM D-3034 SDR 35 SPECIFICATIONS, INSTALLED WITH SAND BEDDING AND BACKFILL OF TYPE II GRAVEL.
- ALL MANHOLES IN PAVED STREETS 80' R/W AND LARGER, SHALL HAVE CONCRETE COLLARS.
- TEE SADDLES SHALL BE USED TO CONNECT SEWER LATERALS TO EXISTING MAIN LINES UP TO 12" DIA. SIZE. CONNECTIONS TO 15" OR LARGER MAINS SHALL REQUIRE SPECIAL PROCEDURES.
- A SEWER MAIN CROSSING OVER A WATER MAIN OR LESS THAN 18" UNDER A WATER MAIN, MUST BE REINFORCED CONCRETE ENCASED FOR A DISTANCE NOT LESS THAN TEN FEET (10') TO EACH SIDE OF THE CENTERLINE OF THE WATER MAIN.
- ALL CONTRACTORS INSTALLING SEWER MAINS THAT WILL BE UNDER THE JURISDICTION OF THE CONTROLLING AGENCY MUST BE CLASS "A" CONTRACTORS.
- THE CITY OF LAS VEGAS WILL NOT ACCEPT ANY SEWER MAINS WHICH HAVE A VERTICAL DEFLECTION OF MORE THAN ONE-TENTH (0.1) OF A FOOT FROM APPROVED CONSTRUCTION PLANS. SEWER MAINS FOUND TO EXCEED THIS TOLERANCE WILL HAVE TO BE REPAIRED OR REMOVED AND REPLACED TO THE SATISFACTION OF THE CITY ENGINEER PRIOR TO ACCEPTANCE BY THE CITY.

REVISED OCT. 2, 1991

SEWER CONNECTION NOTE:

ONE OR MORE SEGMENTS OF THE DOWNSTREAM SEWER SYSTEM THAT WILL SERVE THIS PROJECT HAS NOT BEEN COMPLETED AND/OR ACCEPTED FOR MAINTENANCE BY THE CITY OF LAS VEGAS. ANY WORK DONE ON THIS PROJECT PRIOR TO THE COMPLETION AND/OR ACCEPTANCE OF THE DOWNSTREAM SEWER SYSTEM(S) SHALL BE DONE AT THE DEVELOPER'S OWN RISK. THE CITY OF LAS VEGAS RESERVES THE RIGHT TO PREVENT THE PHYSICAL CONNECTION OF THIS PROJECT INTO THE DOWNSTREAM SEWER SYSTEM UNTIL ALL SEGMENTS HAVE BEEN COMPLETED AND ACCEPTED FOR MAINTENANCE, OR UNTIL SUCH TIME AS THEY ARE DEEMED AVAILABLE FOR SERVICE.

SEWER NOTE:

ALL SEWER SHOWN IS PUBLIC AND IS TO BE MAINTAINED BY THE CITY OF LAS VEGAS.

STREET LIGHT NOTES

ALL STREET LIGHT INSTALLATIONS SHALL CONFORM TO THE STANDARD DETAILS AND SPECIFICATIONS OF THE SUMNERLIM IMPROVEMENT STANDARDS.

CITY OF LAS VEGAS FIRE NOTES

- ALL WORK SHALL BE DONE IN STRICT ACCORDANCE WITH THE CITY OF LAS VEGAS FIRE DEPARTMENT "HYDRANT SPECIFICATIONS", "HYDRANT INSTALLATION SPECIFICATIONS" AND ORDINANCE #3944.
- AUTHORIZED HYDRANTS FOR THIS PROJECT ARE:
 - KENNEDY GUARDIAN
 - MUELLER A-423 CENTURION
 - CLOW MODEL 2546 MEDALLION
- ON ANY NEW HOME OR BUILDING INSTALLATION, ACCESSIBLE FIRE HYDRANTS SHALL BE INSTALLED BEFORE COMBUSTIBLE CONSTRUCTION COMMENCES AND SAID FIRE HYDRANTS SHALL BE IN GOOD WORKING ORDER WITH AN ADEQUATE WATER SUPPLY.
- CONTRACTOR SHALL PLACE A BLUE REFLECTIVE MARKER AT CENTER LIEN OF STREET ADJACENT TO FIRE HYDRANT AS REQUIRED IN ORDINANCE #3944 TO IDENTIFY THE FIRE HYDRANT LOCATIONS.
- CALL THE LAS VEGAS FIRE DEPARTMENT AT 229-2071 FOR UNDERGROUND INSPECTION, PRESSURE AND FLUSH VERIFICATION OF ALL FIRE HYDRANTS AND FIRE LINES BEFORE COVERING.
- PAINTING OF THE CURBS AND HYDRANTS AND ANY WORK NECESSARY FOR PROTECTION OF HYDRANTS FROM PHYSICAL DAMAGE PER ORDINANCE #3944 SHALL BE COMPLETED BEFORE APPROVAL BY THE CITY OF LAS VEGAS FIRE DEPARTMENT.
- A PERMIT IS REQUIRED FROM THE FIRE DEPARTMENT FOR ON-SITE WATER LINE AND FIRE HYDRANT. THE PERMIT AND CONTRACTOR'S MATERIAL AND TEST CERTIFICATE FOR UNDERGROUND PIPING FORM SHALL BE OBTAINED FROM THE FIRE PROTECTION ENGINEER PRIOR TO ANY WORK BEGINNING.
- PRIVATE FIRE HYDRANTS SHALL BE PAINTED RED.
- A FLOW TEST MUST BE WITNESSED BY THE FIRE DEPARTMENT PRIOR TO OCCUPANCY FOR VERIFICATION OF REQUIRED ON-SITE WATER SUPPLY.
- ALL O-SITE FIRE MAIN MATERIALS MUST BE U.L. LISTED AND A.W.W.A. APPROVED.
- FIRE HYDRANT SPACING:
 - RESIDENTIAL - 50 FEET UNSPRINKLERED, 1,000 FEET SPRINKLERED.
 - COMMERCIAL, INCLUDING MULTI-FAMILY - 300 FEET UNSPRINKLERED, 600 FEET SPRINKLERED.
- WHERE NEW WATER MAINS ARE EXTENDED ALONG STREETS, WHERE HYDRANTS ARE NOT NEEDED FOR PROTECTION OF STRUCTURES, FIRE HYDRANTS SHALL BE SPACED AT MAXIMUM 1,000 FOOT SPACING TO PROVIDE FOR TRANSPORTATION HAZARDS.
- NO FIRE HYDRANT SHALL BE LOCATED WITHIN THE REQUIRED RADIUS OF A CUL-DE-SAC OR WITHIN 20 FEET OF THE PERIMETER OF THE RADIUS OF THE CUL-DE-SAC.
- NO FIRE HYDRANT SHALL BE LOCATED WITH 6 FEET OF ANY CURB RETURN, DRIVEWAY, POWER POLE, STREET LIGHT OR ANY OTHER OBSTRUCTION.
- TWO SOURCES OF SUPPLY ARE REQUIRED WHENEVER THERE ARE 4 OR MORE FIRE HYDRANTS INSTALLED ON A SINGLE SYSTEM.
- NOT MORE THAN 2 HYDRANTS CAN BE OUT OF SERVICE DUE TO A SINGLE MAIN BREAK.
- FIRE APPARATUS ACCESS ROADS SHALL HAVE AN UNOBSTRUCTED WIDTH OF NOT LESS THAN 20 FEET PROVIDED NO PARKING IS ALLOWED, NOT LESS THAN 28 FEET IF PARALLEL PARKING IS ALLOWED ON ONE SIDE, AND NOT LESS THAN 36 FEET IF PARALLEL PARKING IS ALLOWED ON BOTH SIDES. Vertical clearance shall be not less than 13 feet 6 inches.
- THE TURNING RADIUS FOR ANY FIRE APPARATUS ACCESS ROAD AND/OR FIRE LANE, PUBLIC OR PRIVATE SHALL BE NOT LESS THAN 45 FEET OUTSIDE RADIUS AND 22 FEET INSIDE RADIUS.
- A FIRE APPARATUS ROAD SHALL BE REQUIRED WHEN ANY PORTION OF AN EXTERIOR WALL OF THE FIRST STORY IS LOCATED MORE THAN 150 FEET FROM A FIRE DEPARTMENT VEHICLE ACCESS. (SEE EXCEPTIONS IN UFG 94, SECTION 902.2)
- ALL DEAD END FIRE APPARATUS ACCESS ROADS AND/OR FIRE LANES, PUBLIC OR PRIVATE, IN EXCESS OF 150 FEET IN LENGTH SHALL BE PROVIDED WITH AN APPROVED TURNAROUND AREA. SEE ORDINANCE #3944
- ACCESS ROADS SHALL BE MARKED BY PLACING APPROVED SIGNS AT THE START OF THE DESIGNATED FIRE LANE, ONE SIGN AT THE END OF THE FIRE LANE AND WITH SIGNS AT INTERVALS OF 100 FEET ALONG ALL DESIGNATED FIRE LANES. SIGNS TO BE PLACED ON BOTH SIDES OF AN ACCESS ROADWAY IF NEEDED TO PREVENT PARKING ON EITHER SIDE. SIGNS TO BE INSTALLED NO HIGHER THAN 10 FEET OR LESS THAN 6 FEET FROM ROADWAY LEVEL. THE CURBS ALONG OR ON THE PAVEMENT OR CEMENT IF CURB IS NOT PRESENT, SHALL BE PAINTED WITH A RED WEATHER RESISTANT PAINT IN ADDITION TO THE SIGNS.
- ELECTRICALLY CONTROLLED ACCESS GATES SHALL BE PROVIDED WITH AN APPROVED EMERGENCY VEHICLE DETECTOR/RECEIVER SYSTEM. SAID SYSTEM SHALL BE INSTALLED IN ACCORDANCE WITH THE CITY OF LAS VEGAS GUIDELINES FOR AUTOMATIC EMERGENCY VEHICLE ACCESS GATES.

LAS VEGAS VALLEY WATER DIST. NOTES

- NO WORK SHALL BEGIN UNTIL THE WATER PLANS HAVE BEEN RELEASED FOR CONSTRUCTION BY THE LVVWD. FOLLOWING WATER PLAN APPROVAL, 48 HOUR NOTICE SHALL BE GIVEN TO THE LVVWD COMMUNICATION SUPPORT CENTER (258-7171) PRIOR TO THE START OF CONSTRUCTION. NOTICE MUST BE GIVEN BY 2:00 P.M. THE BUSINESS DAY PRIOR TO A LVVWD INSPECTION.
- ALL WORK SHALL CONFORM TO THE LVVWD'S STANDARD PLATES, DRAWINGS, AND SPECIFICATIONS AND THE UNIFORM DESIGN AND CONSTRUCTION STANDARDS FOR WATER DISTRIBUTION SYSTEMS (UDACS), LATEST EDITION.
- ALL WORK, EXCEPT AS MODIFIED BY THESE PLANS OR BY NOTE 2, SHALL BE DONE IN ACCORDANCE WITH THE MOST CURRENT DRAFT OR EDITION OF THE UNIFORM STANDARD SPECIFICATIONS FOR PUBLIC WORKS' CONSTRUCTION OFFSITE IMPROVEMENT, CLARK COUNTY AREA.
- A SINGLE PIPE MATERIAL SHALL BE USED THROUGHOUT THE PROJECT UNLESS OTHERWISE APPROVED BY THE LVVWD.
- ALL SERVICE LATERALS TWO (2) INCHES IN DIAMETER AND SMALLER SHALL BE COPPER TUBING WITH LVVWD APPROVED SERVICE SADDLES.
- ALL WATER METER BOXES SHALL BE LOCATED OUTSIDE OF DRIVEWAY AREAS.
- VALVES SHALL BE LOCATED OUTSIDE OF DRIVEWAYS, VALLEY AND CURB GUTTERS.
- THE FOLLOWING REQUIREMENTS MUST BE MET IN THE EVENT A WATER LINE AND SANITARY OR STORM SEWER LINE CROSS:
 - A MINIMUM EIGHTEEN (18) INCH VERTICAL SEPARATION (OUTSIDE TO OUTSIDE) MUST BE MAINTAINED WHEN THE WATER LINE IS INSTALLED OVER THE SANITARY OR STORM SEWER LINE. IF THE VERTICAL SEPARATION CANNOT BE MAINTAINED OR THE WATER LINE MUST BE PLACED UNDER THE SANITARY OR STORM SEWER LINE, THE SANITARY OR STORM SEWER LINE MUST BE CONSTRUCTED WITH ONE OF THE FOLLOWING OR, AS SHOWN ON THESE PLANS:
 - POTABLE WATER SUPPLY QUALITY MATERIAL.
 - ENCASEMENT WITH FOUR (4) INCH CONCRETE (MINIMUM)
 - SLEEVING WITH POTABLE WATER SUPPLY QUALITY PIPE.
- EACH PROVISION MUST EXTEND ALONG THE SANITARY OR STORM SEWER, ON EITHER SIDE OF THE MAIN, A MINIMUM 10 FOOT DISTANCE PERPENDICULAR TO THE WATER MAIN EXTERIOR.
- WARNING TAPE SHALL BE REQUIRED OVER ALL MAINS, ALL SIX (6) INCH DIAMETER AND LARGER SERVICE LATERALS, AND ANY SERVICE LATERAL NOT INSTALLED PERPENDICULAR TO THE WATER MAIN IN ACCORDANCE WITH STANDARD PLATE NO. 27.
- ALL WATER FACILITIES SHALL BE FILLED, DISINFECTED, PRESSURE TESTED, FLUSHED, FILLED AND AN ACCEPTABLE WATER SAMPLE OBTAINED, PRIOR TO CONNECTION TO THE LVVWD'S DISTRIBUTION SYSTEM.
- THE CONTRACTOR MUST OBTAIN ALL METERS TWO (2) INCHES AND SMALLER FROM LVVWD CENTRAL STORES. TELEPHONE 258-3152 FORTY-EIGHT (48) HOURS PRIOR TO PICKUP.
- CONSTRUCTION MAY INTERRUPT SERVICE WITH LVVWD APPROVAL AND PROPER NOTIFICATION, BETWEEN THE HOURS OF 10 P.M. AND 6 A.M. SUNDAY THROUGH THURSDAY. CIRCUMSTANCES MAY REQUIRE TEMPORARY SERVICE FEEDS BE INSTALLED, WITHOUT LVVWD REIMBURSEMENT. ANY TEMPORARY SERVICE FEED MUST HAVE PRIOR LVVWD APPROVAL.
- ALL WATER FACILITY CONSTRUCTION MATERIALS USED MUST BE AS LISTED ON THE LVVWD'S PRE-APPROVED MATERIALS AND MANUFACTURERS LISTING FOR NEW FACILITIES, LATEST REVISION, OR SPECIFICALLY APPROVED ON THE PLANS.

REVISED: April 25, 1995

WATER QUANTITIES

- 8" WATER 3120 L.F.
- ① 8" GATE VALVE 13 EA.
- ② 8" TEE 8 EA.
- ③ 22.5' ELBOW 7 EA.
- ④ 45' ELBOW 4 EA.
- ⑤ STANDARD FIRE HYDRANT ASSEMBLY 4 EA.
- ⑥ 1" TEE 2 EA.
- 1" COPPER LATER SERVICE (NO METER) 2 EA.
- 5/8" WATER METER W/ 1" COPPER SERVICE (CUPACS PLATE 1B) 55 EA.
- 2" BLOWOFF 1 EA.

STREET LIGHT QUANTITIES

- 100 TYPE 3 W/ POLE 19 EA.
- 1-1/4" CONDUIT W/ CABLE 2216 L.F.
- 150 TYPE 2 W/ POLE 2 EA.
- 3-1/2" PULL BOX 6 EA.

SANITATION SEWER QUANTITIES (PUBLIC)

- 8" SEWER 2970 L.F.
- 48" MANHOLE 16 EA.
- SEWER SERVICE 69 EA.

STORM SEWER QUANTITIES (PUBLIC)

- 18" STORM DRAIN RCP 140 L.F.
- 4" TYPE 'A' DROP INLET 1 EA.
- 14.5" MODIFIED TYPE 'C' DROP INLET 1 EA.

STREET SIGN QUANTITIES

- STD. STREET SIGN W/POLE (PER STD. DWG. No. 250) 10 EA.

C.L.V. FIRE FLOW DATA

FIRE FLOW REQUIREMENT IS 1500 GALLONS PER MINUTE AT 20 POUNDS PER SQUARE INCH RESIDUAL BASED ON:
 LARGEST SQUARE FOOTAGE: (1700 S.F.)
 TYPE OF CONSTRUCTION: (V)
 EXPOSURES: (10' OR MORE)
 HEIGHT: TWO STORIES
 SPRINKLER SYSTEM: (NONE)
 OCCUPANCY: SINGLE FAMILY
 ROOF CONSTRUCTION: CONCRETE TILES

NOTE: CONTRACTOR TO VERIFY DEPTH OF EXISTING SEWER STUB BEFORE COMMENCING CONSTRUCTION. ANY DISCREPANCY IN PLAN AND ACTUAL ELEVATION IS TO BE BROUGHT TO THE ENGINEERS ATTENTION IN WRITING IMMEDIATELY!

NOTICE: EXISTING UTILITIES ARE SHOWN ON PLANS FOR THE CONTRACTOR'S REFERENCE ONLY. THE CONTRACTOR IS RESPONSIBLE FOR THE PROTECTION OF ALL UTILITIES. THE ENGINEER BEARS NO RESPONSIBILITY FOR UTILITIES NOT SHOWN OR SHOWN INCORRECTLY.

BEFORE YOU DIG
 1-800-227-2800
 (NEVADA SERVICE 1-800-752-1111)

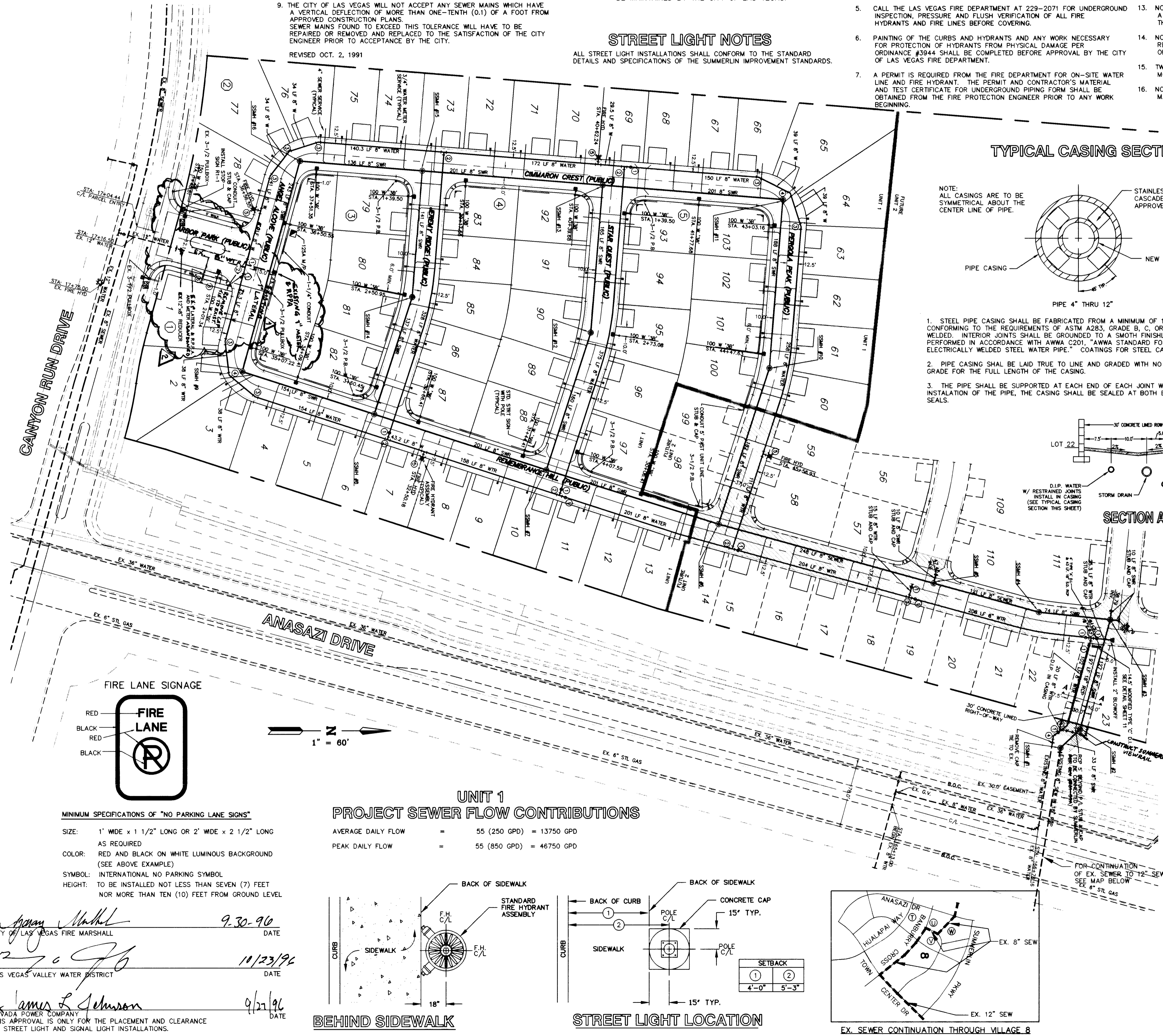

TYPICAL CASING SECTION

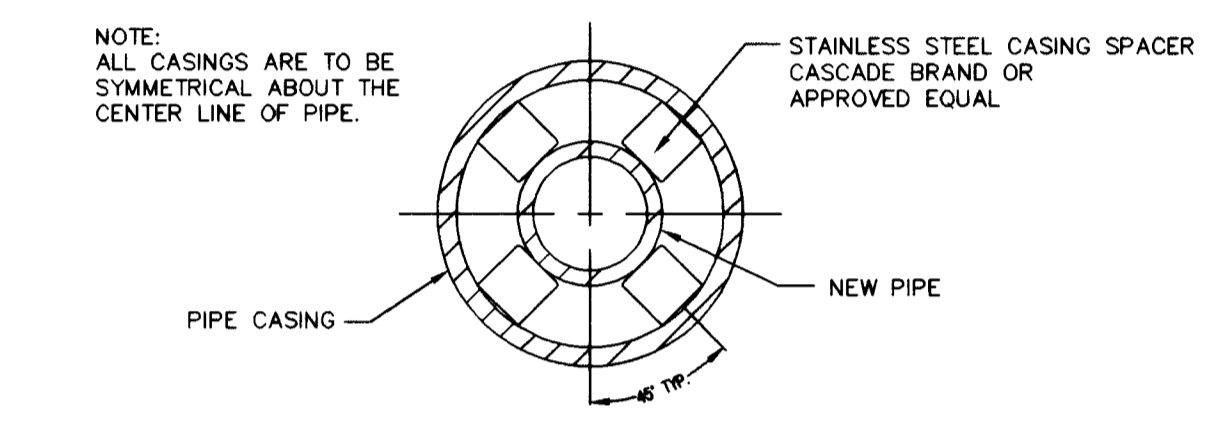

- STEEL PIPE CASING SHALL BE FABRICATED FROM A MINIMUM OF 1/4" THICK STEEL PLATES, CONFORMING TO THE REQUIREMENTS OF ASTM A283, GRADE B, C, OR D. ALL JOINTS SHALL BE WELDED. INTERIOR JOINTS SHALL BE GROUNDED TO A SMOOTH FINISH. ALL WELDING SHALL BE PERFORMED IN ACCORDANCE WITH AWWA C201, "AWWA STANDARD FOR FABRICATED ELECTRICALLY GALVANIZED STEEL WATER PIPE." COATINGS FOR STEEL CASING ARE NOT REQUIRED.
- PIPE CASING SHALL BE LAID TRUE TO LINE AND GRADED WITH NO BENDS OR CHANGES IN GRADE FOR THE FULL LENGTH OF THE CASING.
- THE PIPE SHALL BE SUPPORTED AT EACH END OF EACH JOINT WITH SPACERS. AFTER INSTALLATION OF THE PIPE, THE CASING SHALL BE SEALED AT BOTH ENDS WITH CASING END SEALS.

SECTION A-A

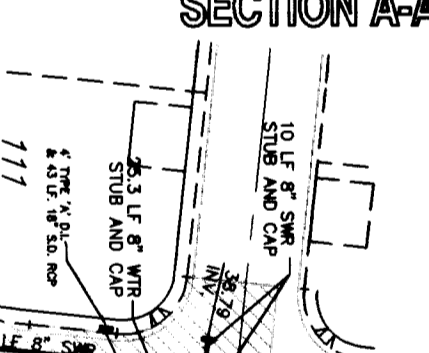

FIRE LANE SIGNAGE

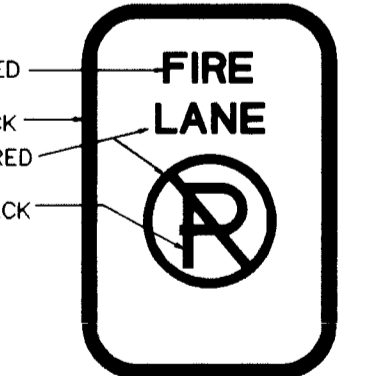

MINIMUM SPECIFICATIONS OF "NO PARKING LANE SIGNS"
 SIZE: 1' WIDE x 1 1/2' LONG OR 2' WIDE x 2 1/2' LONG AS REQUIRED
 COLOR: RED AND BLACK ON WHITE LUMINOUS BACKGROUND (SEE ABOVE EXAMPLE)
 SYMBOL: INTERNATIONAL NO PARKING SYMBOL
 HEIGHT: TO BE INSTALLED NOT LESS THAN SEVEN (7) FEET NOR MORE THAN TEN (10) FEET FROM GROUND LEVEL

UNIT 1 PROJECT SEWER FLOW CONTRIBUTIONS

AVERAGE DAILY FLOW = 55 (250 GPD) = 13750 GPD
 PEAK DAILY FLOW = 55 (850 GPD) = 46750 GPD

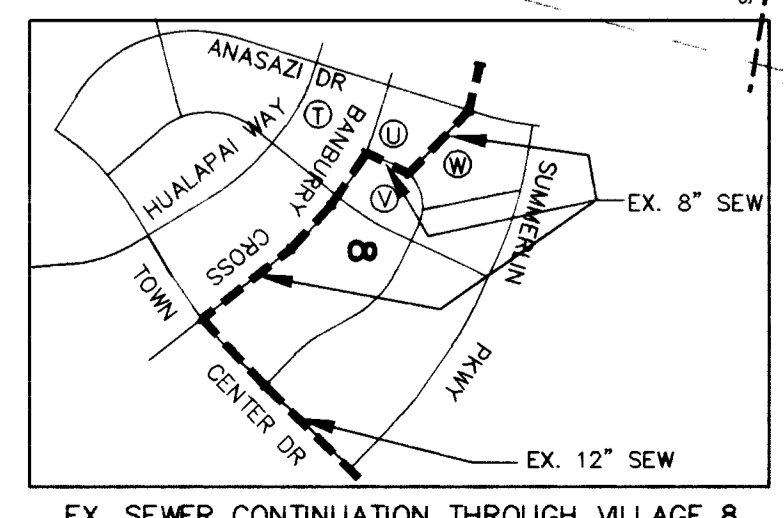
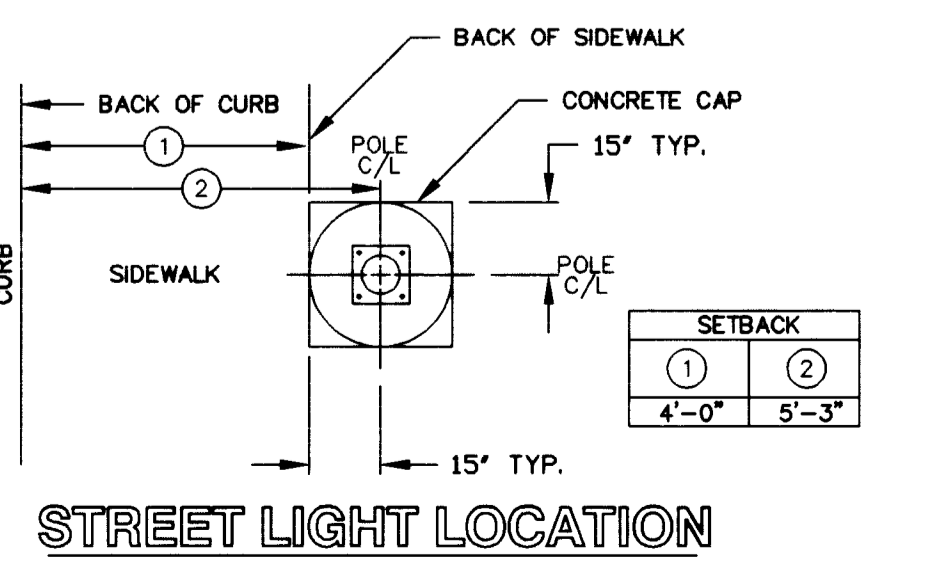
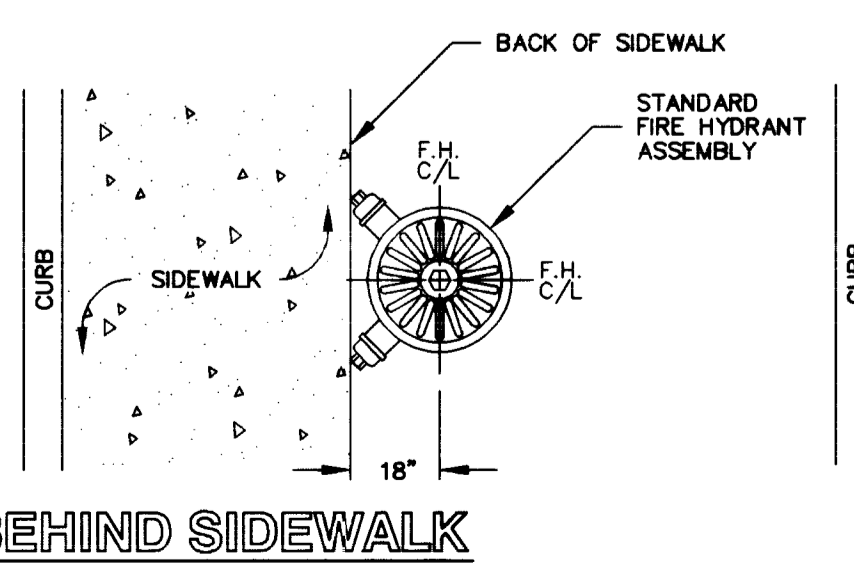

DATE: 11/23/96
 TIME: 9:30-9:00
 NAME: TANEY
 SCALE: 1" = 60'
 PAGE: 4
 U154.DWG OF 12

REVISED: 9/21/96

DATE: 9-23-96

JOB # 6131-01

DATE: 9-23-96

SCALE: 1" = 60'

PAGE: 4

U154.DWG OF 12

307Y-4482-1

ALPHA ENGINEERING COMPANY
 90 So. Jordan Blvd. Las Vegas, NV 89107
 Telephone: (702) 877-1300

STATE OF NEVADA
 PROFESSIONAL ENGINEER
 LICENSE NO. 10000

REVISIONS:

NO.	DATE	BY	DESCRIPTION
1	11/23/96	HL	REVISED PER LANDSCAPE METER AND IRRIGATION LATERALS REVISED PER LANDSCAPE METER PLAN APPROVED BY LVVWD.
2	9/21/96	HL	REVISED PER LANDSCAPE METER AND IRRIGATION LATERALS REVISED PER LANDSCAPE METER PLAN APPROVED BY LVVWD.

1" LATERAL AND 1" TEE ADDED FOR LANDSCAPE IRRIGATION.

MATSETER UTILITY PLAN
 DURABLE HOMES
 ARBOR GROVE UNIT 1

CITY OF LAS VEGAS WATER NOTES

1. ALL WORK SHALL BE IN ACCORDANCE WITH THE CITY OF LAS VEGAS WATER DEPARTMENT SPECIFICATIONS.
2. ALL WORK SHALL BE IN ACCORDANCE WITH THE CITY OF LAS VEGAS WATER DEPARTMENT SPECIFICATIONS.
3. ALL WORK SHALL BE IN ACCORDANCE WITH THE CITY OF LAS VEGAS WATER DEPARTMENT SPECIFICATIONS.
4. ALL WORK SHALL BE IN ACCORDANCE WITH THE CITY OF LAS VEGAS WATER DEPARTMENT SPECIFICATIONS.

5. ALL WORK SHALL BE IN ACCORDANCE WITH THE CITY OF LAS VEGAS WATER DEPARTMENT SPECIFICATIONS.
6. ALL WORK SHALL BE IN ACCORDANCE WITH THE CITY OF LAS VEGAS WATER DEPARTMENT SPECIFICATIONS.
7. ALL WORK SHALL BE IN ACCORDANCE WITH THE CITY OF LAS VEGAS WATER DEPARTMENT SPECIFICATIONS.
8. ALL WORK SHALL BE IN ACCORDANCE WITH THE CITY OF LAS VEGAS WATER DEPARTMENT SPECIFICATIONS.

SEWER CONNECTION NOTES

1. ALL SEWER CONNECTIONS SHALL BE IN ACCORDANCE WITH THE CITY OF LAS VEGAS WATER DEPARTMENT SPECIFICATIONS.
2. ALL SEWER CONNECTIONS SHALL BE IN ACCORDANCE WITH THE CITY OF LAS VEGAS WATER DEPARTMENT SPECIFICATIONS.
3. ALL SEWER CONNECTIONS SHALL BE IN ACCORDANCE WITH THE CITY OF LAS VEGAS WATER DEPARTMENT SPECIFICATIONS.

SEWER NOTES
 1. ALL SEWER CONNECTIONS SHALL BE IN ACCORDANCE WITH THE CITY OF LAS VEGAS WATER DEPARTMENT SPECIFICATIONS.

STREET LIGHT NOTES

1. ALL STREET LIGHTS SHALL BE IN ACCORDANCE WITH THE CITY OF LAS VEGAS WATER DEPARTMENT SPECIFICATIONS.

CITY OF LAS VEGAS FIRE NOTES

1. ALL FIRE PROTECTION WORK SHALL BE IN ACCORDANCE WITH THE CITY OF LAS VEGAS WATER DEPARTMENT SPECIFICATIONS.
2. ALL FIRE PROTECTION WORK SHALL BE IN ACCORDANCE WITH THE CITY OF LAS VEGAS WATER DEPARTMENT SPECIFICATIONS.
3. ALL FIRE PROTECTION WORK SHALL BE IN ACCORDANCE WITH THE CITY OF LAS VEGAS WATER DEPARTMENT SPECIFICATIONS.
4. ALL FIRE PROTECTION WORK SHALL BE IN ACCORDANCE WITH THE CITY OF LAS VEGAS WATER DEPARTMENT SPECIFICATIONS.
5. ALL FIRE PROTECTION WORK SHALL BE IN ACCORDANCE WITH THE CITY OF LAS VEGAS WATER DEPARTMENT SPECIFICATIONS.

6. ALL FIRE PROTECTION WORK SHALL BE IN ACCORDANCE WITH THE CITY OF LAS VEGAS WATER DEPARTMENT SPECIFICATIONS.
7. ALL FIRE PROTECTION WORK SHALL BE IN ACCORDANCE WITH THE CITY OF LAS VEGAS WATER DEPARTMENT SPECIFICATIONS.
8. ALL FIRE PROTECTION WORK SHALL BE IN ACCORDANCE WITH THE CITY OF LAS VEGAS WATER DEPARTMENT SPECIFICATIONS.
9. ALL FIRE PROTECTION WORK SHALL BE IN ACCORDANCE WITH THE CITY OF LAS VEGAS WATER DEPARTMENT SPECIFICATIONS.
10. ALL FIRE PROTECTION WORK SHALL BE IN ACCORDANCE WITH THE CITY OF LAS VEGAS WATER DEPARTMENT SPECIFICATIONS.

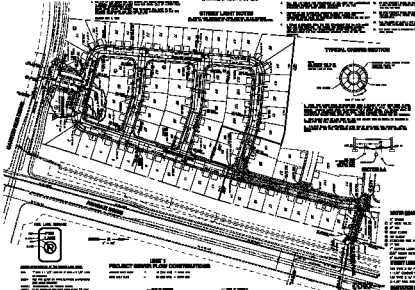

LAS VEGAS VALLEY WATER DIST. NOTES

1. ALL WORK SHALL BE IN ACCORDANCE WITH THE CITY OF LAS VEGAS WATER DEPARTMENT SPECIFICATIONS.
2. ALL WORK SHALL BE IN ACCORDANCE WITH THE CITY OF LAS VEGAS WATER DEPARTMENT SPECIFICATIONS.
3. ALL WORK SHALL BE IN ACCORDANCE WITH THE CITY OF LAS VEGAS WATER DEPARTMENT SPECIFICATIONS.
4. ALL WORK SHALL BE IN ACCORDANCE WITH THE CITY OF LAS VEGAS WATER DEPARTMENT SPECIFICATIONS.
5. ALL WORK SHALL BE IN ACCORDANCE WITH THE CITY OF LAS VEGAS WATER DEPARTMENT SPECIFICATIONS.

1. SCHEDULE

1. ALL WORK SHALL BE IN ACCORDANCE WITH THE CITY OF LAS VEGAS WATER DEPARTMENT SPECIFICATIONS.
2. ALL WORK SHALL BE IN ACCORDANCE WITH THE CITY OF LAS VEGAS WATER DEPARTMENT SPECIFICATIONS.
3. ALL WORK SHALL BE IN ACCORDANCE WITH THE CITY OF LAS VEGAS WATER DEPARTMENT SPECIFICATIONS.
4. ALL WORK SHALL BE IN ACCORDANCE WITH THE CITY OF LAS VEGAS WATER DEPARTMENT SPECIFICATIONS.
5. ALL WORK SHALL BE IN ACCORDANCE WITH THE CITY OF LAS VEGAS WATER DEPARTMENT SPECIFICATIONS.

MINI-SCHEDULE

1. 1/2" DIA	1.00
2. 1/2" DIA	1.00
3. 1/2" DIA	1.00
4. 1/2" DIA	1.00
5. 1/2" DIA	1.00
6. 1/2" DIA	1.00
7. 1/2" DIA	1.00
8. 1/2" DIA	1.00
9. 1/2" DIA	1.00
10. 1/2" DIA	1.00

C.I.P. PIPE FLOW DATA

1. 1/2" DIA	1.00
2. 1/2" DIA	1.00
3. 1/2" DIA	1.00
4. 1/2" DIA	1.00
5. 1/2" DIA	1.00
6. 1/2" DIA	1.00
7. 1/2" DIA	1.00
8. 1/2" DIA	1.00
9. 1/2" DIA	1.00
10. 1/2" DIA	1.00

UNIT'S PROJECT SEWER FLOW CONTRIBUTIONS

1. 1/2" DIA	1.00
2. 1/2" DIA	1.00
3. 1/2" DIA	1.00
4. 1/2" DIA	1.00
5. 1/2" DIA	1.00
6. 1/2" DIA	1.00
7. 1/2" DIA	1.00
8. 1/2" DIA	1.00
9. 1/2" DIA	1.00
10. 1/2" DIA	1.00



APPROVED: _____
 DATE: _____
 PROJECT NO. _____
 SHEET NO. _____

MATERIALS LIST

APPROX. QUANTITY

UNIT

ALPHA

CONTRACT

DATE

NO.

REV.

BY

CHKD.

DATE

NO.

REV.

BY

CHKD.

DATE