

GRADING NOTES

- ALL PROPOSED PAD ELEVATIONS AND SWALE ELEVATIONS ARE ROUGH GRADES. ALL OTHER PROPOSED ELEVATIONS ARE FINISHED GRADES.
- THE GRADING PLANS SHALL BE AT THE PROJECT SITE THROUGHOUT THE COURSE OF CONSTRUCTION.
- ALL GRADING SHALL BE PERFORMED IN CONFORMANCE WITH THE LINES, GRADES AND DETAILS AS SHOWN ON THESE PLANS. ANY DEVIATION FROM THESE PLANS WILL ONLY BE PERMITTED UPON WRITTEN APPROVAL FROM THE ENGINEER.
- ALL PADS ARE TO BE GRADED WITHIN 0.1' OF THE ELEVATIONS AS SHOWN ON THE PLANS. GRADING IS NOT COMPLETE UNTIL THE ENGINEER HAS CERTIFIED THAT THE PADS HAVE BEEN GRADED IN SUBSTANTIAL CONFORMANCE TO THE PLANS.
- ALL GRADING SHALL BE PERFORMED IN CONFORMANCE WITH THE FOLLOWING REPORT PREPARED BY: TERRACON, DATED 10/2/95 PROJECT NO. 64955202

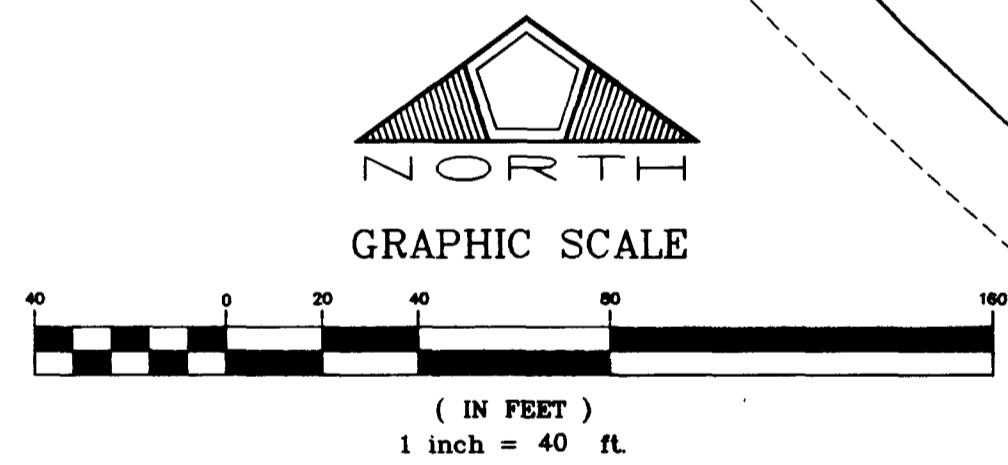
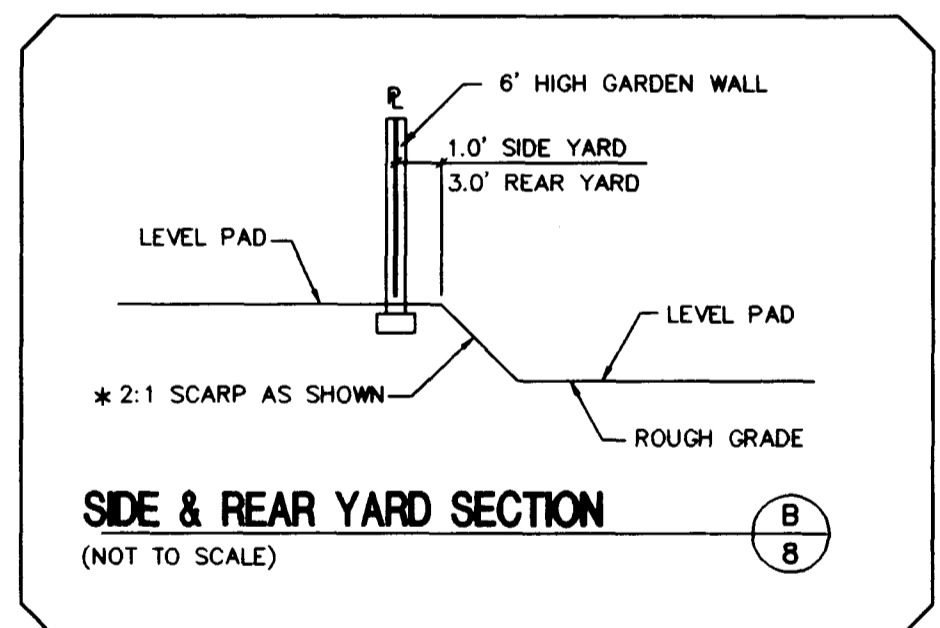
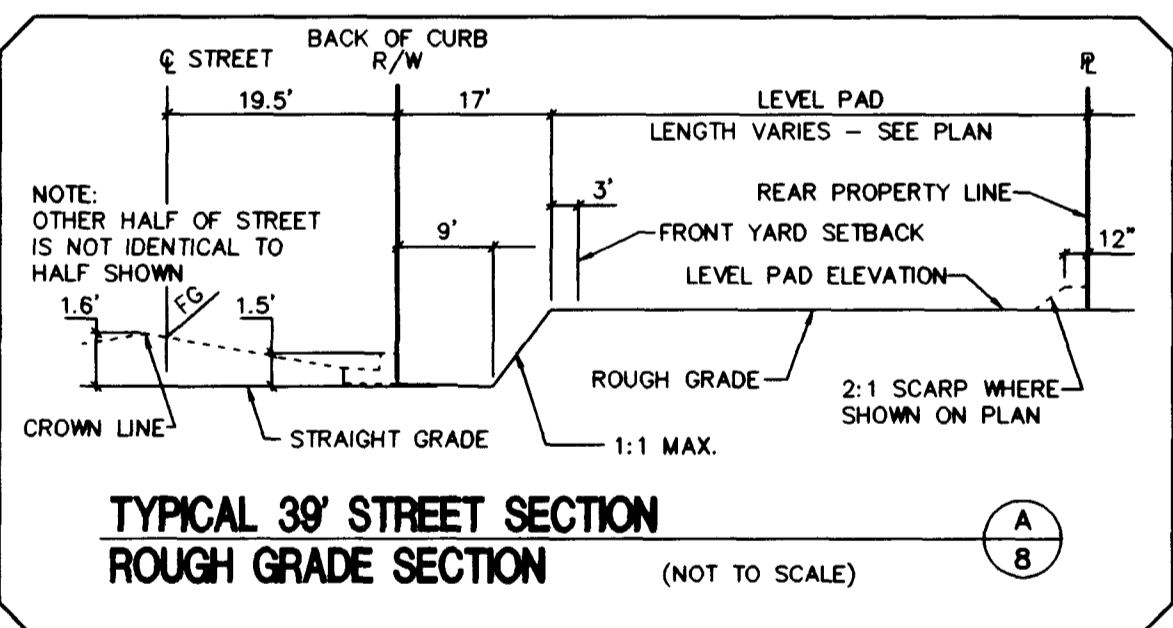
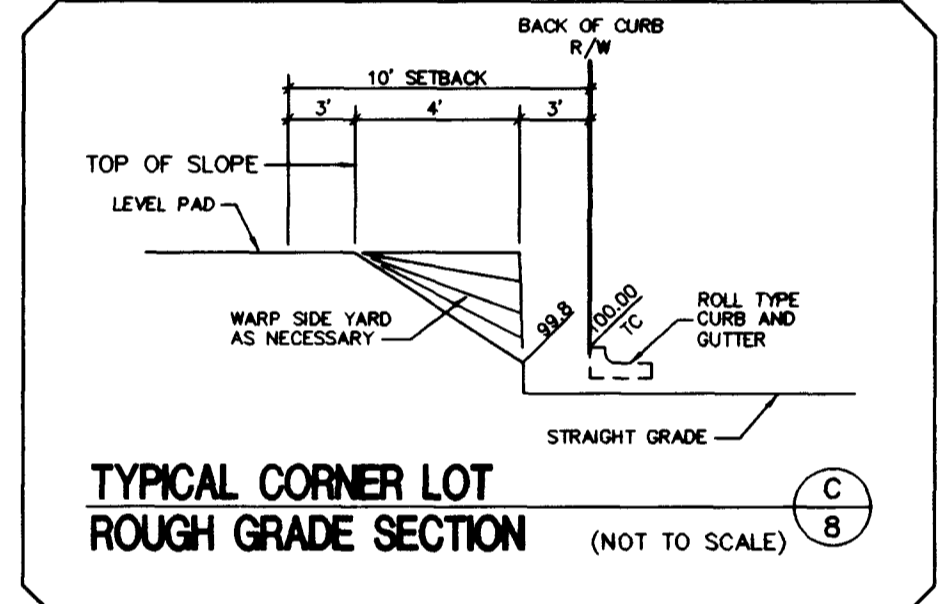
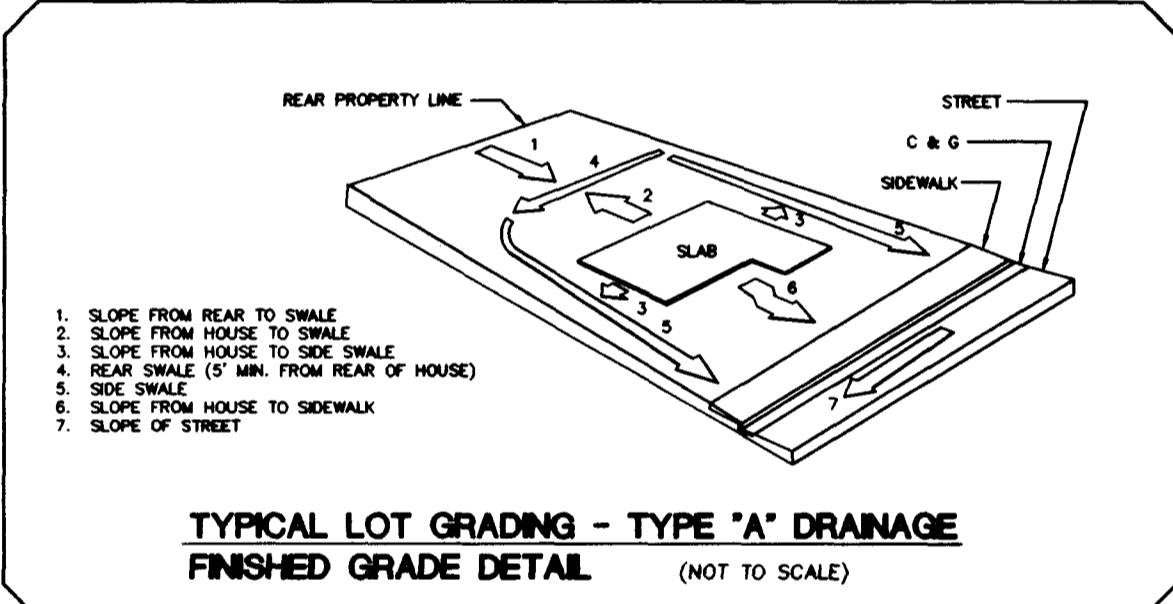
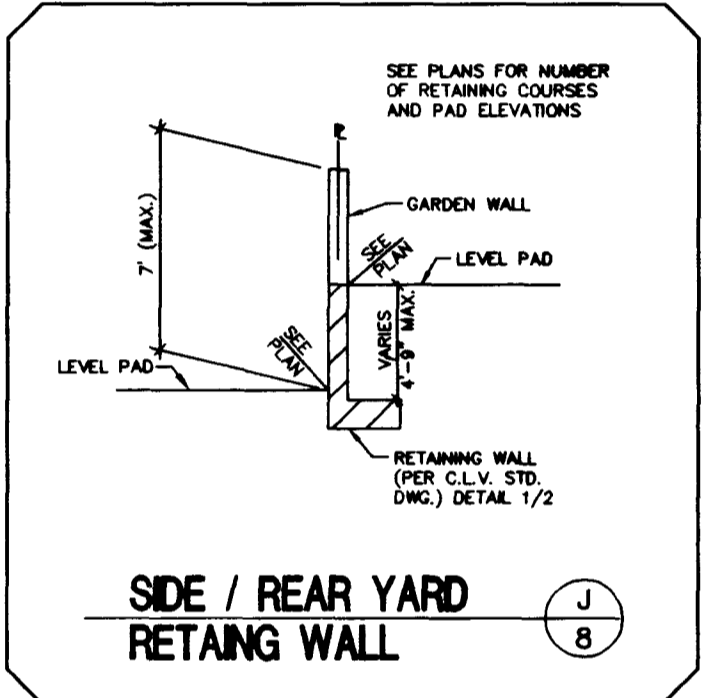
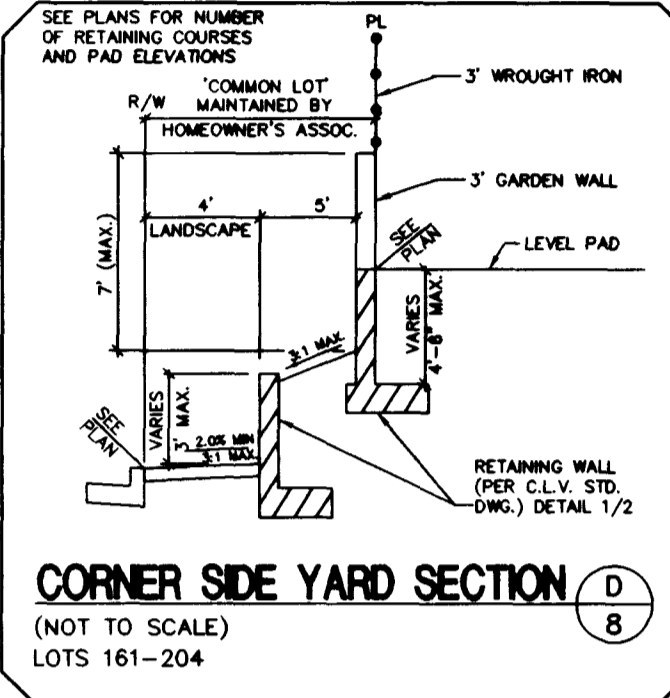
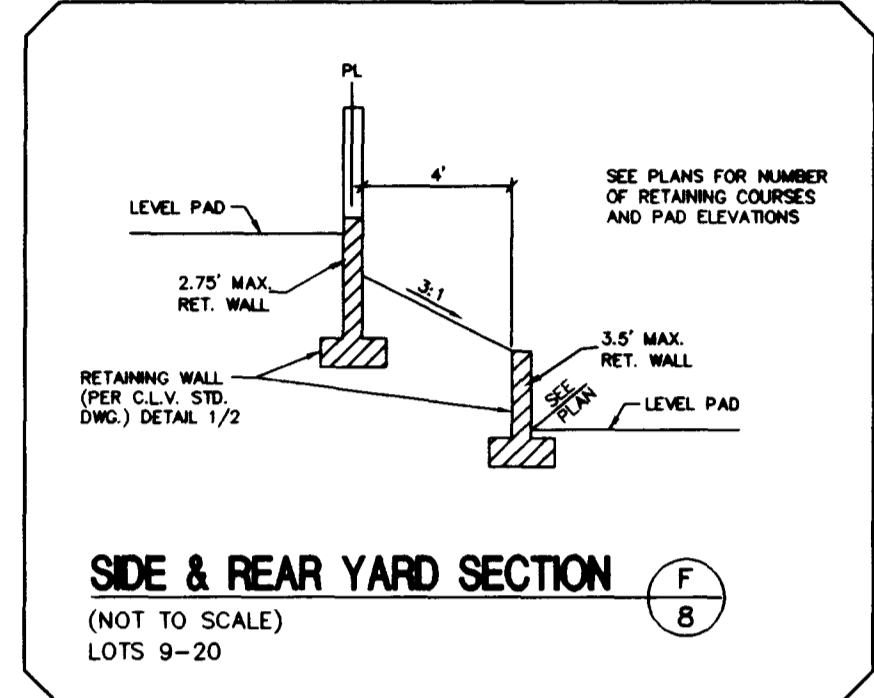
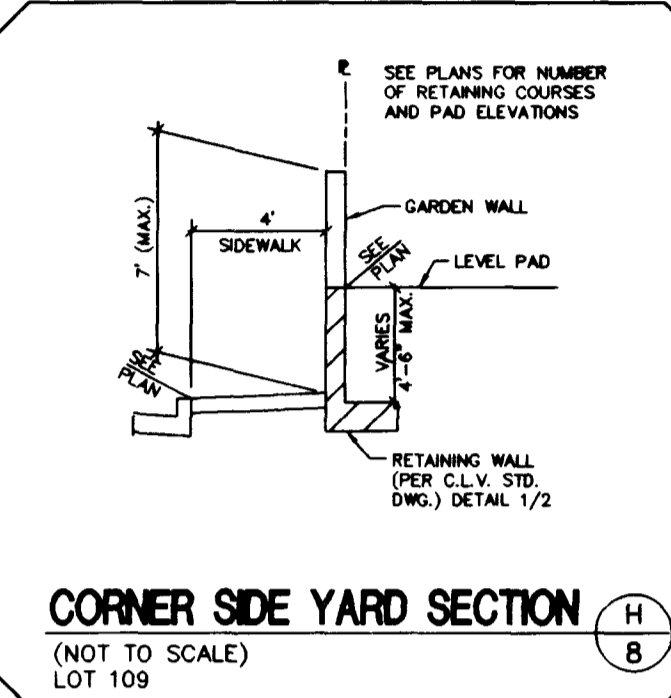
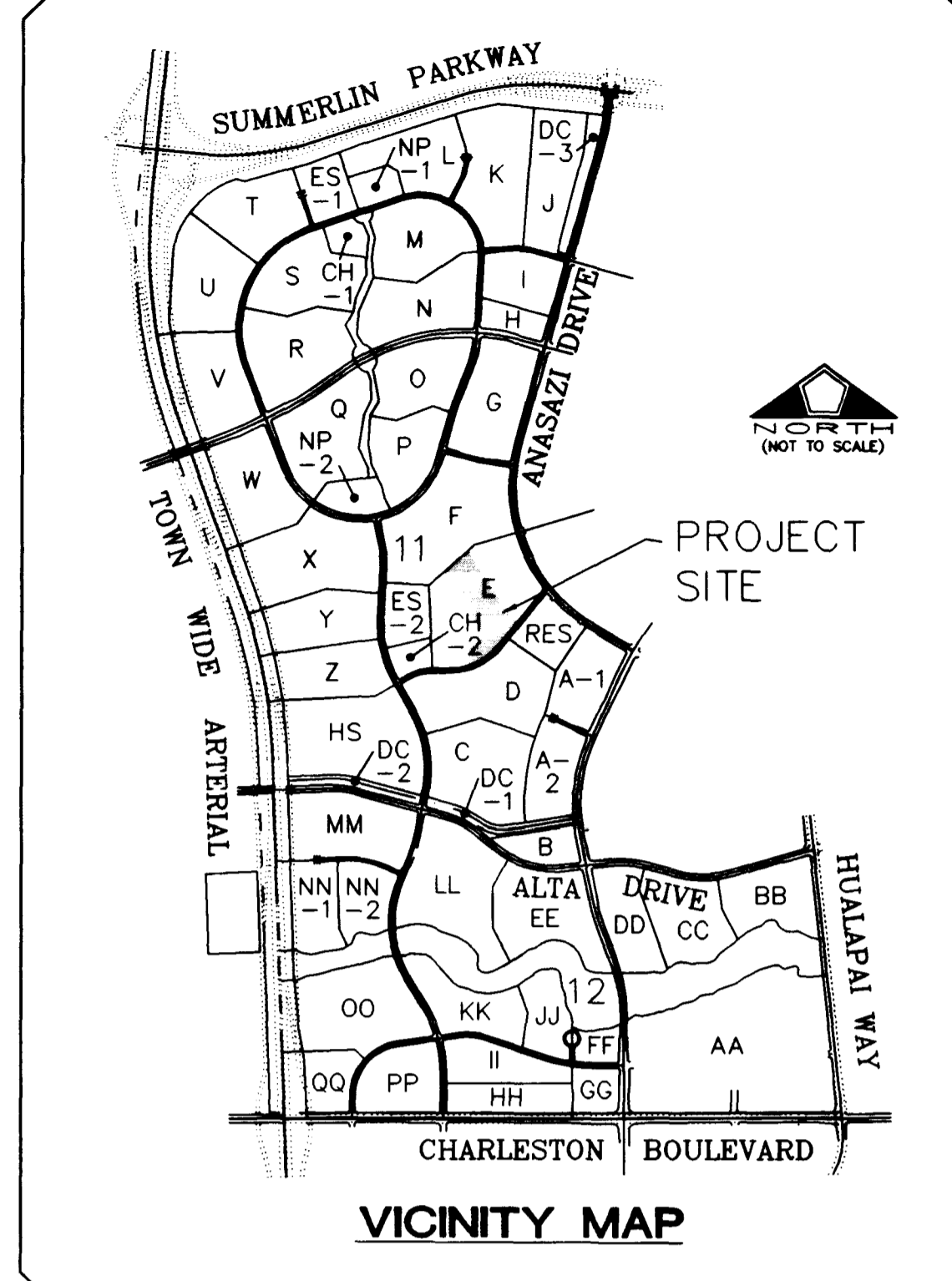

I CERTIFY THAT THIS GRADING PLAN IS IN CONFORMANCE WITH THE APPROVED DRAINAGE STUDY ON FILE AT THE CITY OF LAS VEGAS FOR THIS PROJECT.

Kelly J. Warner, P.E. 3/28/97 DATE
KELLY J. WARNER, P.E. #10625

BASIS OF BEARING

NORTH 51°53'13" EAST, BEING THE BEARING BETWEEN G. C. WALLACE CONTROL MONUMENT No. 194 AND G. C. WALLACE CONTROL MONUMENT No. 204 (BRUTUS) SITUATE IN SECTION 25, TOWNSHIP 20 SOUTH, RANGE 59 EAST, M.D.M., CITY OF LAS VEGAS, CLARK COUNTY, NEVADA, AS SHOWN ON THAT CERTAIN MAP ON FILE IN THE OFFICE OF THE CLARK COUNTY RECORDER IN FILE 85 OF SURVEYS, AT PAGE 17.

BENCHMARK

G. C. WALLACE CONTROL MONUMENT No. 204 (BRUTUS)
A 2" BRASS CAP IN CONCRETE STAMPED "BRUTUS" PER FILE 85 OF SURVEYS, AT PAGE 17.

ELEVATION = 3000.64 (SUMMERLIN DATUM) * PROJECT DATUM
TO OBTAIN NAVD'88 DATUM FROM SUMMERLIN DATUM, ADD 2.2 FEET PER FILE 85, PAGE 17 OF SURVEYS.

ELEVATION = 915.267 METERS (COMPUTED NAVD'88)
ELEVATION = 3002.84 FEET (COMPUTED NAVD'88)

LEGEND

FL	FLOW LINE	(M)	BLOCK NUMBER
FG	FINISHED GRADE	1381	LOT NUMBER
FG-TB	FINISHED GRADE/TOP OF BERM	FF=22.1	PROPOSED FINISH FLOOR
TC	TOP OF CURB	(21.1)	PROPOSED PAD ELEVATION
SWALE	SWALE	(21.5)	FUTURE PAD ELEVATION
GRADE BREAK	GRADE BREAK	(17.5)	EXISTING PAD ELEVATION
2:1 SCARP	2:1 SCARP	1785	EXISTING CONTOUR 5
BUILDING SETBACK	BUILDING SETBACK	(98.63)	EXISTING CONTOUR 1
TOP OF SLOPE, FRONT AND SIDE YARD	TOP OF SLOPE, FRONT AND SIDE YARD	98.63	EXISTING ELEVATION
FUTURE IMPROVEMENTS	FUTURE IMPROVEMENTS	[98.63]	PROPOSED ELEVATION
EXISTING IMPROVEMENTS	EXISTING IMPROVEMENTS		FUTURE ELEVATION
RETAINING WALL	RETAINING WALL		HIGH POINT OF SWALE
EDGE OF EXISTING ASPHALT	EDGE OF EXISTING ASPHALT		STREET CENTERLINE
SUBDIVISION BOUNDARY	SUBDIVISION BOUNDARY		COURSES OF 8" CMU
GARDEN WALL	GARDEN WALL		NUMBER OF RETAINING COURSES

DATE: 03/21/97
DRAWN BY: KAS
DESIGNED BY: KAS
CHECKED BY: KAS
JOB NO.: 0001066
SCALE: 1" = 40'

PENTACORE
CIVIL ENGINEERING - LAND SURVEYING - PLANNING
CONSTRUCTION MANAGEMENT - ADA CONSULTING
6783 WEST CHARLESTON BOULEVARD
LAS VEGAS, NEVADA 89102 (702)258-0115

LEWIS HOMES OF NEVADA
CHARDONWAY No. 52
GRADING PLAN 1

SHEET 8 OF 9

107Y-4512-52

